

Sure Control for Driving Pilot Pipes

Video Measurement System VM-16

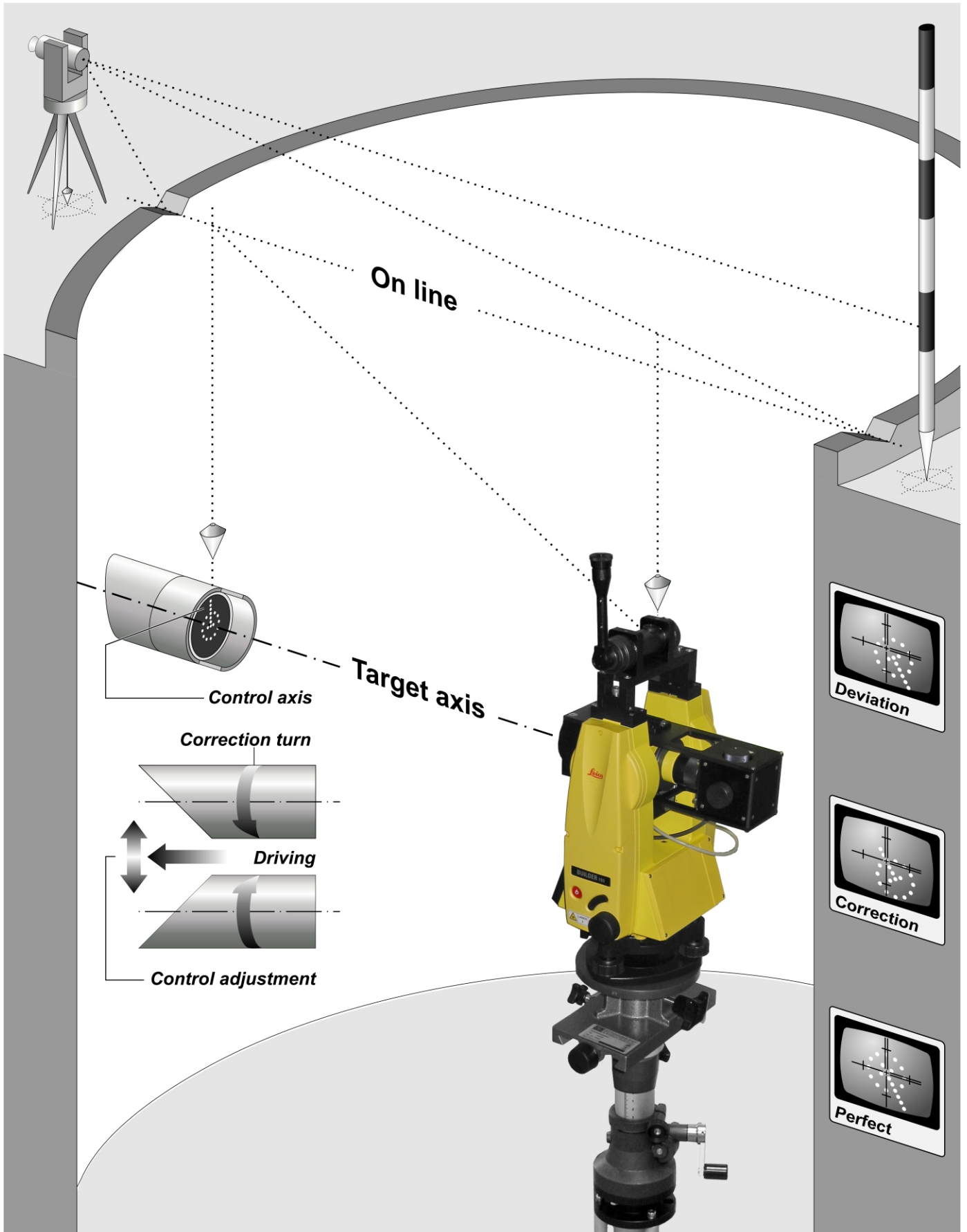

Video Measurement System VM-16

VM-16 with active illuminated target board. Range up to 130 m, depends on diameter of pipe and dimensions of target.

Controlling your way to success

The video measurement system VM-16 was specially developed for controlling pilot pipes. It can also be used for a wide variety of other tasks and has proven itself worldwide in rugged construction site conditions.

The functional principle is as simple as it is ingenious

A pilot pipe is pressed through the earth by the ground displacement method. The control adjustment is carried out quite simply by the inclined face of the control head.

The inclination is related to the control axis of the target board. The arrangement of the target board places the all-important control axis in the centre.

The target board is observed with a theodolite. A CCD camera transmits the picture to the monitor. Deviations from the target axis can be seen immediately and are corrected by turning the pilot pipe. The rotation is stopped as soon as the control axis is on the centre point of the telescope reticule. The height and direction are then corrected automatically as driving proceeds. The target axis is reached when the centre of the target board coincides with the centre of the telescope reticule.

System components

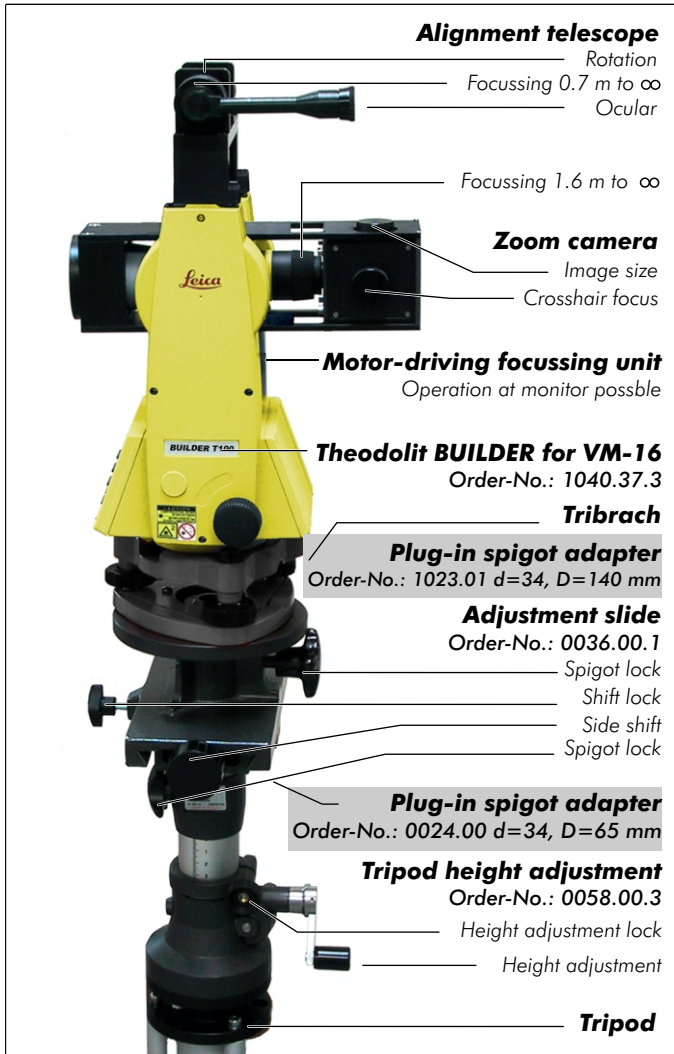

Alignment telescope

The first solution for quick and accurate line transmission and monitoring. Use the good method of line orientation from bottom to top to your advantage.

Zoom Camera

Image scale: at 100 m target distance 1 : 0.5 to 1 : 2
Standard deviation: ± 10 mm/100 m

LED target board GEO-2224 Order-No.: 4007.25

Target with integrated Lilon rechargeable battery, innovative energy saving function, excess temperature warning / cut-off.

Battery: . . . Lilon rech. battery, 3.7 V/6.8 Ah / Operating time to 240 hours
Watertight to 20 m
Dimensions: Ø 58 x 138 mm

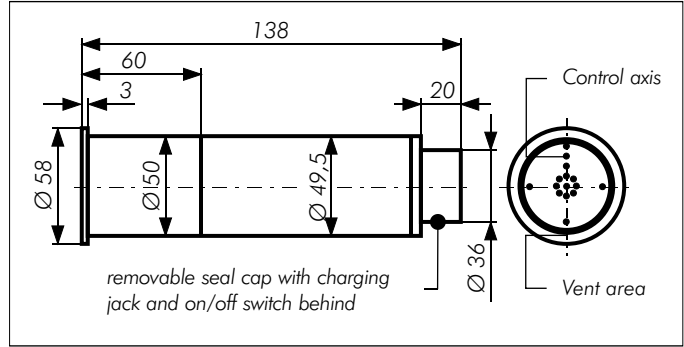

Target board adapter

For use of the LED target board GEO-2224 in larger pilot pipes.

Order-No.: 4007.02.017 Order-No.: 4007.02.020 for RVS-80

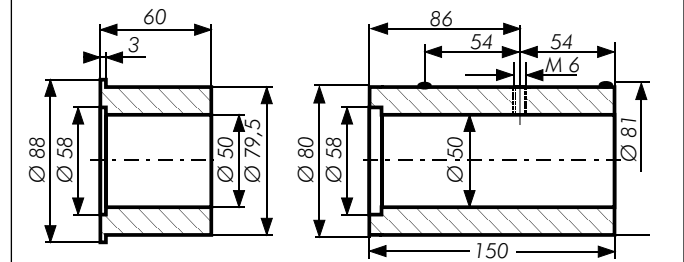

LG-22 Battery charger Order-No.: 4008.07 for GEO-2224

Prim: 100 - 240 V AC 50 - 60 Hz. . . Sec: max. 4.2 V DC, max. 1500 mA
Charging time: 7 hours, depending on residual charge
Short-circuit / inverse-polarity protection, automatic final charge cut-off.

MF-03 10.4" Flatscreen Monitor Order No.: 4005.29

Power supply 10.5 - 14 V DC/1.5 A.
Integrated power supply for theodolite, laser, camera and reticle illumination and focussing of theodolite camera.

Dimensional sketch

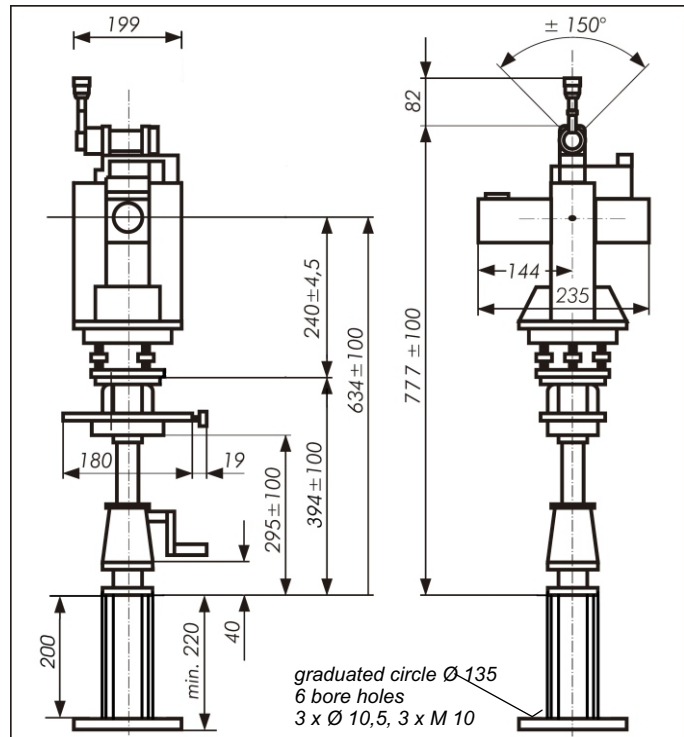

02.2016



- Construction lasers
- Special applications
- Automatic tripod
- Measuring systems and lasers for tunneling and pipe jacking

GEO-Laser GmbH

Solinger Str. 8
45481 Muelheim an der Ruhr
Germany

Phone +49 208 99357-0
Fax +49 208 99357-25
info@geo-laser.de
www.geo-laser.de