

# EASY Planting & Assembly Instructions



## VertiGarden™ Contents:

- 1 Plastic Grow Tray
- 8 Plastic Planting Lids
- 1 Fitted Irrigation String,
- 2 Metal Hanging Brackets,
- 2 extension hangers (for additional modules hung off the bottom of the first)
- 2 Screws,
- 2 Wall Plugs,
- 1 Irrigation Connector,
- 1 Irrigation Stop.

Your VertiGarden™ Module has been designed to give you a rewarding vertical garden display. It has been tried and tested to provide seasonal colour and can be replanted for Summer and Winter use over and over again. You can use perennials in your VertiGarden as well, however these still may not last as long as they possibly would in your regular garden beds due to limited root space.

The selection of plants is yours but we would suggest plants that have a spreading or semi trailing habit are best. We recommend the use of a good quality Basket/ Container compost and would suggest that your plants would benefit from a slow release fertiliser being incorporated into the compost mix prior to planting. Your VertiGarden™ can be planted with Seedlings, Plugs, Starter Plants, Pot Plants or even seeded directly, the choice is yours. Consideration should be given to the growing on of your module and the correct siting in the vertical position, all of which will depend on your choice of plants. When choosing plants, consider the location (sun/shade), whether they have equal water needs and how long you'd like the display to last. Please read and study the full instructions before starting to plant up your module so that you can identify the correct steps to take.

## Using Starter plants, plug plants and/or Seedlings:

1. Place the plastic grow tray with fitted irrigation on a suitable flat, planting surface
2. Ensure the arrow is pointing up (TOP) (fig.1).
3. The designed for purpose irrigation string has been pre-installed ready for use.
4. Fill the tray with a good quality compost. At this stage it is advisable to add a slow release fertilizer into the compost. (fig. 3)
5. When completely filled, lightly firm the compost. Clip the lids into the allocated segments on to the tray as shown in figures 4 to 6. Ensure the arrow always points to the outside edge of the module. You will therefore have the top ones pointing up, and the bottom ones pointing down.
6. Use a dibber to create a planting hole, and use starter plants, plug plants or seedlings to plant up the module (figures 7 to 10)
8. Take each plant and place into the hole so that the top of the compost is just below the surface of the lid.
9. Gently firm in each plant
10. When fully planted, water well.
11. Place the tray in a suitable environment for the plants you've used and grow on horizontally. Water as you would if the plants were in pots. Water well initially and then allow to dry before watering again. Do not over water.
12. Your VertiGarden module should be ready to hang in three to four weeks once the roots have established and prevailing weather conditions are favourable.

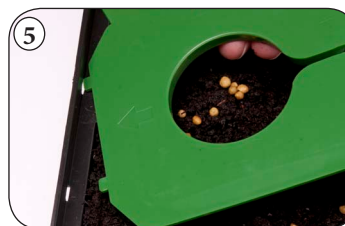

**Using Pack and/or Pot Bedding up to 10cm (short) pots.**

Pack Bedding and Pot Bedding of a pot size not exceeding 10cm diameter and 9cm in depth can be used. First complete steps 1 to 3 as shown in the instructions for planting with plug plants.

1. Place your plants in place in the grow tray - position the 4 plants in such a way that the lids can be positioned around the top foliage/flowers (fig. 11).
2. Fill in around the root balls with a good quality compost and lightly firm in to ensure no air gaps. It is advised you add some slow release fertilizer into the compost at this point (fig. 12).
3. Clip the lids into place, twisting the flexible sides to arrange them around the plants so that the foliage and flowers stick out the hole (fig. 13 & 14).
4. When fully planted, water well.
5. Follow steps 10 to 12 above, or alternatively, as you have used larger plants in this instance the module could be hung up immediately or within a few days.

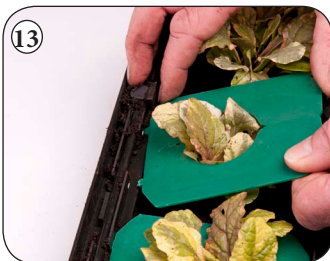

**VertiGarden™ Module Wall Mounting Instructions**

VertiGarden™ modules can be mounted on almost any vertical surface, care should be taken to select suitable fixings for the mounting surface.

**Weight limitations:** It should be noted that each VertiGarden™ module, planted and watered can weigh up to 10kg when fully grown and the water tank can be a further 3kg when full. We recommend that no more than two Modules are hung from any one set of fixing points. Therefore mounting brackets should be fixed for every two Modules hung vertically. The weight of modules should therefore be considered when positioning VertiGarden™ and selecting appropriate fixings.

1. Decide on the height of the top of your module. Mark this position then 10mm above this point mark two holes 29cm apart on a horizontal line.
2. Drill the two holes using a 6mm masonry drill bit. Ensure the depth is sufficient to accommodate the wall plugs. NOTE: Plugs and screws supplied are suitable for sound masonry, brick or stone walls. Fixing to alternative surfaces may require different fixings.

3. Insert the wall plugs and push fully home until flush with the wall surface. A hammer may be required to gently tap the plug into place
4. Screw each of the brackets into place with the hooked side facing out from the wall. When fully secured check they are vertical (fig. 15 & 16).
5. Lift the module higher than the bottom bracket hooks (fig. 17 & 18). Press the module against the brackets and then slide it down the brackets until they engage with the slots on the back of the plastic grow tray. (fig. 17). NOTE: make sure that the module is the right way up! The irrigation pipe should emerge from the top right corner.



**Hanging an Additional Module**

Take the extension hangers and hang them off the bottom of the first metal brackets. Hang the next brackets off the bottom of the extension hangers, as seen in figure 19 & 20. Screw the second brackets into the wall to lock them in place (fig. 21 & 22). Take your second VertiGarden™ Module and present the slots of the grow tray to the brackets (fig. 23). Lift the module higher than the bottom bracket hooks. Press the module against the brackets and then slide it down the brackets until they engage with the allocated slots on the plastic grow tray (fig. 24).

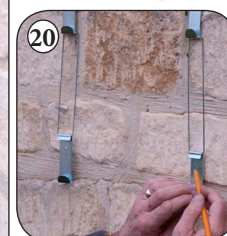
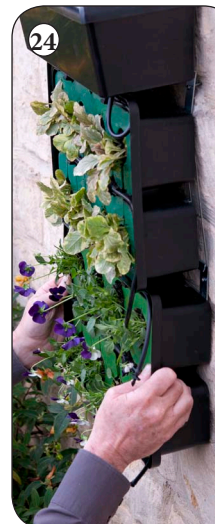

### Connecting the Irrigation

As soon as your VertiGarden™ module is hung in the vertical position you will need to use the built in irrigation to water the plants. The irrigation string is designed for use with a low pressure system. The VertiGarden™ Water Tank if used provides a water supply fed by gravity. The alternative is to connect the irrigation to a micro drip irrigation system that is pressure regulated to 1.5 bar or similar. These systems are readily available and are supplied with a pressure regulator. Do not connect directly to a mains pressure supply, this will simply blow the irrigation apart. NOTE: A clean water supply should be used at all times. It is advisable to flush through the irrigation pipe before fitting connectors.

The pipe emerging from the top right corner of the first (upper) module needs to be connected to a suitable water source, either a VertiGarden™ Water Tank (fig. 25) or a micro drip irrigation system (the supplied irrigation connector can be used for this purpose).

The irrigation connector can also be used to join the irrigation pipe between the two modules (fig. 26).

Push the connector into the pipe emerging from the bottom right of the upper module. Now push the other end of the connector into the pipe emerging from the top right corner of the lower module. If necessary, cut off the extra length on the irrigation pipe for a neater appearance (fig. 27).

The end stop is used to plug the bottom end of the irrigation pipe emerging from the bottom right of the lowest module (fig. 28).

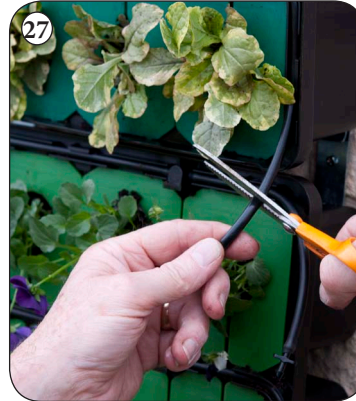

### Replanting the VertiGarden™ Module

At the end of the flowering season: Take down your VertiGarden™ module, remove the lids and tip out the plants and compost. The module can now be cleaned with water and a mild detergent if desired. The irrigation string should be flushed through to ensure there is nothing blocking the drippers. The module can now be replanted with seasonal bedding, perennials, or stored safely for use next year. Should you require any spare parts these are available from [www.vertigarden.co.uk](http://www.vertigarden.co.uk).