

evolve

Auto-Diverting Tub Spout System

+ ShowerStart® TSV³

FOR IN WALL DIVERTERS
With Hand Shower
EV3746-CPXX-SB

GUIDE

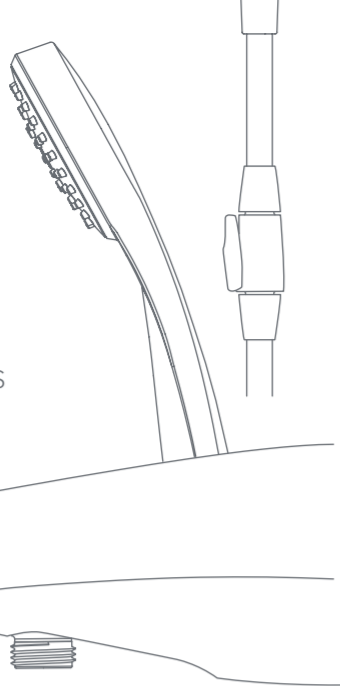

CERTIFIED SUPERIOR PERFORMANCE		
part number	max flow at 80 psi	min flow at 45 psi
EV3746-CP125	1.25gpm (4.7 L/min)	.9gpm (3.4 L/min)
EV3746-CP150	1.5gpm (5.7 L/min)	1.1gpm (4.2 L/min)
EV3746-CP175	1.75gpm (6.6 L/min)	1.3gpm (4.9 L/min)

IMPORTANT SAFETY INFORMATION:
ShowerStart TSV is NOT an anti-scald device.

- Lower water heater temperature to prevent scalding accidents.
- Water temperatures above 120° F can cause severe burns or even death.
- Always resume water flow and check water temperature before entering shower.
- Not designed for use with tankless hot water heaters.

HOW IT WORKS

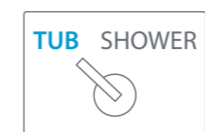

1 Turn water flow to tub spout

Make sure the water flow is always set to **TUB** whether taking a bath or shower.

note: failure to set to **TUB** will result in a stream of water flowing from the hand shower mount.



2 Turn on hot water

Cold water exits spout. Continue with your typical routine - the things you do while waiting for the shower to become warm.

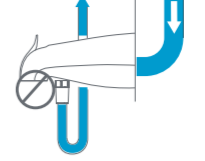

3 Auto diverts when hot water arrives

Upon reaching 95°F, ShowerStart Technology automatically diverts flow. Showerhead trickles - saving hot water until you get in.

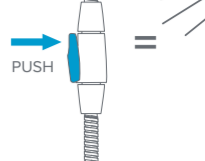

4 Push button when ready to shower

Push the in-hose button to activate normal flow and begin showering.

Taking a bath

If a bath is preferred, simply push tub spout lever back to its original position.

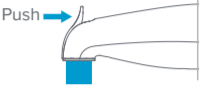

HANDSHOWER INSTALLATION

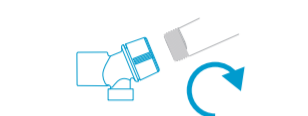

1 Remove washer from pipe if present. Hand tighten Evolve Handshower Mount clockwise onto the shower pipe.

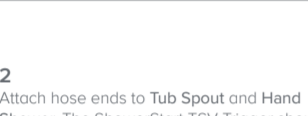

2 Attach hose ends to Tub Spout and Hand Shower. The ShowerStart TSV Trigger should be attached closest to the Hand Shower.

THREADED CONNECTION INSTALLATION

Use Threaded Connection Install if:
• threaded pipe extends 5/8" or less from wall

Tools needed:
hex key (included)

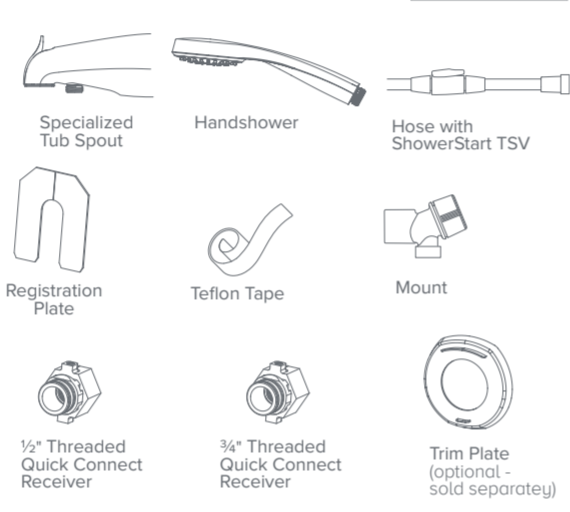

1 Wrap supplied Teflon Tape around threads in a clockwise direction.

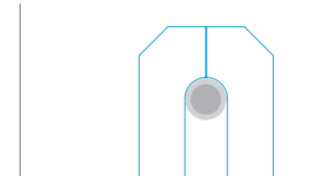

2 Place Registration Plate to assure accurate alignment.

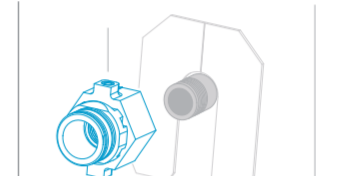

3 Thread the appropriate size Quick Connect Receiver onto the water supply pipe. Align vertical indication on mount with registration plate. Adjust teflon tape if necessary to achieve tight and vertical. Remove Registration Plate.

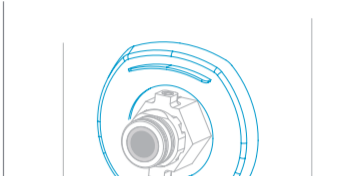

4 (Optional - sold separately) If necessary or desired, affix Trim Plate.

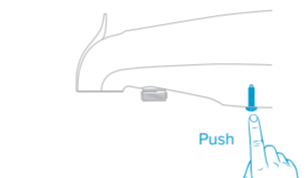

5 Before attaching the Auto-Diverting Tub Spout, press up on the unit's set screw until it can move upwards no further. (unthread screw slightly if interfering)



6 Fully seat the Auto-Diverting Tub Spout.

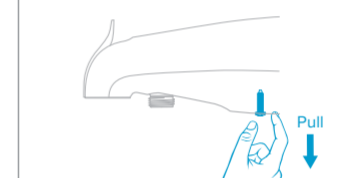

7 Pull the Auto-Diverting Tub Spout's set screw until it slides downward no further. This holds the unit in place.

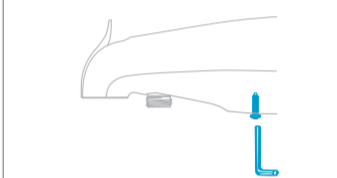

8 Lock the Auto-Diverting Tub Spout in place by tightening the unit's set screw. Apply caulk around the back edge of the tub spout leaving a small gap at the bottom.

SLIP-FIT CONNECTION INSTALLATION

Use Slip-Fit Connection Install if:
• previous tub spout was a slip-fit
• water pipe extends more than 1.25" from wall

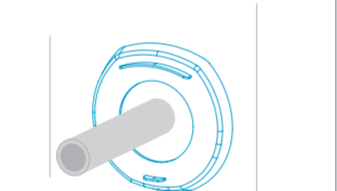
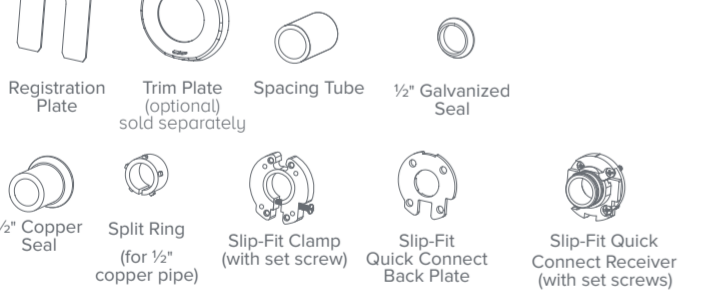
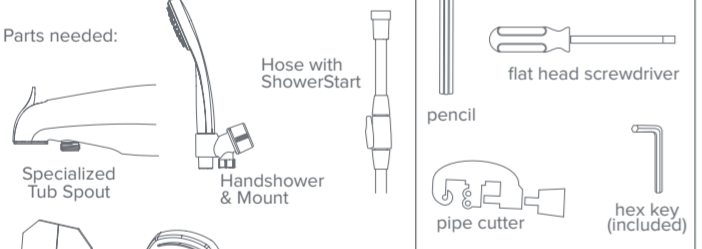

1 (optional Trim Plate - sold separately) The Trim Plate is only needed if the existing hole in the wall would not be fully covered by the back end of the tub spout or the wall is uneven.

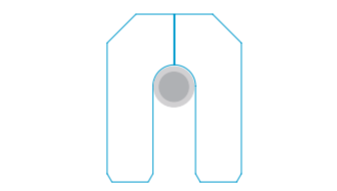

2 Place the Registration Plate against the wall over pipe.

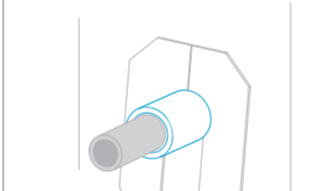

3 Slide the Spacing Tube over the water supply pipe until it touches the Registration Plate.

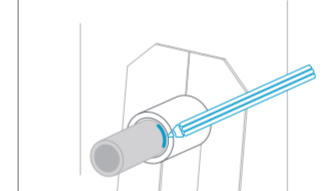

4 Place a mark on the water supply pipe at the end of the Spacing Tube. Remove the Spacing Tube.

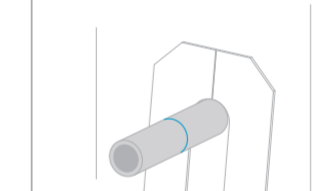

5 Cut the water supply pipe at the mark.

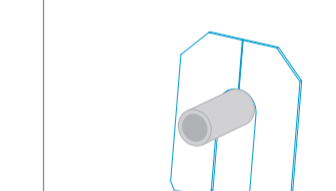

6 Place the Registration Plate against the wall so the water supply pipe fits within its notch. Adjust so its alignment indicator is vertical.

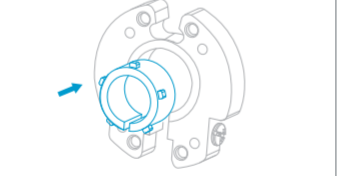

7 For 1/2" copper pipe only: Slide Split-Ring into Slip-Fit Clamp before continuing with next step.

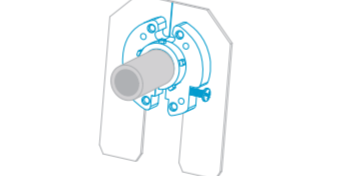

8 Slide the Slip-Fit Clamp over the water supply pipe until it's touching the Registration Plate.

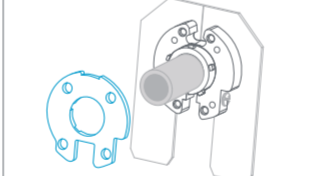

9 Slide the Slip-Fit Quick Connect Back Plate over the water supply pipe until it connects to the Slip-Fit Clamp. It seats via alignment tabs.

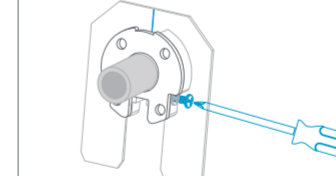

10 Tighten the Slip-Fit Clamp's set screw.

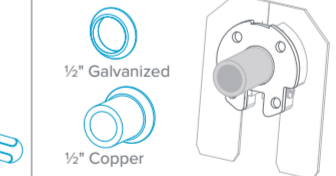

11 Slide the correct Seal over the water supply pipe until it touches the Slip-Fit Quick Connect Back Plate. The small end of either seal should be facing outwards.

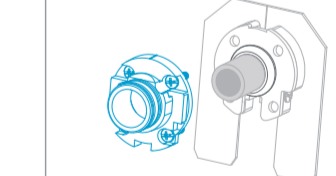

12 Slide the Slip-Fit Quick Connect Receiver over the water supply pipe until it is seated upon the Seal.

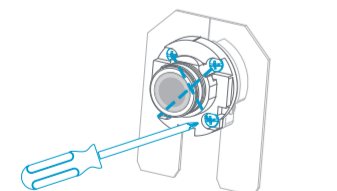

13 Tighten the Slip-Fit Quick Connects Receiver's four front facing screws. Each screw should be tightened a little at a time, working in an "X" pattern until they are fully tightened.

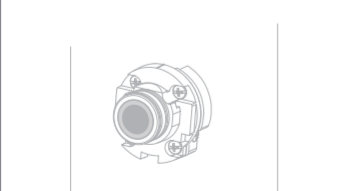

14 Remove the Registration Plate.

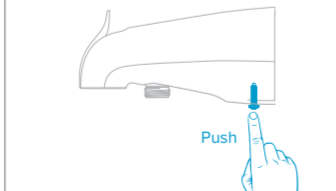

15 Before attaching the Auto-Diverting Tub Spout, press up on the unit's set screw until it can move upwards no further (unscrew first slightly if interfering).

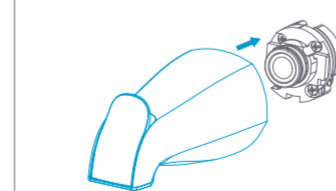

16 Fully seat the Auto-Diverting Tub Spout.

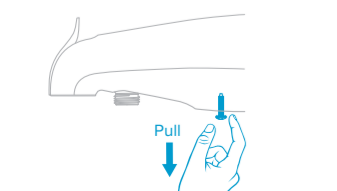

17 Pull the Auto-Diverting Tub Spout's set screw until it slides downward no further. This holds the unit in place.

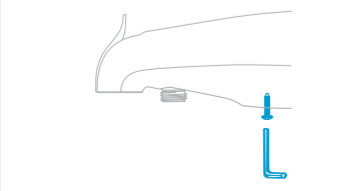

18 Lock the Auto-Diverting Tub Spout in place by tightening the unit's set screw.

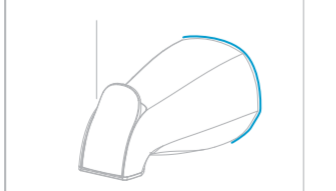

19 Apply caulk around the back edge of the tub spout leaving a small gap at the bottom.

TECHNICAL

Compatibility:

- For use in showers with in wall diverters
- For use in homes with static water pressure of at least 35 psi
- Works with galvanized or copper plumbing
- Tankless systems require a minimum flow rate to produce hot water. With some tankless systems, a brief yet noticeable change in the shower's temperature may occur shortly after resuming the shower's normal flow

Codes / Standards

WaterSense

Conforms to A112.18.1M
1.25 GPM models: For use with automatic compensating valves rated at .9 gpm (3.4 L/min) or less.
1.5 GPM models: For use with automatic compensating valves rated at 1.1 gpm (4.2 L/min) or less.
1.75 GPM models: For use with automatic compensating valves rated at 1.3 gpm (4.9 L/min) or less.

Questions?
Contact us at www.thinkevolve.com/support or call 480-496-2294

WARRANTY

3 Year Limited Lifetime Warranty
For warranty claims please contact us at www.thinkevolve.com or call 480-496-2294

Evolve Technologies warrants this product to be free from defects in materials and workmanship for a period of three years from the date of purchase. This warranty is limited to repairing or replacing, at Evolve Technologies' sole option, any such defective products. To obtain service under warranty you must obtain a Return Material Authorization (RMA) number from an Evolve Technologies representative. The product must be returned with transportation charges prepaid and must be accompanied by a brief description of the problem encountered and proof of date and place of purchase. This warranty does not apply to equipment which has been damaged by accident, negligence, or misapplication or has been altered or modified in any way. This warranty applies to the original purchaser. EXCEPT AS PROVIDED HEREIN, Evolve Technologies MAKES NO WARRANTIES, EXPRESSED OR IMPLIED, INCLUDING WARRANTIES OF MERCHANTABILITY AND FITNESS FOR A PARTICULAR PURPOSE. Some countries do not permit limitation or exclusion of implied warranties; therefore, the aforesaid limitation(s) or exclusion(s) may not apply to the purchaser. EXCEPT AS PROVIDED ABOVE, IN NO EVENT SHALL Evolve Technologies BE LIABLE FOR DIRECT, INDIRECT, SPECIAL, INCIDENTAL, OR CONSEQUENTIAL DAMAGES ARISING OUT OF THE USE OF THIS PRODUCT, EVEN IF ADVISED OF THE POSSIBILITY OF SUCH DAMAGE. Specifically, Evolve Technologies is not liable for any costs, such as lost products or revenue, loss of equipment, loss of use of equipment, costs of substitutes, claims by third parties, or otherwise. This warranty gives you specific legal rights and you may also have other rights which may vary from location to location.

[thinkevolve.com](http://www.thinkevolve.com)

©2019 Evolve Technologies LLC. All rights reserved.
Patent <http://www.thinkevolve.com/patents>
Other U.S. and Foreign Patents Pending.
Designed and developed in USA. Manufactured in China. Rev-31

Sistema de Auto-Desviación de Grifo de Bañera + ShowerStart® TSV³

Para desviador en pared con Regadera de mano EV3746-CPXX-SB

GUÍA

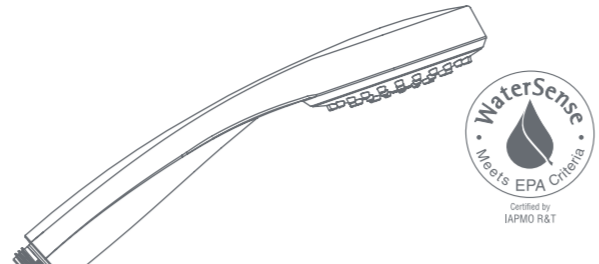

CERTIFIED SUPERIOR PERFORMANCE			
part number	max flow at 80 psi	min flow at 45 psi	
EV3746-CP125	1.25gpm (4.7 L/min)	.9gpm (3.4 L/min)	
EV3746-CP150	1.5gpm (5.7 L/min)	1.1gpm (4.2 L/min)	
EV3746-CP175	1.75gpm (6.6 L/min)	1.3gpm (4.9 L/min)	

INFORMACIÓN DE SEGURIDAD IMPORTANTE:
ShowerStart TSV NO es un dispositivo contra quemaduras.

- Reduzca la temperatura del calentador de agua para prevenir quemaduras. Temperaturas sobre 120° F pueden causar quemaduras severas o incluso la muerte.
- Siempre reanude el flujo de agua y asegúrese de revisar la temperatura del agua antes de entrar a la regadera.
- No está diseñado para uso con calentadores de agua sin tanque.



CÓMO FUNCIONA



1 Gire el flujo de agua a la tina.

Asegúrese de que el flujo de agua siempre esté configurado en la tina, incluso si usas la regadera.

Nota: Si no se ajusta a la tina, saldrá un corriente de agua del monte de la regadera.

2 Abra la llave del agua

Abra la llave del agua caliente de su tina, déjala correr y siga con su rutina mientras espera que salga el agua tibia.

3 Desvío Automatico, comienza a funcionar

Cuando el agua caliente comienza a salir en la llave de la tina, ShowerStart automáticamente desvía el flujo de agua a la regadera y se inicia un goteo, ahorrando así agua caliente, hasta que esté listo para bañarse.

4 Presione el botón cuando este listo de entrar

Presione el gatillo en la manguera para activar el flujo normal y empezar el baño.

Para continuar su baño de tina si lo prefiere, active la salida de agua para la tina como usualmente lo hace.

INSTALACIÓN DE REGADERA



INSTALACIÓN DE CONEXIÓN ENROSCADA

Use la Instalación de Conexión Enroscada si:

- la tubería con rosca sale 5/8" o menos de la pared

Partes necesarias:

- Grifo de bañera
- Regadera manual
- Manguera
- Placa de Registro
- Cinta de teflón
- Base
- 1/2" Recividor de Rosca de Conexión Rápida (con tornillos)
- 3/4" Recividor de Rosca de Conexión Rápida (con tornillos)
- Placa de ajuste (opcional)

Herramientas necesarias:

- llave hexagonal (incluida)

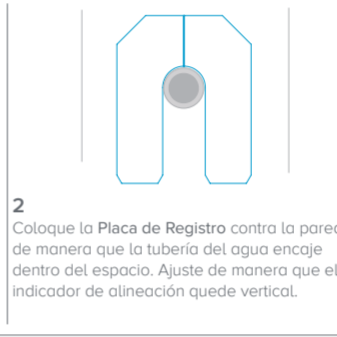

INSTALACIÓN DE CONEXIÓN POR DESLIZAMIENTO

Use la Instalación de Conexión Deslizada si:

- el grifo de bañera tenía una conexión por deslizamiento
- la tubería del agua sale más de 1.25" de la pared

Partes necesarias:

- Grifo de bañera
- Regadera manual
- Base Manguera
- Placa de Registro
- Placa de ajuste (opcional)
- Tubo Espaciador
- Sello de cobre de 1/2"
- Anillo abierto (para tubería de cobre de 1/2")
- Pinza de Deslizamiento (con tornillo fijo)
- Placa Posterior Deslizable de Conexión Rápida
- Recividor Deslizable de Conexión Rápida

Herramientas necesarias:

- Destornillador de estrella
- Destornillador plano
- lápiz
- cortador de tubos
- llave hexagonal (provided)

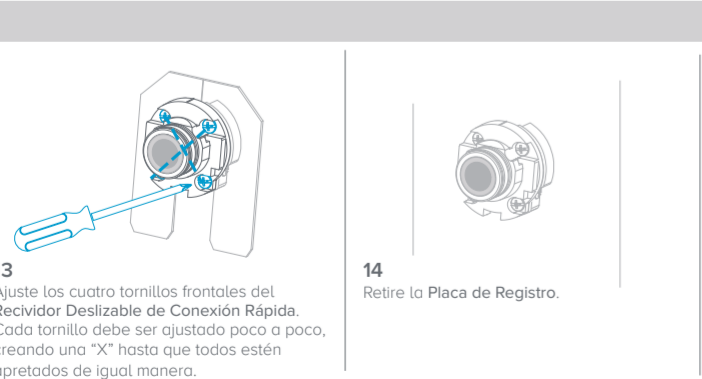
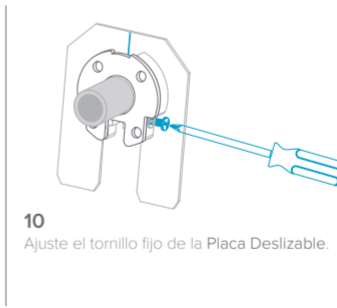
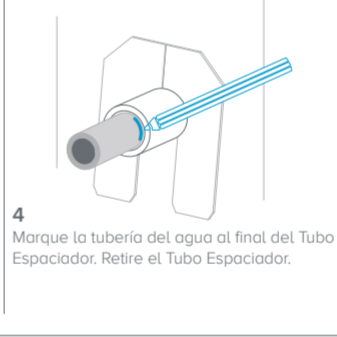
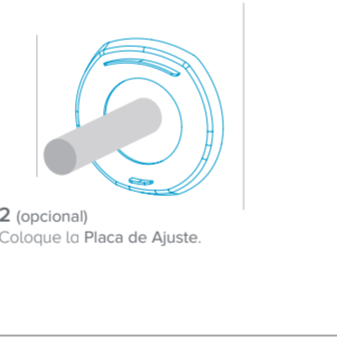

COMPATIBILIDAD & CONSIDERACIONES TÉCNICAS

Compatibilidad:

- Para uso en hogares con presión estática de agua de al menos 35 psi
- Funciona con tuberías de Acero Galvanizado o Cobre
- Sistemas sin tanque requieren un determinado flujo de agua para producir agua caliente. Cambios breves pero notables pueden ocurrir con algunos sistemas sin tanque al reanudar el flujo normal de la regadera.

Reinicio para el siguiente uso:

- El sistema se reinicia automáticamente, volviendo al modo de funcionamiento estándar después de cada uso en regadera o bañera.

ShowerStart TSV:

- ShowerStart TSV no es un dispositivo contra quemaduras.
- Reduzca la temperatura de su calentador de agua a 120° F (49° C)
- Siempre reanude el flujo de agua y asegúrese de revisar la temperatura del agua antes de entrara a la regadera.

Modo de funcionamiento estándar:

- El modo de funcionamiento estándar de este sistema asume que la regadera será utilizada.



CÓDIGOS / ESTÁNDARES

WaterSense

Cumple con A112.18.1M

1.25 GPM: Para su uso con válvulas automáticas compensadoras clasificadas a .9 gpm (3.4 L/min) ó menos.

1.5 GPM: Para su uso con válvulas automáticas compensadoras clasificadas a 1.1 gpm (4.2 L/min) ó menos.

1.75 GPM: Para su uso con válvulas automáticas compensadoras clasificadas a 1.3 gpm (4.9 L/min) ó menos.

GARANTÍA

Garantía de por Vida Limitada de 3 Años
Para reclamaciones de garantía por favor comuníquese con nosotros en www.thinkevolve.com ó llame al 480-496-2294

Evolve Technologies garantiza que este producto está libre de defectos en materiales y mano de obra durante un periodo de tres años de la fecha de compra. Esta garantía está limitada a la reparación o el reemplazo, a la discreción única de Evolve Technologies, de cualquier producto defectuoso. Para obtener servicio bajo garantía usted debe obtener un número de Autorización de Devolución del Material (RMA por sus siglas en inglés) de un representante de Evolve Technologies. El producto debe ser devuelto con los gastos de transporte pre-pagados y debe ser acompañado por una breve descripción del problema encontrado y el comprobante de la fecha y el lugar de compra. Esta garantía no es aplicable al equipo que haya sido dañado por accidente, negligencia, o mala aplicación o que haya sido alterado o modificado de cualquier manera. Esta garantía es aplicable al comprador original. SALVO COMO SE ESTIPULE EN ÉSTA, Evolve Technologies NO OFRECE GARANTÍAS, EXPRESAS O IMPLÍCITAS, INCLUYENDO GARANTÍAS DE COMERCIABILIDAD Y APTITUD PARA UN PROPOSITO EN PARTICULAR. Algunos países no permiten la limitación o exclusión de garantías implícitas; por lo tanto, las limitaciones o exclusiones antes mencionadas pueden no ser aplicables al comprador. SALVO COMO SE ESTIPULA ANTERIORMENTE, EN NINGUN CASO Evolve Technologies DEBERÁ SER RESPONSABLE POR DAÑOS DIRECTOS, INDIRECTOS, ESPECIALES, INCIDENTALES O RESULTANTES QUE SURJAN DEBIDO AL USO DE ESTE PRODUCTO, AUN SI ES ADVERTIDO DE LA POSIBILIDAD DE DICHAOS DAÑOS. Específicamente, Evolve Technologies no es responsable por cualquier costo, tal como productos o ingresos perdidos, pérdida de equipo, pérdida del uso del equipo, costo de sustitutos, reclamaciones de terceros, o de otra forma. Esta garantía le otorga derechos legales específicos y usted también puede tener otros derechos que pueden variar de un lugar a otro.

[thinkevolve.com](http://www.thinkevolve.com)

©2019 Evolve Technologies LLC. Se reservan todos los derechos. Patentes <http://www.thinkevolve.com/patents> Otras patentes pendientes en los E.U.A. y el extranjero. Diseñada y desarrollada en los E.U.A. Fabricada en China. V 31

