



Cigar Punch Kit

Kit Features:

- Multiple Finishes
- Replaceable stainless steel cutter
- Easy to carry and cut cigar tips
- Spring action ejector button easily removes cigar waste
- Spare stainless steel cutter supplied
- Overall length: 3"
- Swivel key ring

Required Accessories:

- 7mm mandrel
- 7MM drill bit
- 7MM barrel trimmer
- Bushing set #419 - Sierra Pen
- 2 part epoxy glue or insta-cure (cyanoacrylate)



DIAGRAM A / PARTS LAYOUT

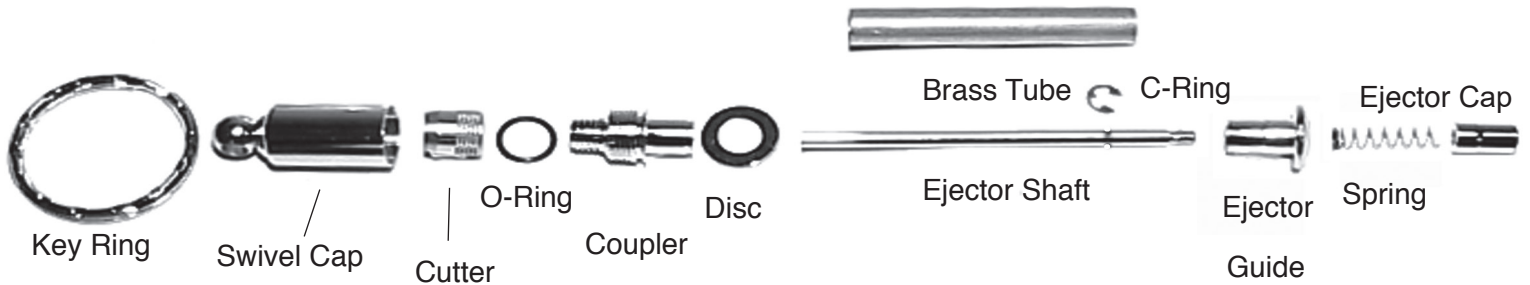
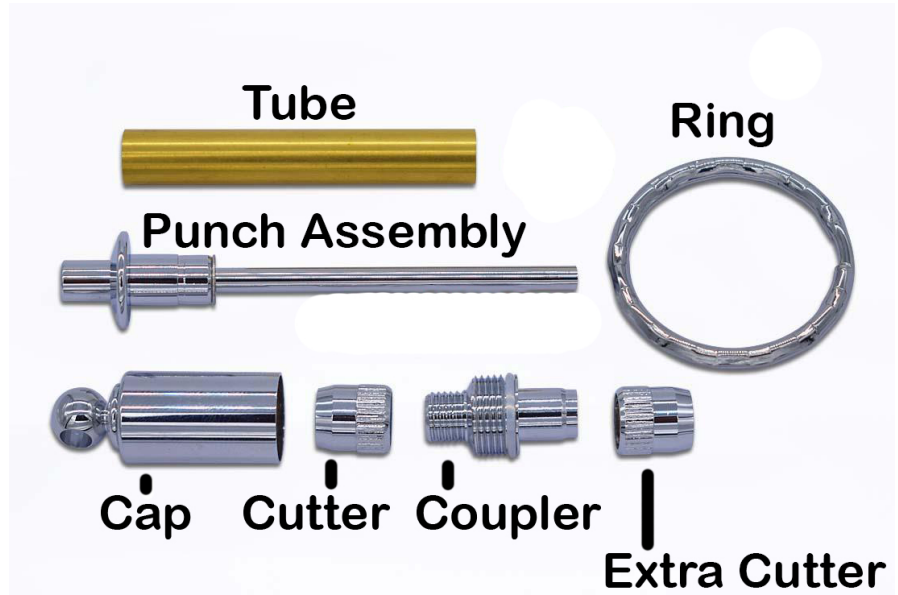

DIAGRAM A-2 / PARTS LAYOUT



Preparing the Blank:

- Cut a 3/4" to 5/8" square blank to the length of the brass tube (add 1/16" for squaring off).
- Drill a 7mm center hole lengthwise through the blank.
- Spread glue over the brass tube. Insert it into the blank with a twisting motion to spread the glue evenly inside.
- Center the tube lengthwise inside the blank.
- When the glue dries, square the ends of the blank. Use a 7mm barrel trimmer or a universal pen blank squaring jig to take the wood down flush square to the brass tube.

DIAGRAM B / TURNING THE BLANK

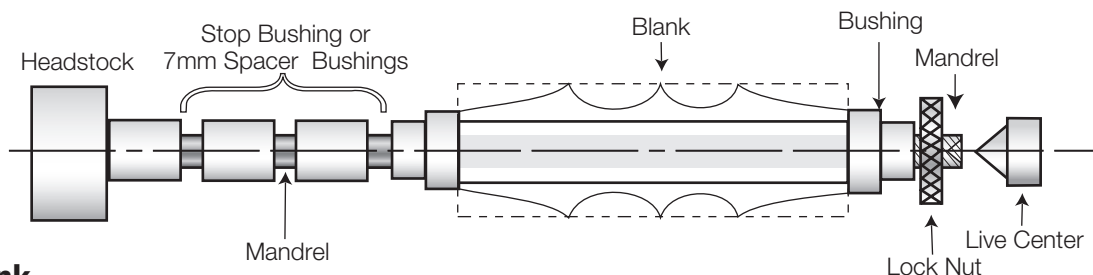

Turning the Blank

- Place 7MM spacer bushings on the mandrel. Then one kit bushing, large diameter facing blank. Then the wood blank, and the other bushing, large diameter facing blank. Use additional bushings to fill up the space on the mandrel. Thread on the knurled lock nut. Engage the tail stock with the live center snug into the mandrel shaft. Lock it in place (Do not over tighten, it may damage the mandrel). Hand tighten the knurled lock nut to secure the blank from spinning on the shaft.
- Turn the blank to the design of your choice. It is not necessary to turn the wood flush to meet the bushings diameter. Be creative and design your own unique cigar punch profile.
- Sand and Finish with product of your choice.

Assembly

- Line up parts according to Diagram 'A-1'.
- Press the Cutter (Cutter Screwed onto the Coupler) Assembly into the Bottom end of the barrel.
- Unscrew Ejector Cap. Be sure and retain Ejector spring (under the cap) and remove Ejector Shaft.
- Now Press in just the Ejector Guide.
- Re-assemble the Punch Assembly. (Put the Ejector shaft in through the open bottom of the tube and allow threaded portion to Protrude past the Ejector Guide. You may find it necessary to unscrew the cutter and use a small rod to keep the ejector shaft pushed through the Ejector Guide. Place the Spring over the threaded end of the Ejector Shaft and screw on the Ejector Cap.
- Now you can break out your favorite stick, punch it and light it up and enjoy.

Diagram C / Bushings #419

