



INSTALLATION INSTRUCTIONS EVANNEX PERFORMANCE PEDAL COVERS FOR MODEL S, MODEL X, AND MODEL 3

Please read these installation instructions **BEFORE** you install the EVANNEX® Performance Pedal Covers.

Installation of EVANNEX Performance Pedal Covers is a relatively straightforward DIY project. However, if you're uncomfortable with the installation for any reason, we recommend that you contact a professional installer and have them do the installation for you.

Video installation instructions are available at evannex.com.

Step 1. Slide the rubber grommet on the back of the EVANNEX accelerator pedal cover over the OEM accelerator pedal. Begin at the bottom of the OEM pedal and slide the edge into the slot at the top of the EVANNEX pedal cover. Be sure that the rubber edges of the pedal cover slide over the OEM pedal base so that the pedal cover is firmly attached to the pedal base. See Photos #1 and #2 for details.

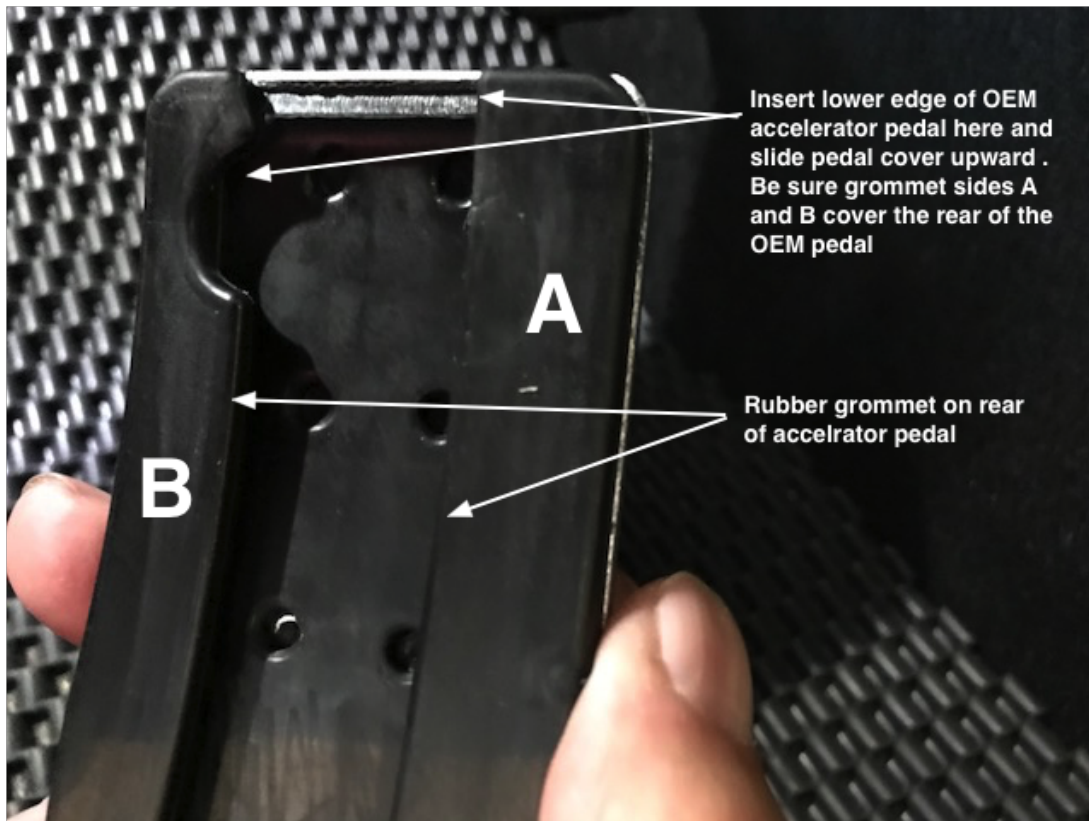

Photo #1 Rear of EVANNEX Accelerator Pedal Cover

EVannex® — Tesla Aftermarket Accessories
Deerfield Beach, FL •• evannex.com

Disclaimer: Evannex is not responsible for any vehicle damage caused during the installation or use of this product. Any costs associated with any vehicle damage are the sole responsibility of the purchaser.



Photo # 2. Slide pedal cover upward with grommet covering the OEM pedal

WARNING: Be certain that the accelerator pedal cover grommet on the back of the EVANNEX pedal cover is positioned so that it covers the edges of the OEM accelerator pedal base on all sides. Use your fingers to “feel” that the grommet covers the base. If the pedal cover is improperly attached, it can detach, and cause a driving hazard.

Step 2. Remove the OEM brake pedal cover. To do this, use your fingers to pry the rubber grommet at the back of the OEM cover upward on all sides until it loosens and detaches. Once the OEM brake pedal cover is removed, the brake pedal base should be visible as shown in Photo #3.



Photo # 3 Remove OEM Brake Pedal cover to expose base



STEP 3. Slide the rubber grommet on the back of the EVANNEX brake pedal cover over the OEM brake pedal base. Begin at the top of the OEM pedal and slide the edge into the slot at the top of the EVANNEX pedal cover, using your fingers to pry back the rubber grommet. Be sure that the rubber edges of the pedal cover slide over the OEM brake pedal base so that the pedal cover is firmly attached to the pedal base. See Photos #4 and #5 for details.

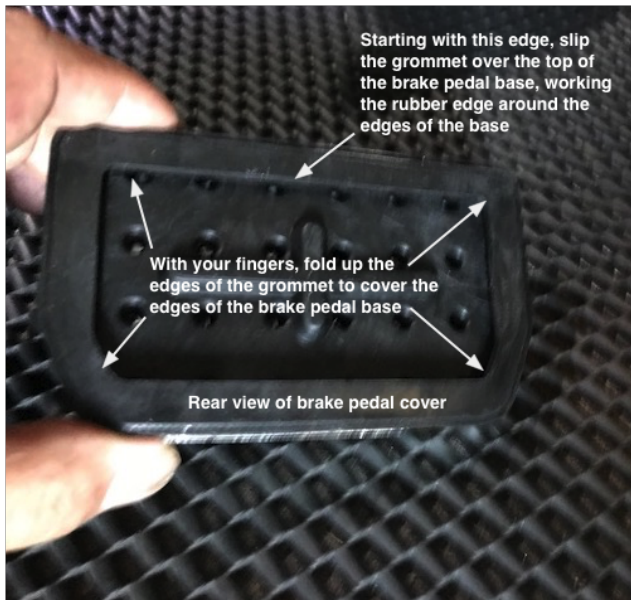

Photo # 4 Rear of brake pedal cover



Photo # 5 Applying Brake pedal cover

WARNING: Be certain that the brake pedal cover grommet on the back of the EVANNEX brake pedal cover is positioned so that it covers the edges of the OEM braker pedal base on all sides. Use your fingers to “feel” that the grommet covers the base. If the pedal cover is improperly attached, it can detach, and cause a driving hazard.

Your installation is now complete.

EVannex® — Tesla Aftermarket Accessories
Deerfield Beach, FL •• evannex.com

Disclaimer: Evannex is not responsible for any vehicle damage caused during the installation or use of this product. Any costs associated with any vehicle damage are the sole responsibility of the purchaser.