

CALIPER COVERS

INSTALLATION INSTRUCTIONS

For

Model 3 & Model Y

Hardware Included:

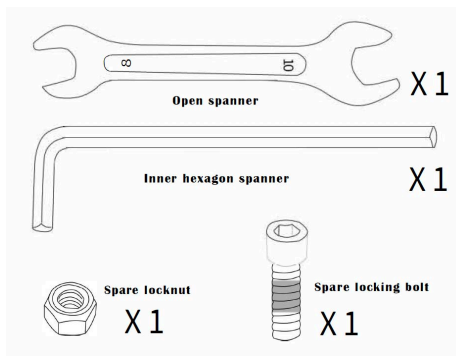

Note: Nuts and bolts installation will require some force to be fastened because of the anti-loosen fastener design.

- Four Caliper Covers

Two Front Wheels Caliper Covers

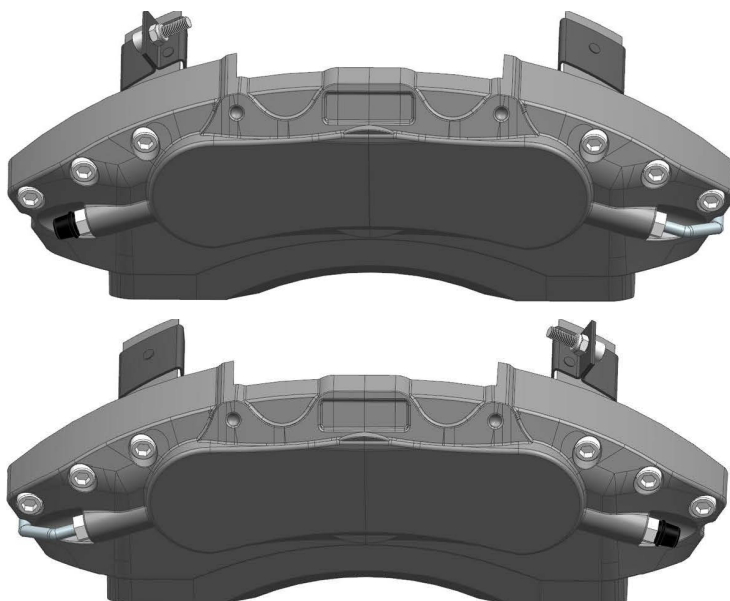

Two Rear Wheels Caliper Covers

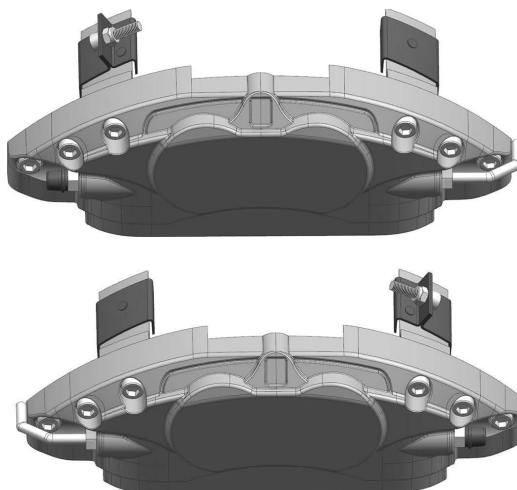

Note: The front wheel caliper covers are larger than the rear wheel caliper covers.

Installation:

Step 1. Identify the appropriate caliper cover to be installed, according to the area being worked on (two sets for the front wheels and 2 smaller sets for rear wheels). Once you are sure you have the correct calipers covers you can position them correctly.

IMPORTANT : The installation approach described below is applicable to both front and rear caliper covers (i.e., the fastening approach is identical).

Step 2. All caliper covers must be positioned with rubber cap on the upper end of the caliper and the tubing on the lower end of the caliper as shown in graphic.

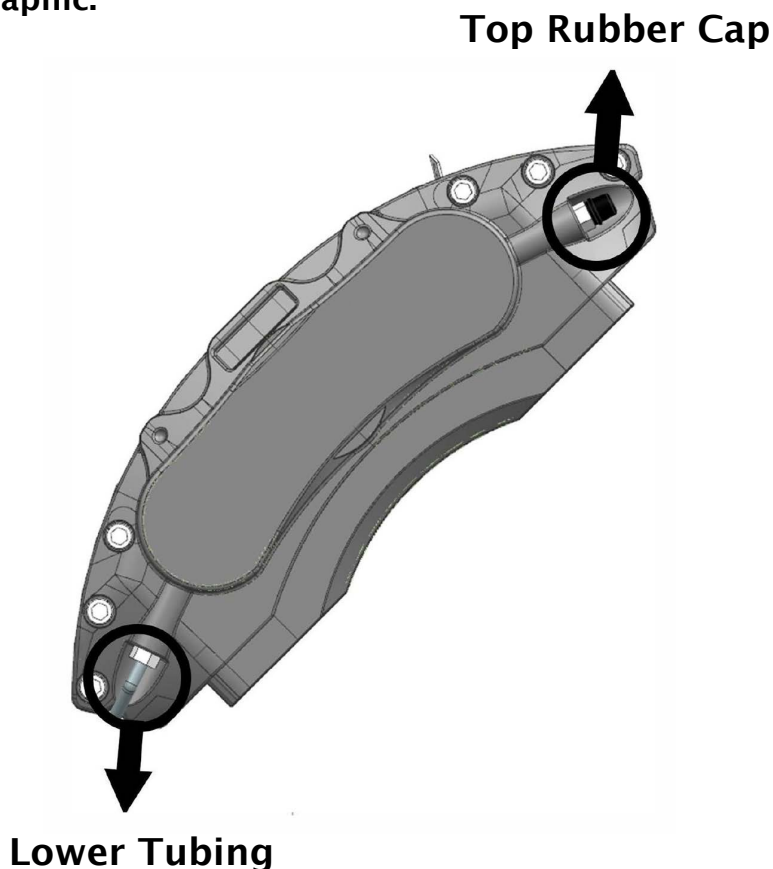

Step 3. Locate the gap between the brake disc and the caliper bracket.

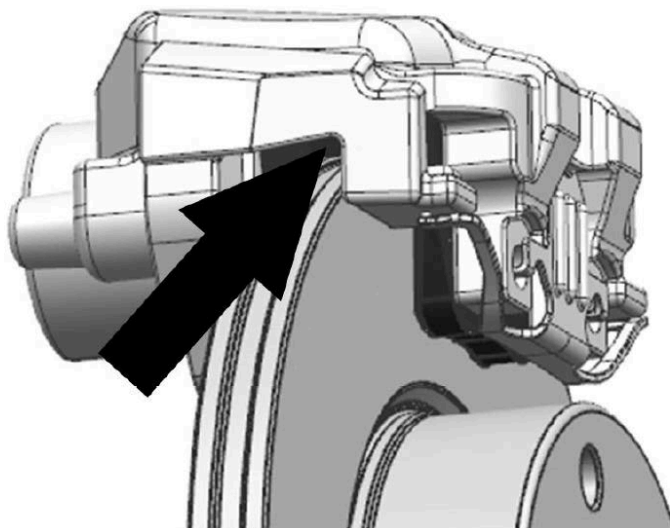

Step 4. Use the fixed buckle on the caliper covers to hook to the caliper bracket. Push buckle toward the center until it's flush with the caliper bracket side wall.

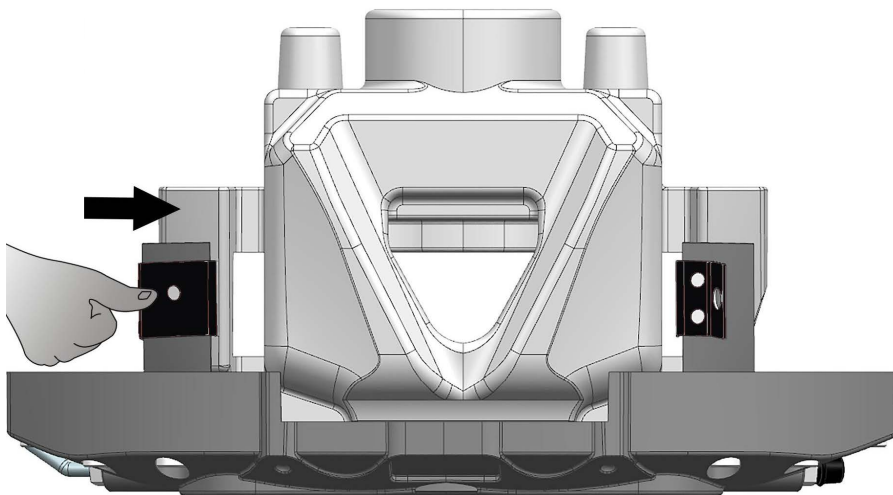
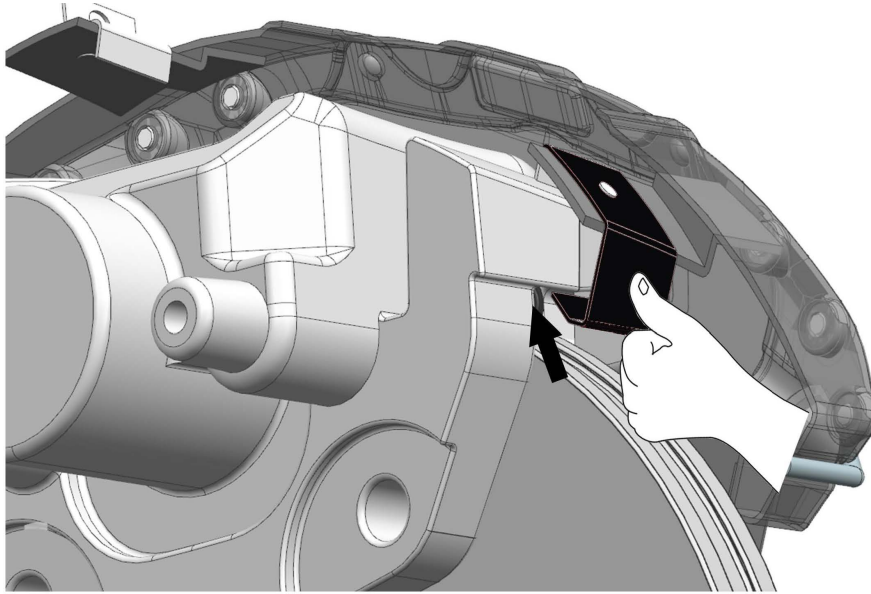

Note: Make sure bracket is even on both sides and align caliper cover center with the caliper center.

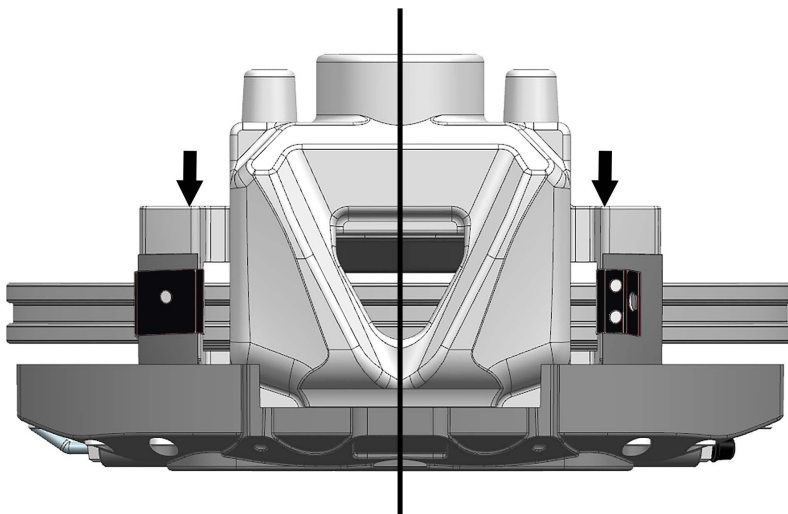

EVANNEX Tesla Aftermarket Accessories •• evannex.com

Disclaimer: Evannex is not responsible for any vehicle damage caused during the installation or use of this product. Any costs associated with any vehicle damage are the sole responsibility of the purchaser.

Step 5. Move on to second buckle. Locate gap between the caliper and the disc brake. Insert the adjustable buckle and push buckle towards the center until the bolt holes are flush and align.

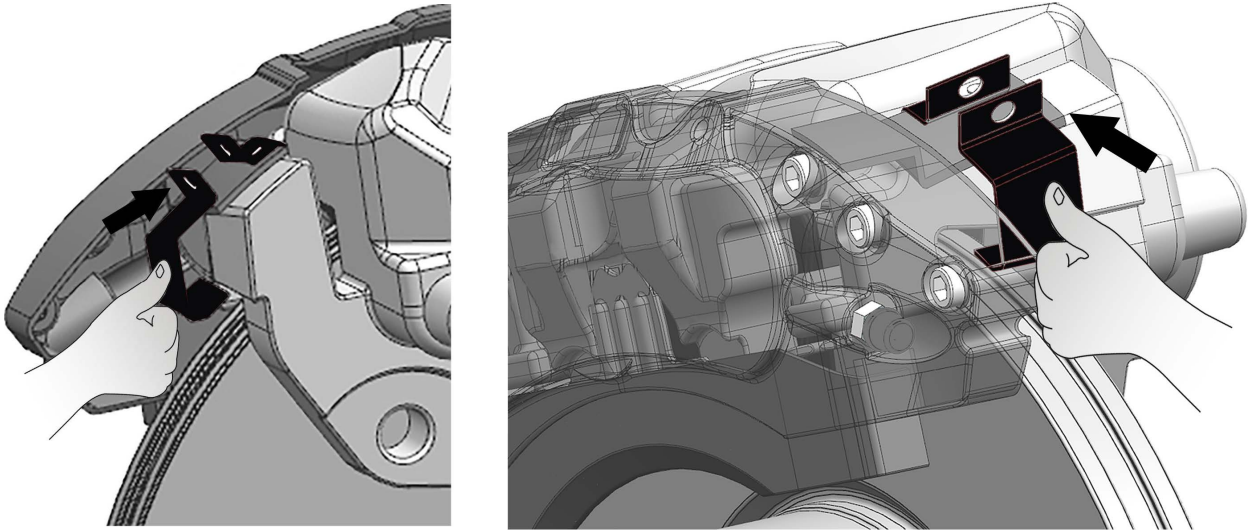

Step 6. Thread the hexagon bolt through the buckle hole. Then, attach the provided nut to fasten buckle.

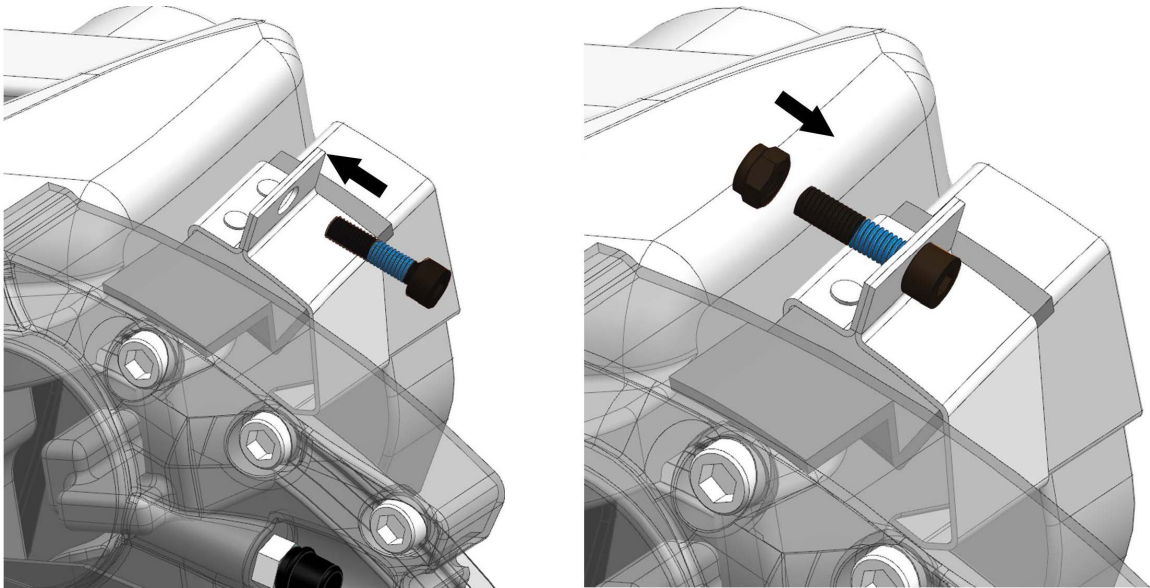

Step 7. Tighten the bolt and the nut with the provided tools. Make sure to apply enough force to secure them in place.

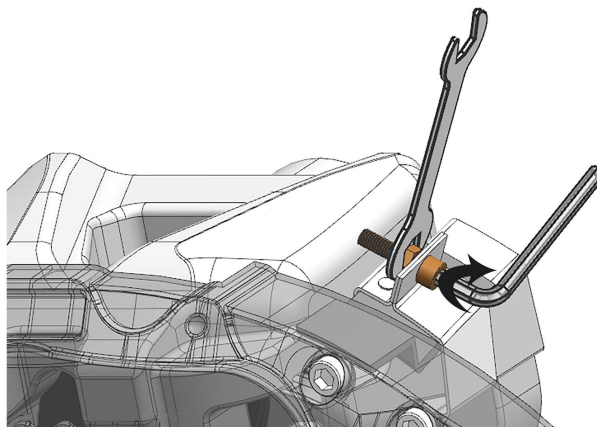

Step 8. Before finishing installation, verify that the brake disc protective cover behind break disc doesn't affect the installation of the buckle. If it does affect installation you can use a flat head screw driver to pry it to the side. You can restore it back in place after buckle is installed.

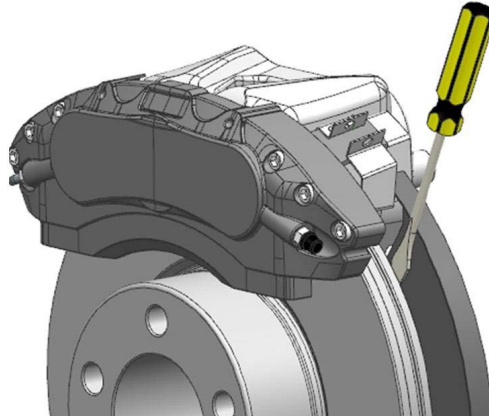

Step 9. Next, test the installation.

Place tire back in place. Install 2 lug nuts by hand and see if the wheel interferes with caliper cover when rotated. There shouldn't be any metal friction noises.

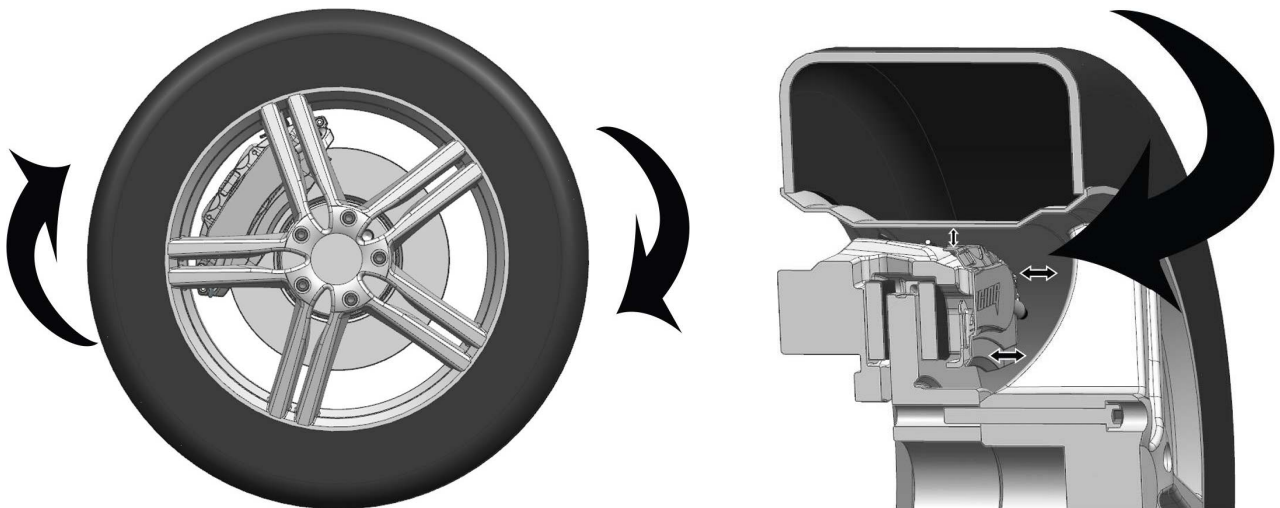

After confirming that there is no problem. Install remaining lug nuts. Jack down vehicle and complete securing lug nuts with the appropriate tool.

Drive the car at a low speed and check for any interference or rubbing. There should be no scraping sound. Once you're certain there is no interference, installation is completed.

