

Corsica Product Guide

Evita Sinks

CORSICA
CUSTOM COUNTERTOPS

CABINETS WOW
TO GO FOR
LESS.

Washbasin Installation Manual

Before installing the washbasin, make sure the pack includes: the drain valve and the support bars for the wall installation (in case of washbasins with a skirt).

If you have any questions about the installation of the washbasin, please contact Cabinets to Go.



Wall-Hung Installation

1. On-site placement verification

The most usual height for the washbasin installation, ranges from 80 to 90 cm [32" to 36"], depending on the user and country standards. Verify the outer dimensions of the washbasin and mark them on the wall. Draw also a horizontal line at the desired height level.

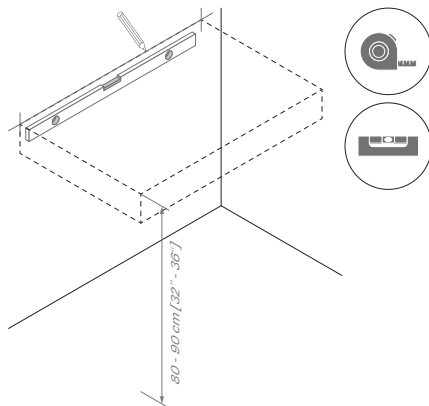

2. Support bars installation

Each support bar has an anchoring plate prepared for four fixings. Verify the installation system based on the vertical wall. If necessary, reinforce the wall with beams/wood blocks.

The installation of the first support bar has to take as reference the upper right corner of the anchoring plate.

This must be placed in the vertical line at 1.2 to 2 cm below the washbasin desired height, depending on the material thickness.

In the horizontal line, if the distance between the sink and the end of the top is the recommended minimum of 12 cm [4 5/7"], place that corner at 2 cm [1"] from the exterior right skirt. If the distance is larger, it can be placed at 4 or 5 cm [1 1/2" or 2"]. Once the support bars are placed, mark the holes of the anchoring plate, drill the wall and fix the bars with the chosen installation system. Ensure that the supports are perfectly levelled.

3. Check before washbasin installation

The support bars must be placed on both sides of the washbasin as per Step 2. Cabinets to Go recommends a maximum distance of 120 + 5 cm [48" + 2"] between them. The support bar has been tested with a weight of 150 Kg [330 lb].

If the countertop has a double basin, it will be necessary to install a third support bar in the very middle, so the weight is perfectly distributed.

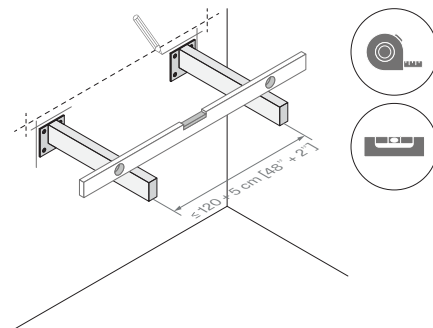

4. Washbasin installation

NOTE: The faucet and drain valve can be installed before or after the washbasin, whichever is easier.

- a. Before placing the washbasin, apply anti-mould silicone on the upper side of the support bars and the back edge of the countertop. A minimum joint of 3 mm between the washbasin and the wall should be left.

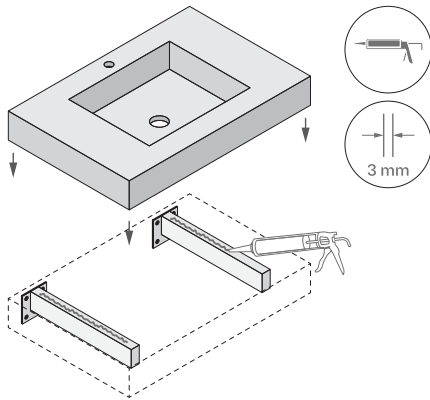

- b. Immediately afterwards, place the washbasin on top of the support bars, making sure that the washbasin is centred and levelled.

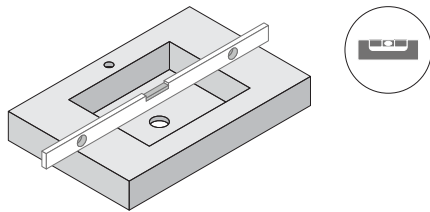

- c. Clean the joint between the washbasin and the wall with a degreasing agent such as alcohol, acetone or other suitable agent. Clean the rest of the washbasin surface.

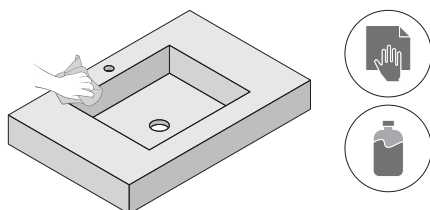

- d. Seal the joint between the washbasin and the wall with anti-mould silicone. Smooth the silicone bead and let it dry for at least 24 hours.

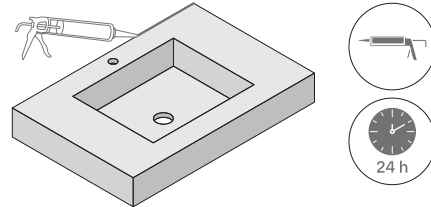

Once the installation has been completed, connect the faucet supply hoses to the wall stopcocks and the valve to the drain pipe.

5. Additional works (Optional)

If the model includes a waterfall edge, on the previous step, apply also anti-mould silicone on the upper edge of it and then place the washbasin on top. The waterfall edge must not support the weight of the washbasin. It is simply an aesthetic feature.

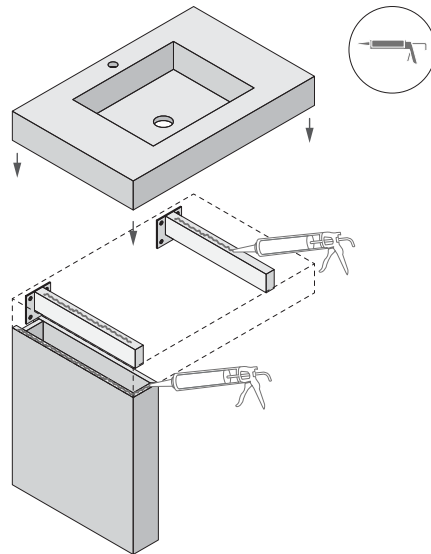

Installation on a Bathroom Cabinet

1. Washbasin installation

NOTE: The faucet and drain valve can be installed before or after the washbasin, whichever is easier.

- a. Before placing the washbasin, apply anti-mould silicone on the upper side of the bathroom cabinet. A minimum joint of 3 mm between the washbasin and the wall should be left.

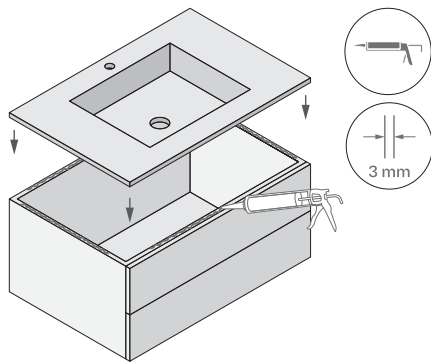

- b. Immediately afterwards, place the washbasin on top of the bathroom cabinet, making sure that the washbasin is centred and levelled.

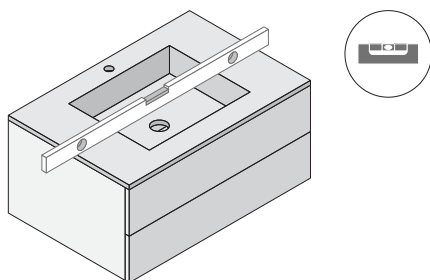

- c. Clean the joint between the washbasin and the wall with a degreasing agent such as alcohol, acetone or other suitable agent. Clean the rest of the washbasin surface.

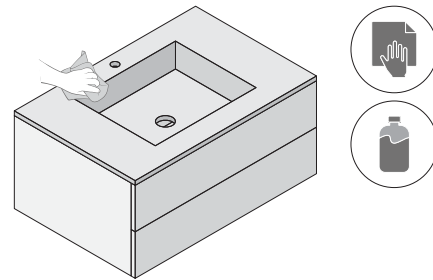

- d. Seal the joint between the washbasin and the wall with anti-mould silicone. Smooth the silicone bead and let it dry for at least 24 hours.

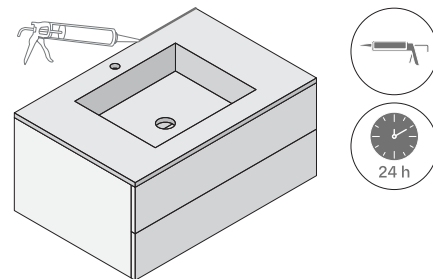

Once the installation has been completed, connect the faucet supply hoses to the wall stopcocks and the valve to the drain pipe.

Annex: Recommendations for the Arrangement of the Support Bars

The following are recommendations for the arrangement of support bars in some of the most common washbasin cases:

- $L < 120 \text{ cm}$ [48"] (Single Basin): 2 Support Bars

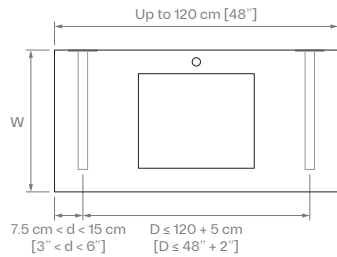

d: Distance between the side of the washbasin and the axis of the support bar.

D: Maximum distance allowed between the axis of two support bars.

W: Washbasin width.

- 120 cm [48"] $< L < 320 \text{ cm}$ [126"] (Single Basin):
3 or More Support Bars (depending on the distribution)

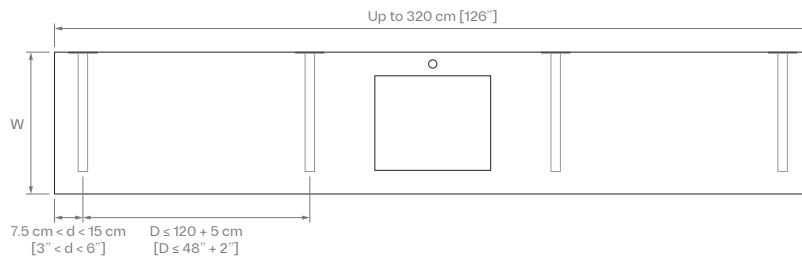

- 120 cm [48"] $< L < 320 \text{ cm}$ [126"] (Double Basin):
3 or More Support Bars (depending on the distribution)

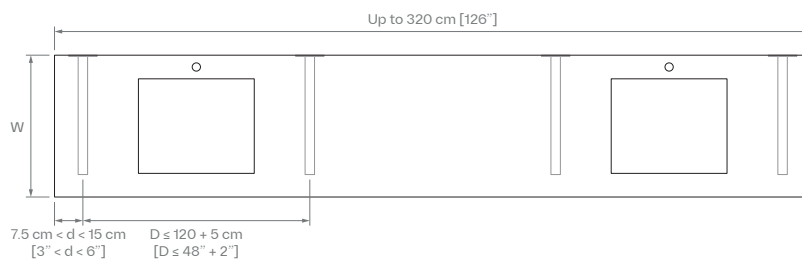

General Advice for Use, Maintenance, and Cleaning

Regular Cleaning and Maintenance

Due to their low porosity, Corsica Quartz and Corsica Premiere Ultra Compact are surfaces that are highly resistant to common household stains.

For cleaning Corsica Quartz and Corsica Premiere Ultra Compact surfaces, Cabinets to Go recommends the use of Q-Action®.

If the above product (or similar) is not available, use water and neutral soap.

Cleaning Stubborn Stains

For stubborn stains, pour Q-Action® (or similar) over the affected area and leave for 2 minutes. Then rub gently with a non-abrasive scouring pad (e.g. Scotch-Brite), rinse with plenty of water and dry the area.

For stubborn stains which have been there for a long time, here are some of our recommendations:

Grease Stains (Traces of Cosmetics Products)

Apply Q-Action® (or a similar product) to the stain and rub gently with a non-abrasive scouring pad (e.g. Scotch-Brite) until the stain is removed. Then rinse with plenty of water and dry the area.

Limescale Stains (Hard Water and Other Liquid Deposits)

Pour an anti-limescale product (like Viakal or similar), according to the manufacturer's instructions, onto the surface and leave

for 1 minute. Then rinse with plenty of water and dry. Do not use an anti-limescale product on the other components such as the sink, the valve, the faucet, etc., as this may damage their finish.

Silicone or Putty Stains

Use a scraper and a solvent (which does not contain dichloromethane) and rub gently with a non-abrasive scouring pad (e.g. Scotch-Brite). Then rinse with plenty of water and dry.

We recommend that stains are removed at the time of installation.

Cleaning Textured Surfaces (Suede) and Non-Slip Shower Finishes

For the regular cleaning of these surfaces in unpolished textures, Cabinets to Go recommends using Q-Action® (or similar) or neutral soap. For stubborn stains, use a non-abrasive scouring pad without pressing too hard on the affected area.

For stubborn stains with Corsica Premiere Ultra Compact Grip/Grip+, you can use a soft bristle toothbrush for those stains that are harder to remove. As they are rougher, these textures are more susceptible to staining. This also applies to the sandblasted areas of Corsica Quartz surfaces which, although they have a protective treatment which helps prevent dirt from accumulating on them, are areas which require more maintenance.

For further information on the cleaning and maintenance of Corsica Premiere Ultra Compact Grip/Grip+ surfaces, please refer to the manual for this material finish.

Cleaning Corsica Premiere Ultra Compact XGloss Surfaces (Ultra-Polished)

Due to its ultra-shiny surface, it is recommended to use Q-Action (or a similar product) with a sponge or microfibre cloth, rinse with clean water and then wipe with a dry microfibre cloth.

For dark colours, remove the soap with a damp sponge and dry with a paper towel or clean cotton cloth.

Check the availability of Corsica Premiere Ultra Compact XGloss for the bathroom collection.

Resistance to Knocks

Corsica Quartz and Corsica Premiere Ultra Compact surfaces are resistant to impacts from normal use. However, avoid dropping dense objects (e.g. perfume bottle) on the surface and avoid hitting the edges.

Heat Resistance of Corsica Quartz Surfaces

After using tools that are subjected to intense heat, such as hair straighteners, curling irons, etc., do not leave them directly on the surface. Leave them on a heat-resistant mat (made of silicone if possible) to cool down.

The thermal shock caused by the temperature difference (hot/cold) could damage the surface.

Heat Resistance of Corsica Premiere Ultra Compact Surfaces

Corsica Premiere Ultra Compact is designed to withstand the high temperatures of household objects. Hair straighteners, curling irons, flat irons, etc., which generate heat can be placed directly on the surface, during and after use.

Corsica Quartz Precautions

- Do not place outdoors or in places exposed to direct UV radiation.
- Do not place hot objects, such as hair straighteners, curling irons, etc., directly on the surface.

Always use a heat-resistant mat.

- Do not use water repellents, sealants, polishes, etc.
- Do not polish the surface.
- Do not use paint strippers, caustic soda or products with a PH greater than 10. If you use bleach or solvent, rinse immediately with plenty of water and avoid prolonged contact. Avoid all chlorine-based products and any contact with hydrofluoric acid.
- Do not use degreasing agents with a high mineral content or abrasive cleaning agents for the thorough cleaning of surfaces and joints.
- Avoid using metal scouring pads. The use of such products may void the product warranty.
- Examples of products that should not be used on Corsica Quartz surfaces: paint strippers, brush or metal cleaning products, aggressive cleaning agents, methylene chloride cleaning products, acids for unblocking drains or nail polish removers with acetone, among others.

If any of these products are ever spilled onto the surface, remove them as soon as possible with plenty of water and neutral soap.

Corsica Premiere Ultra Compact Precautions

- Do not polish the surface.
- Avoid high temperatures from direct sources such as fireplaces, barbecues, etc.
- Avoid using metal scouring pads or those with abrasive particles.
- For Corsica Premiere Ultra Compact XGloss, avoid cutting directly on the surface.
- As for the dark colors from the XGloss collections, try not to drag or drop accessories or other objects on the surface.
- Avoid direct contact with a naked flame.

Stain Resistance of Corsica Quartz Surfaces

Overall, Corsica Quartz has an excellent performance with the most commonly used products in the bathroom.

Below are examples of products that could affect these surfaces:

Laundry bleaches	Unaffected
Shower gel	Unaffected
Active powder (toilet disinfectant)	Unaffected
Hot wax (hair removal)	Unaffected
Bleach-based bathroom cleaner	Slightly affected
Make-up	Unaffected
Body hair bleaching cream	Slightly affected
Body moisturiser	Unaffected
Hydrogen peroxide	Unaffected
Shaving foam	Unaffected
Contact lens solution	Unaffected
Keratin-based hair product	Unaffected
Body deodorant spray	Unaffected
Aftershave lotion	Unaffected
Whitening mouthwash	Unaffected
Hair styling gel	Unaffected
Shampoo	Unaffected
Lipstick	Unaffected
Mascara	Unaffected
Lip liner	Unaffected

Particular attention should be paid to corrosive and caustic products which could affect Corsica Quartz surfaces due to their aggressiveness.

These include dark hair dyes, strongly aggressive bathroom cleaning products, dark shoe creams, depilatory creams, perfumes, exfoliating gels or nail varnishes.

Stain Resistance of Corsica Premiere Ultra Compact Surfaces

One of the features of the material is its high stain resistance.

The ultra-compaction and the virtually zero porosity ensure that all stains, even the most stubborn ones, remain on the surface.

Thanks to the exceptional chemical resistance of the material, as a result of the sintering process, stains can be removed effortlessly with the right cleaning agent, without the need for stainless steel scouring pads, keeping the material unaltered.

The ultra-polished Corsica Premiere Ultra Compact XGloss surface features the 'Nanocoating Process', which produces a stain-repellent effect, making it even easier to clean.

Cabinets to Go Warranty

Kitchen Sinks | Washbasins | Bathroom Countertops

Transferable Warranty for End Products Manufactured by Cabinets to Go

Cabinets to Go guarantees the registered end user its end products* manufactured with Corsica Quartz or Corsica Premiere Ultra Compact for three-dimensional applications (such as sinks, modular kitchen worktops, washbasins, bathroom countertops, shower trays and modular worktops) against manufacturing defects for a period of FIVE (5) YEARS from the date of purchase. All this under the terms, conditions and limitations described for the rest of Corsica Quartz or Corsica Premiere Ultra Compact products in their *Letter of Warranty*, available on the website.

This Warranty is only valid when the end products have been correctly installed (in accordance with the applicable regulations and the *Specific assembly instructions*), and have been used correctly according to their intended application (as described in the *Use, care and maintenance guide*). End products which have been altered or have undergone post-manufacturing operations, which are not covered under or do not follow the recommendations described in the installation mortises, etc.), are excluded from this Warranty.

This *Letter of Warranty* shall only be fully valid when the end user has registered the product within 6 months of the purchase of the product and when the end user submits the original invoice or purchase receipt (indicating the date of purchase and the name of the dealer of the product). The end user shall return the defective product to Cabinets to Go.

The 5-year warranty period set out in this *Letter of Warranty* for three-dimensional end products only applies to products that are purchased and registered after 1st November 2018.

Cabinets to Go reserves the right not to offer the warranty service free of charge if the requirements set out in this Warranty are not met, or if the information provided by the end user is false, incomplete or illegible. registered online on the Cosentino® website.

Go to <http://warranty.cosentino.com> and follow the steps to register your Warranty depending on where you purchased the product or, if provided, by using the corresponding activation code found on the packaging and/or on the product.

(* Related products and other installation costs (silicone, faucets, valves, labours, etc.) are not covered under this Warranty.