



Use Zone: 44' x 65'



Age Group: 2-12



Occupancy: 48-52



Free Shipping!

COMPONENTS: Wave Slide / Rock Wall Climber / Circle Climber / Angel Overhead Ladder / Transfer Station / Drum Panel / Spin Panel / Single Straight Slide / Honeycomb Climber / Gear Panel / Paddel Ball Panel / Twist Climber / Hopscotch Climber / Curly Climber / Spiral Slide / Single Sectional Right Turn Slide





Compliance:
 This play structure has been designed to meet the safety requirements established in:
 - 2010 ADA Standard
 - ASTM F1487
 - CPSC Pub #325
 when the play structure is installed over a properly maintained surfacing material which is in compliance with:
 - ASTM F1292
 - ASTM F1951
 and is appropriate for the highest designated play surface of the structure.

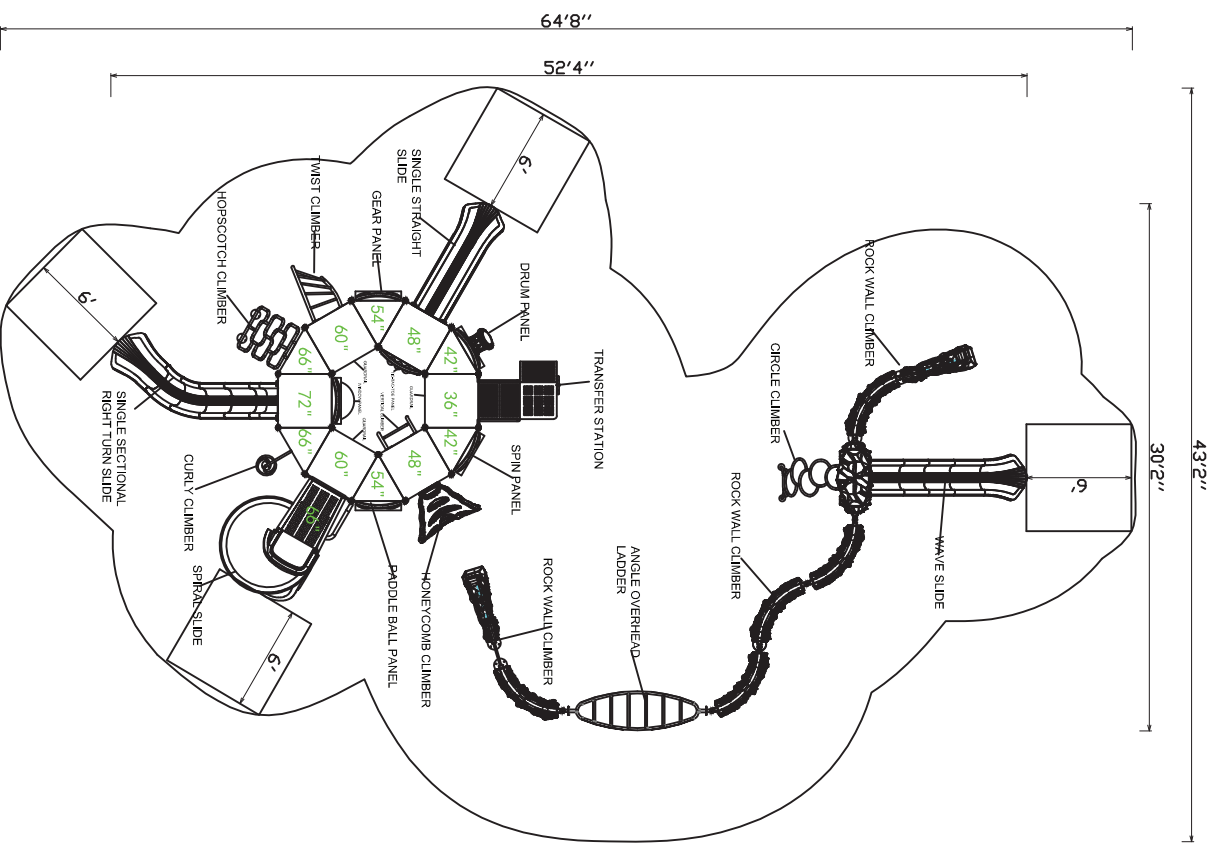

Buena Vista A

Drawing No: KP-32803

Date: 27/03/2020

Scale: To Fit

Structure Size: 30'-2" X 52'-4" X 10'-1"

Recommended

Use Zone: 43'-2" X 64'-8"

Surface Area: 2860 Sq Ft

HDPS: 84'

Age Group: 2-12

Capacity: 48-52

**Creative
 Recreational
 Systems**