



Use Zone: 39' x 36'



Age Group: 2-12



Occupancy: 34-38



Free Shipping!

**COMPONENTS:** Inclined Arch Bridge / Transfer Station / D-Shape Challenge Ladder / Hopscotch Climber / Ships Wheel / Talk Tube / Wave Slide / Leg Left / Sail Pe Climber / Arch Bridge / Vertical Climber / Spiral Step Climber / Single Drum / Spiral Slide / Single Right Turn Slide / Dual Drum Panel Below / Talk Tube / Twist Climber / Curly Climber / Inclined Crawl Tunnel



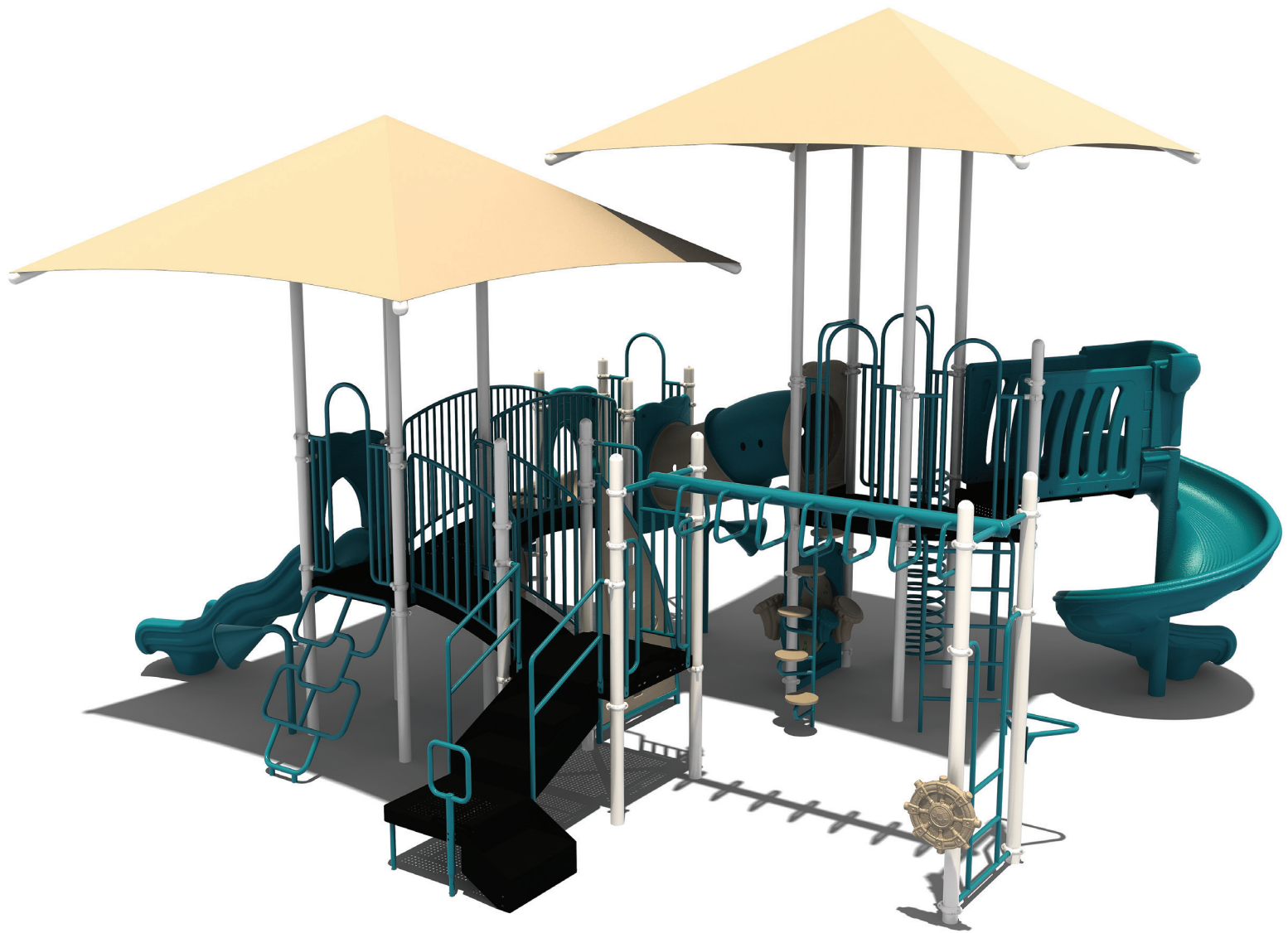





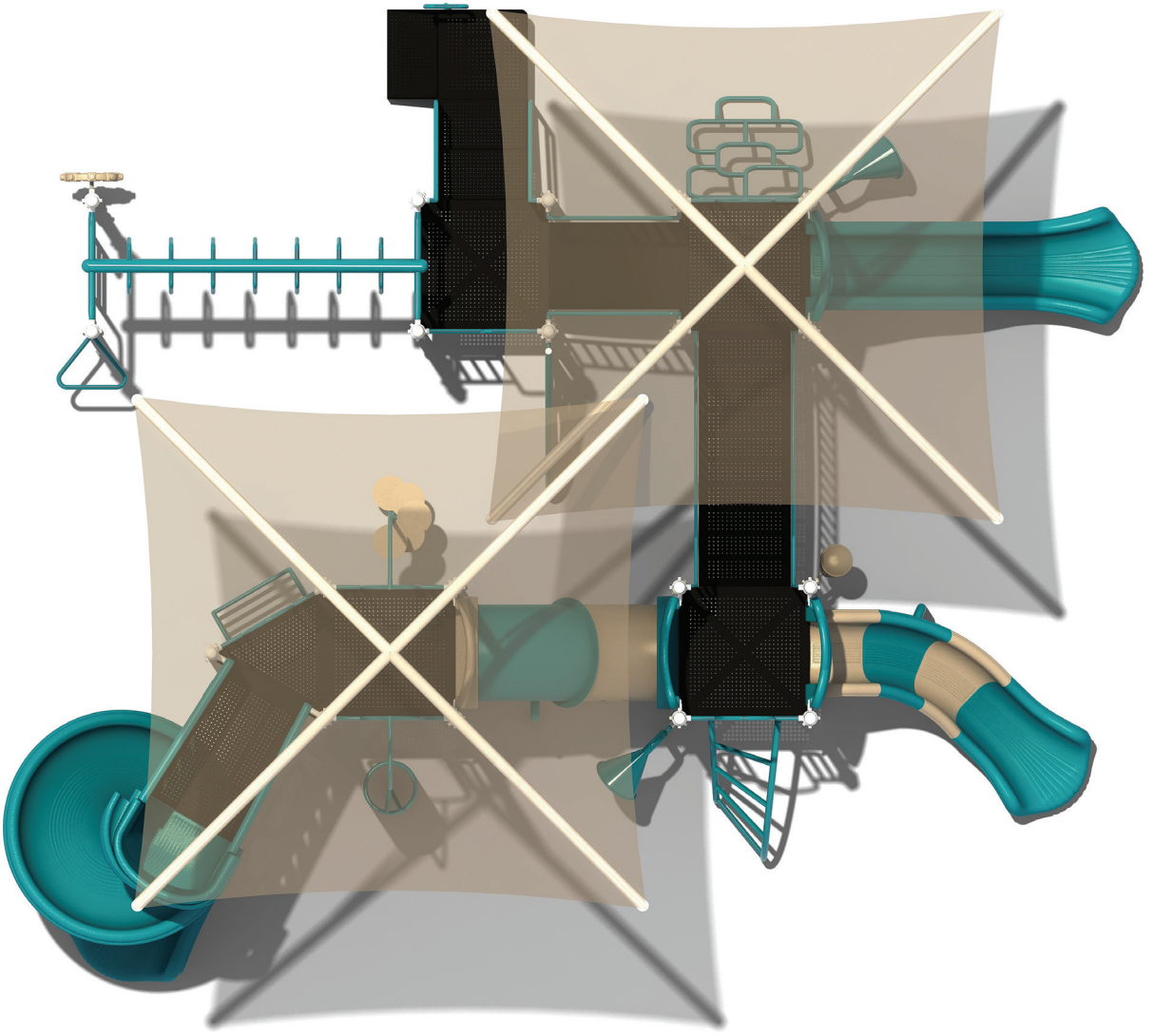

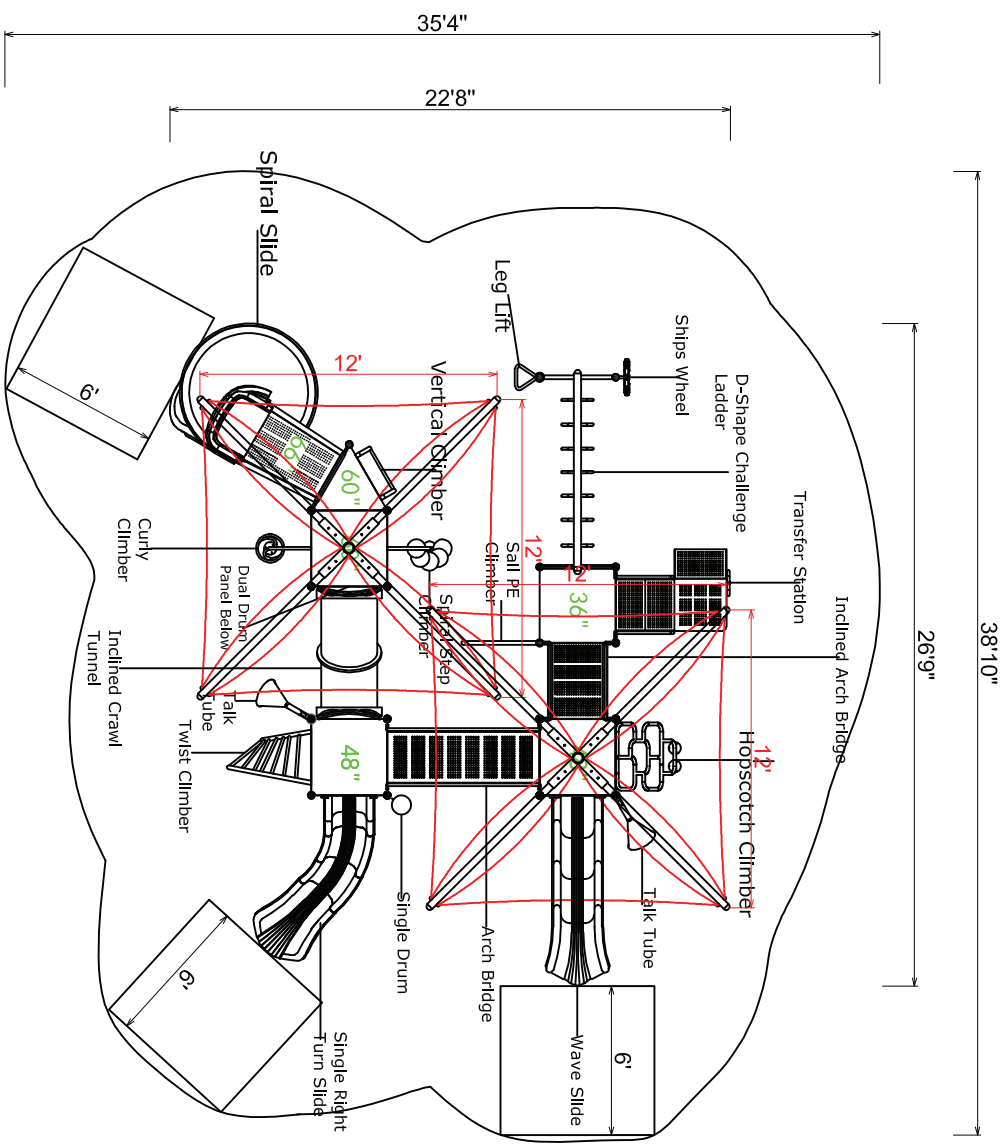

**Compliance:**  
 This play structure has been designed to meet the safety requirements established in:

- 2010 ADA Standard
- ASTM F1487
- CPSC Pub #325

when the play structure is installed over a properly maintained surfacing material which is in compliance with:

- ASTM F1292
- ASTM F1951

and is appropriate for the highest designated play surface of the structure.

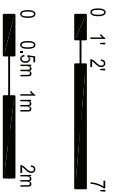

<p><b>Buena Vista B</b></p>	<p>Drawing No: KP-32726          Date: 27-03-2020          Scale: To Fit</p>	<p>Structure Size: 26'9"X22'8"X13'6"          Recommended Use Zone: 38'10"X35'4"          Surface Area: 1404 Sq Ft</p>	<p>HDPS: 7'          Age Group: 2-12          Capacity: 34-38</p>	<p><b>Creative Recreational Systems</b></p>
-----------------------------	--	--	---	---