



Use Zone: 110' x 40'



ADA Access: Yes



Age Group: 2-12



Occupancy: 68-72



Free Shipping!

COMPONENTS: Transfer Station / Hex Leaf Roof / Single Wave Slide / Upright Snake Climber / Rise Inter Steps / Spiral Slide / Safety Panel (Above) / Store Panel (Below) / Bones Bridge / Single Left Turn Slide / Challenge Ladder / Tic-Tac-Toe Panel / Single Straight Slide / Four Leaf Roof / Pod Climber / Single Drum / Guardrail (Above) / Bench Panel (Below)

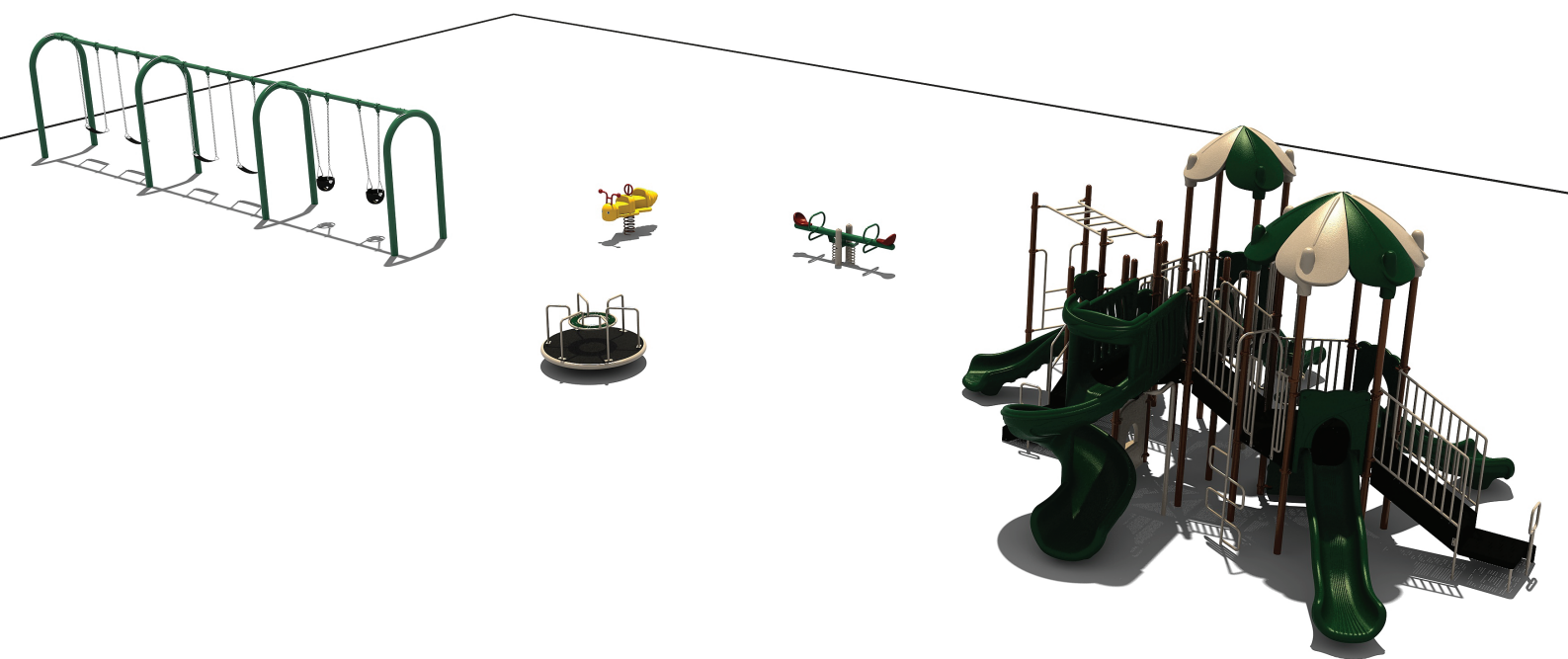

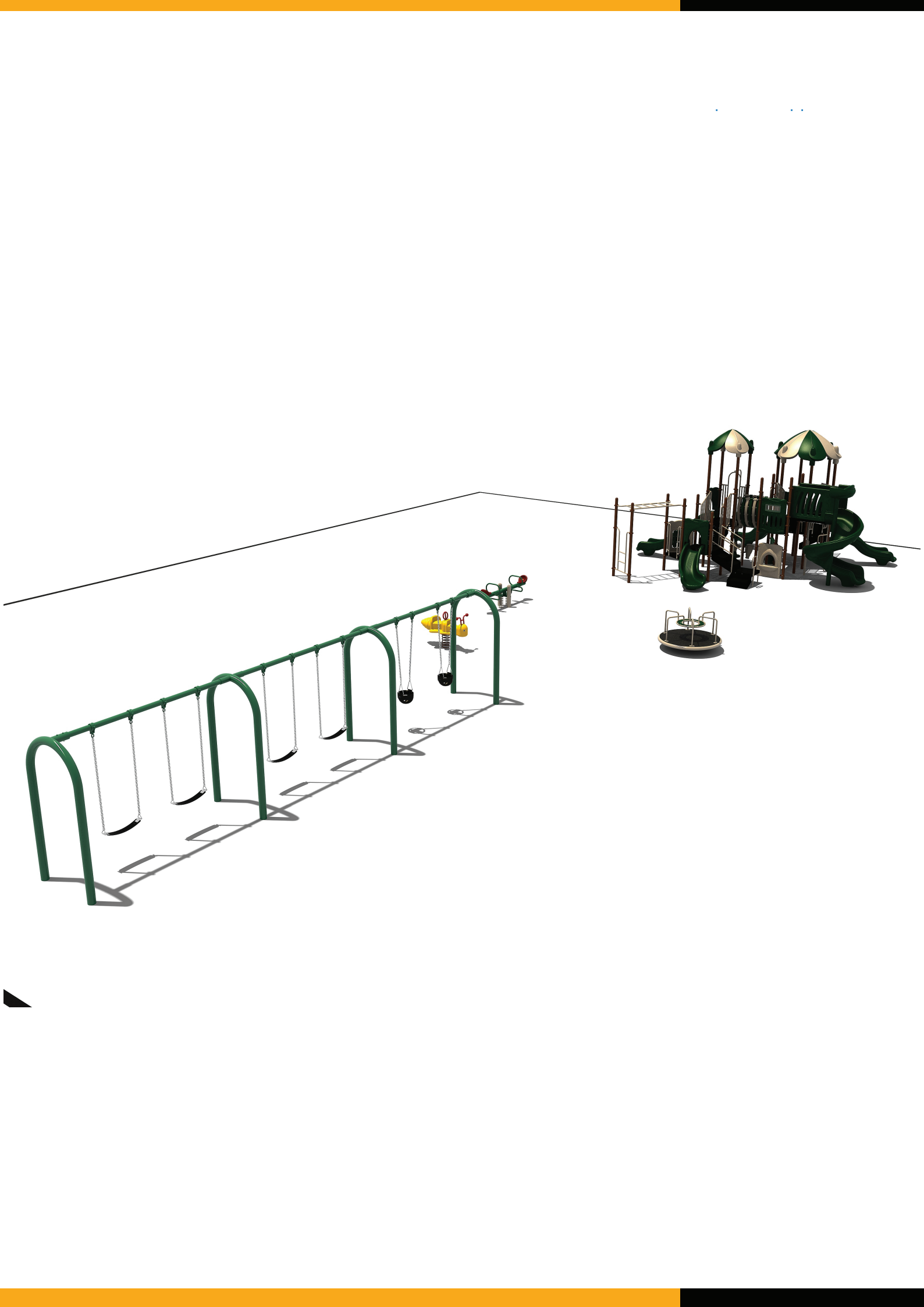

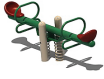

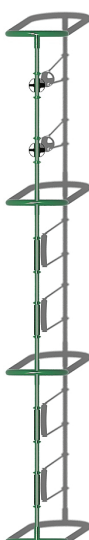
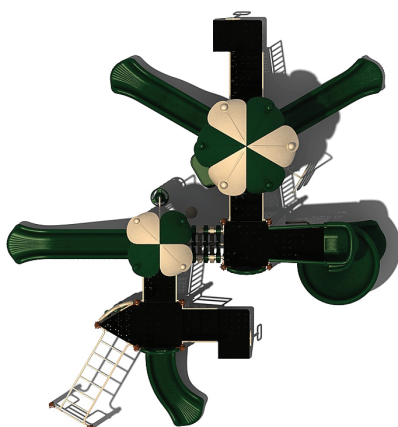

Top View Detail

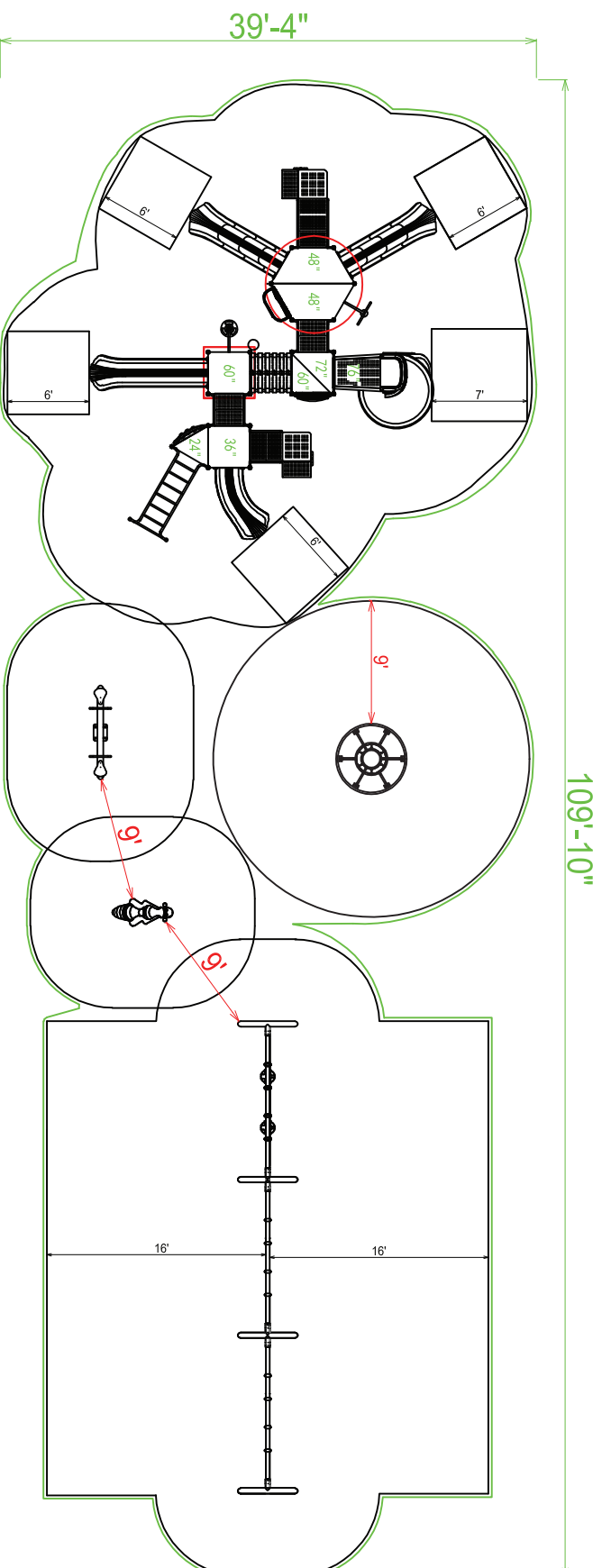

Green Line Area: 3405 Sq Ft

Compliance:
 This play structure has been designed to meet the safety requirements established in:
 - 2010 ADA Standard
 - ASTM F1487
 - CPSC Pub #325
 when the play structure is installed over a properly maintained surfacing material which is in compliance with:
 - ASTM F1292
 - ASTM F1951
 and is appropriate for the highest designated play surface of the structure.

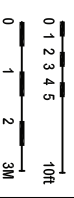

Drawing No.: KP-22019 FS-1808 SR-1404 ASF-500803 Date: 16-12-2022 Scale: To Fit	Structure Size: 27'-6" X 25'-6" X 14'-6" Recommended Use Zone: 109'-10" X 39'-4" Surface Area: 3405 Sq Ft	HDPS: 7 Age Group: 2-12 Capacity: 68-72 Weight: 5080 lbs	Creative Recreational Systems, Inc
--	---	---	------------------------------------