

CANOPY HOODS



Model E81 AQUA

Model E83 KEYLINE

Mounting the hood - follow the numerical sequence (10,20,30)

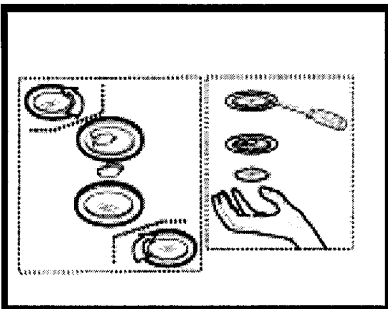
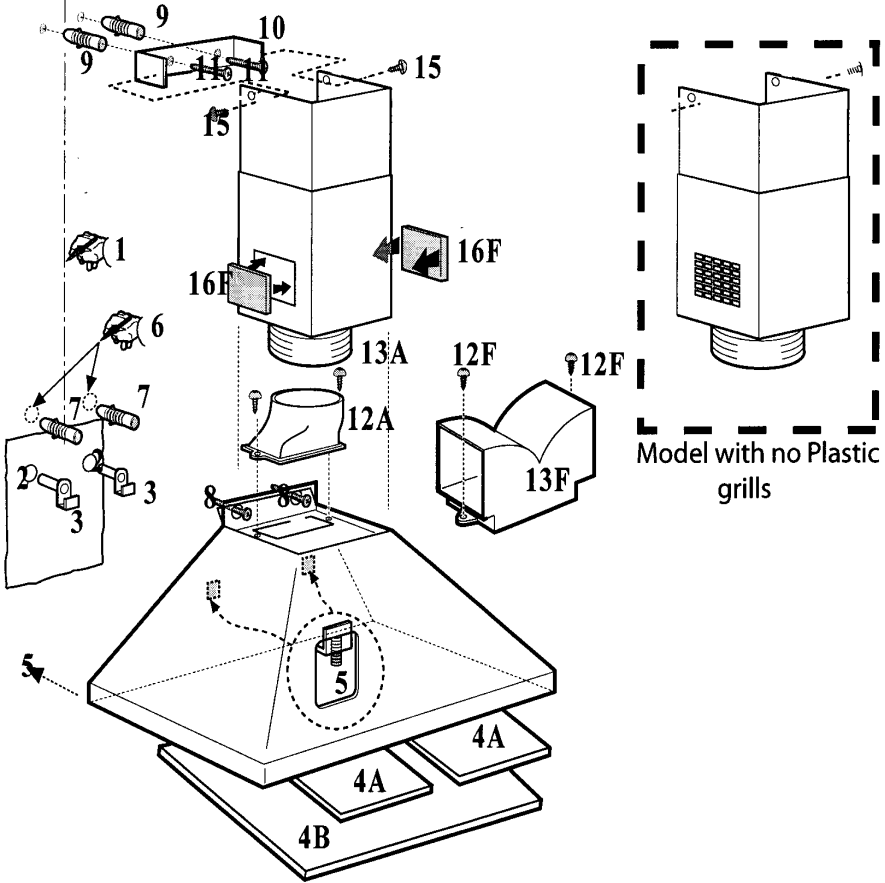

Remove or Replace Halogen Globe

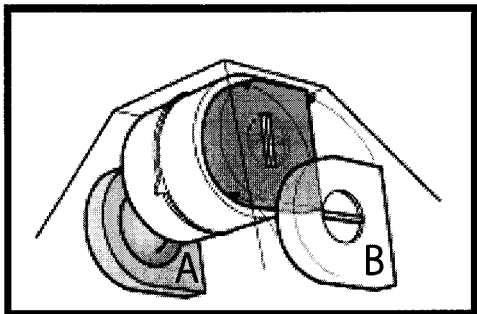

Remove or Replace Charcoal Filters

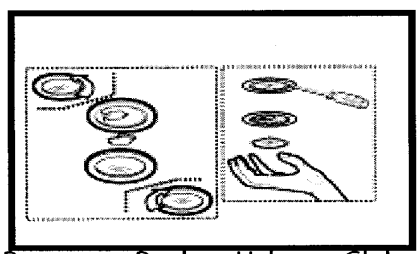
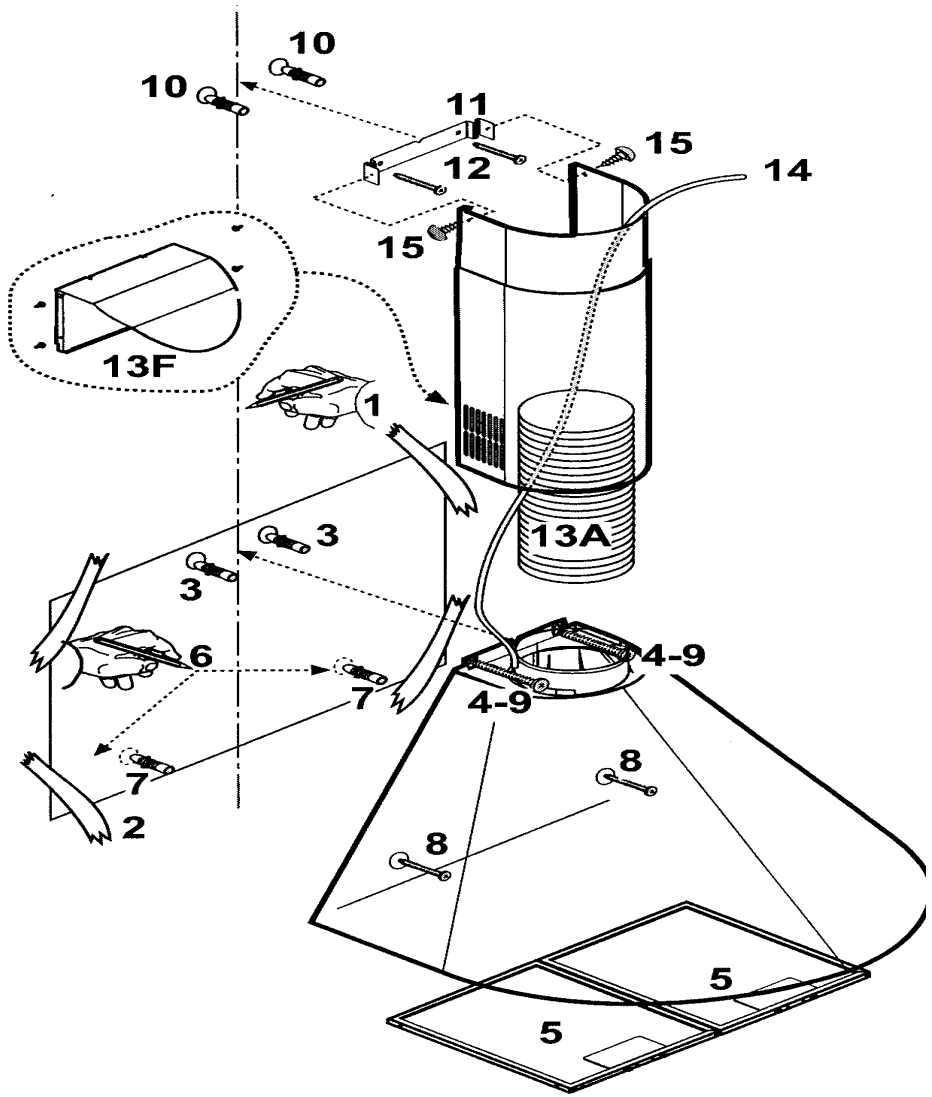

Remove or Replace Halogen Globe

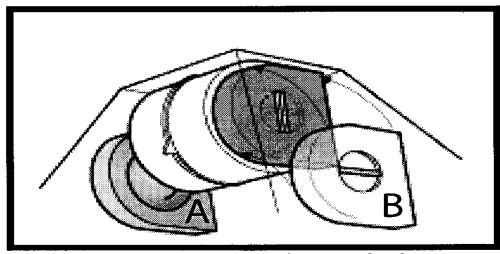

Remove or Replace Charcoal Filters

Consult the designs in the front pages referenced in the text by alphabet letters. Closely follow the instructions set out in this manual. All responsibility for any eventual inconveniences damages or fires caused by not complying with the instructions in the manual is declined.

Installation

When installed, the distance between hood and burners must be not less than 65 cm. above electric burners or 75cm above gas or mixed-fuel burners
 The exhausting pipe is not supplied and must be purchased apart. The manufacturer only recommends the use of smooth bore ducting. As this does not restrict air flow during use.
 Do not tile or grout or silicone the appliance to the wall. Surface mounting only.
 Do not fix the chimney flue to furniture or shelves unless the chimney flue can be easily removed in case maintenance is ever required.

USE

The cooker hood is provided with an upper air exit, B- for discharging fumes externally for models including chimney flue C- (Suction version A- exhaust pipe 13A not supplied) In the instance where it is not possible to discharge cooking fumes and vapours externally even if utilising the model with chimney flue. C- the cooker hood may be used in the filter version F- by mounting two active carbon filters E- the fumes and vapours are recycled via the upper grill G- (depending on the model the grill may be directly placed on the chimney flue or via the mounting of two small grills if in possession of a model with grill placed on chimney flue the two H extensions must be placed on the deflector 13F The models provided with small dome D may only be used in the filter version F The models without suction motor operate only in the suction version and must be connected to a peripheral suction unit (not supplied)

Electric connection

Before completing any connection, make sure the house voltage corresponds with the voltage indicated on the label affixed inside the hood. It is advisable to call a qualified technician to make the electrical connection

Appliance fitted with plug.

Connect it to a socket which conforms with current regulations.

Operation

The cooker hood is provided with a key or pushbutton control panel situated at the frontal part of the cooker hood type in possession. for proper operation consult the text below and the relative illustration:

- a. ON/OFF lighting b. OFF motors
- c-d-e. Minimum suction power (c) medium (d) maximum (e)
- (f) Operation warning light (where present)

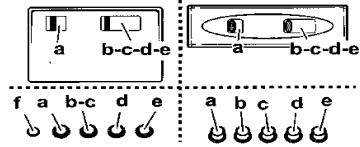

Use the high suction speed in cases of concentrated kitchen vapours. It is recommended that the cooker hood suction is switched on for 5 minutes prior to cooking and to leave in operation during cooking and for another 15 minutes approximately after terminating cooking.

Electronic control panel

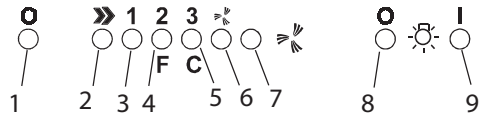

- 1 - Motor OFF button
- 2 - On button and motor speed selection button 1 - 2 - 3 - 1 - 2 - ...
- 3 - Speed 1 LED
- 4 - Speed 2 LED and metal grease filter saturation LED (in the latter case, the LED will flash - See instructions on grease filter cleaning).
- 5 - Speed 3 LED and carbon filter saturation LED (in this latter case, the LED will flash - See instructions on active carbon filter replacement).

Warning!

The active carbon filter saturation LED is not activated In order to activate the carbon filter saturation indicator press buttons 2 and 7 simultaneously for 3 seconds. Initially, only LED 4 will flash, then after the 3 seconds have passed, LED 5 will also start flashing, indicating that the carbon filter saturation control system is active. To switch off the system, re-press the same two buttons after 3 seconds LED 5 will stop flashing and the device will be switched off

- 6- Intensive speed LED
- 7- Intensive speed ON switch. This speed should be used when the concentration of cooking fumes or odours is particularly strong (for when frying, cooking fish etc). The fast speed will run for about for about 5 minutes and then return to the speed previously set automatically (1, 2 or 3), or switch off the fast speed before the end of the 5 minutes, press button 1 or button 2 (see page 13).
- 8 - OFF lamp button
- 9 - ON lamp button

If the hood fails to operate correctly, briefly disconnect it from it from the mains supply for almost 5 sec. by pulling out the plug. Then plug it in again and try once more before contacting the Technical Assistance

Using the hood—

The hood is provided with a motor with several speeds. For the best performance, we recommend using the low speeds in normal conditions and the high speeds in particular cases of strong odour and vapor concentration.—We recommend starting up the hood a few minutes before cooking and keeping it running until all the odors have been eliminated. If the hood fails to operate correctly, briefly disconnect it from the mains power supply for almost 5 sec. by pulling out the plug. Then plug it in again and try once more before contacting the Technical Assistance Service.

Warning!

- The hood cannot be connected to flues of other appliances that run on energy sources other than electricity.
- When the hood is used at the same time of other appliances that run on energy sources other than electricity, provision must be made for an adequate supply of air.
- No food must be cooked flambeé underneath the hood.
The use of an unprotected flame is dangerous for the filters and could cause fires. Therefore, never use an open flame under the hood. When frying foods, never leave the pan alone because the cooking oil could flare up.
- Please, keep to the provisions of official directives regarding the question of fume discharge.
- The manufacturers refuse to accept any responsibility for damage to the hood or its catching on fire because of failure to observe the above instructions.

Maintenance

Before performing any maintenance operation, isolate the hood from the electrical supply by switching off at the connector and removing the connector fuse.
Or if the appliance has been connected through a plug and socket, then the plug must be removed from the socket.

Metal grease filter (2 or 3 pieces)

The metal grease filter lasts forever and must be washed either by hand or in the dishwasher (65°C) with suitable detergents.

The metal grease filters must be washed at least once a month and anyhow whenever **LED 4 indicates the saturation of the filter.**

This **LED** warns you when the metal grease filter needs to be cleaned.

This **LED** flashes to warn you that the metal grease filters must be cleaned.

Generally, these must be cleaned after 40 hours of use.

Once the grease filters have been cleaned, press button **1** for some seconds until you hear the acoustic signal (beep): the **LED 4** will now stop flashing.

When washed in a dish washer, the grease filter may discolor slightly, but this does not affect its filtering capacity.

Remove the filter using the handles designed for this purpose by pulling the filter backwards and then downwards (Fig. 1).

Let the filter dry without damaging it before putting it back into place.

Carry out the above steps in reverse order to put the filters back after having washed them.

Carbon filter (2 pieces)

This filter dissolves cooking odors.

The carbon filter must never be washed.

The carbon filter should be replaced every **4** months under normal use and anyhow whenever **LED 5** indicates the saturation of the filter.

This **LED** indicates carbon filter needs to be replaced.

This led flashes to warn you that the carbon filter must be replaced.

This must be done after approximately 160 hours of use.

Once you have replaced the carbon filter, press button **1** for about 3 seconds until you hear the acoustic signal (beep).

The **LED 5** will now stop flashing.

Mounting and replacing the carbon filter:

- a) Disconnect the hood from the electricity.
- b) Remove the metal grease filters (Fig. 1).
- c) If the filters have not been installed, place one filter on each side so that they cover the grates protecting the rotor on the motor. Then turn the center handle for the filters in the clockwise direction (Fig. 2).
- d) If the charcoal filters have already been installed (covering the grates protecting the rotor on the motor) and must be replaced, turn the central handle in the counter-clockwise direction until the filters are unlocked.
- e) Refit the the metal grease filters.

Cleaning

To clean the outside of the hood use a cloth moistened with denatured alcohol or neutral liquid detergents. Never use products containing abrasive.

Wipe brushed stainless steel in the same direction as the brushing to avoid scratching.

Attention

Failure to observe the rules for cleaning the appliance and changing and cleaning the filters may cause fires.

Therefore, we recommend observing these instructions.

Replacing the lamp

- a) Disconnect the hood from the electricity.
- b) Unscrew the light shield (Fig. 3).
- c) Replace the damaged lamp with a new halogen lamp of 20 Watt max.
- d) Refit the the metal grease filters and the light shield.
- e) Before calling for repair service because the hood fails to light up, make sure the bulbs are screwed in tightly.

Use: Two systems are available

Exhaust mode (S)

Vapors are extracted outside through an exhausting pipe that is affixed to the connection ring above the hood. Diameter of the exhausting pipe must be equal to that of the connection ring.

Attention!

If the hood is supplied with carbon filter, then it must be removed.

Filter version (K)

The air is filtered through a carbon filter (for its installation see paragraph "Carbon filter") and recirculated into the room through the grating on the lower side of the chimney.

Attention!

If the hood is not supplied with carbon filter, then it must be ordered and mounted.

This version is used when there is no exhaust duct for venting outdoors or when it is impossible to install one.



Warranty Certificate (Australia)

Fiori Holdings Pty Ltd ABN 11 089 098 297

PO Box 45, Marayong NSW 2148 PH 02 9831 5594 Fax 02 9831 3803

The benefits conferred hereunder are in addition to all other rights and remedies in respect of the product which the purchaser has by virtue of the Trade Practices Act 1974, and similar State and Territory legislation and nothing contained in this Certificate shall in any way limit the purchaser's rights under such legislation

Fiori Holdings Pty Ltd warrants this product against manufacturing defects and faulty materials, for a period of 24 months from date of purchase.

This warranty is limited to the repair or replacement free of charge within the warranty period of any component or part, which Fiori Holdings Pty Ltd at its discretion determines to be faulty. Such warranty is subject to the terms and conditions set out below.

TERMS AND CONDITIONS

The following conditions apply in respect of the warranty given in this certificate,

1. The warranty applies within the Commonwealth of Australia and only if the product is used for domestic purposes and where normal vehicular access is provided.
2. The warranty does not apply for the following:
 - (a) Light globes
 - (b) To paint finishes and glass.
 - (c) If defect is caused by misuse - wear and tear - dirt - fire - accidental damage or faulty electrical connection
 - (d) If the product has been repaired or serviced by an unauthorized person
 - (e) If installed contrary to Fiori Holdings Pty Ltd instructions

3 For warranty service outside of Capital City metropolitan area or outside the normal service area of the nearest authorized service provider the purchaser shall be liable for traveling expenses and cost of transport of the product or parts to and from the Service Provider. NOTE: A charge shall be made if the service person finds the product is functioning correctly.

4 The purchaser must produce proof of the date of purchase together with this Warranty Certificate when making a claim.

5 To abide by the guarantee please complete the details below and keep with your purchase invoice.

For details of your nearest Service Provider please select from the Service Provider list or contact the warranty administrator, Data Works Administration on 02 9674 2361

Guarantee Record

Name of Purchaser: _____

Address: _____

Date of Purchase: _____ Model No: _____ Serial No: _____

Name of Supplier: _____

Address: _____

Invoice No: _____

Complete but do not post

Fiori cooking products				
Warranty Service Providers				
20th August '03				
State	Service Area	Company Name	Telephone	Products Serviced
ACT	Canberra	Premier Appliances	(02) 6280-5087	CE DW MW RH
NSW	Ballina to Tweed	Paul N Rogers	(02) 6680-3247	CE CG DW MW RH
NSW	Bathurst	Zylstra Appliances	(02) 6332-1226	CE CG RH
NSW	Berridale	Berridale Appliances	(04) 2711-0247	CE CG DW MW RH
NSW	Coffs Harbour	Coffs Electrical Services	(02) 6651-4145	CE CG DW MW RH
NSW	Coffs Harbour	Reg Wooderson Appliance Service P/L	(02) 6653-3581	CE CG DW MW RH
NSW	Cowra	Neil Stephenson Washer & Dishwasher Service	(02) 6342-1860	DW MW RH
NSW	Grafton	Repairs and Spares	(02) 6642-1911	CE DW MW RH
NSW	Kempsey	Macleay Appliance Service	(02) 6562-1359	CE CG DW MW RH
NSW	Leeton	Leeton Appliance Service	(02) 6953-4151	CE DW MW RH
NSW	Newcastle	Regional Appliance and Electrical Services P/L	(02) 4284-9873	CE CG DW MW RH
NSW	Norwa	Shoalhaven Gas Hot Water & Elements P/L	(02) 4423-1533	CE CG DW RH
NSW	Orange	Orange Refrigeration and Washing machine Repairs	(02) 6362-9364	CE CG DW MW RH
NSW	Port Macquarie	Mid Coast Appliance Service	(02) 6584-2433	CE DW RH
NSW	Singleton	Electrical Spares and Repairs	(02) 6571-1633	CE MW RH
NSW	Sydney	All General White Goods	(02) 9756-1511	CE CG DW MW RH
NSW	Tamworth	Tamworth Electrical Service	(02) 6765-8509	CE CG DW MW RH
NSW	Wollongong	Hen's Appliance Service	(02) 4261-3227	CE CG DW RH
NT	Darwin	Mobile Electrics	(08) 8936-1888	CE DW MW RH
QLD	Ayr	Coral Coast Electrical	(07) 4783-4711	CE DW RH
QLD	Brisbane	Endeavor Refrigeration	(07) 3872-7444	CE CG DW MW RH
QLD	Bundaberg	Bundaberg Appliance Service	(07) 4153-1700	CE DW MW RH
QLD	Gympie	Deans Electrical	(07) 5482-2366	CE CG DW MW RH
QLD	Hervey Bay	Hervey Bay Home Appliances	(07) 4125-3775	CE DW MW RH
QLD	Mackay	All Electrical And Refrigeration Services	(07) 4942-1106	CE DW RH
QLD	Mt Isa	P & R Electrical	(07) 4743-3354	CE DW MW RH
QLD	Mt Tambourine	Tambourine Mountain Electrical Service & Refrigeration	(07) 5545-1207	CE DW RH
QLD	Nambour	Nambour Electrical Service	(07) 5441-1677	CE CG DW MW RH
QLD	Noosa	Paul Matters Electrical P/L	(07) 5449-7133	CE CG DW MW RH
QLD	Port Douglas	Port Douglas Electric	(07) (40985) 933	CE DW RH
QLD	Rockhampton	Leenders Electrical	(07) 4927-2922	CE DW RH
QLD	Sunshine Coast	Kerr's Electrical Appliance Service	(07) 5491-2188	CE CG DW MW RH
QLD	Toowoomba	Mercer and Luck	(07) 4632-8155	CE CG DW MW RH
VIC	Bendigo	Charlton's	(03) 5443-4622	CE CG DW MW RH
VIC	Echuca	Stapleton Electrical & Refrigeration Service	(03) 5482-5453	CE DW MW RH
VIC	Horsham	J.D & J.M English	(03) 5382-2568	CE DW MW RH
VIC	Melbourne	Advantage Appliances	(03) 9558-8611	CE CG DW MW RH
Vic	Mildura	Jack Abel	(03) 5023-3613	DW RH
VIC	Mildura	Sunrasia Gas P/L	(03) 5023-2907	CG
VIC	Ouyen	Greegs Electrical	(03) 5092-1352	CE DW RH
VIC	Sale	Mackay and Love Appliance repairs	(03) 5144-7855	CE MW RH
VIC	Torquay	P.K.E. Appliance Repairs	(03) 5261-3628	CE DW MW RH
VIC	Warmambool	Peter Pierson Gas Services	(03) 5562-5113	CG
WA	West Australia	GBI Appliance Service	(08) 9478 0469	CE CG DW MW RH
Legend: CE = cooking electric. CG = cooking gas. MW = microwave oven. DW = dishwase RH = range hoods				
For service please select the nearest service provider from the above list or contact the warranty administrator.				
Warranty Administrator :- Data Works Administration				
P O Box 785, Kings Langley 2147				
Ph: 02 9674 2361. Fax: 02 9674 2415				
Email: dataworks@tpq.com.au				