

IVORY BASIC SOCKET

DIY Assembly
Instructions

COLOR CORD COMPANY[®]

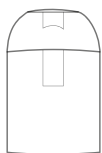
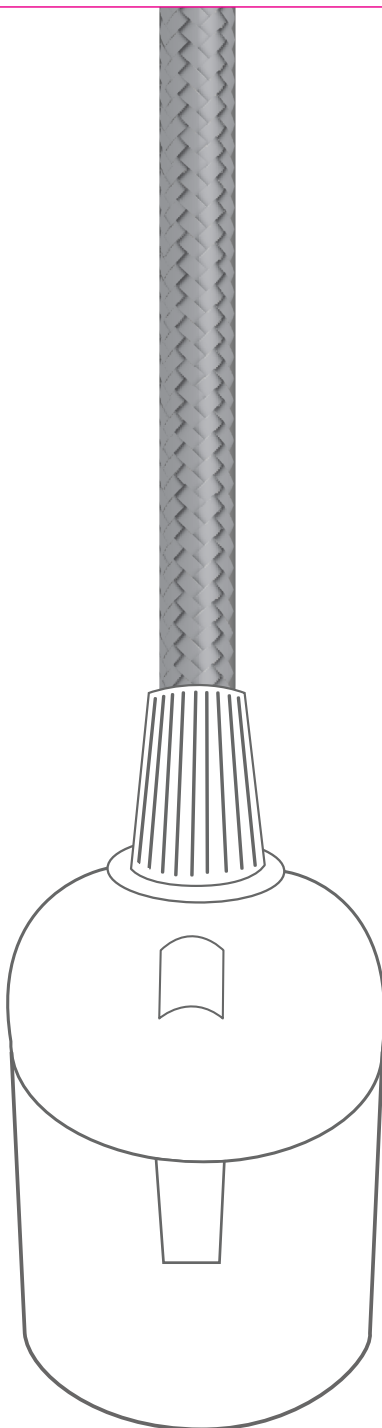

Basic

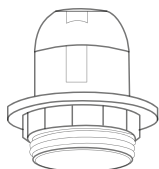

Shade Ready

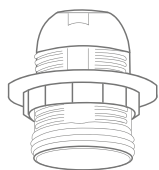

Shade Ready
Extended Threads



Check disclaimer on the last page prior to beginning assembly.

WIRE A SOCKET

Parts:

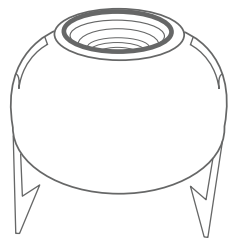

Cap

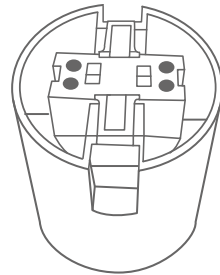

Shell



Blade



Screwdriver



Electrical Tape

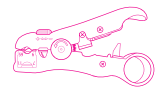

Color Cord 3000
stripping tool
NOT REQUIRED



Standard

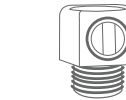

OR Barrel

Cord Grip

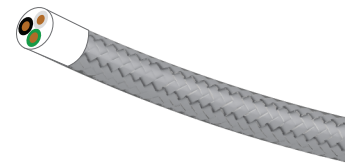

Cloth Covered
Electrical Wire
Your Choice of length.

WARNING: THESE SOCKETS ARE SELF LOCKING! Do not assemble the sockets with the terminal plate inside before it is wired. The terminal is designed to lock the socket permanently.



1. Grab the cord grip and untwist the cap.

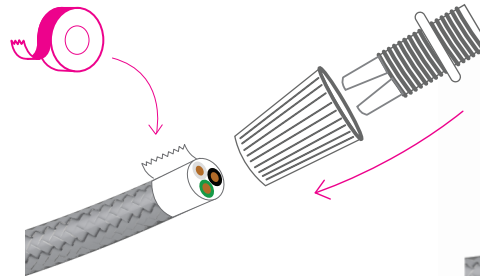

2. You might need to place tape around the end of the cord, so the cord grip and cap can slide over the cord easily. Try spinning the cord grip into the cord if it gets stock.

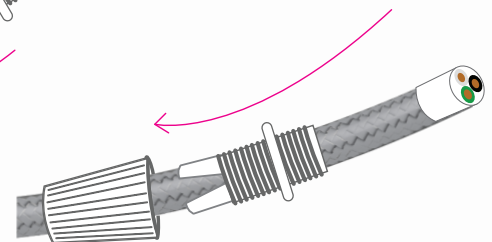

3. Insert one end of the cloth covered wire into the top hole of the cord grip's cap and then the cord grip. The cord grip's threaded end should face the end of the cord once inserted.

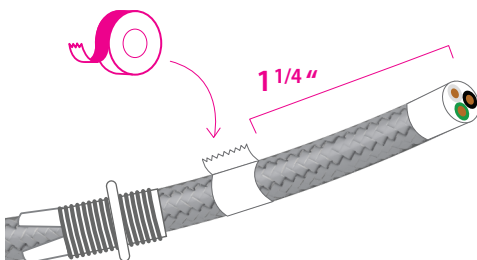

4. Measure 1 1/4" from the tip of the cloth covered wire, and wrap an inch of electric tape over the wire.

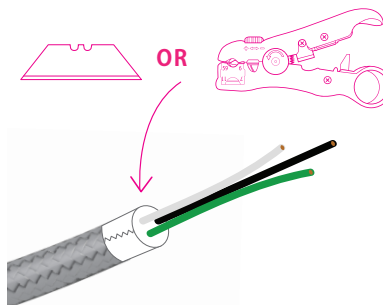

5. Over the mid section of the tape, strip the PVC housing to expose the 3 conductor wires. We recommend the use of our Color Cord 3000 stripping tool.

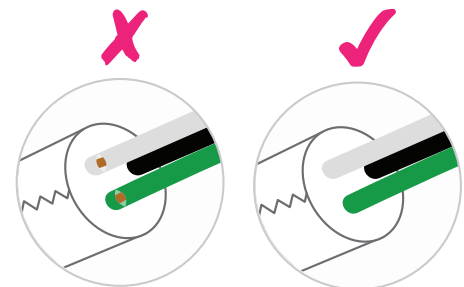

6. Make sure that there are no cuts on the conductor wires exposing the internal stranded copper wire.

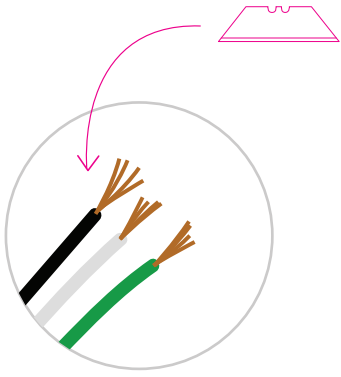

7. Strip one end of each wire to expose about 3/16" of the stranded copper wire.

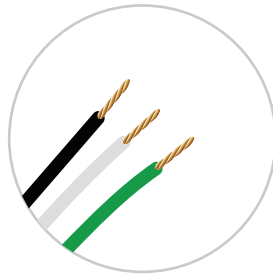

8. Using your fingers, twist the stranded wires together.

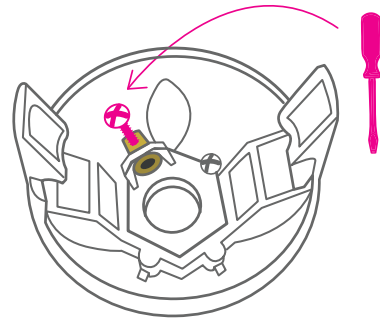

9. Flip the cap upside down & locate the screw of the ground terminal. Loosen the screw about 1/8."

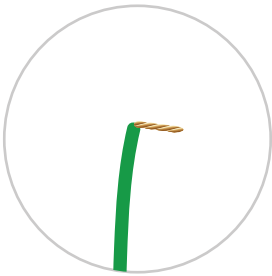

10. Bend the exposed end of the ground (green) wire to a 90 degree angle.

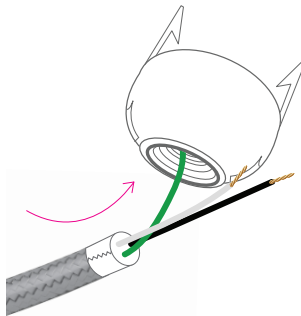

11. Insert ground (green) wire through the top opening of the cap.

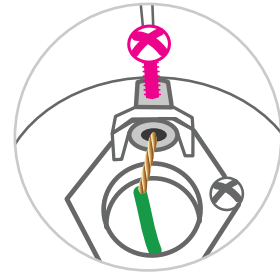

12. Insert the exposed section of the green (ground) wire into the ground terminal opening under the screw.

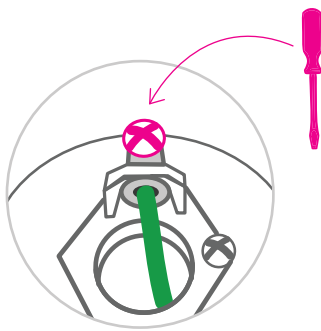

13. Make sure the exposed copper wire is completely inside the hole. Then secure wire in place with the screw.

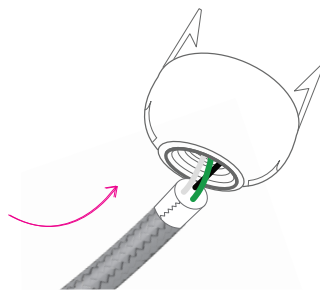

14. Insert the black & white wire through the top opening of the cap and push the wire inside the cap.

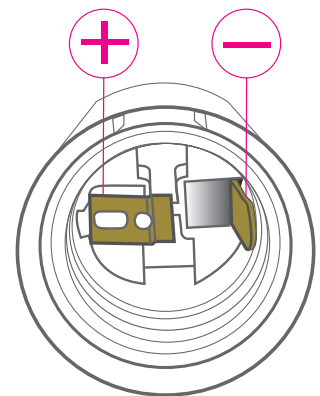

15. Flip the terminal upside-down & locate the positive & negative ports. The positive terminal will be the bent brass plate, and the negative the open plate that reveals the silver piece underneath.

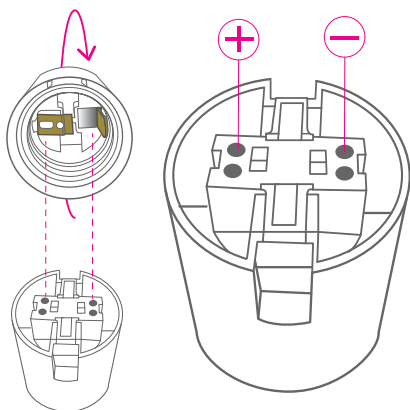

- 16.** Flip the terminal again and locate the corresponding positive & negative terminals, which will directly above the + & - ports.

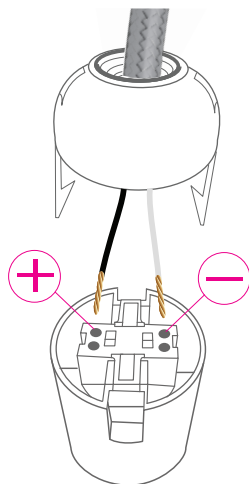

- 17.** Align the cap with the terminal, so the black wire is aligned with the positive terminal, and the white wire with the negative.

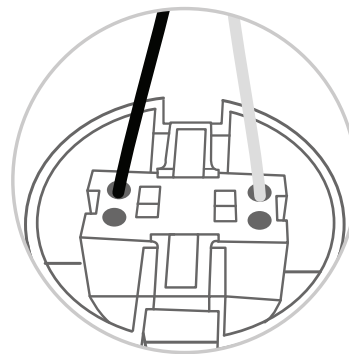

- 18.** Insert the black stranded copper wire into one of the 2 round positive terminal holes, and the white stranded copper wire into one of the circular negative terminal holes.

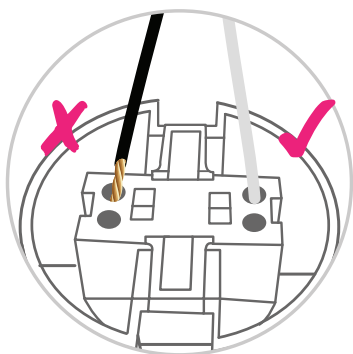

- 19.** Make sure the stranded wires are all the way in, and that each wire is locked in place. If done correctly, you won't be able to pull the wire out of the terminal.

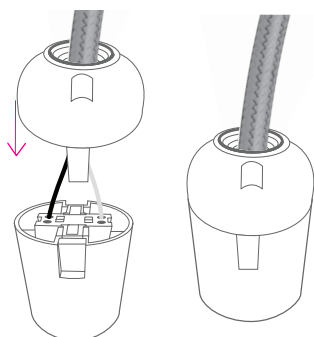

- 20.** Align the wings of the cap and side pockets of the terminal. Push them together until socket locks.

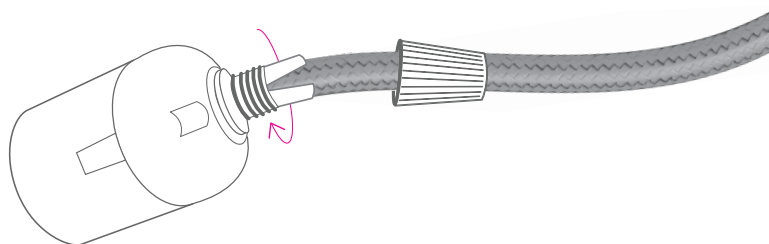
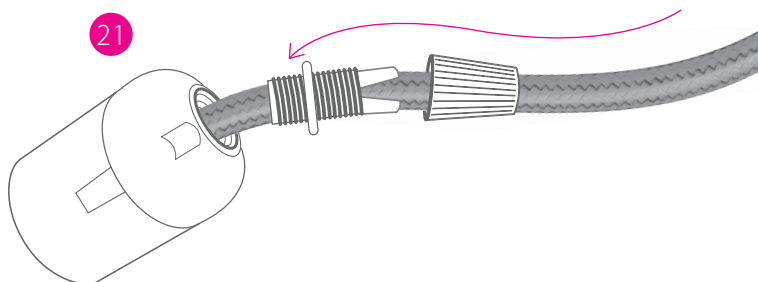

- 21.** Take caution when sliding the cord grip down the cord towards the socket so as not to snag the cloth covered wiring.

- 22.** Twist the threaded cord grip into the socket, and then slide the cord grip's cap over it and twist it until it covers all the threads. The cord grip might be tight and will take some force to screw it into the threads. Don't be discouraged!

ENJOY!

Educational, Tutorial and DIY Content Disclaimer

COLOR CORD COMPANY[®]

Educational, Tutorial and DIY Kit Content Disclaimer

All material covered on **www.colorcord.com** and associated social media and print assets is for informational purposes only. We take no responsibility for what you do with this knowledge. We can not be held responsible for any property or medical damages caused by items you read about on our website. We would advise you to check your local laws and consult professional electricians/contractors for any project involving electricity, construction or assembly.

The DIY and tutorial material taught throughout Color Cord Company's website and other assets is for informational purposes only. By taking any information or education material from Color Cord Company, you assume all risks for the material covered. You agree to indemnify, hold harmless, and defend The World Effect, LLC & Color Cord Company from any and all claims and damages as a result of any and all of the information covered.

By taking and/or using any informational resources from Color Cord Company, you agree that you will use this information in a safe and legal manner, consistent with all applicable laws, safety rules, and good common sense. You further agree that you will take such steps as may be reasonably necessary or required by applicable law to keep any information out of the hands of minors and untrained and/ or immature individuals.

You must accept that You and You Alone are Responsible for your safety and safety of others in any endeavor in which you engage. While the material on www.colorcord.com is provided in hopes that you build your own lighting, You are Responsible for verifying its accuracy and applicability to your project. You are Responsible for knowing your limitations of knowledge and experience. If you do any work with "main power" such as 120 or 240 VAC power wiring, you should consult a Licensed Electrician.

Some illustrative photos do not depict safety precautions or equipment, in order to show the project steps more clearly. These projects are not intended for use by children. Use of these instructions, kits, projects and suggestions is at your own risk. Color Cord Company and The World Effect, LLC disclaim all responsibility for any resulting damage, injury, or expense. It is your responsibility to make sure that your activities comply with applicable laws.

The World Effect, LLC | DBA: Color Cord Company

PO BOX 12496

Denver, CO 80212

1.800.409.1070