

# THUMB SWITCH

COLOR CORD COMPANY<sup>®</sup>

DIY Assembly  
Instructions

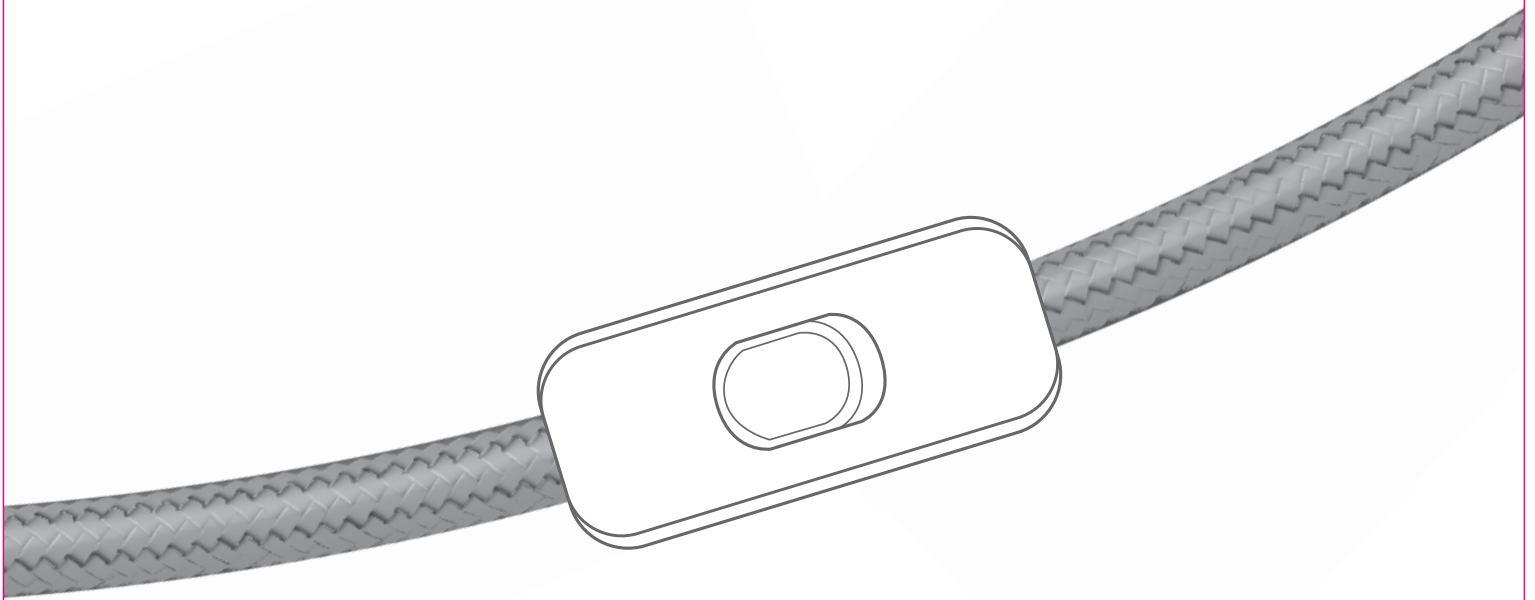

**Check disclaimer on the last page prior to beginning assembly.**

# WIRE A THUMB SWITCH

## Parts:

### TOOLS:

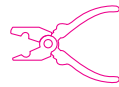

Pliers



Blade



Screwdriver



Electrical Tape

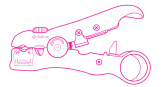

Color Cord 3000 stripping tool  
**NOT REQUIRED**

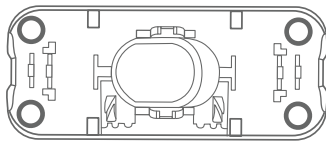

Thumb Switch

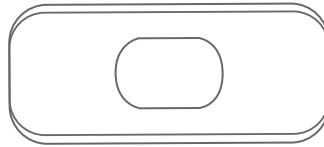

Thumb Switch Cap

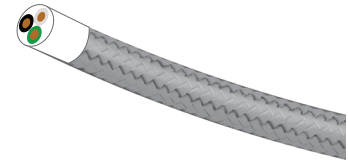

Cloth Covered Electrical Wire  
Your Choice of length.  
1 extra foot for practice recommended

**Steps 1, 2 & 3 can be tricky**, so we recommend to test this process on a separate piece of wire until you feel confident.

1. Place 2 pieces of tape 2" apart (measuring from the outer edge of each piece of tape) where you want the thumb switch on your cord.
2. At the center of each tape cut (with wire stripping tool or blade) about 1/32" to 1/6" deep around the diameter of the cord. you might need to bend the cord while you cut to make sure you don't cut the internal wires (green, white and black). Remove the cloth of the wire.
3. With a blade, carefully slice about 1/32" to 1/6" deep from the cut on one tape to the other cutting the outer plastic covering to exposing the inside wires (green, black and white). Make sure you don't cut the internal wires and expose the stranded copper wire.
4. Double check that there are no cuts on the conductor wires exposing the internal stranded copper wire.

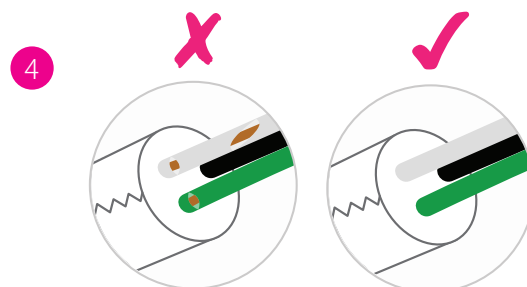
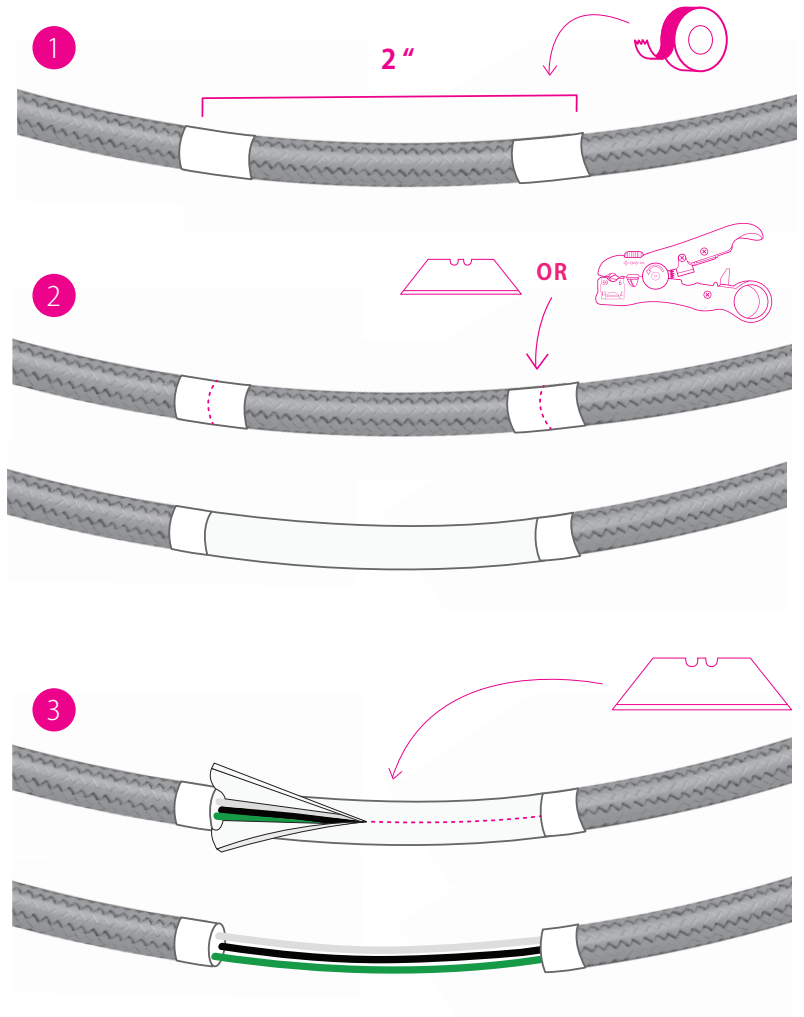

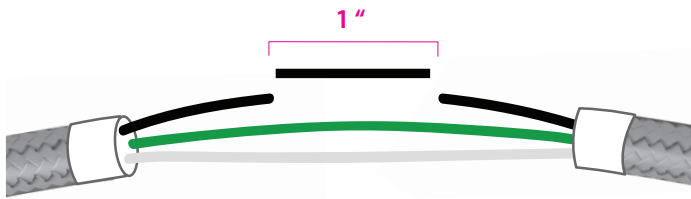

5. Locate the black (positive) wire and cut an inch off at the center.

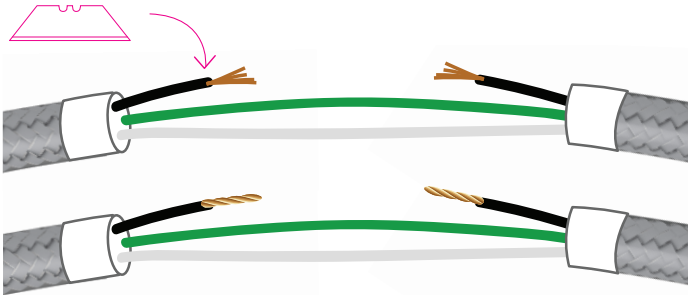

6. Strip one end of each side of the black wire to expose about 3/16" of the stranded copper wire. Using your fingers, twist the stranded wires together.

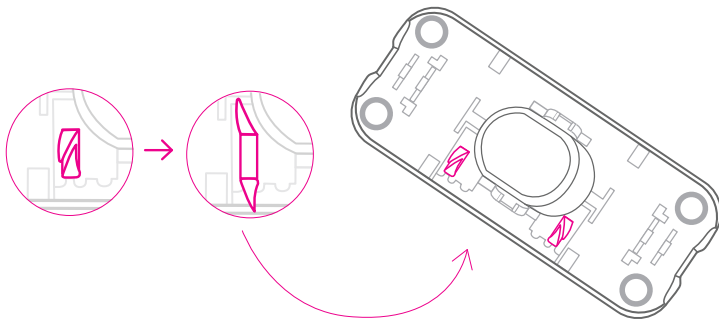

7. For easier insertion of the stranded copper wire, you may open up the tabs on the thumb switch. You can use a screw driver or pliers.

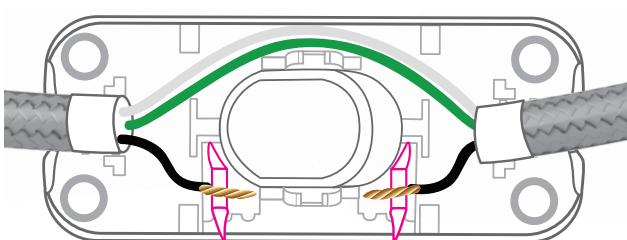

8. Place the exposed wire on the thumb switch, placing the black (positive) wires on the side of the tabs, and the green and white wires on the opposite side. Place the stranded copper wires from the black wire on the open tabs.

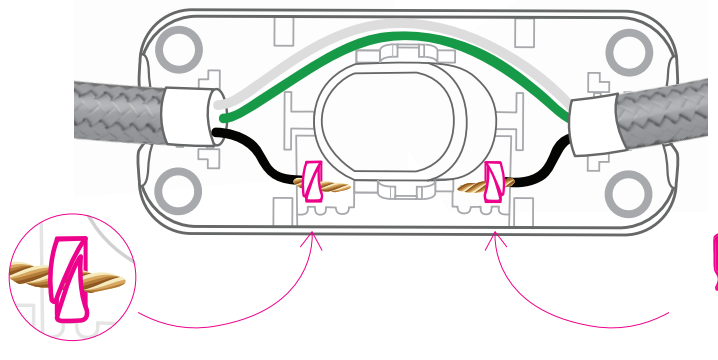

9. Close the tabs over the stranded copper wire, and using a flat screw driver press the tabs to secure the wire in place.

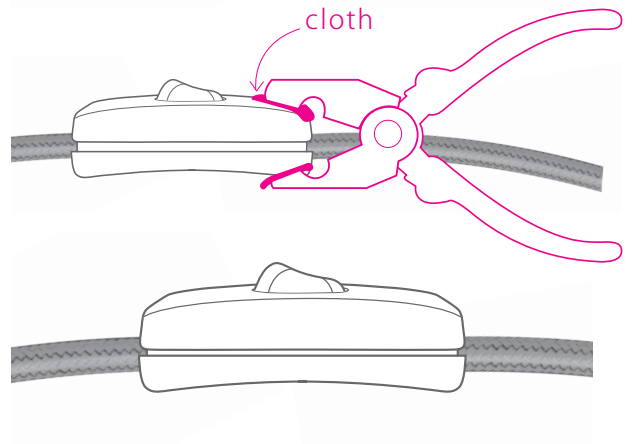
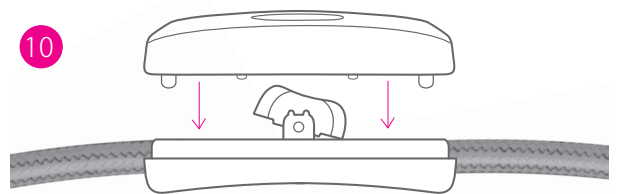

10. Secure cap into thumb switch by pressing pieces together. If you use pliers to tighten, protect the thumb switch with some cloth to avoid scratches. This is a hard task, so don't be discouraged. Try a few times!

**Heads up!** Trying to secure the cap onto the thumb switch might seem like an impossible task, but don't be discouraged. You'll need strength to place the pieces together, and you'll notice the cap won't close all the way. This is because these thumb switches are typically closed by way of a machine, and our body can only do so much. Don't worry! the thumb switch will stay in place, you just need to keep pressing until it feels secure. Call us with any questions!

**ENJOY!**

# Educational, Tutorial and DIY Content Disclaimer

COLOR CORD COMPANY<sup>®</sup>

## Educational, Tutorial and DIY Kit Content Disclaimer

All material covered on **www.colorcord.com** and associated social media and print assets is for informational purposes only. We take no responsibility for what you do with this knowledge. We can not be held responsible for any property or medical damages caused by items you read about on our website. We would advise you to check your local laws and consult professional electricians/contractors for any project involving electricity, construction or assembly.

The DIY and tutorial material taught throughout Color Cord Company's website and other assets is for informational purposes only. By taking any information or education material from Color Cord Company, you assume all risks for the material covered. You agree to indemnify, hold harmless, and defend The World Effect, LLC & Color Cord Company from any and all claims and damages as a result of any and all of the information covered.

By taking and/or using any informational resources from Color Cord Company, you agree that you will use this information in a safe and legal manner, consistent with all applicable laws, safety rules, and good common sense. You further agree that you will take such steps as may be reasonably necessary or required by applicable law to keep any information out of the hands of minors and untrained and/ or immature individuals.

You must accept that You and You Alone are Responsible for your safety and safety of others in any endeavor in which you engage. While the material on [www.colorcord.com](http://www.colorcord.com) is provided in hopes that you build your own lighting, You are Responsible for verifying its accuracy and applicability to your project. You are Responsible for knowing your limitations of knowledge and experience. If you do any work with "main power" such as 120 or 240 VAC power wiring, you should consult a Licensed Electrician.

Some illustrative photos do not depict safety precautions or equipment, in order to show the project steps more clearly. These projects are not intended for use by children. Use of these instructions, kits, projects and suggestions is at your own risk. Color Cord Company and The World Effect, LLC disclaim all responsibility for any resulting damage, injury, or expense. It is your responsibility to make sure that your activities comply with applicable laws.

**The World Effect, LLC | DBA: Color Cord Company**

**PO BOX 12496**

**Denver, CO 80212**

**1.800.409.1070**