

# PARTS DIAGRAM

## VANTAGE 80 80 LBS THRUST - 24 VOLT

## VANTAGE 101 101 LBS THRUST - 36 VOLT

This page provides Minn Kota® WEEE compliance disassembly instructions.

For more information about where you should dispose of your waste equipment for recycling and recovery and/or your European Union member state requirements, please contact your dealer or distributor from which your product was purchased.

Tools required, but not limited to: flat head screw driver, Phillips screw driver, socket set, pliers, wire cutters.

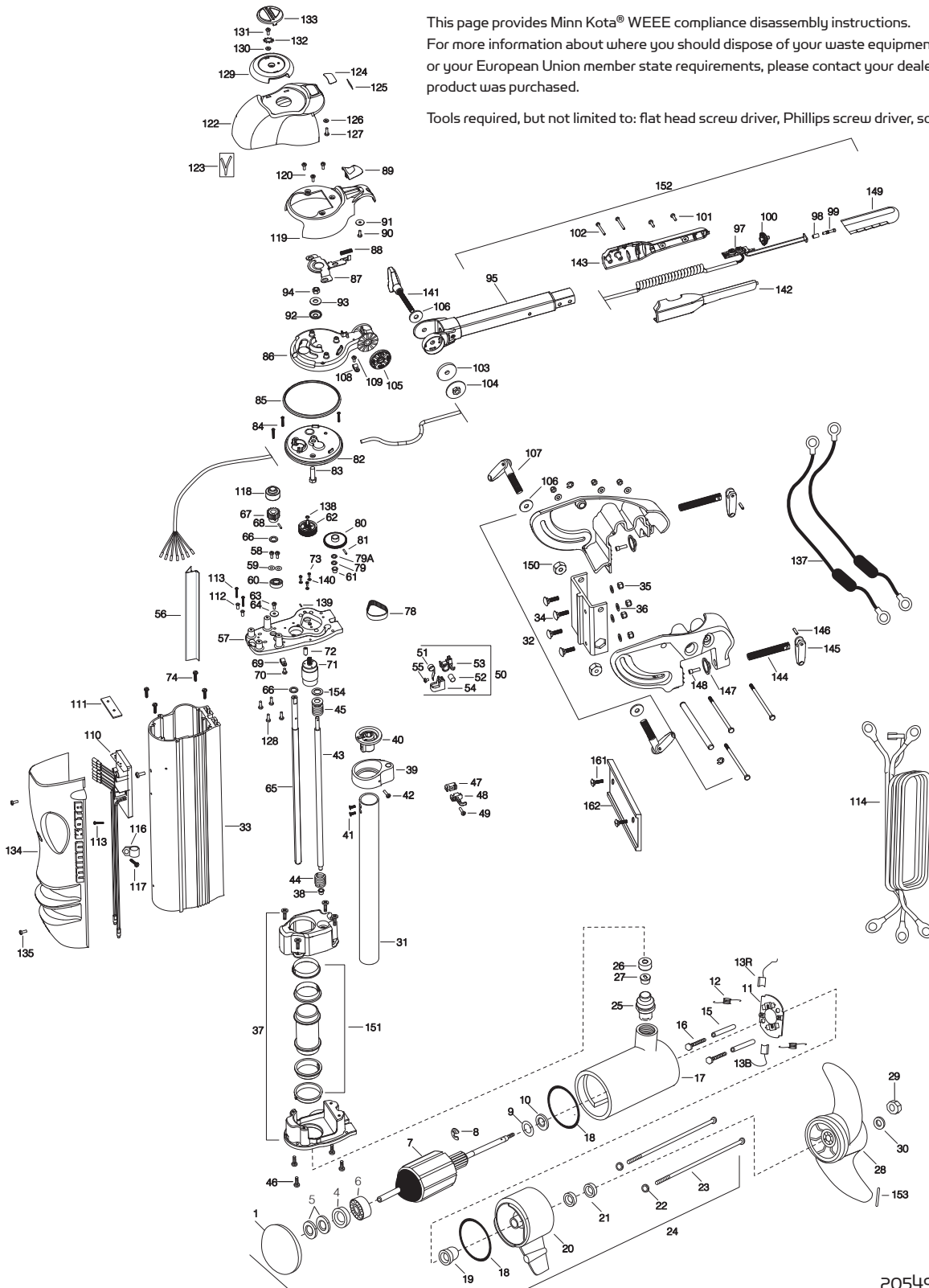

# PARTS LIST

## VANTAGE 80/101

### 80/101 LBS THRUST - 24/36 VOLT

ITEM	QTY	PART NUMBER	DESCRIPTION
1	1	421-276	PLAIN END HOUSING ASSY
4	1	990-045	THRUST SPACER
5	2	992-010	SPRING WASHER
6	1	140-010	BALL BEARING
7	1	2-100-214	ARMATURE ASSEMBLY 80
	1	2-100-216	ARMATURE ASSEMBLY 101
8	1	788-040	RETAINING RING
9	1	990-051	WASHER-THRUST, STEEL
10	1	990-052	WASHER- NYLATRON
■	1	2-600-144	BRUSH/WIRE/PLATE ASSEMBLY(11-13)
*11	1	738-004	BRUSH PLATE
*12	2	975-041	SPRING -TORSION
13	2	188-094	BRUSH
15	2	973-025	SPACER -BRUSH PLATE
16	2	830-027	SCREW - 10-32 X 2.2"
17	1	2-200-160	CENTER HSING ASSY 80
	1	2-200-110	CENTER HSING ASSY 101
*18	2	701-043	O-RING
19	1	144-017	BEARING -FLANGE
20	1	2-300-160	BRUSH END HOUSING ASSY
*21	2	880-025	SEAL
*22	2	701-009	O-RING -THRU BOLT
■	1	2889460	SEAL & ORING KIT(18, 21, & 22)
23	2	830-094	THRU BOLT 80
	2	830-096	THRU BOLT 101
24	1	2316271	MOTOR ASSEMBLY 80
	1	2316261	MOTOR ASSEMBLY 101
25	1	979-015	STRAIN RELIEF - BODY
26	1	9950339	CAP - STRAIN RELIEF
27	1	2382900	GROMMET- STRAIN RELIEF
28	1	2331160	PROPELLER (W.WEDGE 2)
29	1	2093101	NUT-PROP NYLOC (LARGE)
30	1	2091701	WASHER-PROP (LARGE)
31	1	2772010	TUBE-MOTOR 1 3/4" KIT W/TEMPLATE
32	1	2991822	TRANSOM BRCKT ASSY
33	1	2056505	HOUSING EXTRUSION
34	4	2053511	BOLT-CARRIAGE 5/16-18 1"
35	4	2151726	WASHER-5/16 STD (5/5)
36	4	2053103	NUT, 5/16-18 NYLOC
37	1	2770420	LOWER SUPPORT CAGE ASSEMBLY
38	1	2057302	BEARING-UPPER, LIFT SCREW
■	1	2881510	YOKE/BEARING RACE KIT (39,40,42)
*39	1	2051510	YOKE-LIFT SCREW
*40	1	2056200	BEARING RACE-YOKE

ITEM	QTY	PART NUMBER	DESCRIPTION
41	2	2053401	SCREW-10 X 1/2,TYPE 25
*42	1	2353401	SCREW-10-16 X 1/2 STALGD
43	1	2053400	SCREW-LIFT, 1/2-10 ACME
44	1	2052707	SPRING-COIL,SOFT STOP
45	1	2770429	COIL SPRING/WASHER KIT
46	4	2053413	SCREW-10-16X1'
N	1	2883200	WIRE CLAMP KIT (47,48,49)
*47	1	2053200	WIRE CLAMP, LEFTHAND
*48	1	2053205	WIRE CLAMP, RIGHTHAND
*49	1	2053417	SCREW-10-16X3/4
50	1	2770400	TAPE SPRING ASSY (51-55)
51	1	2052705	SPRING, CONSTANT FORCE
52	1	2052610	PIN-PIVOT 7/16" O.D.
53	1	2051920	BRACKET-SPRING
54	1	2052305	WIRE GUIDE
55	1	2053418	SCREW-#4-40X1/4
56	1	2050225	WIRE SHIELD
■	1	2770405	TOP PLATE ASSEMBLY (57,60,61,68)
*57	1	2051927	TOP PLATE
58	2	2053414	SCREW-#8-32 X 1/2
59	2	2051717	WASHER-#8 SAE FLAT
*60	1	2057306	BEARING-BALL
*61	1	2057302	BEARING-UPPER LIFT SCREW
*62	1	2052630	PIN, CLUSTER GEAR
63	1	2053415	SCREW-#8-32 X 3/8
64	1	2051716	WASHER-FENDER #10
65	1	2052001	SHAFT-STEERING
66	2	2051706	WASHER-SPRING SUPPORT
67	1	2052205	GEAR, STEERING TUBE MACHINED
*68	1	2052616	PIN-DRIV-LOK 1/8 X 1 1/8
69	1	2052510	CABLE CLAMP, 3/16'
70	1	2053415	SCREW-#8-32 X 3/8
71	1	2777812	MOTOR-LIFT (1,2,24,36V)
72	1	2058411	TENSIONER-BELT
73	3	2053422	SCREW - 3MM
74	4	2053413	SCREW-10-16X1
■	1	2882201	CLUSTER GEAR / FLANGE PULLEY KIT (75, 76, 77)
*75	1	2770427	PULLEY/PINION GEAR ASSY
*76	1	2058405	FLANGE-PULLEY
*77	2	2053418	SCREW 4-40 X 1/4 PPH
78	1	2050800	BELT-DRIVE
79	1	2051705	WASHER-NYLON
79A	1	2051703	WASHER-THRUST
■	1	2882200	GEAR LIFT/PIN KIT (80,62)

# PARTS LIST

## VANTAGE 80/101

### 80/101 LBS THRUST - 24/36 VOLT

ITEM	QTY	PART NUMBER	DESCRIPTION
*80	1	2990426	LIFT GEAR ASSEMBLY
81	1	2052620	PIN-DRIV-LOK 1/8 X 5/8"
82	1	2056520	CAP-LOWER, GEAR HOUSING
83	1	2383500	BOLT-3/8-16 X 1.25
84	3	2053402	SCREW-10-24 X 1"
85	1	2054600	O-RING, GEAR HOUSING
86	1	2056510	UPPER CAP GEAR HOUSING
87	1	2057200	LATCH
88	1	2052711	SPRING, LATCH RETURN
89	1	2050102	KNOB-LATCH
90	1	2353401	SCREW-10-16 X 1/2 STALGD
91	1	2051716	WASHER-FENDER #10
92	1	2151730	WASHER-CUP (HINGE BRACKET)
93	1	2051737	WASHER - FLAT (ZINC)
94	1	2053107	NUT-3/8-16, TOPLOCK
96	1	2990921	HANDLE ASSEMBLY
■	1	2884106	HANDLE CTRL BOARD/GRIP KIT (97,149)
*97	1	2994005	CTRL BOARD ASSY-HANDLE
98	1	2055115	BUTTON SWITCH ACTUATOR
■	1	2883701	PLUNGER/GRIP KIT (99,149)
*99	1	2053700	PLUNGER, ON/OFF
100	1	2050111	KNOB-SPEED CONTROL
101	2	2012100	SCREW-8-18 X 5/8" THD CUT
102	2	2053412	SCREW 8 X 1.5"
■	1	2880921	HANDLE TENSION KNOB KIT (103-105, 141)
*103	1	2051736	WASHER-URETHANE
*104	1	2053115	NUT-WASHER, HANDLE ASSY
*105	1	2050015	RACHET-DISK, HANDLE ASSY
■	1	2880920	BRACKET TENSION HANDLE KIT (106, 107, 150)
*106	1	2051737	WASHER-FLAT
*107	2	2050922	HANDLE, TENSION, SHORT
108	1	2052510	CABLE CLAMP, 3/16"
109	1	2053415	SCREW-#8-32 X 3/8"
*110	1	2774041	CNTRL BRD ASSY 24/36V W/PAD INCL.111
*111	1	2315105	INSULATING PAD
112	2	2261712	SHOULDER WASHER
113	3	2053407	SCREW-#8-32 X .75 PPH
114	1	2051220	LEADWIRE, 24/36V CONDUCT
116	1	2052512	CABLE CLAMP, 1/2"
117	1	2053415	SCREW-#8-32 X 3/8"
118	1	2052210	ROLLER-STEERING SHAFT
■	1	2880102	CONTROL HEAD COVER LATCH KIT (89,90,91,119)
119	1	2050200	COVER-CONTROL HEAD
120	3	2053415	SCREW-#8-32 X 3/8"

ITEM	QTY	PART NUMBER	DESCRIPTION
121	2	2012100	SCREW-8-18 X 5/8"
122	1	2050211	SHROUD-CONTROL HEAD
123	2	2055612	DECAL-SHROUD
124	1	2055604	DECAL-COVER, 24V
	1	2055602	DECAL-COVER, 36V
125	1	2055610	DECAL-COVER, LED
126	1	2051712	WASHER- .152 ID, .50 OD, .06
127	1	2302100	SCREW-6-20 X 1/2"
128	4	2012100	SCREW-8-18 X 5/8"
129	1	2050110	KNOB-POINTER, VANTAGE
130	1	2051717	WASHER- #8
131	1	2332101	SCREW-8-32 X 1/2" S5
132	1	2371715	LOCKWASHER-STAR #8 ZINC
133	1	2056700	PLUG, POINTER
134	1	2050220	SHIELD-EXTRUSION
135	2	2053414	SCREW-#8-32 X 1/2"
136	2	2055611	DECAL-SHIELD - VANTAGE
137	2	2998200	CIRCUIT BRKR ASSEMBLY 36V
138	1	2051732	WASHER .315 X .562
139	1	2053420	SET SCREW #8-32
140	3	2051710	LOCKWASHER 3MM
141	1	2050921	HANDLE TENSION - LONG
■	1	2880910	HANDLE L/R KIT (100,101,102,142,143,150)
*142	1	2050916	HANDLE SIDE L
*143	1	2050911	HANDLE SIDE R
■	2	2880925	HANDLE/CLAMP SCREW KIT (144-148)
*144	1	2051300	SCREW-CLAMP 5/8X4
*145	1	2050925	HANDLE-CLAMP SCREW
*146	1	2052625	PIN-COILED SPRING
*147	1	2011710	WASHER-CLAMP SCREW
*148	1	2263402	SCREW- 1/4-20X3/4"
149	1	2880424	GRIP KIT
*150	1	2053105	NUT- HEX
151	1	2881500	TUBE/SLEEVE/BUSHING KIT
152	1	2990950	HANDLE/CTRL BOARD ASSY
153	1	2262658	PROP PIN
154	2	2340610	CONNECTOR CABLE
■	1	2994844	TRANSOM EXTRUSION KIT (161, 162) - 101 ONLY
161	2	2053421	BOLT - 1/4-1/4X1 - 101 ONLY
162	1	2058415	TRANSOM EXTRUSION KIT - 101 ONLY

■ THIS ITEM IS PART OF AN ASSEMBLY.

\*THIS ITEM IS PART OF A KIT AND ONLY LISTED FOR VIEWING PURPOSES.