

# PARTS DIAGRAM & PARTS LIST

## TRAXXIS 55 - 55 LBS THRUST - 12 VOLT - 36" & 42" SHAFT

This page provides Minn Kota® WEEE compliance disassembly instructions. For more information about where you should dispose of your waste equipment for recycling and recovery and/or your European Union member state requirements, please contact your dealer or distributor from which your product was purchased. Tools required, but not limited to: flat head screw driver, Phillips screw driver, socket set, pliers, wire cutters.

### Traxxis 55 Parts Diagram

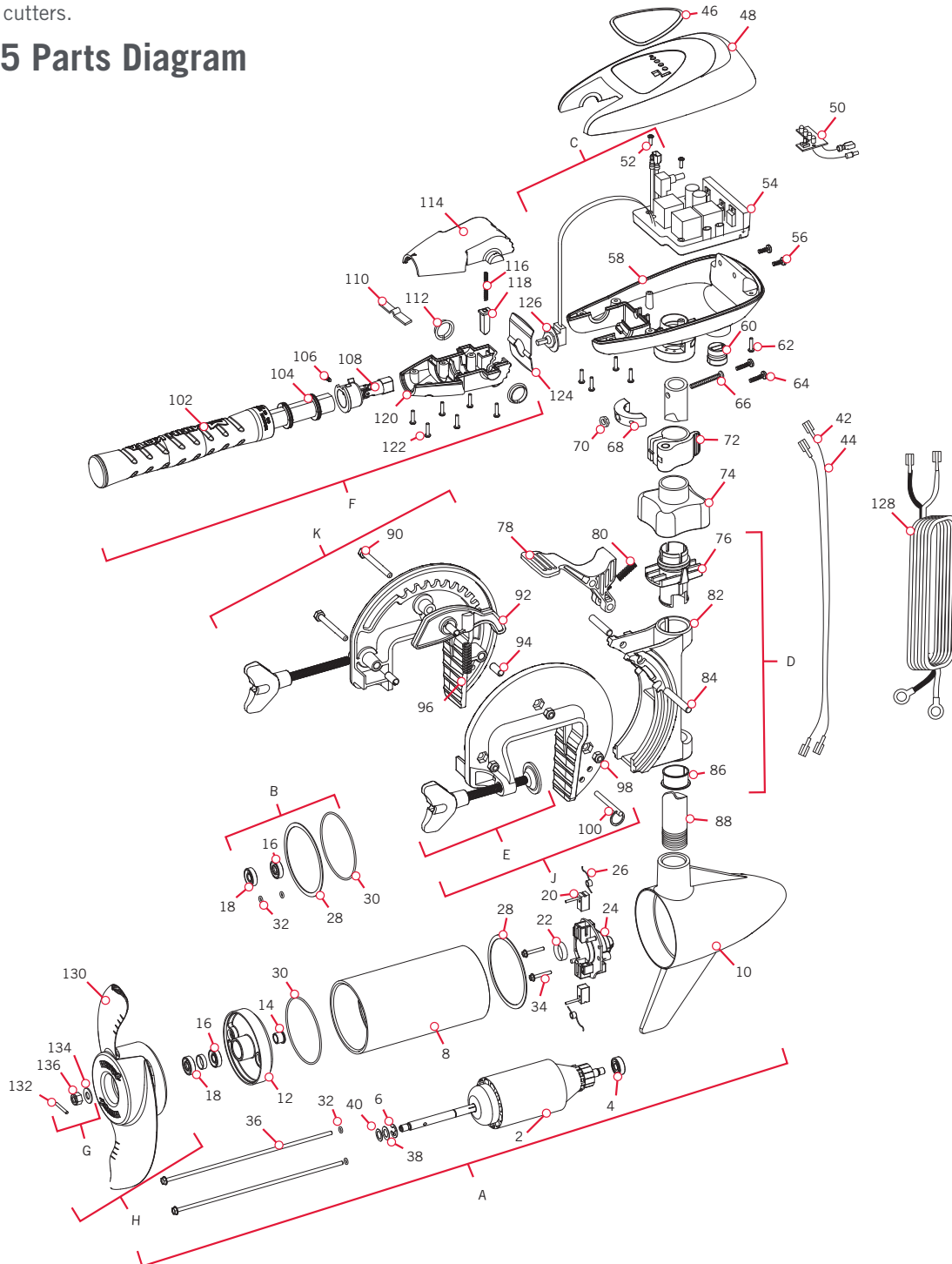

# PARTS DIAGRAM & PARTS LIST

## Traxxis 55 Parts List

Assembly	Part #	Description	Quantity
A	2097074	12V MOTOR 42" FW	1
B	2888460	SEAL AND O-RING KIT	1
C	2888411	POTENTIOMETER REPLACEMENT KIT	1
D	2991795	BRACKET ASSY, COMPOSITE	1
E	2881380	CLAMP SCREW KIT	2
F	2990468	HANDLE ASSY, VARS	1
G	1378170	PROPELLER KIT	1
H	2994875	PROPELLER BAG ASSY	1
J	2771955	BRACKET, LEFT, FW	1
K	2771950	BRACKET, RIGHT, FW	1
Item	Part #	Description	Quantity
2	2-100-121	ARMATURE ASSEMBLY	1
4	140-010	BEARING	1
6	788-015	RETAINING RING	1
8	2-200-101	CENTER HOUSING ASSEMBLY	1
10	421-065	BRUSH END HOUSING ASSEMBLY	1
12	2-400-101	PLAIN END HOUSING ASSEMBLY	1
14	144-049	FLANGE BEARING	1
16	880-003	SEAL	1
18	880-006	SEAL WITH SHIELD	1
20	188-036	BRUSH	2
22	725-050	PAPER TUBE	1
24	738-036	BRUSH PLATE ASSEMBLY	1
26	975-040	BRUSH SPRING	2
28	337-036	GASKET	1
30	701-081	O-RING, MOTOR	1
32	701-008	O-RING, THRU-BOLT	2
34	830-007	SCREW, #8-32	2
36	830-042	THRU-BOLT	2
38	990-067	WASHER, STEEL	1
40	990-070	WASHER, NYLATRON	1
42	640-004	LEADWIRE, BLACK	1
44	640-105	LEADWIRE, RED	1
46	2065772	DECAL, C-BOX COVER	1
48	2060298	C-BOX COVER	1
50	2074070	BATTERY METER, 12V FW	1
52	2043427	SCREW, #8 X 7/8 SS	2
54	2184016	CONTROL BOARD, 12V	1
56	2303434	SCREW, #8-32 X 5/8 SS	2
58	2062536	CONTROL BOX, CAST, FW	1

Item	Part #	Description	Quantity
60	2062905	STRAIN RELIEF	1
62	2303412	SCREW, #6-20 X 5/8 SS	6
64	2063410	SCREW, #10-32 X 3/4" CAP SS	2
66	2093400	SCREW, #10-24 X 1-7/8" PPH SS	1
68	2061527	COLLAR-CTRL BOX (FW)	1
70	2383124	NYLOCK NUT, #10-24, ZINC	1
72	2991521	CAM LOCK/DEPTH COLLAR ASSY	1
74	2060100	KNOB, STEERING TENSION, SOFT	1
76	2068400	COLLET	1
78	2064200	LOCK ARM	1
80	2062701	SPRING, LOCK ARM	1
82	2061821	HINGE	1
84	2062602	PIN, LOCK, ZINC	2
86	2037301	BUSHING, HINGE	1
88	2032052	TUBE 36"	1
	2032053	TUBE 42"	1
90	2063500	BOLT 1/4-20 X 2 3/8", ZINC	3
92	2067905	CAM DEACTIVATOR	1
94	2067306	BUSHING, DOWEL 1/4 X 1/2	3
96	2062702	SPRING, CAM DEACTIVATOR	1
98	2263104	NYLOCK NUT, 1/4-20, ZINC	3
100	2062604	PIN, STOP	1
102	2990456	GRIP/HANDLE ASSY, VARS	1
104	2060015	BEARING, HANDLE	2
106	2063405	SCREW, #6 X 1/2 PFH SS	2
108	2884092	YOKE / SPIDER ASSY, VARS	1
110	2302742	SPRING, DETENT, OFF	1
112	2060005	BEARING, HANDLE PIVOT	2
114	2060900	HANDLE PIVOT, TOP	1
116	2302745	SPRING, RELEASE BUTTON	1
118	2063700	BUTTON, RELEASE	1
120	2060905	HANDLE PIVOT, BOTTOM	1
122	2303412	SCREW, #6-20 X 5/8 SS	6
124	2062715	SPRING, HANDLE PIVOT	1
126	2061700	WASHER, POT HOLDER	1
128	2992523	LEADWIRE ASSY, INCLUDES	1
130	2091170	PROPELLER	1
132	2092600	DRIVE PIN, LARGE	1
134	2151726	WASHER, PROP, STANDARD	1
136	2053101	NUT, NYLOCK, PROP, MEDIUM	1

✘ This part is included in an assembly and cannot be ordered individually.

▲ Not shown on Parts Diagram.

# MOTOR WIRING DIAGRAM

## TRAXXIS

The following Motor Wiring Diagram applies to all Traxxis models that come factory installed with a variable speed switch.

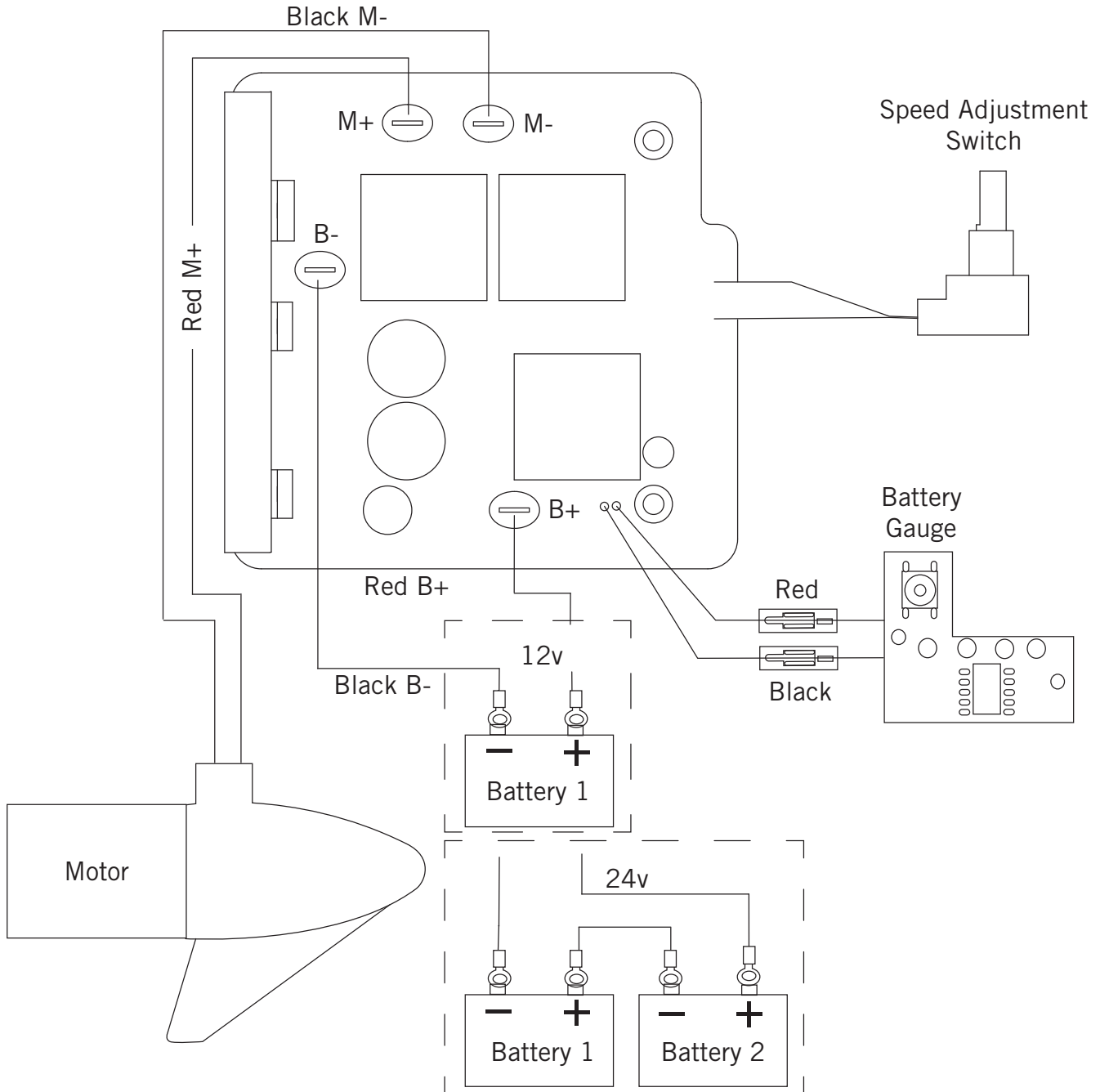

**NOTICE:** This is a multi-voltage diagram. Double-check your motor's voltage for proper connections. Over-Current Protection Devices are not shown in this illustration.