

HermanMiller

Cyclade Occasional Table Installation Instructions (FE1L, FE1M, FE1T, Wood (W) or Stone (S) top)

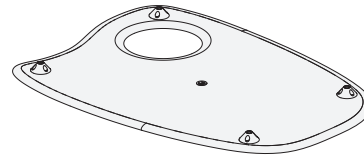

Parts Included



A Cyclade Table Top
QTY 1 (only one top per package)



B Cyclade Leg
QTY 3/4



Cyclade Bowl
(Optional)



How to assemble your occasional table

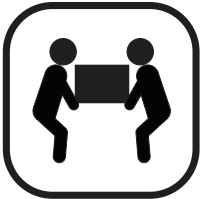

⚠ WARNING

Heavy!
Exercise caution when lifting

⚠ WARNING

Failure to fully tighten legs could result in table failure, legs breaking or other damage.

Step 1

1.1 Place the table top on a clean protective surface top down.

Step 2

2.1 Align leg over assembly hub and lower until internal threaded stud is inserted in center hole of attachment hub.

2.2 Screw the leg into the attachment hub until it cannot be tightened anymore and leg tight against the surface of the top.

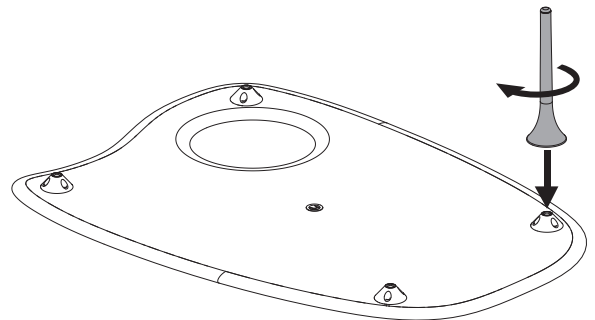
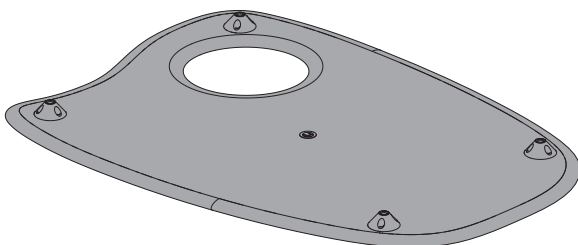

Step 3

3.1 Repeat steps 2 and 3 until all legs are attached and tight.

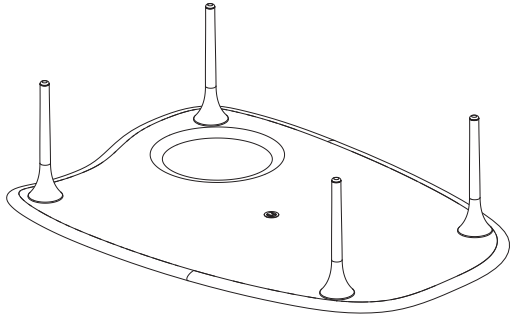

Step 4

4.1 Place table right side up in desired location.

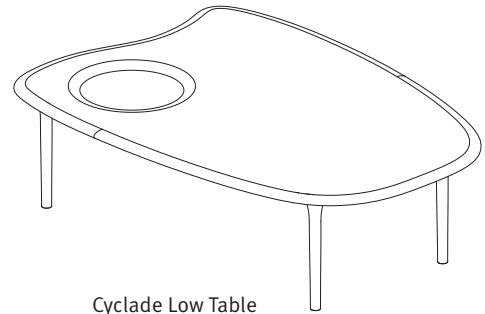

Cyclade Low Table

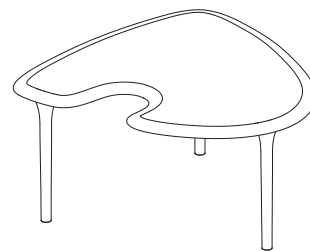

Cyclade Mid Table

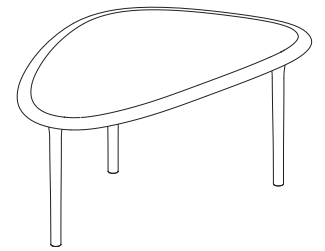

Cyclade Tall Table

Step 5 (Optional)

5.1 Lower the Cyclade bowl gently into the opening in your table.

Note: Install Cyclade Glass Bowl (if applicable) into center of the low height table.

