

±130 (5.1')

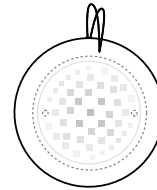

114 (4.5')



±150 (5.9')

- PENDANTS: one
- MOUNTING: metal mounting plate 114mm (4.5") in diameter
- LAMPING: 1w LED
- INSTALLATION: threaded on - wall or ceiling mount
- MATERIALS: blown glass, copper mesh, electrical components, metal mounting plate
- WEIGHT: approximately 0.7kg (1.5lb)
- POWER SUPPLIES: integral (driver housed within junction box). Drivers included

DESCRIPTION

The 'sp' designation in this variation on the 76 refers to it being surface-mounted, with a mounting plate large enough to cover a standard North American junction box. This surface light has a paintable 114mm (4.5") in diameter mounting plate designed to be mounted on walls as well as ceilings.

A vacuum is introduced to a strata composed of hot white and clear glass with copper mesh between. The vacuum causes the white layer to pull away through the embedded mesh, leaving numerous tendrils of white glass suspended within an interstitial space as it goes.

NOTES

- + Purchase replacement lamps online at www.bocci.com/shop/bulbs
- + Unless otherwise specified, a single class 2 driver will be sent for every 15 LED fixtures
- + Requires drivers to be remote mounted.
- + Please note that the copper mesh used within the 76 may be affected by heat and oxidization during the glass blowing process. These small oxidized edges can sometimes separate within the pendant; this is a natural characteristic of the metal and is seen as an evolution of the piece as it ages.

US Patent # D817,524 S
EU Design Patent # 002840975-0004-0007

Made in Vancouver, Canada

Vancouver
sales@bocci.com
www.bocci.com

Berlin
europe@bocci.com
www.bocci.com

approx 0.7kg (1.5lb)



SURFACE LIGHT - PRINTABLE LARGE PLATE

76sp

PRODUCT SPECIFICATION

© 2021, Bocci Design and Manufacturing Inc. All rights reserved. Any inquiries should be directed to: info@bocci.com

BOCCI

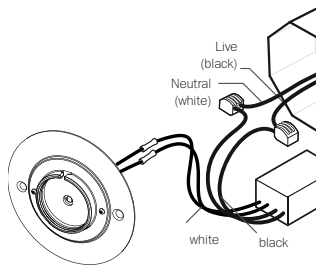

1

The 76sp can be directly mounted to a junction box.

Connect the black wire to live wire and white wire to neutral wire.

Join driver wiring to cover plate wiring using connectors provided.

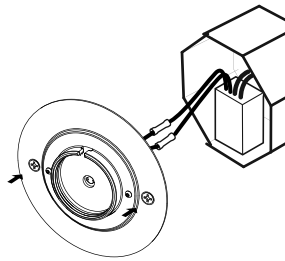

2

Tuck the driver and wiring into the octagonal box. Lining up the fastener holes. Affix surface mounted plate with fasteners provided.

Turn power to fixture on.

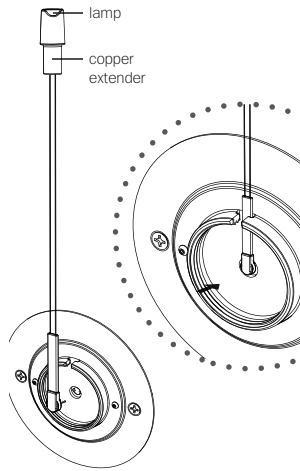

3

Boccì 1w LED lamp included.

Insert LED lamp into flexible copper extender.

Push the flexible copper extender wires through the open slot on the sconce plate and plug end into the sconce socket.

Ensure power to lamp is working correctly.

Note: when using a dimmer use only low voltage electronic dimmers to ensure the fixture works properly.

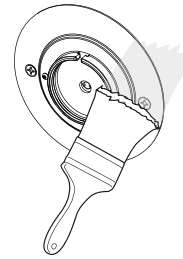

4

Paint over the cover plate to match the wall finish.

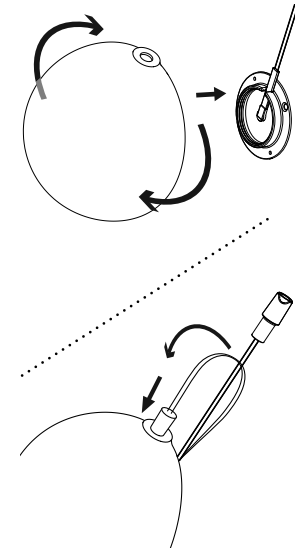

5

Hold lamp wires against the wall to ensure they do not interfere with spinning glass.

Gently thread glass hemisphere onto cover plate. Do not over tighten.

Bend the insulated wires and insert the lamp into the small hole in the pendant. Ensure that the lamp does not touch the inner glass bubble.

Note: when using a dimmer use only low voltage electronic dimmer.

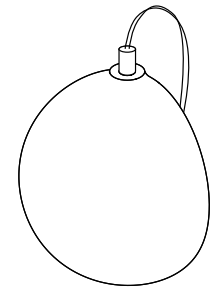

6

Clean fingerprints from surfaces.

For additional assistance, please contact Boccì:

Vancouver
sales@bocci.com
www.bocci.com

Berlin
europe@bocci.com
www.bocci.com

US Patent Pending

EU Design Patent # 002840975-0004-0007

Made in Vancouver, Canada



SURFACE LIGHT - PRINTABLE LARGE PLATE

76sp

PRODUCT INSTALLATION INSTRUCTIONS

© 2021, Bocci Design and Manufacturing Inc. All rights reserved. Any inquiries should be directed to: info@bocci.com

BOCCI