

116 (4.5")  
 40 (1.6")  
 adjustable  
 3000 (10')  
 6000 (20')  
 15000 (49')

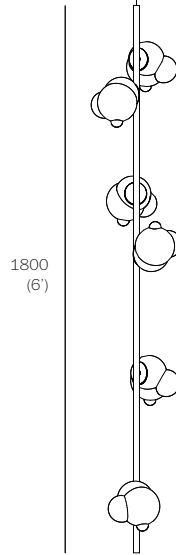

1800 (6')



±100-165 (4-6')

approx 10.4kg (23lb)

PENDANTS: six  
 MOUNTING: deep white canopy 116mm (4.5") in diameter x 40mm (1.6") deep  
 LAMPING: 1.5w LED  
 CABLE LENGTH 3m (10') / 6m (20') / 15m (49')  
 STEM LENGTH 1.8m (6') long stem  
 MATERIALS: blown and dipped grey or white opaline glass, electrical components, black or white canopy  
 WEIGHT: approximately 10.4kg (23lb)  
 POWER SUPPLIES: integral

#### DESCRIPTION

The stem cable suspended vertical system comes in a black or brass stem with a 116mm (4.5") diameter white or black canopy rated for ceiling use.

57 is an exploration of a technique used for producing closed cell foam. The process involves trapping voids of air of different sizes and configurations within a glass matrix, yielding a shape loosely referencing a rain cloud. These pockets of air remain invisible when the piece is off, but come alive to reveal an interior universe when the piece is illuminated. By virtue of the fabrication process, each piece is completely unique.

#### NOTES

- + Purchase replacement lamps online at [www.bocci.com/shop/bulbs](http://www.bocci.com/shop/bulbs)
- + **The brass used in our Stem Series is untreated and, as such, will develop a natural patina over time. To avoid any marking or tarnish on the brass during handling and installation, please use the gloves provided in your shipment.**

US Patent # D796732  
 EU Design Patent # 002268581-0001 to 0006

Made in Vancouver, Canada

Vancouver  
[sales@bocci.com](mailto:sales@bocci.com)  
[www.bocci.com](http://www.bocci.com)

Berlin  
[europe@bocci.com](mailto:europe@bocci.com)  
[www.bocci.com](http://www.bocci.com)

STEM - CABLE SUSPENDED, VERTICAL

57.6

Design by Omer Arbel  
 PRODUCT SPECIFICATION

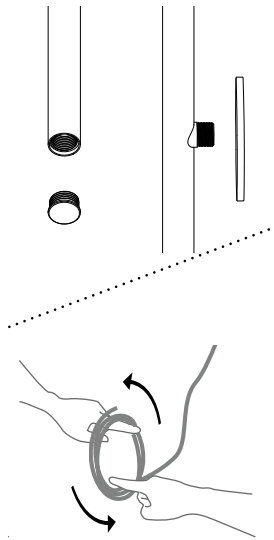

1

Thread the cover cap and the pendant mounting plates onto the stem.

Very carefully uncoil the braided coaxial cable in a spool like manner. Insert your index fingers into opposite sides of the roll then rotate your fingers around each other to unroll the coaxial cable.

Use patience: allow the cable to uncoil completely to avoid kinks.

Note: Bocci recommends wearing thin gloves during installation to protect the stem finish and the glass surface.

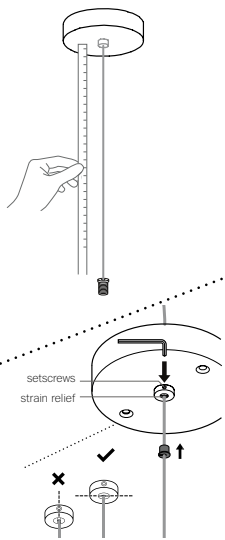

2

Determine the overall drop.

Feed coaxial cable into canopy and set the length with set screw.

Note: this portion of the install will be done on the ground.

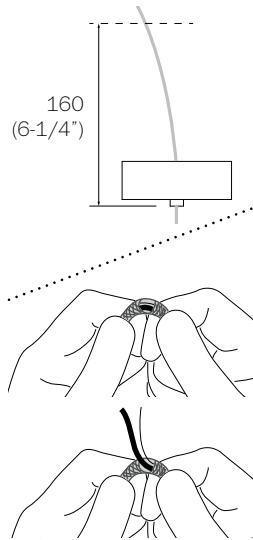

3

Leave a minimum 160mm (6-1/4") cable for next step.

Using a tool or your hands, pry a small hole in the braided cable to expose the two cables inside. Pull out the insulated cable and the aircraft cable.

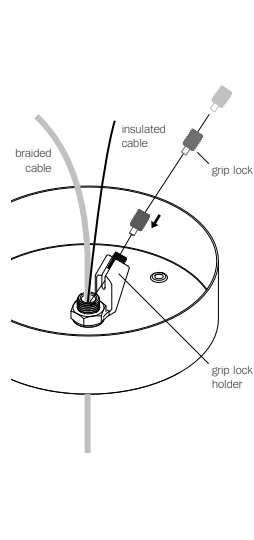

4

Thread the griplock through the aircraft cable and slide the aircraft cable into the griplock holder located inside the canopy.

Push (tighten) the griplock against the holder so the griplock partially rests in the holder.

This aircraft cable provides primary support for the fixture.

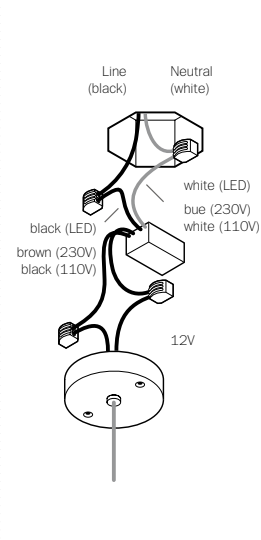

5

Connect power supply to line voltage.

i. Connect input low voltage wire to 12V DC output wires.

ii. Connect the black wire to line wire and white wire to neutral wire.

iii. Ensure that line voltage is not active during this part of the installation!

Note: As an option, Bocci recommends mounting power supplies remotely in a close, accessible and hidden location for ease of long term maintenance. Installation to be done by certified personnel to ensure compliance with the code.

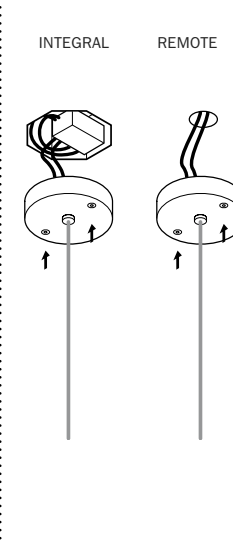

6

The client is responsible for ensuring fasteners are attached to a robust structural substrate.

Affix mounting plate to surface with fasteners provided.

Note: Gently pull the coax cable to make sure cable is secured before attaching the canopy to the ceiling.

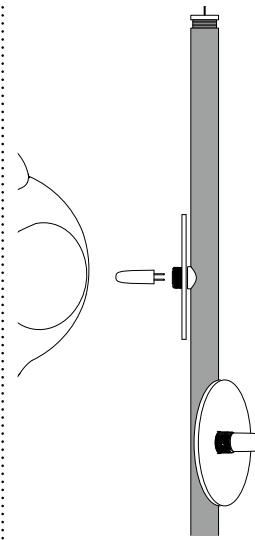

7

Thread the stem onto the connector that is located at the end of the coax cable.

Carefully insert provided lamps into sockets. Check that each lamp is working properly as you go along by keeping power to the fixture on.

Thread pendants onto mounting plates end.

Clean fingerprints from fixture surfaces.

For additional assistance, please contact Bocci:

Vancouver  
sales@bocci.com  
www.bocci.com

Berlin  
europe@bocci.com  
www.bocci.com

STEM - CABLE SUSPENDED, VERTICAL

57.6

Design by Omer Arbel  
PRODUCT INSTALLATION INSTRUCTIONS

© 2020, Bocci Design and Manufacturing Inc. All rights reserved. Any inquiries should be directed to: info@bocci.com

**BOCCI**