

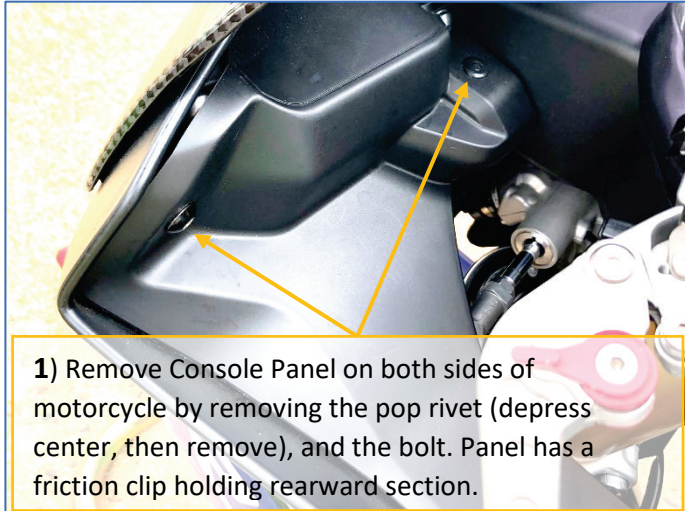

CUSTOMLED 2015+ YZF-R1/M Blinker Genie

Illustrated Installation Instructions

This 100% plug-and-play kit allows for run and turn operation of the OEM pilot light assemblies ☺



1) Remove Console Panel on both sides of motorcycle by removing the pop rivet (depress center, then remove), and the bolt. Panel has a friction clip holding rearward section.

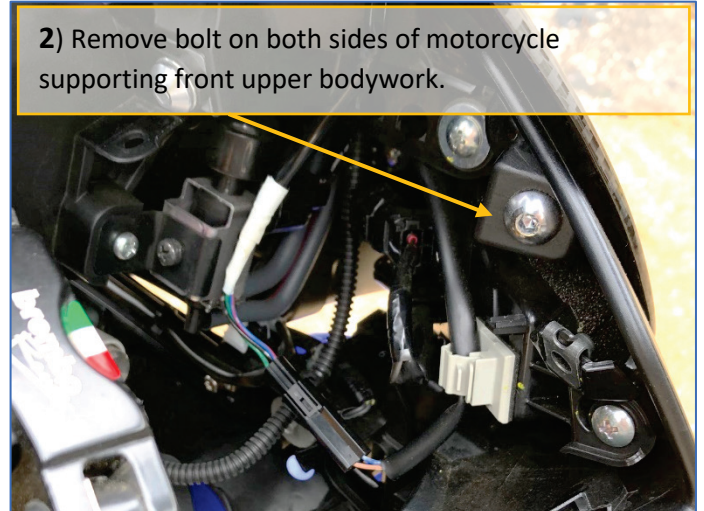

2) Remove bolt on both sides of motorcycle supporting front upper bodywork.

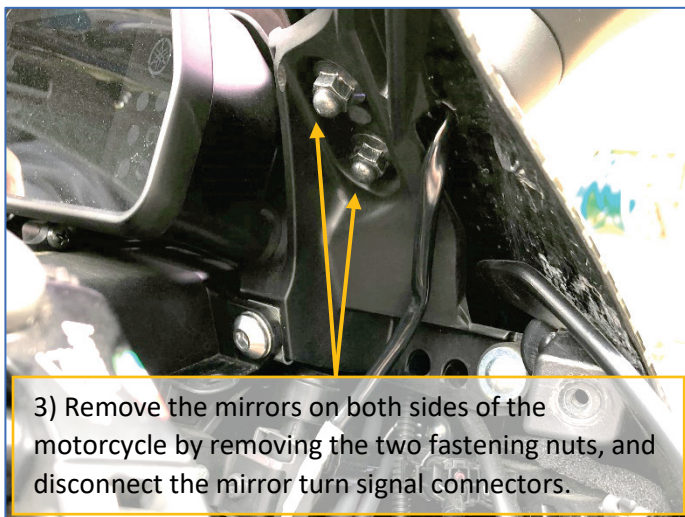

3) Remove the mirrors on both sides of the motorcycle by removing the two fastening nuts, and disconnect the mirror turn signal connectors.

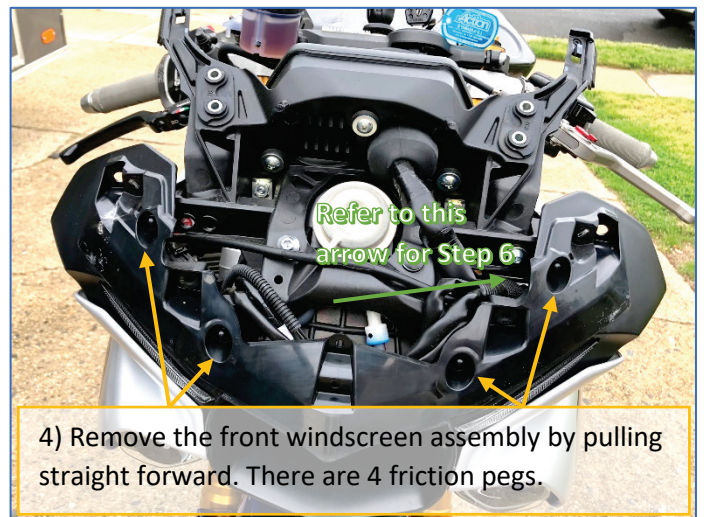

4) Remove the front windscreen assembly by pulling straight forward. There are 4 friction pegs.

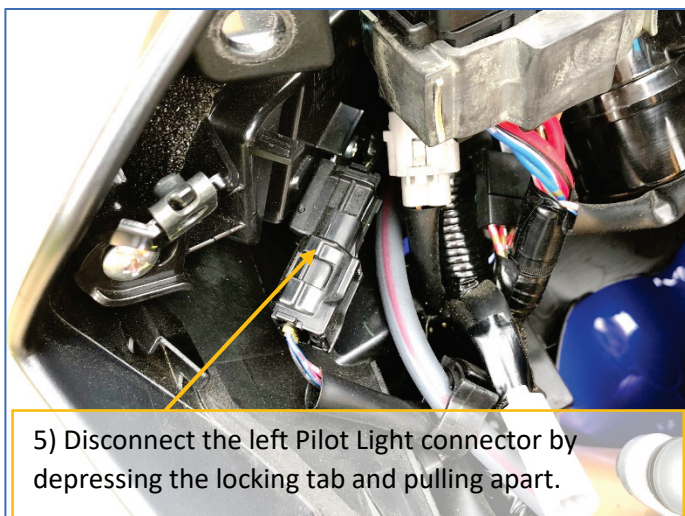

5) Disconnect the left Pilot Light connector by depressing the locking tab and pulling apart.

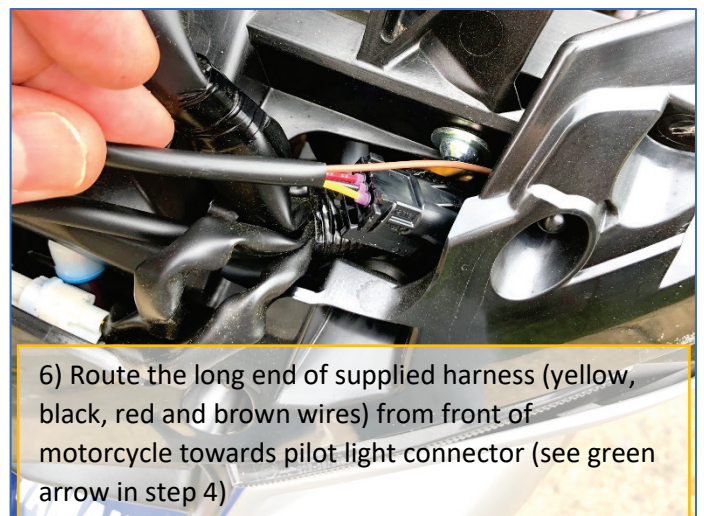

6) Route the long end of supplied harness (yellow, black, red and brown wires) from front of motorcycle towards pilot light connector (see green arrow in step 4)

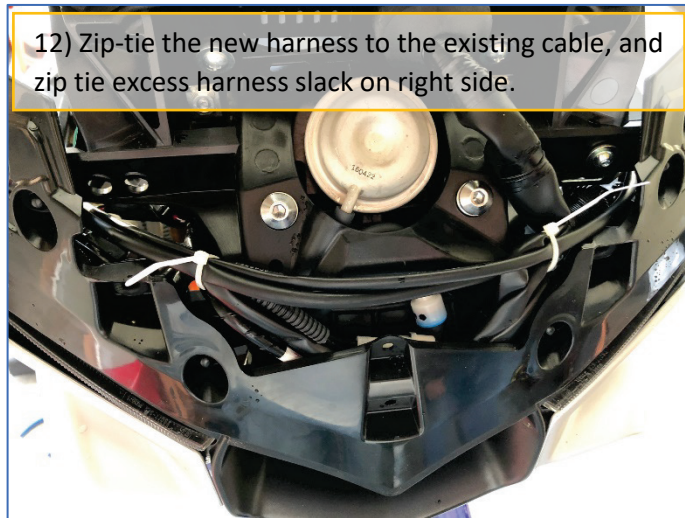
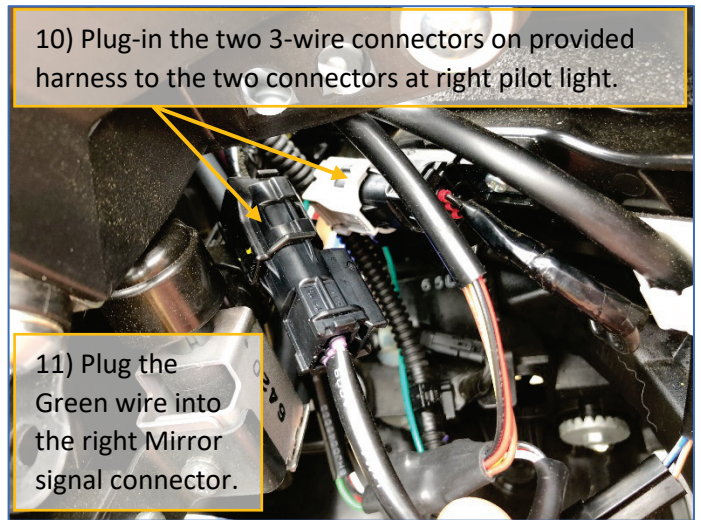
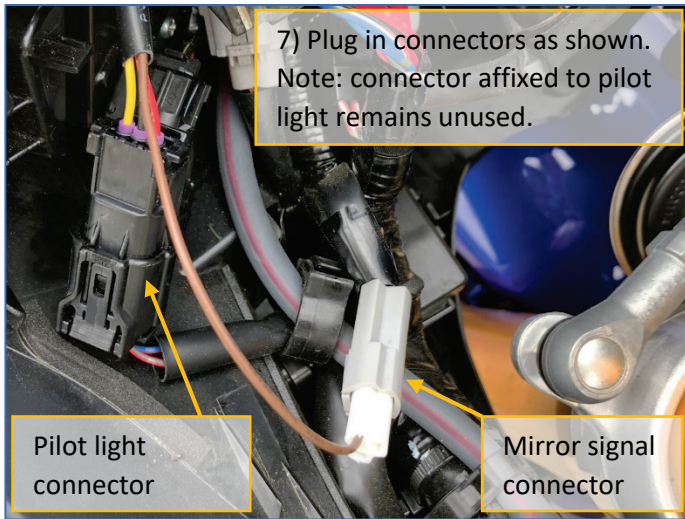

13) Reinstall windscreen assembly.

14) Reinstall mirrors (if desired) **or** install mirror block-offs to support windscreen properly. If you have also purchased the turn signal Y-splitters, install them on the turn signal connectors to attach the mirror lamps AND the harness brown and green wires.

15) Reinstall the left and right console covers.

Thank you for choosing Custom LED, and supporting USA manufacturing. Please help spread the word! You can share Video of this product in action on **YouTube**, and share your pre and post-install pictures on **Instagram**. Be sure to tag us **@Custom_LED_LLC** in the pictures so they will appear on our website Instagram feed!