

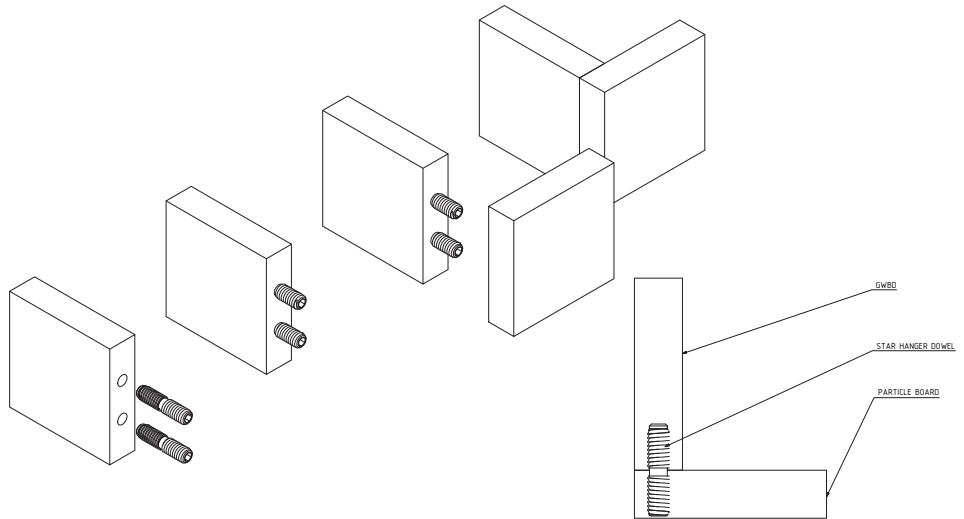

### DESCRIPTION

The 440 Backsplash Dowel is an 8MM Sharply ribbed steel dowel fits into drilled holes in both the top of the Countertop and Backsplash. The dowels are inserted and bottom of the backsplash is coated in Silicone glue and pushed down, the steel ribs hold the backsplash in place until the glue sets. The 440 Backsplash Dowel provides a mechanical lock and when set into a bed of caulk (as per AWI Premium Grade installations) provides the highest possible performance.

The clip offers a quick and efficient means of providing a mechanical connection between the backsplash, the counter, and the backing wall surface. The strength of the clip the full silicone seal ensures a tight connection between the backsplash and the counter, allowing for a minimum visible caulk line, and a reliable long lasting seal, especially over extended periods of time. (Common problems associated with shifting and settling are avoided.) Complies with AWI Premium Standards for mechanical connections.

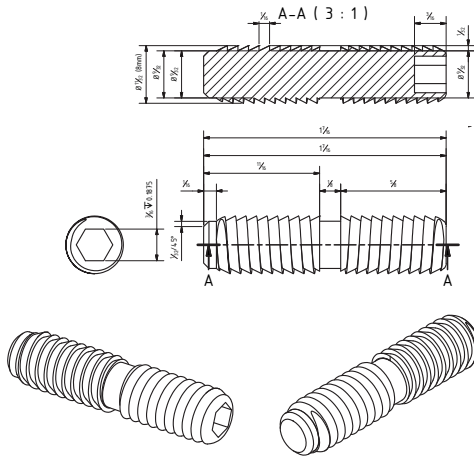

### SPECIFICATION

**MATERIAL:** The dowels are mild steel with a zinc coating

**BENEFITS:** Over time cabinets and floors begin to settle, causing gaps between the countertop and backsplash. These gaps allow water to contact the particleboard, the particleboard swells and the gaps open wider. The gaps causes a self destructive cycle that is very difficult to stop. The 440 Backsplash Dowel provides a mechanical lock and when set into a bed of caulk as they provide a mechanical lock and a water resistant seal that stops the gaps that allow water in. (per AWI Premium Grade installations)

**LOAD:** Pulls out at 50 pounds

### INSTALLATION

The 440 Backsplash Dowel is an 8MM ribbed steel dowel fits into drilled holes in both the Countertop and Backsplash. A Star Drill Fixture is needed to accurately place the holes in the low points of the countertop.

The bottom of the backsplash must be fully coated in Silicone glue and pushed down, the steel ribs hold the backsplash in place until the glue sets.

The field installation is a one step process both installation and caulking can be finished and cleaned up on the same day. (AWI Premium Grade installations).

Please see [www.Starhanger.com](http://www.Starhanger.com) > Technical for complete Installation Guide

### OTHER BACKSPLASH DOWEL RESOURCES

**SHOP DRAWINGS:**

<https://www.starhanger.com/pages/downloadable-drawing>

**INTRODUCTION ANIMATIONS:**

<https://www.starhanger.com/pages/animation-videos-info>

**INSTRUCTION VIDEOS:**

[www.starhanger.com/pages/installation-videos](http://www.starhanger.com/pages/installation-videos)

**PRODUCT SPECIFICATION:**

[www.starhanger.com/pages/product-specifications](http://www.starhanger.com/pages/product-specifications)

**SALES & GENERAL QUESTIONS:**

Sam Porter, P. 803-250-9608 E. [sporter@starhanger.com](mailto:sporter@starhanger.com)

**TECHNICAL QUESTIONS:**

Charles Porter, P. 803-730-4463 E. [cporter@starhanger.com](mailto:cporter@starhanger.com)

### STRENGTH TESTING

With 3/4" - 45 lb. particle board:

- Tensile Failure (Horizontal pull) Failure = 40 lbs. / Working Strength, Pull out from Countertop = 10 lbs.
- Shear Failure (Vertical weight holding) Failure = 200 lbs. / Working Strength, Weight holding = 40 lbs. Pull up from Countertop

### USEFUL ACCESSORIES:

Backsplash Dowel, Drill Fixture SKU, ???

Backsplash Dowel Jig, SKU ??

Panel Adjuster, SKU 920

**ORDER:** BACKSPLASH DOWEL, SKU 440