

# Star Hanger SYSTEMS

"Hidden Fastener Specialists" | [www.starhanger.com](http://www.starhanger.com)

## 420 S CLIP & LONG BARS, INSTALLATION GUIDE

1



Required Tools; 420 S Clip, 421 S Alignment Clips, Panel Adjuster, 1/32" plastic laminate, Spray Contact Cement, Panel Adhesive.

2

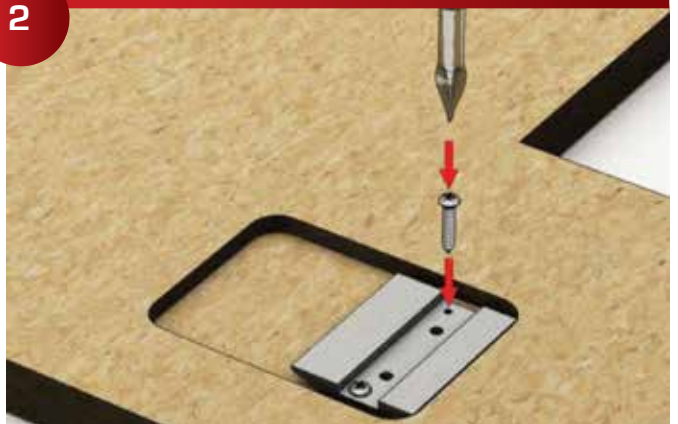

When using pre-engineered, field verified, CNC cut furring, the panel clips are pushed firmly to the bottom of the clip pocket.

3

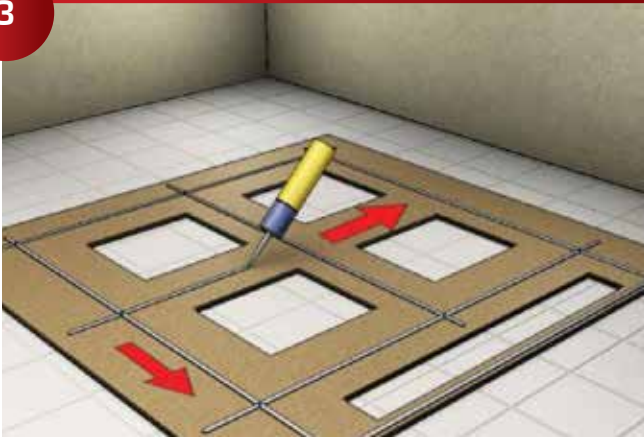

Full size furring sections can be pre-glued and shimmed into place.

4

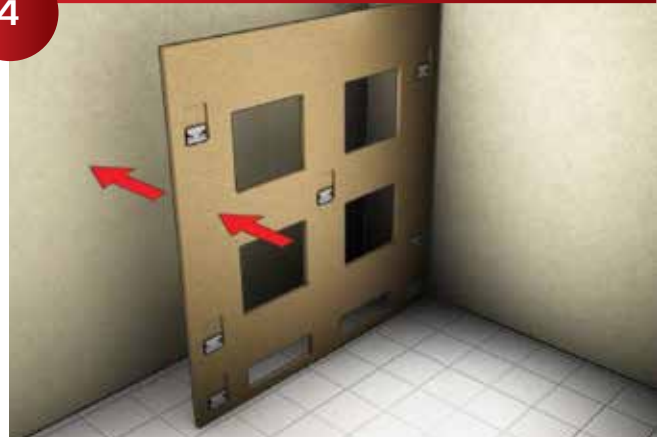

Install the corner furring sections to the field control lines.

5



Level and square the corner furring sections with shims and screws as required.

6



Use a string line to straighten the pre-cut furring. (Tip: If you have pre-glued the furring panels, you need to work quickly.)

13

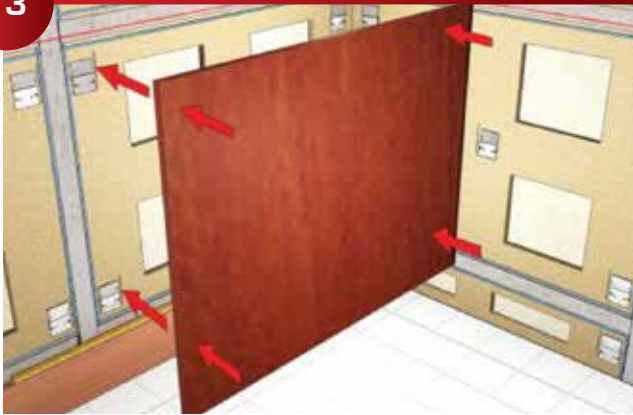

Carefully position your panel over the 421 S Alignment Clips and push them firmly enough to leave a location mark for the mounting screws.

14

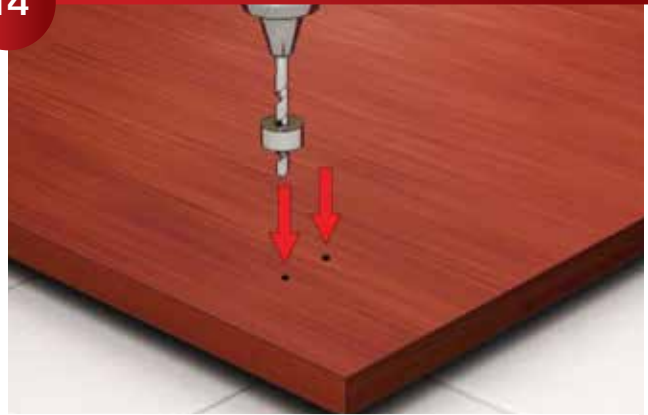

Pre-drill with a 1/16" drill on the back side of the panel at each location mark.

15



Insert supplied screws.

16



Lift the panel into place about 1/2" above marks, push in and down firmly to lock the panels into their final position.

17



Finished paneled wall.