

1



Find a beautiful yacht that needs new Upholstered seat cushion, (this is the hardest part).

2



Carefully space the locations for each cushion.

3

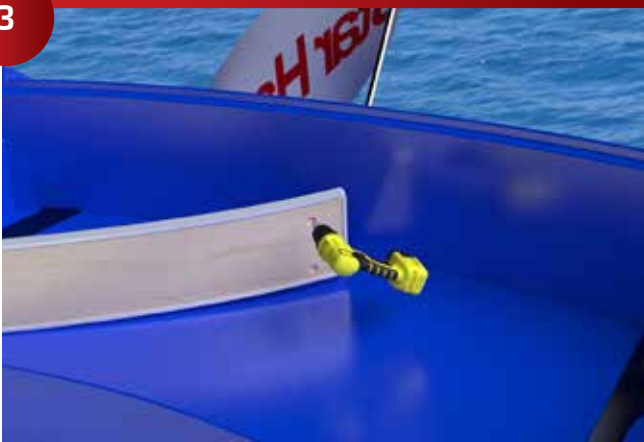

Drill a 1-1/4" hole x 3/8" deep for each Galaxy.

4



Insert the Galaxies into place, this can be done with a soft blow hammer or specialized tools form Star Hanger.

5



Install the Galaxy Alignment Pins into place, they can be removed with pliers or a pry bar.

6



Carefully align the cushion into place and push it firmly to mark the screw positions.

7

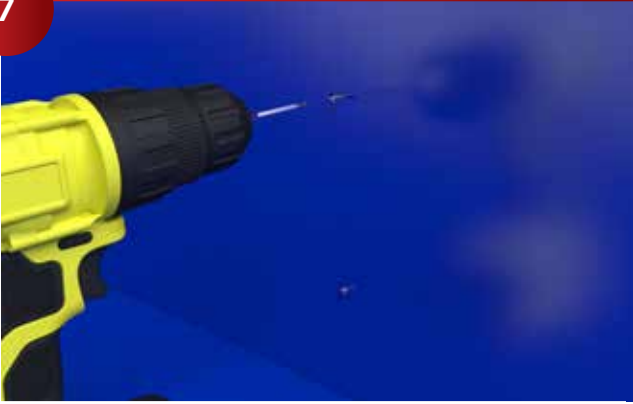

Predrill with a 1/8" Hole. Install stainless steel screws into the fiberglass.

8

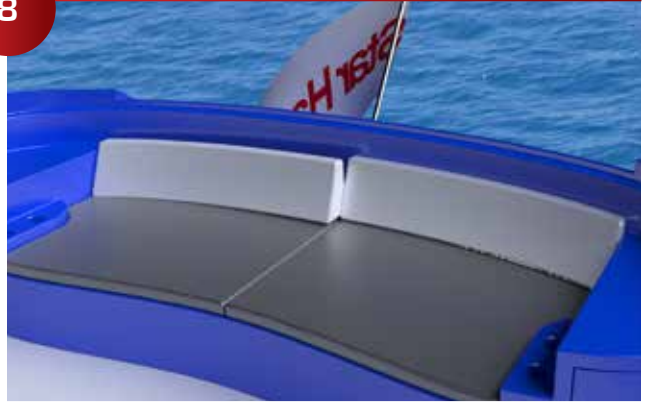

Install cushion, you should hear each Galaxy snap into place.

9

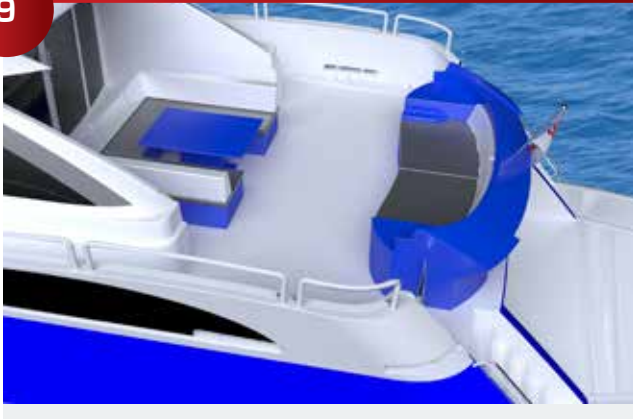

Completed cushion can be stored flat with no hardware projecting.