

1

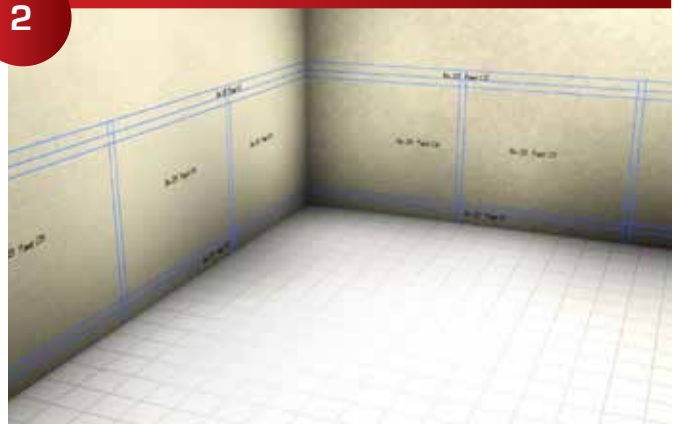

Required Tools; 200 Hangers, 211 Alignment Pins, Contact Cement Spray, 1/32 Revel Material, Dead Blow Hammer, Panel Adjuster, Drill, 1-3/8" Hole Saw.

2



Layout the position of the reveals on site, adding 1" to the width of the chalk line and the width of the reveal.

3

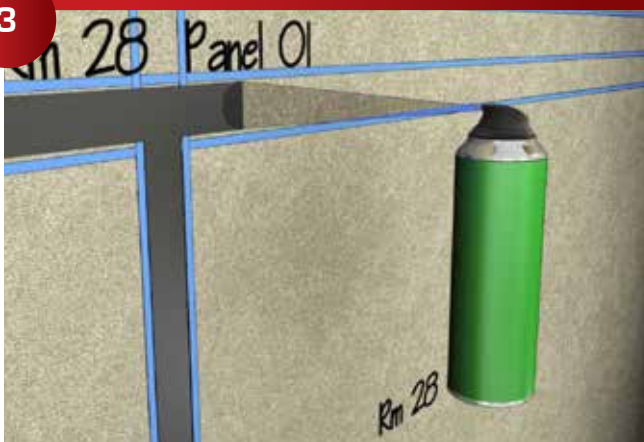

Paint the reveals.

4



Drill the 1 3/8" diameter holes through the sheet rock, as needed. (TIP: Exact location is not required.)

5



Insert the 200 Hanger into the pre-drilled hole. (TIP: If you hit a stud, cut off the back arms and remove the wings of the 200 Hanger for a flush fit.)

6



Use an electric drill to lock the 200 Hanger into place. Set drill for minimum torque.

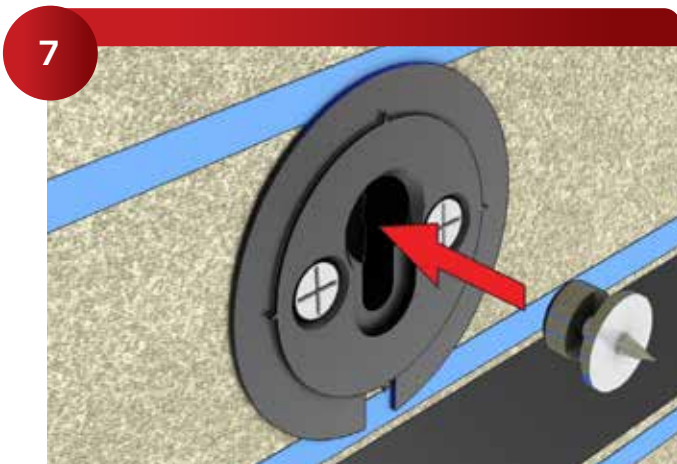

Place 211 Alignment Pin into the 200 Hanger.

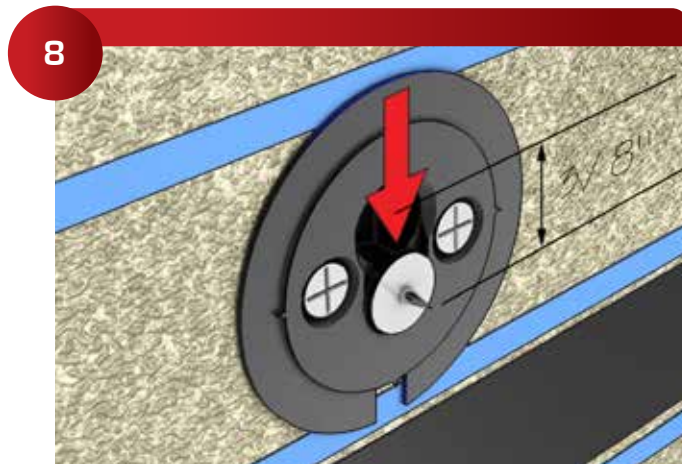

Push the 211 Alignment Pin down. (**TIP:** If the pin fits loosely, use tape to better hold the pin if needed.)

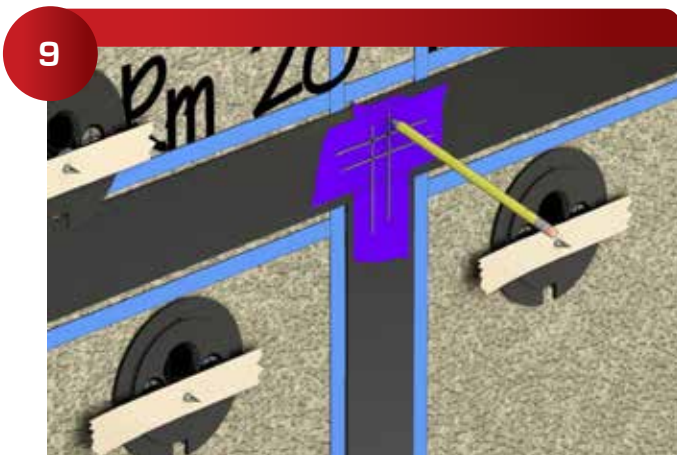

Place blue tape over the corners of the reveals and mark the exact position of the panel.

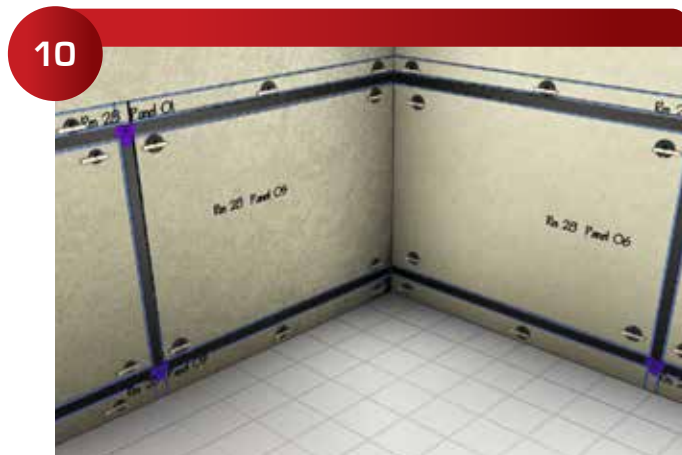

Carefully measure and number each panel and place panel order.



Carefully position your panel over your 211 Alignment Pins and push them firmly to leave a location mark for the 3/16" Mounting Screw.

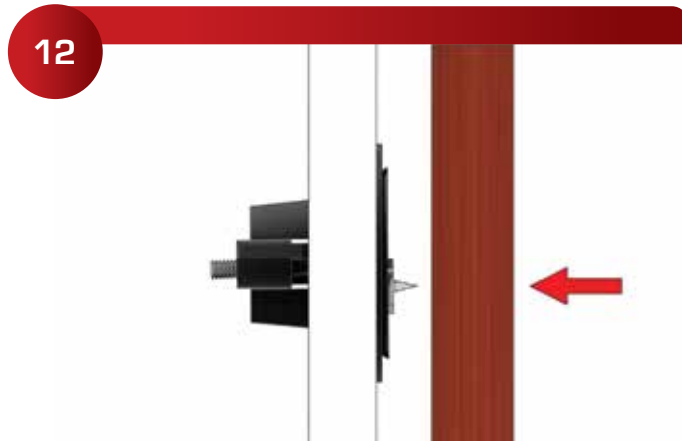

(**Useful Accessories:** Star Hanger sells the 210 Hanger Shim 1/32" it is available to help with dips in the wall.)