

Star Hanger SYSTEMS

"Hidden Fastener Specialists" | www.starhanger.com

320 ZERO, RECEPTION DESK INSTALLATION GUIDE

1



320 Zero, 330 Alignment Pins, 349 Upholstery Mount, 910 Forster Drill Bit 1", 913 Pilot Drill 5MM & Stop, Dead Blow Hammer or 305-320 Hammer Head for Zero, Panel Adjuster, 1/32" plastic laminate, Spray Contact Cement, Panel Adhesive

2



This is a CNC cut in plant die wall Reception Desk, it is designed to quickly assembled.

3



320 Zero inserts fit into a 1" hole, they can CNC cut into the panels or drilled into the panels.

4

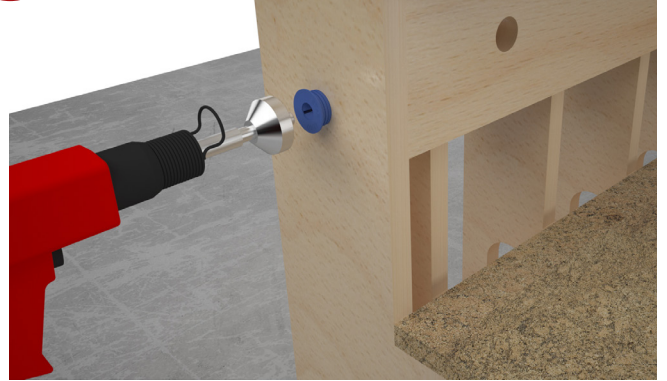

You can use a dead blow hammer or pneumatic hammer to insert the 320 Zero at all corners of the panels to install the inserts.

5



Place 330 Zero Alignment Pins on each individual panel's set of inserts (the Alignment Pins are reusable).

6



Carefully push the panel into the 330 Zero Alignment Pins to mark the Zero's mounting screw locations. If needed install the reveal laminate in the reveal locations as needed.

7



In this case, we are showing tackable fabric wall panel with a Galaxy 227 in the panel and a 349 Upholstery Mount for easy removal.

8



The back panel is a 1/2" thick high-density mineral board core tackable fabric wall panel. The soft cores generally requires the insert be installed with epoxy poured around the core to make the panel removable.

9



The 320 Zeros have a 1/40" rim, the thin reveal laminate can be 3 ply plywood or horizontal grade plastic laminate. Reveals can be quickly fit and installed.

10



Carefully push the panels into the 330 Zero Alignment Pins to mark the Zero's mounting screw locations. Next drill the 5mm holes for the 334 Mounting Screws in the position indicated by the alignment pins.

11



Push the wood panels straight into place, panels can be easily removed with a glass suction cup, or a plastic pry bar.

12



Completed Tackable Fabric Panel System.