



7



Set the panels on top of the reveal strips and push them firmly into the drywall to mark the locations for the 236 Combination Screws.

8

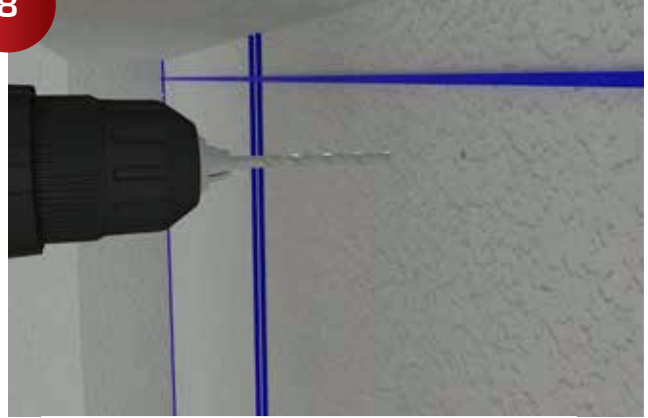

Drill a 5/16" hole in the positions indicated by the 211 Alignment Pins

9



Install 952 Pop Toggle and 236 Combination Screws. Push red the setting stick into the 952 Pop Toggle to force the arms to pop out in the back. Using a drill set on low torque gently snug the screws. (TIP: Do not over tighten the screw, it can compress into the sheetrock.)

10



The reveals can be quickly painted, or you can use 1/32" plastic laminate with contact cement.

11



To install the panels they must be carefully realigned with the mounting screws. Then push them straight into place firmly, you should hear them click and lock in position. (TIP: Use reveal spacers to quickly locate the position of the panel.)

12



The panels are permanently removable for maintenance. The Galaxies are not suitable for frequently used access panels.

1



Required Tools; 226 Galaxy, 229 Galaxy Alignment Pins, 239 Machine Screws, Dead Blow Hammer or 965 Galaxy Hammer, 917 Drill & Tap combination, 10-24 Thread, 911 Carbide Tipped Drill 1-1/4" Forstner Drill

2



Determine the location of the sign and lightly mark the location, use tape on the door if it's too hard to mark.

3



The 226 Galaxy can be field installed using a 911 Carbide Tipped Drill 1-1/4", Forstner Drill

4

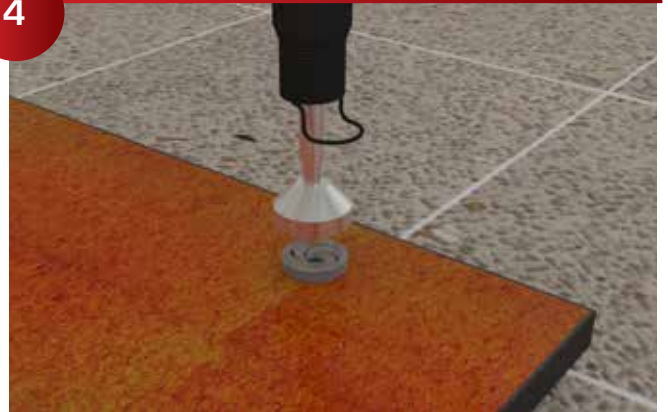

The 226 Galaxy can be plant installed flush with the back of the sign, allowing signs to be shipped flat with the hardware installed. A plant prepared CNC cut sign and layout template, including the centers for the mounting screws, makes the field installation very quick.

5



Place 229 Galaxy Alignment Pins in each 226 Galaxy to mark the sign. Alignment Pins are reusable.

6



Carefully place the sign in the correct position and bump the sign in each corner to mark the location of each mounting screw.