

Star Hanger SYSTEMS

"Hidden Fastener Specialists" | www.starhanger.com

210 LOCK, PANELS FIELD FURRING INSTALLATION GUIDE



Required Tools; 210 Lock, 211 Alignment Pins, 910 Carbide Tipped 1" Forstner Drill, Center Point Drill, 920 Panel Adjuster, 1/32" plastic laminate, Spray Contact Cement, Panel Adhesive.



Determine greatest projection (bump out in wall) to determine face of panels on a floor layout. (Working Plane)

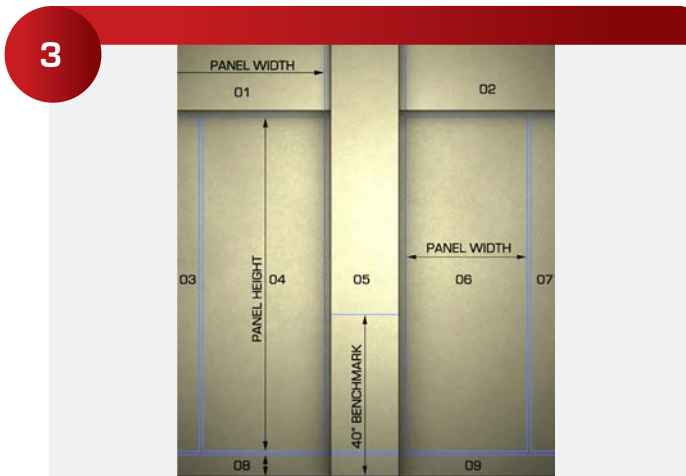

Field verify all required site dimensions based on face of panels for both field horizontal & vertical lines, revise shop drawing for production.



Preassemble the vertical furring corners (if any) and install them to use as a guide for the horizontal furring.



Using string lines or a laser, shim, glue, and screw all horizontal furring into place.

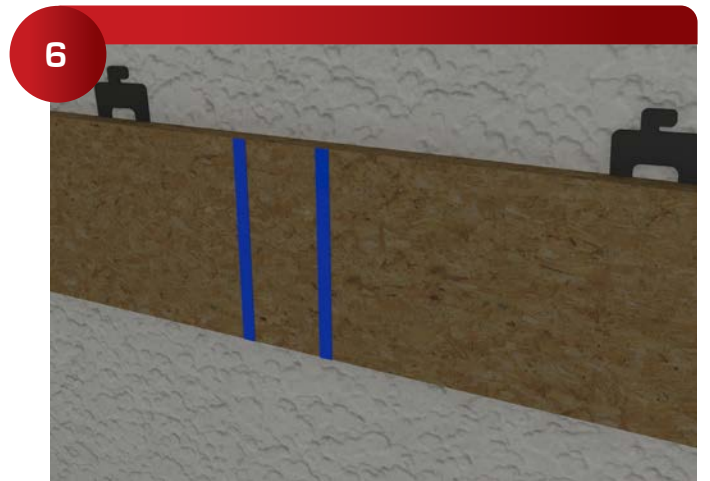

Transfer the revised shop drawing panel sizes to the face of the furring.

7



Insert the 210 Lock at 24" on center or as needed. The Locks can be drilled to 1" with a 910 Carbide Tipped 1" Forstner Drill, Center Point Drill

8

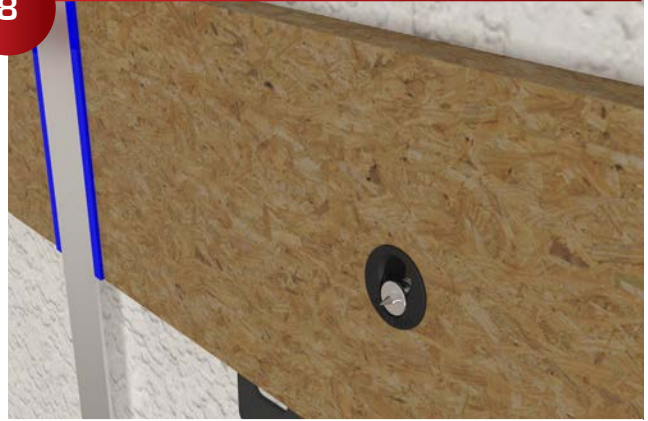

Place 211 Alignment Pins in each Lock needed to mark one full panel. (Tip: 211 Alignment Pins are reusable.)

9

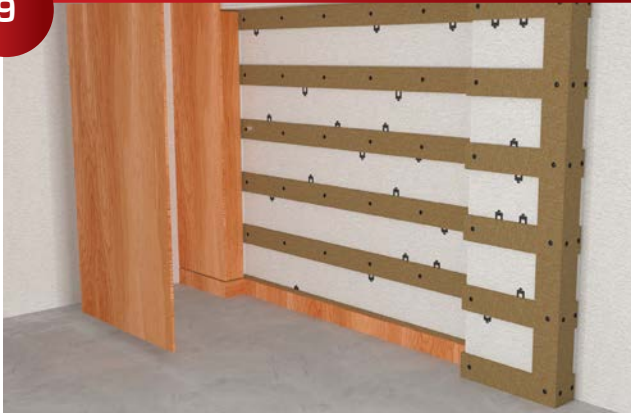

Place reveal spacers between panels to locate the exact panel positions. Carefully push the panel into the 211 Alignment Pins to mark the Lock positions.

10



Drill a 5MM hole in the positions indicated by the 211 Alignment Pins, and install the Mounting Screw

11



Set the panels by firmly pulling them down until they bottom out on the clips. (Tip: It is good practice to use a dab of silicone on the center clips to prevent movement.)

12



Completed Panel System.