

1

LAYOUT

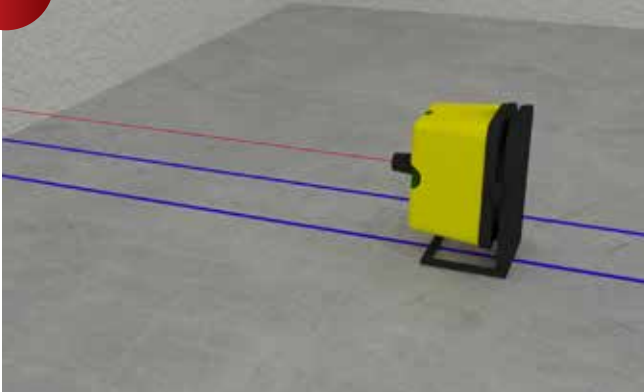

Complete the track lay out per industry practices Typical Erection Tolerances. B. Maximum Variation, 1/8 inch in 10 feet (3 mm in 3 m). Typical Material Selection: 16" OC, 5/8 Rock, Web Depth: 3-5/8", 18 gauge. Paint the floor to denote this section has special specification WD-1.

2

TRACK

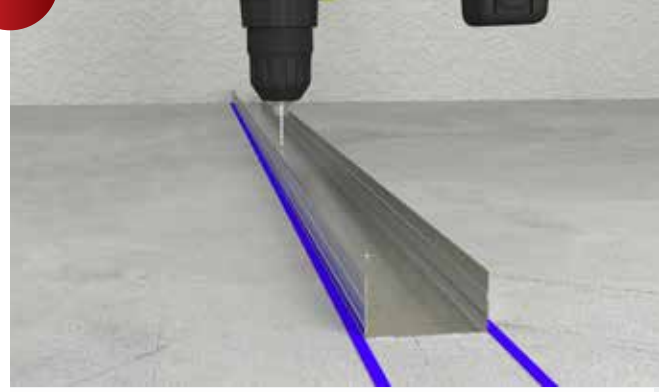

Butt all track joints. Securely anchor abutting pieces of track to a common structural element, do not splice or overlap because that bulges out the track.

3

STEEL STUD FRAMING

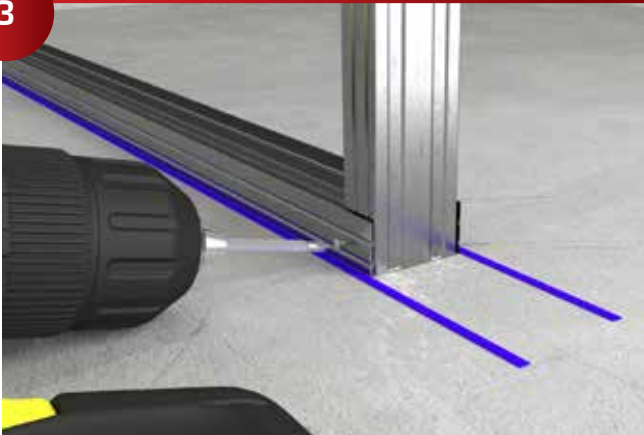

Use a #8 x 9/16 in. Waferhead low profile, self-drilling screws to attach steel framing. Do not use a standard panhead screw because they bulge out the gypsum wallboard.

4

U CHANNEL



Use it least one row of cold-formed galvanized steel U Channel to hold the steel stud in place while installing the gypsum.

5

HORIZONTAL BRACING



Steel Studs can also be used to hold the steel studs in place while installing the gypsum in lieu of or in addition to U channel.

6

INSTALLING GYPSUM BOARD



Use longest gypsum board length available, avoiding unnecessary joints. Do not use any gypsum wallboard that is distorted or wrapped. One side the wall with special specifications WD-1. Be sure to firmly screw all wallboard to the steel framing.

7

CORNERS



Do not use cornerbead or tape on the outside corners, because they bulge out the corners. Use full thickness gypsum with carefully trimmed edges, do not use gypsum with tapered edges.

8

FINISH LEVEL 2

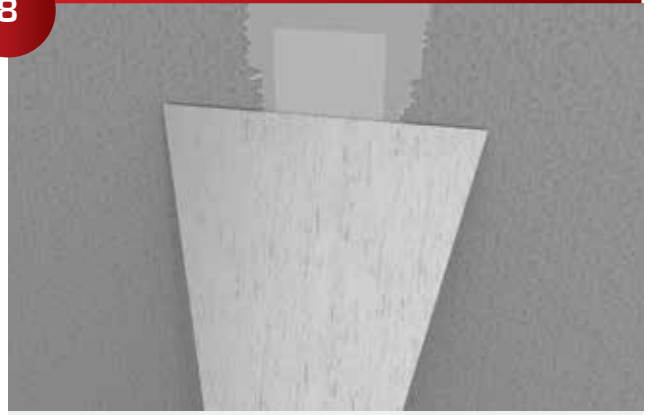

Locations to receive special specification WD-1 should have only a Level 2 finish. All joints and corners should have tape embedded in joint compound and wiped with a joint knife leaving a thin coating of joint compound over the joints and corners.