

CUPTI™

Specification

length: 50mm
width: 22.5mm
height: 82mm
Capacity: 5.0mL
battery weight: 158g (exclude battery)
suitable battery: 18650 lithium battery X 1

Product Feature

material: zinc alloy and aluminum alloy
color: Black/Red/White
Drip tip: POM black (can exchange)
display: OLED display
coil: CLOCC SS316L 0.5 Ohm (DL)
CLOCC NiCr 1.5 Ohm (MTL)
RBA: optional
Replaceable Pyrex glass

Function

Output power: 75W
MICRO USB charge port, input voltage DC 5V,
charge current: 1A
Battery cell: 3.7V lithium battery,
18650 discharge over 30A
Resistance: Ni200, Ti and Nichrome, 0.15-1.3Ohm
Temperature control from 100°C to 300°C and then
200°F to 600°F with achieve wattage range setting.

Warnings:

- Do not charge the device outdoors or near water.
- Do not use this device for anything other than vaping.
- Dissemble the device will invalidate your warranty.
- Do not swallow the e-liquid.
- Do not look into the drip tip while vaping to prevent juice spit in eyes.
- Do not use the device while driving.
- Do not dispose battery to fire or use it in extreme temperature.
- This is not designed to be a smoking cessation device.
- Keep all components away from children and pets.
- Suitable temperature in using is 5-45 degree.
- Use the provided tank and battery as a kit and do not use with other tank or battery separately.
- This device is designed for adults. It should not be used by children under the age of their local smoking or vaping laws, women who are pregnant, or those suffering from illness that could be worsened by the use of this product.
- Switch off the device when put into your pocket to prevent accidental firing.
- If you have an adverse reaction in the use of this product, stop using it immediately and seek medical assistance.
- This device contains no user serviceable parts. It should be repaired by qualified personal only.
- Kanger takes no responsibility for damage to person or property through improper use of this product.
- Kanger will not warrant this product due to improper use or damage caused by the user.
- KangerTech will not be responsible for any damages or injuries caused by using a substandard battery. End users must certify their batteries before plugging them into a KangerTech device.

Assemble diagram

Juice filling and coil changing diagram

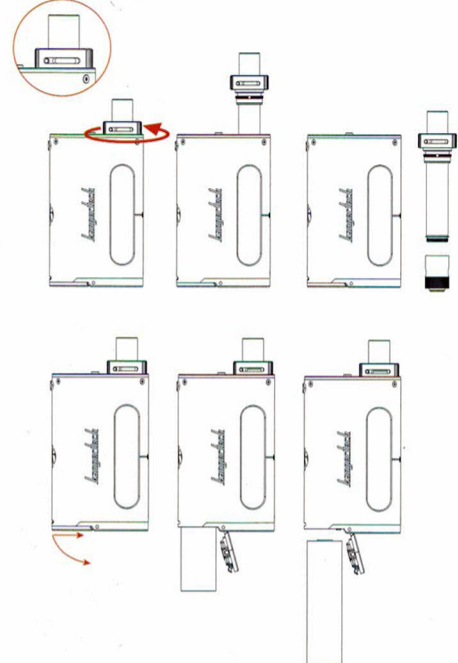
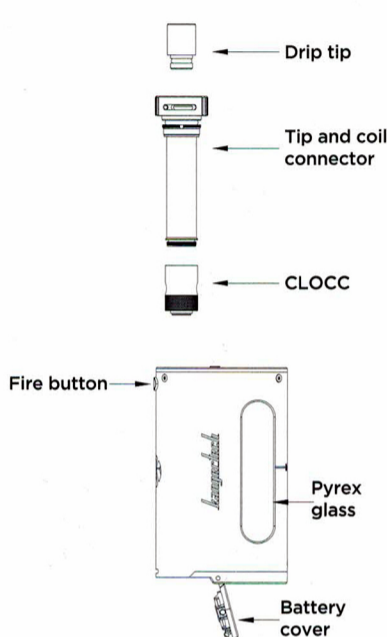

LCD display:

NO.	Process	LCD Display	Function	Explanation																
1.	When battery is switched off, press fire button 5 times within 2 seconds to switch on the battery.	Kanger Tech	Battery on / off																	
2.	To select temperature control materials, switch on the CUPTI, press 3 successive clicks on fire button, to shift to another mode, just press another 3 successive clicks.	<table border="1"> <tr> <td>0.150 75.0W</td> <td>Ni</td> <td>0.150 75.0W</td> <td>Ti</td> </tr> <tr> <td>500 F</td> <td></td> <td>500 F</td> <td></td> </tr> <tr> <td>0.150 75.0W</td> <td>SS</td> <td>0.150 75.0W</td> <td>NC</td> </tr> <tr> <td>500 F</td> <td></td> <td>500 F</td> <td></td> </tr> </table>	0.150 75.0W	Ni	0.150 75.0W	Ti	500 F		500 F		0.150 75.0W	SS	0.150 75.0W	NC	500 F		500 F		Sequence of tempertaure control wire type: Ni: Pure Nickel Ti: Titanium SS: Stainless steel NiCr: Nichrome	Choose your preferred coil resistance type, which contains Ni: Nickel 200, Ti: Titanium, SS: Stainless steel and NiCr: NiCr. Once coil wire is chosen, it will run in temperature control mode with the pre-set temperature value. It is reminded that user must choose the right coil wire and in corresponding mode for proper function.
0.150 75.0W	Ni	0.150 75.0W	Ti																	
500 F		500 F																		
0.150 75.0W	SS	0.150 75.0W	NC																	
500 F		500 F																		
3.	At temperature control of Ni 200 (pure Nickel), Ti (Titanium), SS (Stainless steel), NC(Nichrome) or you can adjust desired temperature.	<table border="1"> <tr> <td>0.150 75.0W</td> <td>Ni</td> <td>0.150 75.0W</td> <td>500 F</td> </tr> </table>	0.150 75.0W	Ni	0.150 75.0W	500 F	For example of Ni mode, press up (+) or down (-) button to set the desired temperature of the coil. Temperature range from 100°C to 315°C and then 200°F to 600°F	Once set up the desired temperature, CUPTI mod will cut off the output if the coil reaches your preset temperature												
0.150 75.0W	Ni	0.150 75.0W	500 F																	
4.	Apart from the 4 temperature control modes, the final mode is full power wattage output, this is the last setting behind the temperature control selection of NC mode.	<table border="1"> <tr> <td>0.490 0.00V</td> <td>75.0W</td> </tr> </table>	0.490 0.00V	75.0W	Temperature control off	Display the resistance value and wattage setting. At standby mode, voltage = 0.00V. Once press the fire button, it will display corresponding voltage irrespective of coil temperature.														
0.490 0.00V	75.0W																			
5.	To reverse the LCD display, switch on CUPTI, press up and down button together for 2 seconds.	<table border="1"> <tr> <td>0.50 0.00V</td> <td>75.0W</td> <td>MO'9Z</td> <td>A000 090</td> </tr> </table>	0.50 0.00V	75.0W	MO'9Z	A000 090	Choose the best LCD display for the left or right hand holding	There are only two options.												
0.50 0.00V	75.0W	MO'9Z	A000 090																	
6.	When the battery is switched on, press fire button 5 times within 2 seconds.	OFF	Batety in off mode	For long period storage																
7.	In using Ni/Ti/SS/NC resistance wire, once changing the coil, CUPTI will detect your coil value automatically	CHECK ATOMIZER	Use the up or down small button and to choose New coil: up (+) button Old coil: down (-) button	This is to calibrate the coil resistance for Ni 200, Ti, SS or NiCr coil, make sure the coil in the room temperature (the environment you vape) for best temperature control.																
8.	When 18650 drained out	Check Battery	Check Battery	18650 cell needs to recharge																
9.	Short pretection	Low Resistance	Low Resistance	Some portion is short, check spring loaded connection or atomizer																
10.	Open circuit	Check Atomizer	Check Atomizer	Poor connection of spring load or atomizer worn-out.																
11.	Long time pressing	10S Over	Prevent over time firing	This prevent accidental pressing on firebutton																
12.	High Temperature protection	Temp High	Prevent over heating of control board	In case successive vaping causes the control board over heating, it will disappear once cooled down																

CUPTI usage:

- 5 speedy clicks to switch on/off the battery.
- After switched on, LCD displays "KANGER TECH" at standby mode.
- Press fire button 3 times, choose your resistance wire, Ni 200, Ti, SS, NiCr or pure wattage output.
- For pure Ni 200, Ti, SS or NiCr resistance wire, you can set your desired coil temperature to fit your taste.
- For power output mode, set your desired working wattage that best fits you.
- Press (+) and (-) together to choose LCD display orientation.
- Press (+), (-) and fire button all together, this can lock the up and down button once you have best setting by pressing the entire buttons together.
- In case you change the coil or vape in other environment of presetting, you may need to calibrate the CUPTI atomizer as new coil: YES (+), NO (-) for best performance.
- If no display of calibration:
 - Screw down the CLOCC.
 - Press the fire button till LCD displays "Check Atomizer".
 - Screw back the SUBDRIP and press fire button again.

Protection

- Short circuit protection, LCD flashes and displays "Low Resistance".
- Atomizer open circuit, LCD flashes and displays "Check Atomizer".
- Cell reverse protection, no power output when cell reversely installed.

- PCB over temperature protection, and battery stops function and LCD displays "Temp High".
- 10 seconds overtime usage protection, no power output and LCD displays "10S OVER".
- Cell capacity protection, when cell capacity is too low, and displays "Check Battery".

LCD Overview:

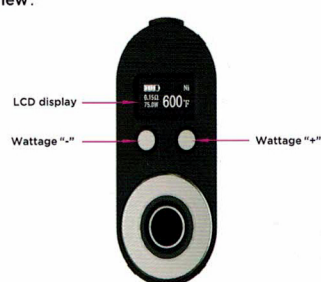

Remarks:

This package does not include the 18650 cell or charger. Customer needs to choose suitable 18650 cell and the corresponding charger. The cell output discharge best at 30A or above. Once the capacity indicator drops to the minimum, the cell needs to be charged. End user must choose the correct temperature control mode corresponding to their resistance wire for CUPTI to function normally. Ni 200 wire is suggested to use in TC mode only. The information contained in this manual is subject to change without notice.