

Manufactured by Joyetech
 Email: info@joyetech.com
 Web: www.joyetech.com



the CUBIS Pro Atomizer User Manual



Notice for Use

Thank you for choosing Joyetech!
 To ensure safe and proper usage, please read this manual carefully. If you require any additional information or have any questions regarding this product or its use, please consult your local Joyetech retailer, or visit our website at www.joyetech.com.

Product Introduction

CUBIS Pro, adopts innovative and leak resistant cup design, whose coil replacement and juice fill can be achieved by removing this top section from the cup. Airflow controls are also contained within the removable top tank assembly, meaning the possibility for leakage or coil flooding is greatly reduced. With the CUBIS Pro atomizer, you'll gain a perfect flavor and more precise vaping experience.

How to Assemble

1. Screw the top cap onto the airflow ring and put the mouthpiece onto the top. ①
2. Drip a few drops into the atomizer head and install it onto the vent pipe. ②
3. Install the above part with the atomizer tube then the whole CUBIS Pro is assembled. ③

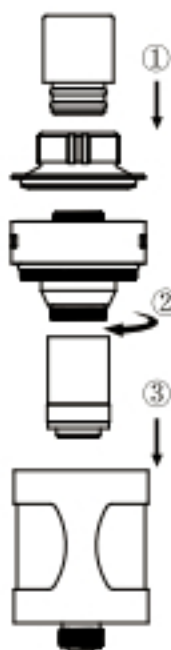

Atomizer Head replacement:

Unscrew the atomizer cap, the atomizer head(with natural cotton) is located on the cap, just unscrew it and replace and clean.

NOTE:

1. Please do not wash the atomizer head with water. Simply scrub it with cotton or clean dry cloth.
2. Please drip at least 5 drops of e-juice to the atomizer head and vape a few times in power-off condition (with airflow widely open) before its first use to avoid dry burn.

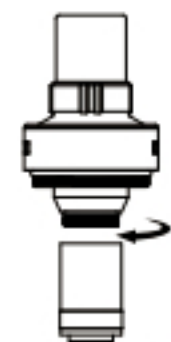

E-juice filling:

Separate the atomizer from the battery, and unscrew the mouthpiece base from the atomizer cap. Inject the liquid into e-juice hole at the both sides.

NOTE:

1. Please don't fill in through the middle hole of the atomizer cap.
2. Please don't overfill to avoid overflown.



Warning

1. Keep out of reach of children.
2. This device is not recommended for use by young people or non-smokers.

Cautions:

1. Only have your CUBIS Pro atomizer repaired by Joyetech. Do NOT attempt to repair it on your own as it may lead to further damage to the item and/or personal injury.
2. CUBIS Pro atomizer should be operated in dry conditions between temperatures of -10°C(14°F) to 60°C(140°F) and charged between 0°C(32°F) to 45°C(113°F).
3. CUBIS Pro atomizer is designed with authentic Joyetech components. Applying CUBIS atomizer with unauthorized components may cause the device to function improperly and/or lead to damage.

Warranty

Please consult your Joyetech product warranty card. We are not responsible for any damages caused by human error. Our warranty is not available for products purchased from third party vendors.

Joyetech agrees to provide repair under warranty pursuant to the following terms and conditions:

1. This warranty provides repair free of charge for defective Joyetech brand merchandise. Warranty period is 90 days from date of purchase by the end user.
2. This warranty may be void as a result of any of the following conditions:
 * Customer does not provide warranty card and original receipt of purchase.

- * Merchandise failure or damage is caused due to improper use or unauthorized repair.
- * Merchandise failure or damage as a result of excessive force such as dropping.
- * Merchandise failure or damage as a result of usage outside of recommended operating conditions (see precautions in usage manual).
- * Merchandise failure or damage caused by improper use of water or other liquid (see usage manual for operating instructions).
- * Merchandise failure or damage due to usage with non-Joyetech components (charger, battery, and power cable).

3. This warranty does not cover personal items or consumable goods and attachments, including but not limited to: mouthpiece, cartridge, atomizer head, lanyard, and leather sheath.

4. This warranty does not cover any non-Joyetech brand products. This warranty is only valid for eligible Joyetech brand products during the warranty period of 90 days after date of purchase as indicated on proof of purchase.

Joyetech reserves the right of final decision in all warranty cases. Joyetech may interpret and revise the content of this warranty terms.