

GROUP E PRICING

Classic - Flatsawn Walnut, Mahogany, Bamboo

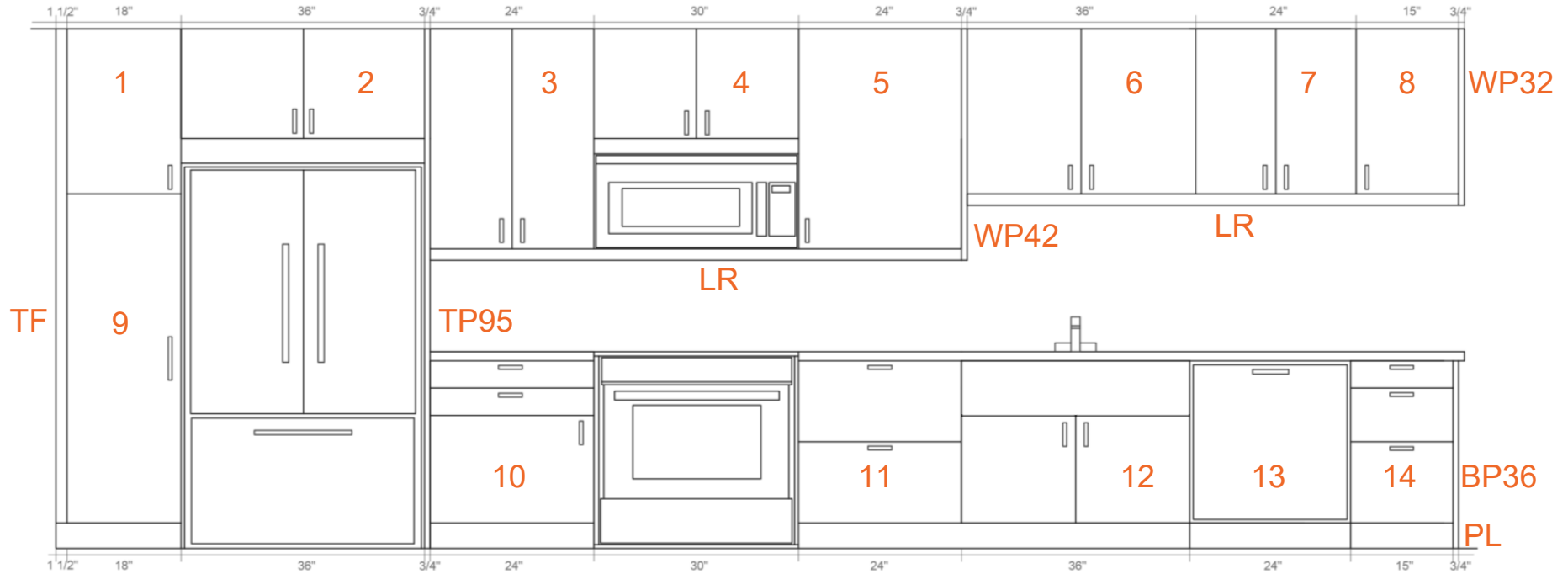

- 18" x 30" 1 door-\$2ĪĪ
- GĒ 36" x 20" 2 doors-\$455
- 3Ē 24" x 40" 2 doors-\$1GĪ
- IĒ 30" x 20" 2 doors-\$393
- 5Ē 24" x 40" 1 door-\$373
- 6Ē 36" x 30" 2 doors-\$552
- 7Ē 24" x 30" 2 doors-\$3ĪĒ
- ĪĒ 15" x 30" 1 doors-\$2HĪ
- JĒ 18" x 60" 1 door-\$12Ē
- FĒĒ 24" 3 pieces-\$360
- FFĒ 24" 2 pieces-\$342
- F2Ē 36" 3 pieces-\$580
- F3Ē 24" DWCP*-\$325
- F4Ē 15" 3 pieces-\$2ĪF

- BP36* Base panel 26" x 36"-\$295
- WP32* Wall Panel 17" x 32"-\$184
- WP42* Wall Panel 17" x 42"-\$205
- TP95* Tall Panel 26" x 95"-\$567
- TF** Tall Filler 4" x 90"-\$81
- LR** Light Rail-2 X \$53 (\$106)
- PL** Plinth/Toe-Kick-2 x \$63 (\$126)

FYI:
 -We can make cover panels for all major brand appliances
 -Unfinished available

AVERAGE COST OF FRONTS IN GROUP E	COST COMPARISON TO IKEA RINGHULT FRONTS
\$6,443	\$3,590
COST OF CABINETS AND HARDWARE FROM IKEA	
\$1,667	
AVERAGE TOTAL COST FROM SH	AVERAGE TOTAL COST FROM IKEA
\$8,110	\$5,257