

GROUP B3 PRICING

Supermatte (Shaker Style)

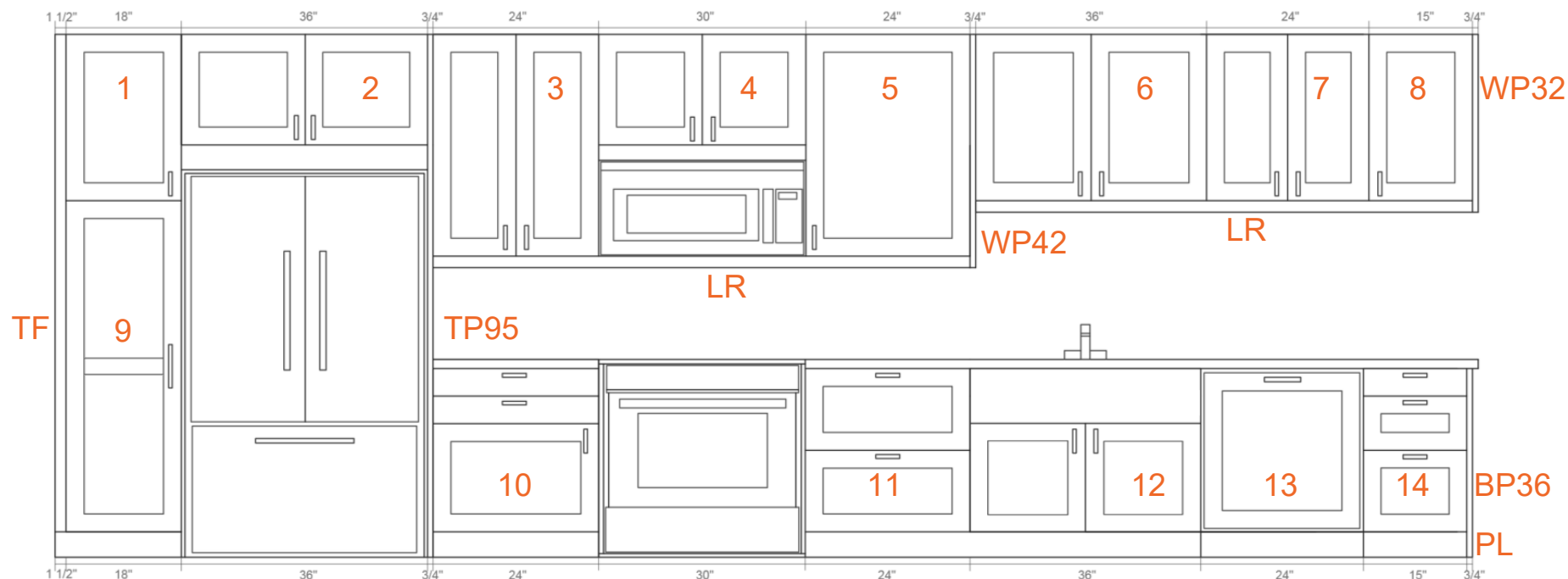

- 1. 18" x 30" 1 door-\$150
- 2. 36" x 20" 2 doors-\$266
- 3. 24" x 40" 2 doors-\$273
- 4. 30" x 20" 2 doors-\$229
- 5. 24" x 40" 1 door-\$230
- 6. 36" x 30" 2 doors-\$300
- 7. 24" x 30" 2 doors-\$219
- 8. 15" x 30" 1 doors-\$137
- 9. 18" x 60" 1 door-\$283
- 10. 24" 3 pieces-\$227
- 11. 24" 2 pieces-\$208
- 12. 36" 3 pieces-\$328
- 13. 24" DWCP*-\$189 (optional)
- 14. 15" 3 pieces-\$164

- BP36* Base panel 26" x 36"-\$109
- WP32* Wall Panel 17" x 32"-\$75
- WP42* Wall Panel 17" x 42"-\$90
- TP95* Tall Panel 26" x 95"-\$249
- TF** Tall Filler 5" x 95" -\$45
- PL** Plinth/Trim -4 x \$45 (\$180)

FYI:
 **Fillers to be used for light-rail, trim and plinth
 -We can make cover panels for all major brand appliances

<p><u>AVERAGE COST OF FRONTS IN GROUP B1</u></p> <p>\$3,951</p>
<p><u>COST OF CABINETS AND HARDWARE FROM IKEA</u></p> <p>\$1,667</p>
<p><u>AVERAGE TOTAL COST FROM SEMIHANDMADE</u></p> <p>\$5,618</p>