

GROUP B1 PRICING

Impression

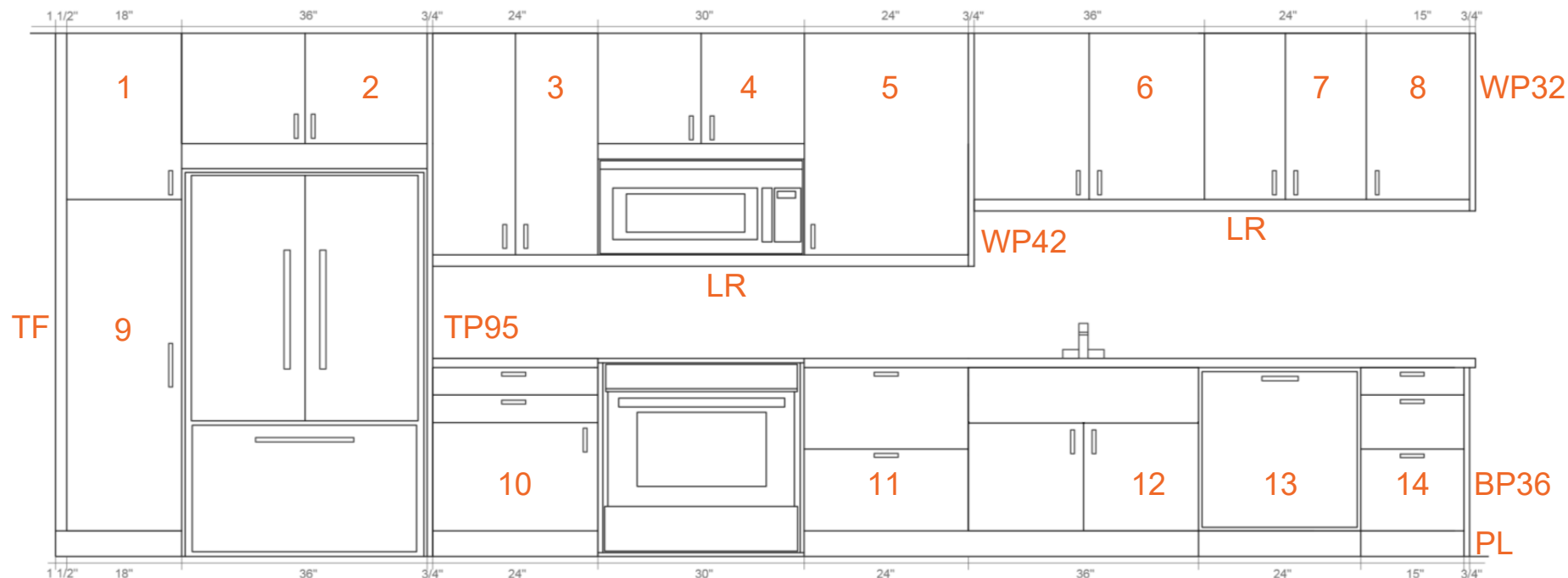

1. 18" x 30" 1 door-\$124
2. 36" x 20" 2 doors-\$187
3. 24" x 40" 2 doors-\$231
4. 30" x 20" 2 doors-\$158
5. 24" x 40" 1 door-\$183
6. 36" x 30" 2 doors-\$248
7. 24" x 30" 2 doors-\$181
8. 15" x 30" 1 doors-\$111
9. 18" x 60" 1 door-\$226
10. 24" 3 pieces-\$181
11. 24" 2 pieces-\$166
12. 36" 3 pieces-\$270
13. 24" DWCP*-\$151 (optional)
14. 15" 3 pieces-\$133

- BP36*** Base panel 26" x 36"-\$99
- WP32*** Wall Panel 17" x 32"-\$75
- WP42*** Wall Panel 17" x 42"-\$90
- TP95*** Tall Panel 26" x 95"-\$199
- TF**** Tall Filler 5" x 95" -\$45
- PL**** Plinth/Trim -4 x \$45 (\$180)

FYI:
 **Fillers to be used for light-rail, trim and plinth
 -We can make cover panels for all major brand appliances

<p><u>AVERAGE COST OF FRONTS IN GROUP B1</u></p> <p>\$3,238</p>
<p><u>COST OF CABINETS AND HARDWARE FROM IKEA</u></p> <p>\$1,667</p>
<p><u>AVERAGE TOTAL COST FROM SEMIHANDMADE</u></p> <p>\$4,905</p>