

GROUP A2 PRICING

DIY Shaker

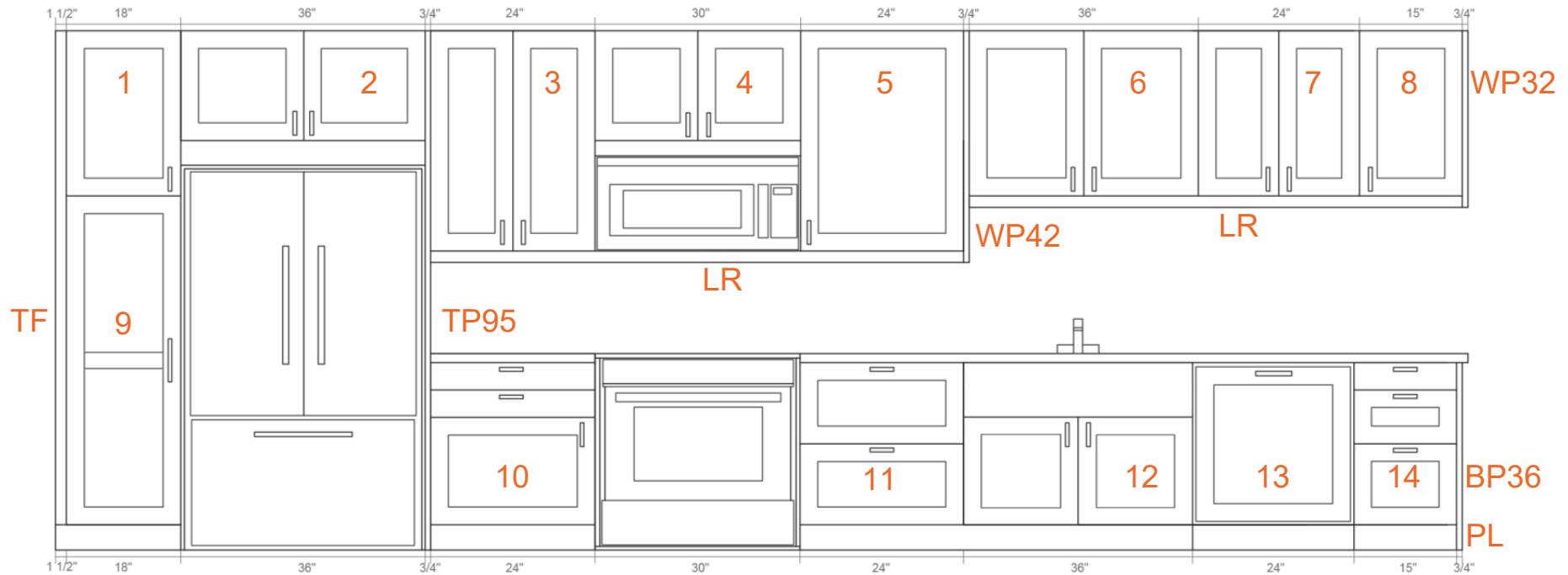

1. 18" x 30" 1 door-\$93
2. 36" x 20" 2 doors-\$126
3. 24" x 40" 2 doors-\$173
4. 30" x 20" 2 doors-\$104
5. 24" x 40" 1 door-\$167
6. 36" x 30" 2 doors-\$186
7. 24" x 30" 2 doors-\$130
8. 15" x 30" 1 doors-\$78
9. 18" x 60" 1 door-\$198
10. 24" 3 pieces-\$135
11. 24" 2 pieces-\$130
12. 36" 3 pieces-\$195
13. 24" DWCP*-\$125 (optional)
14. 15" 3 pieces-\$84

DIY SLAB Group A1*

- BP36*** Base panel 26" x 36" - \$81
- WP32*** Wall Panel 17" x 32" - \$59
- WP42*** Wall Panel 17" x 42" - \$69
- TP95*** Tall Panel 26" x 95" - \$199
- PL**** Plinth/Toe-Kick -4 x \$45 (\$180)

FYI:

- *All panels 3/4" thick, over-sized and cut to fit on-site.
- **Fillers to be used for light-rail, trim and plinth.
- We can make cover panels for all major brand appliances.

AVERAGE COST OF FRONTS IN GROUP A2	COST COMPARISON TO IKEA RINGHULT FRONTS
\$2,518	\$4,003
COST OF CABINETS AND HARDWARE FROM IKEA	
\$1,267	
AVERAGE TOTAL COST FROM SH	AVERAGE TOTAL COST FROM IKEA
\$3,785	\$5,270