

GROUP A1 PRICING

DIY Slab

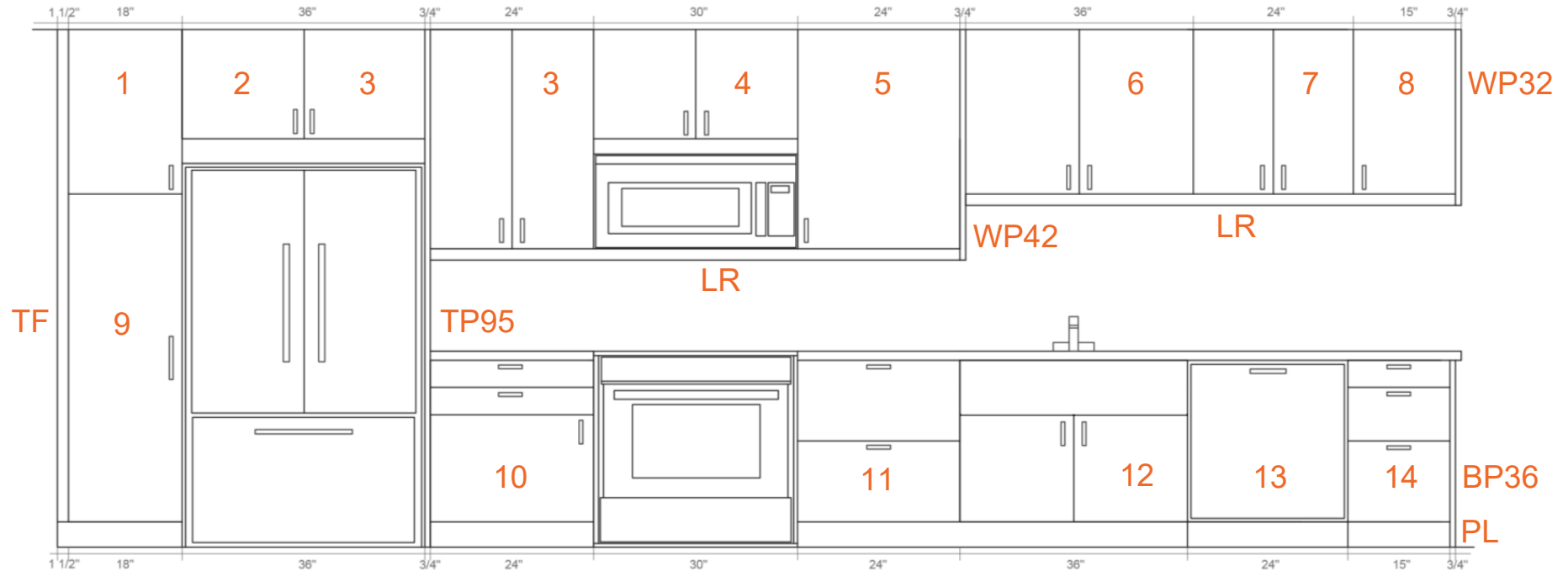

- 1. 18" x 30" 1 door-\$77
- 2. 18" x 20" 1 door-\$54
- 3. 18" x 20" 1 door-\$54
- 4. 30" x 20" 2 doors-\$88
- 5. 24" x 40" 1 door-\$142
- 6. 36" x 30" 2 doors-\$158
- 7. 24" x 30" 2 doors-\$111
- 8. 15" x 30" 1 doors-\$66
- 9. 18" x 60" 1 door-\$160
- 10. 24" 3 pieces-\$115
- 11. 24" 2 pieces-\$111
- 12. 36" 3 pieces-\$166
- 13. 24" DWCP*-\$106 (optional)
- 14. 15" 3 pieces-\$71

- BP36* Base panel 26" x 36" -\$81
- WP32* Wall Panel 17" X 32" -\$59
- WP42* Wall Panel 17" X 42" -\$69
- TP95* Tall Panel 26" x 95" -\$199
- TF** Tall Filler 5" x 95" -\$45
- PL** Plinth/Toe-Kick -4 x \$45 (\$180)

FYI:
 *All panels 3/4" thick, over-sized and cut to fit on-site.
 **Fillers to be used for light-rail, trim and plinth.
 -We can make cover panels for all major brand appliances.

<p><u>AVERAGE COST OF FRONTS IN GROUP A1</u></p> <p>\$2,258</p>
<p><u>COST OF CABINETS AND HARDWARE FROM IKEA</u></p> <p>\$1,667</p>
<p><u>AVERAGE TOTAL COST</u></p> <p>\$3,925</p>