

# GROUP A1 PRICING

DIY Slab

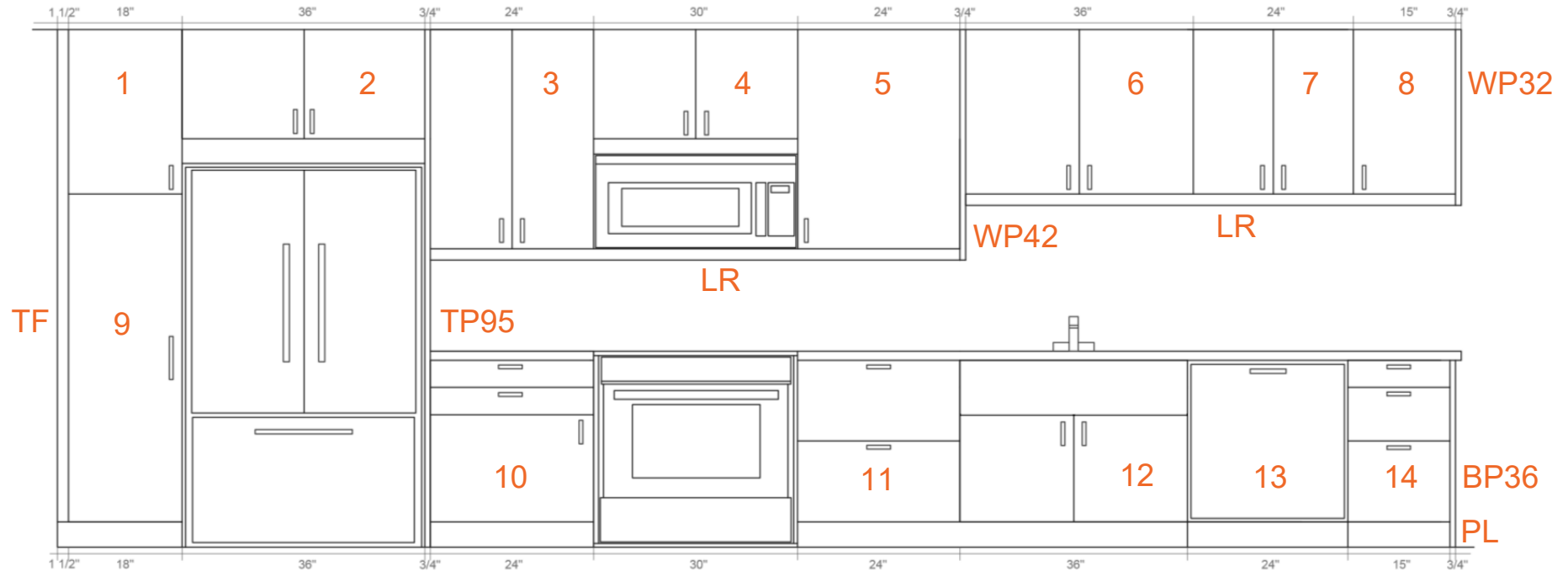

- 1. 18" x 30" 1 door-\$77
- 2. 36" x 20" 2 doors-\$107
- 3. 24" x 40" 2 doors-\$147
- 4. 30" x 20" 2 doors-\$88
- 5. 24" x 40" 1 door-\$142
- 6. 36" x 30" 2 doors-\$158
- 7. 24" x 30" 2 doors-\$111
- 8. 15" x 30" 1 doors-\$66
- 9. 18" x 60" 1 door-\$160
- 10. 24" 3 pieces-\$115
- 11. 24" 2 pieces-\$111
- 12. 36" 3 pieces-\$166
- 13. 24" DWCP\*-\$106 (optional)
- 14. 15" 3 pieces-\$71

- BP36\* Base panel 26" x 36" -\$81
- WP32\* Wall Panel 17" X 32" -\$59
- WP42\* Wall Panel 17" X 42" -\$69
- TP95\* Tall Panel 26" x 95" -\$199
- TF\*\* Tall Filler 5" x 95" -\$45
- PL\*\* Plinth/Toe-Kick -4 x \$45 (\$180)

**FYI:**  
 \*All panels 3/4" thick, over-sized and cut to fit on-site.  
 \*\*Fillers to be used for light-rail, trim and plinth.  
 -We can make cover panels for all major brand appliances.

AVERAGE COST OF FRONTS IN GROUP A1	COST COMPARISON TO IKEA RINGHULT FRONTS
<b>\$2,258</b>	<b>\$3,590</b>
COST OF CABINETS AND HARDWARE FROM IKEA	
<b>\$1,667</b>	
AVERAGE TOTAL COST FROM SH	AVERAGE TOTAL COST FROM IKEA
<b>\$3,925</b>	<b>\$5,257</b>