

### Specification

**Product name**  
MAIWO USB3.2 Gen2 M.2 SSD clone docking with SD card reader

- PC Type-C
- Power Type-C
- Power switch
- Power LED
- B+M Key SATA M2
- M-key NVMe M2
- Disk LED
- Clone switch
- Diagram Of clone setting
- Clone button
- Clone Indicator light
- SD memory LED
- SD express slot

Name	MAIWO USB3.2 Gen2 M.2 SSD clone docking with SD card reader
Interface	Type-C to M.2
Support SSD	B+M Key(SATA); M-key/B+M key(NVMe);
Support SD	SD Express and down compatibility
USB peed	10Gbps
Rating	5V, 3A
Feature	External storage and SD card reader
Compatible	Windows XP/7/8/8.1/10, MAC OS
Unit size	79(L)X76(W)X18(H)MM
LED	Power(green), disks(white),SD(white),Clone(Blue)



K3016CL M.2-SSD Docking

## Attention!

Check the connector icon and SSD label match before assembling SSD, can not work if assemble wrong SSD

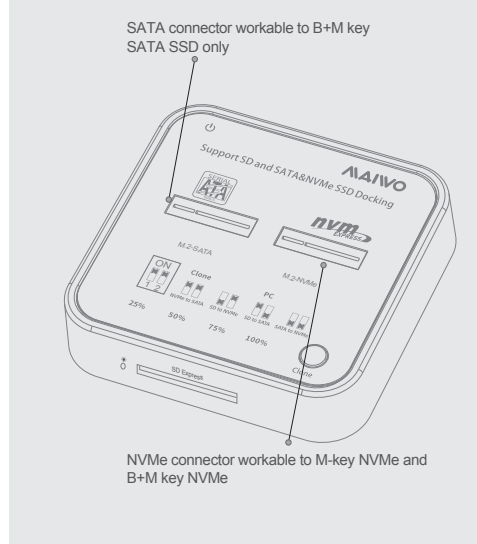

### Quick Installation Guide

- PC mode (Read and Write)
  - Insert M.2 SSD to correct SSD slot
  - Connect USB cable with docking and PC/NB
  - Connect power type C with docking and AC adapter
  - Press power switch one time, power and disks LED will illuminate following
- SD card reader
  - Insert SD memory card to slot
  - Connect USB cable with docking and PC/NB
  - Connect power type C with docking and AC adapter
  - Press the power switch one time, then SD LED will illuminate following

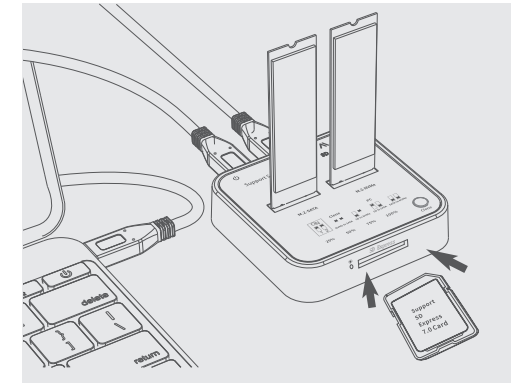

①

②

③

### Operation Guide

#### 1. How to set the clone mode

1.1: NVMe to SATA: set clone switch as below picture, both key up, lie to "ON", then follow up clone operation.



1.2 SATA to NVMe: set clone switch as below picture, both key down, lie to "1" and "2", then follow up clone operation



### Operation Guide

#### 1. How to set the clone mode

1.3 SD to SATA: set clone switch as below picture, one key lie to "O", one lie to "2", then follow up clone operation.



1.4. SD to NVMe: set clone switch as below picture, one key lie to "1", one lie to "N", then follow up clone operation.



### Operation Guide

#### 2. Clone

2.1: Insert SATA M.2 SSD in the "M.2-SATA" slot, NVMe M.2 SSD in the "M2-NVMe" slot, SD card in the "SD Express" Slot. (Kindly note: Don't insert the SSD in the wrong position)

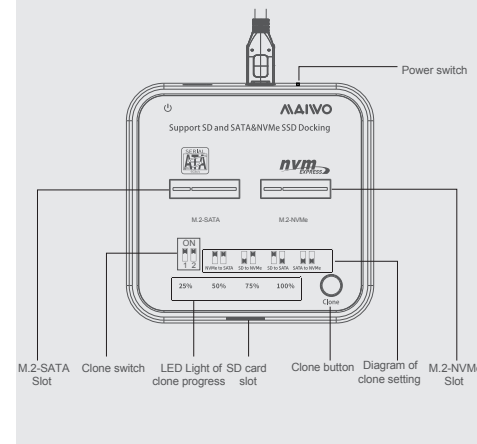

### Operation Guide

#### 2. Clone

- Set clone switch follow as diagrame wanted mode (remark: capacity source =<target)
- Connect USB power cable with AC adapter and power type C port, power LED illuminate green and disk LEDs illuminate white following
- Press clone button twice, interval approximate 5s, clone LED 25% will flash blue when start till 100% illuminate, four clone LED are blue when complete

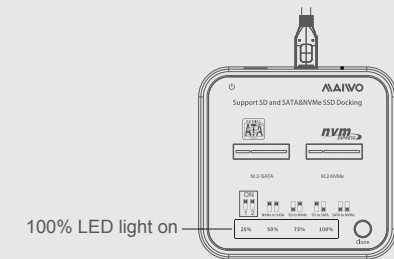

④

⑤

⑥

⑦