

guzzle H2O

pure water. no trash.



INSTALLATION / OPERATION MANUAL

SPIGOT STEALTH

REV B

7.25.19

BILL OF MATERIALS

ITEM		QTY
SPIGOT STEALTH		1
15' POWER CABLE W/ CONNECTOR		1
CARBON BLOCK CARTRIDGE		1
STRAIGHT ADAPTER, .375 TUBE X .375 BARBED FITTING		2
STRAIGHT ADAPTER, .375 TUBE X .5 BARBED FITTING		2
HOSE CLAMP		2

SPIGOT STEALTH

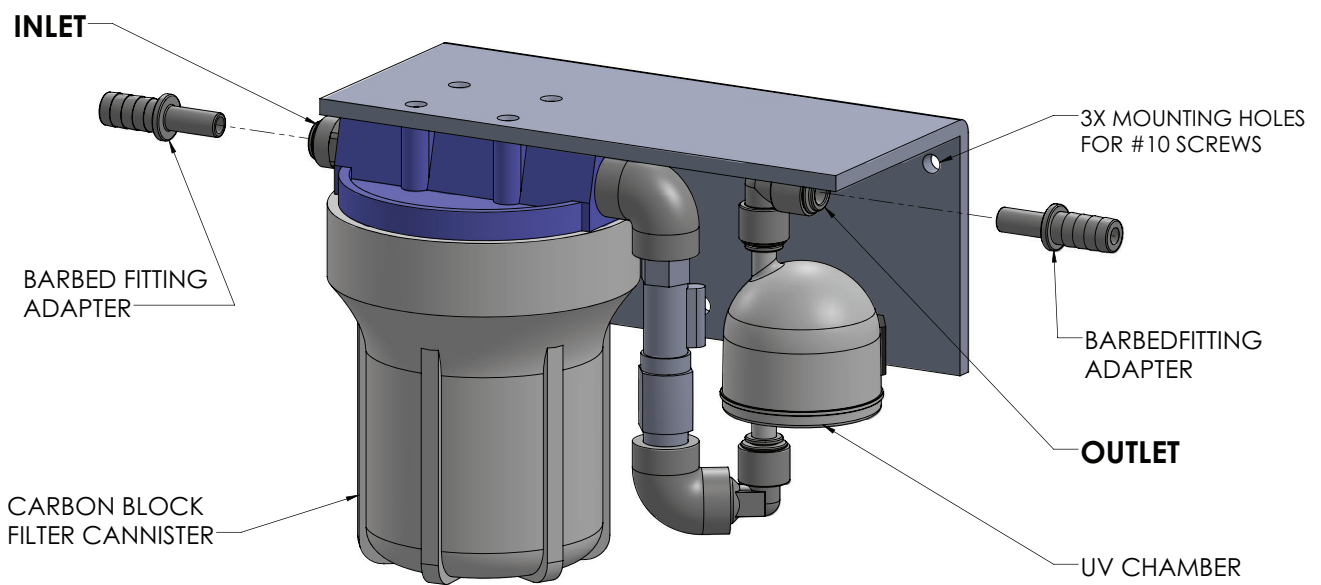

INSTALLATION AND OPERATION INSTRUCTIONS

System layout:

The Spigot Stealth should be installed on the cold water line between the pump/ pressure tank and the faucet. Ideally the Spigot Stealth should be the last thing the water passes through before the faucet. The inlet side of the Spigot Stealth is the carbon block filter cartridge. The outlet side is the UV chamber. Additionally, note the flow direction arrow on the flow switch.

Mounting:

On the back panel of the Spigot Stealth there are 3 holes that fit #10 screws. It may be easier to access these holes by removing the carbon block cartridge housing. Use fasteners appropriate to the surface and material you are mounting on.

Plumbing:

The Spigot Stealth is supplied with qty (2) 3/8 barbed x push-to-connect and qty (2) 1/2 barbed x push-to-connect fittings. The inlet and outlet of the Spigot Stealth accept the push-to-connect fittings. Cut the water line where the Spigot Stealth will be inserted and install the appropriate size supplied barbed fitting into the water line.

Wiring:

Connect the Spigot Stealth to the 12v power supply with 16 gauge wire. Power draw from the Spigot Stealth is 1.5 amp. It is suggested to install the Spigot Stealth on the same circuit as the water pump so that when the onboard water system is activated the Spigot Stealth will be supplied power as well. Note that the power line pigtail may be unplugged to assist wiring. The Spigot Stealth has an integral 2 amp fuse.

Operation:

The Spigot Stealth has a flow sensing switch which detects water flow and instantly turns itself on. An indicator light comes on when the UV chamber is activated. The Spigot Stealth should sense that water is moving when you open the faucet. It draws no power when it is in standby mode. LED technology allows it to instantly switch on the UV chamber with no warm up necessary.

INSTALLATION AND OPERATION INSTRUCTIONS (CONT.)

When to change carbon block element:

Carbon block filters should be changed after 1000 gallons of use. Actual capacity may vary depending upon quality of water filtered. Reduced water flow rate through filter or at the faucet is an indication that the carbon block filter element should be changed.

How to change carbon block element:

Turn off water pump, and open faucet to drain and depressurize water line. Place a bucket or towel below Spigot Stealth to catch any water that may drain. Unscrew carbon block filter housing. Use a filter wrench if necessary. Locate the o-ring on the perimeter of the cannister. Drain water and remove carbon block element. Place new carbon block filter element in the cannister. Make sure cannister o-ring is properly seated and cartridge gaskets are in place. Thread the cannister onto filter housing base. Make sure top and bottom of filter cartridge is centered on mounting. See below for list of acceptable replacement filters. Tighten cannister firmly, making sure o-ring seals. Turn on water pump, let water run. Close faucet and check for leaks.

Replacement Carbon Block Cartridges

Guzzle H2O 5" Carbon Block Cartridge

Pentek CB-5

Pentek EP-5

Winterization:

In below freezing temperatures, water must be removed from the Spigot Stealth. Unscrew the carbon block filter canister and remove the carbon block cartridge. Open faucet. Use an air compressor to inject air into the outlet hole in the center of the filter housing. Pulse air into the outlet hole until no more water comes out of the faucet. Reinstall the filter cannister without the carbon block element. Allow carbon block element to dry, and store for reinstallation.

