



the

natural

nipple™

LatchMatch™ Starter Kit

User Instruction Manual

Set includes:

Two nipples designed after maternal anatomy for shape, feel & flow

Two 5 oz bottles in BPA and toxin-free FDA-grade silicone

IMPORTANT INSTRUCTIONS and contact details included inside this pack. Please read and retain for future reference.

Squeeze before feeding to ensure the valve is accessible after storing and cleaning.

If the nipple becomes damaged, replace the nipple.



Instructions for Use

Please read these instructions carefully before using The Natural Nipple® bottle and nipple.

Safety Guide

For your child's safety and health.

WARNING!

Always use this product with adult supervision. Always check the bottle and nipples for tears, cracks or signs of wear and replace when damaged. Throw away bottle or nipples if damage is discovered.

Do not attempt to enlarge hole in the nipple as it could lead to a choking hazard.

Never use nipples as a pacifier/soother. Continuous and prolonged sucking of fluids will cause tooth decay. Always check food temperatures before feeding and stir heated food to ensure an even temperature. Do not use in a microwave except in a sterilizer. Keep out of the reach of children when not feeding.

Do not allow a child to walk or run with a bottle.



Cleaning and Sterilization

Clean bottle and nipple before each use. Always wash the bottle and nipple immediately after each use. Wash in warm soapy water and rinse in clean water or use the top-shelf of a dishwasher.

Do not clean with solvents or harsh chemicals. To prevent staining, do not allow bottle and nipple to come into contact with oil-based foods, such as oil or tomato sauce. Product may be sterilized by steam (electric or microwave), boiling or cold-water tablet/liquid solution.

Change nipples after approximately [six] weeks of use, as nipples will become worn out after repeated use and sterilization.

Storage and Use

Inspect the bottle and nipple before each use and pull the nipple in all directions. Throw away at the first signs of damage or wear. Do not store with or allow to come in contact with solvents or harsh chemicals. Nipples and bottles are not toys and should not be given to children to play with or suck on when not feeding. Do not leave the product in direct sunlight, heat or in disinfectant (sterilizing solution) for longer than recommended, as this may cause wear.



Assembly Instructions

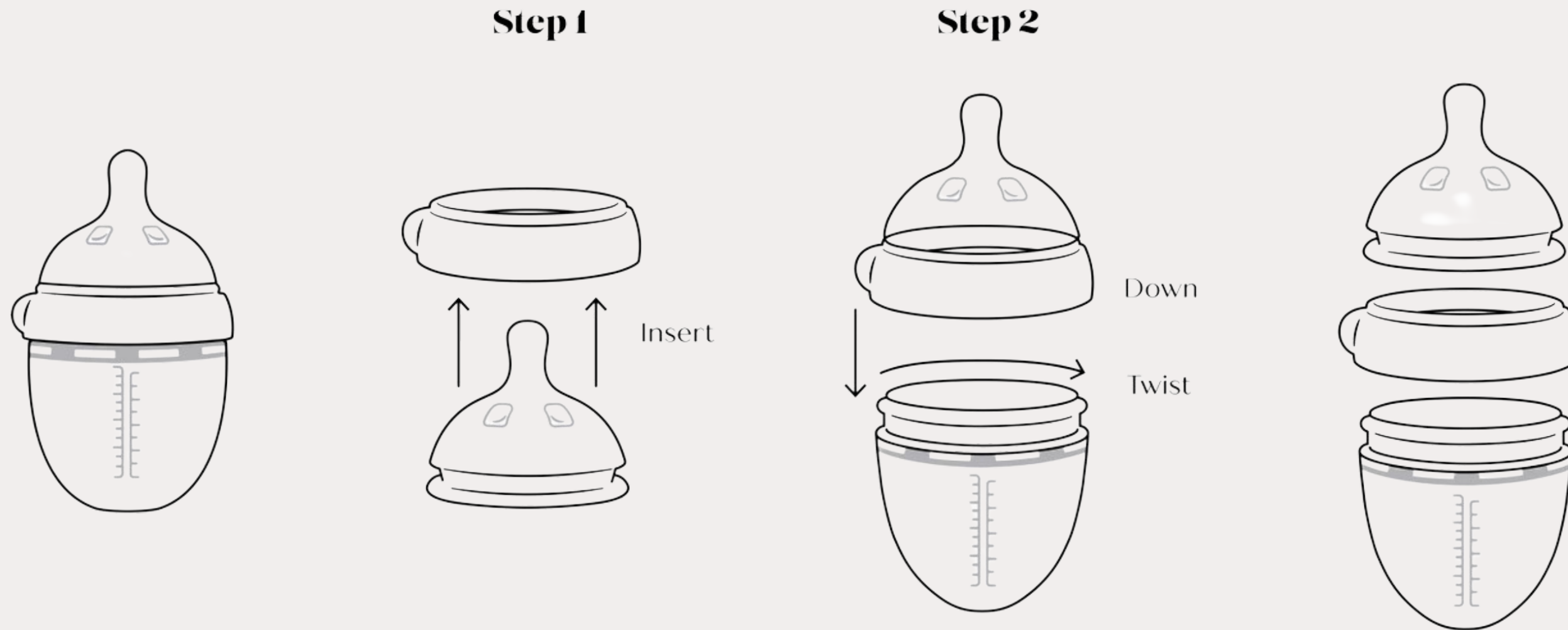

Distributed by: The Natural Nipple Corp. Tampa Bay Wave 501 E Kennedy Blvd Floor 6 Tampa, FL 33602

Any questions? Visit our website: www.thenaturalnipple.com or email us at support@thenaturalnipple.com

