



HASE
FOLDABLE FAIRING

User's Manual



Contents

Features.....	1
Installing the fairing mounts.....	2
Mounting the Foldable Fairing.....	3
Mounting steps.....	4
Adjusting the height and width of the Foldable Fairing.....	5
Adjusting the height of the Foldable Fairing.....	6
Don't forget!.....	7
Tensionstraps.....	8
Replacement parts.....	9/10
Safety information.....	11/12
Conditions of warranty and liability.....	13

Features / Features



Rear-view mirror



Stabilizers for crosswinds



Easy access from both sides



Wind deflector



Waterproof fabric



Universal Smartphone Mount



Aerodynamic design

U-tube
KETTWIESEL, LEPUS und TRIX

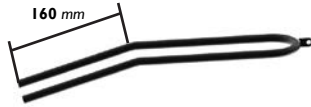

U-tube
TRIGO

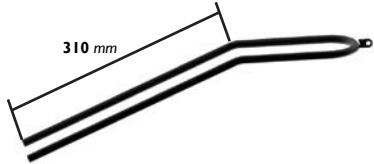

Installing the fairing mounts

Fig. 1: For the models KETTWIESEL, LEPUS, and TRIX, you will need two plastic adapters (shown blue in Figs. 1 and 2 – come with Foldable Fairing) for attaching the U-tube. Slide the two adapters from below onto the front boom near the headset.

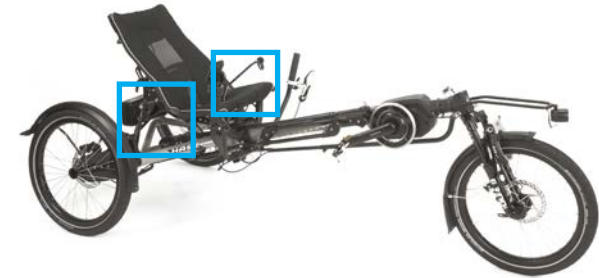

Fig. 2: For KETTWIESEL, LEPUS, and TRIX: guide the U-tube through the openings in the adapters. Then fasten the metal clamps around the adapters.

Fig. 3: For the TRIGO: the U-tube is attached directly to the groove in the frame tube (as shown), and no adapters are required.

Fig. 4: For KETTWIESEL, LEPUS, and TRIX: the side tubes and catches are mounted to the slot of the seat frame as shown.

Fig. 5: For TRIGO, the side tubes and catches are mounted as shown.

1



2

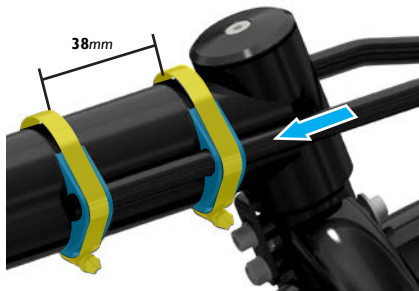

3

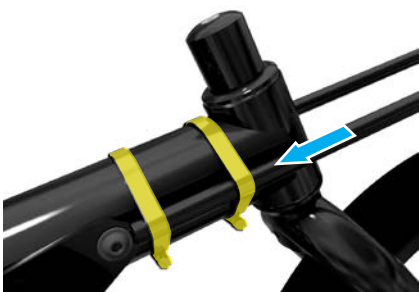

4



5





Mounting the Foldable Fairing

Fig. 6: Guide the coupling plate of the Foldable Fairing into the U-tube from above.

Fig. 7: Check to make sure that the coupling plate is properly seated in the U-tube (as shown).

Fig. 8: In order to attach the sides of the Foldable Fairing, simply press the respective rod against the metal catch (as shown).

Fig. 9: In order to release the sides of the Foldable Fairing, press the catch and guide the rod out of the slot (as shown).

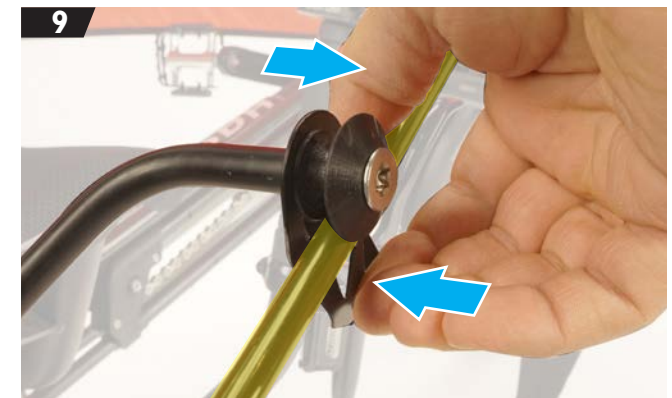
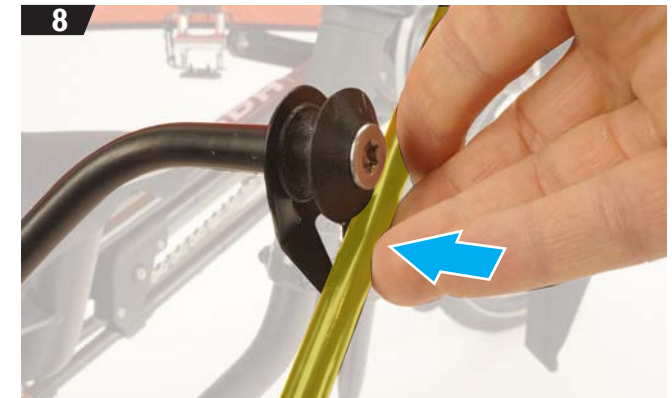

Foldable Fairing Mounting steps

1



2



3



4



5



6



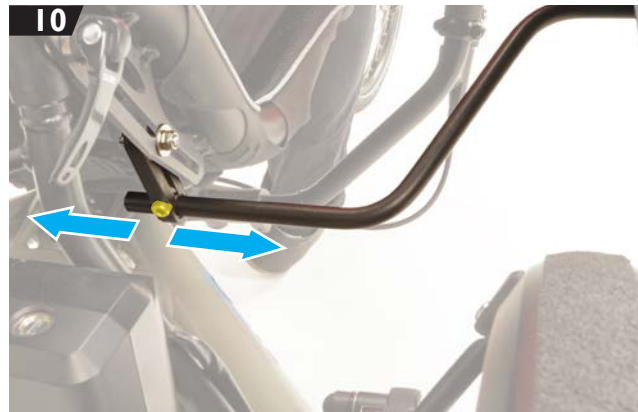

Adjusting the height and width of the Foldable Fairing

Fig. 10: After loosening the M6 bolt shown in the image, the width and height of the Foldable Fairing can be adjusted by rotating and/or sliding the side tube.

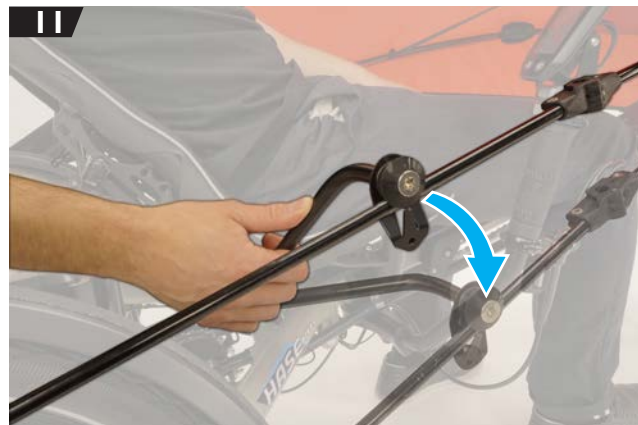

Fig. 11: By rotating the side tube, the height can be adjusted to the size and preferences of the rider. See following page for important information on height adjustment.



Fig. 12: Check to make sure there is enough space between the handlebar grips and the side tubes of the Foldable Fairing so that steering movements are not restricted in any way.

Adjusting the height of the Foldable Fairing

The height of the Foldable Fairing will affect wind deflection and the rider's field of vision.

Therefore, it is important that the height is properly adjusted.

Fig. 13: A higher position offers more protection from wind but restricts the rider's view of the road or path (e.g. of potholes). The high position is recommended for riding at higher speeds on smooth roads and paths.

13

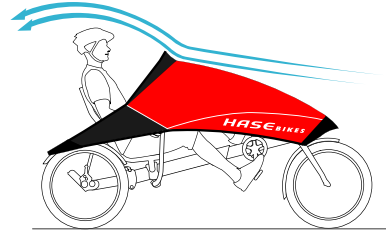
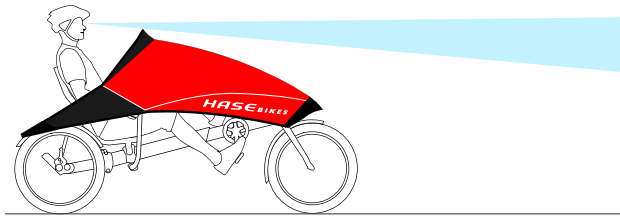

14

Fig. 14: The lower position offers less wind protection but gives the rider a better view of the road or path. This position should always be used when riding over rough surfaces.

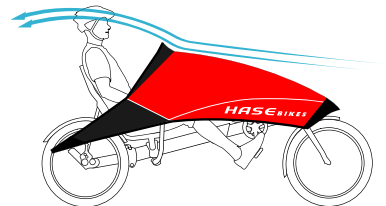
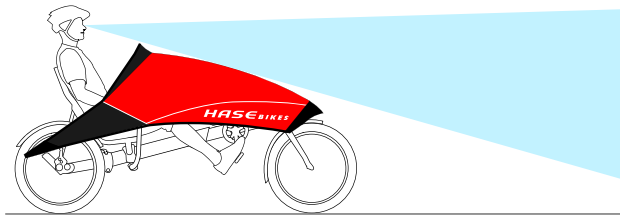

Please note: if the side tubes are not attached too tightly, then it is easy to adjust the height without tools by rotating the side tubes before starting your ride.

15



Don't forget

Fig. 15: The wind deflector is held in place by a flexible metal strip. Make sure that this metal strip is in the correct position before starting your ride (see image).



16



Fig. 16: On trikes with a motor, make sure there is enough space between the display and the Foldable Fairing.

17

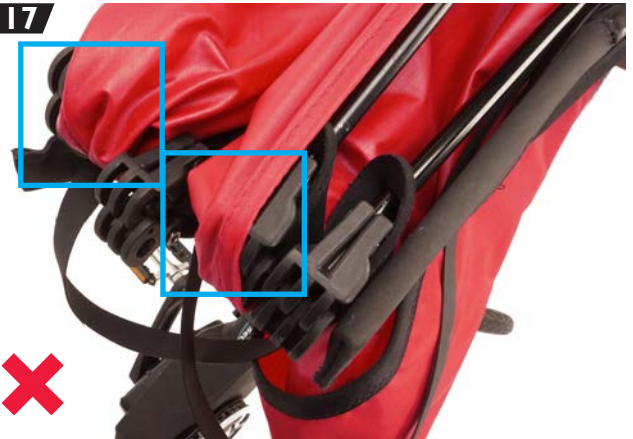

Fig. 17: When folding the fairing, make sure the fabric is not wrapped around the joints (see photo), as this could damage the fabric.

18



Fig. 18: This photo shows how the fabric should be positioned when folding the fairing.

19



Adjusting the tension straps

Fig. 19: The tension straps significantly improve side stability in crosswinds.

20

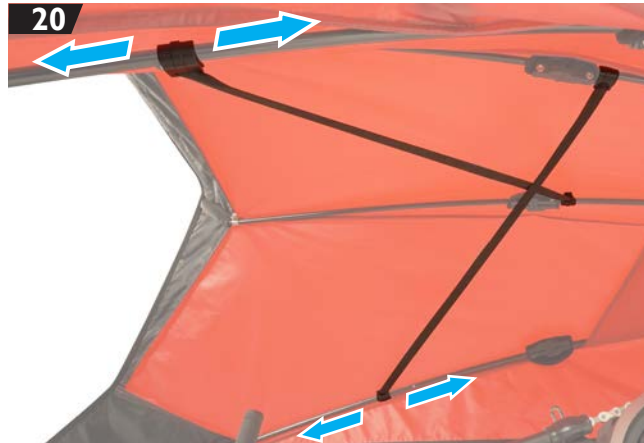

Fig. 20: The tension straps come pre-mounted as shown. By re-positioning the strap hooks, the shape of the Foldable Fairing can be adjusted. In order to ensure that the tension on the fabric cover is not reduced, the tension straps should only be under slight tension when the fairing is attached on both sides. They will only be under full tension in crosswinds.

21

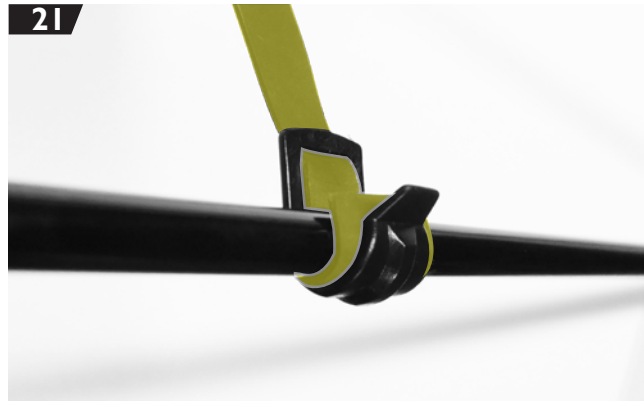
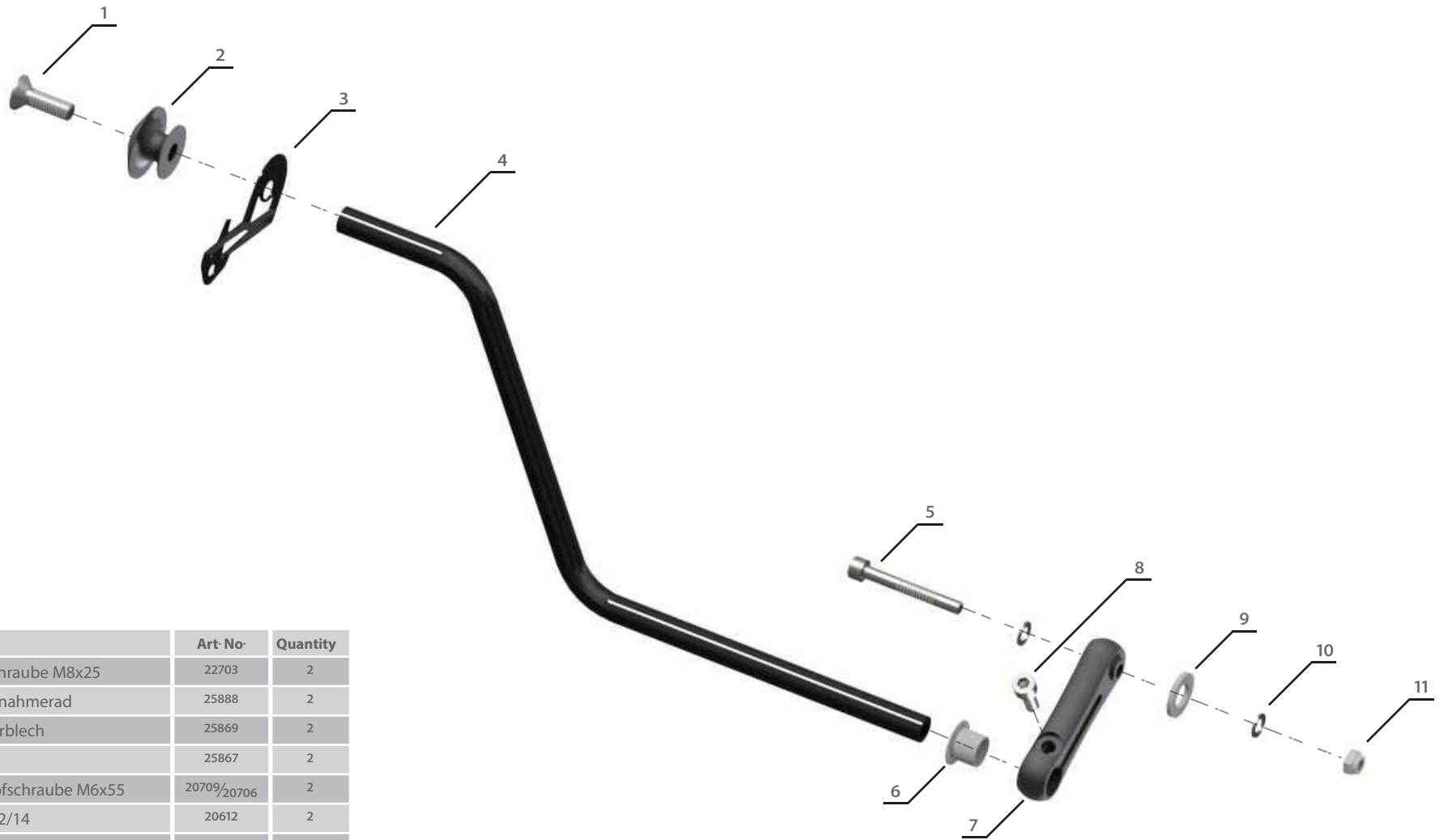
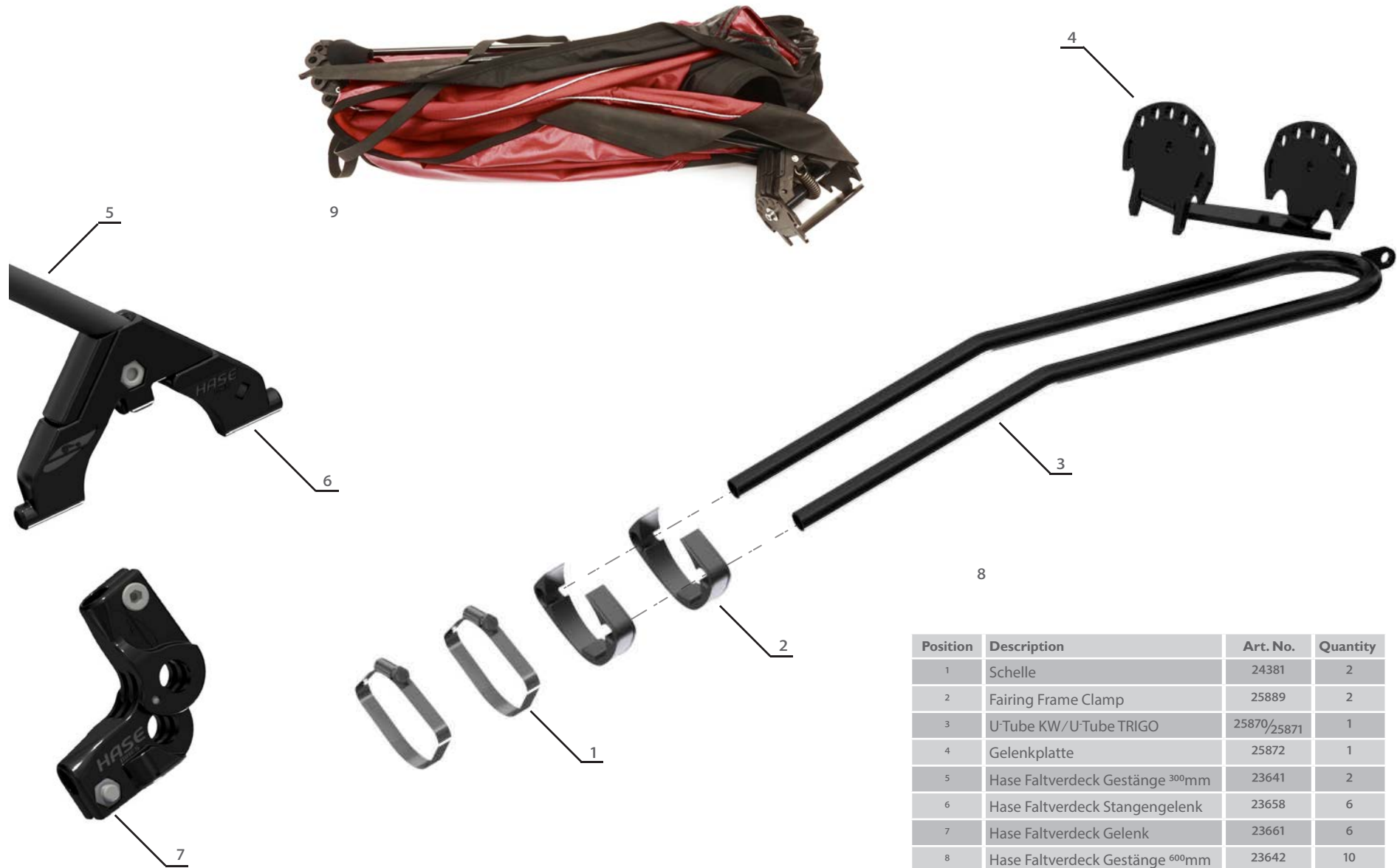

Fig. 21: Make sure that the ends of the straps are clamped between the respective hook and rod (as shown).



Position	Description	Art- No-	Quantity
1	Senkkopfschraube M8x25	22703	2
2	Stangenaufnahmerad	25888	2
3	Schließfederblech	25869	2
4	Side Z-Tube	25867	2
5	Zylinderkopfschraube M6x55	20709/20706	2
6	Gleitlager 12/14	20612	2
7	Rohrklemmhebel	25865	2
8	Zylinderkopfschraube M6x16	20581	2
9	Zahnscheibe M10	25772	2
10	Unterlegscheibe VA M6	20686	4
11	Sicherheitsmutter M6	20643	2

Replacement Parts



Position	Description	Art. No.	Quantity
1	Schelle	24381	2
2	Fairing Frame Clamp	25889	2
3	U-Tube KW/U-Tube TRIGO	25870/25871	1
4	Gelenkplatte	25872	1
5	Hase Faltverdeck Gestänge 300mm	23641	2
6	Hase Faltverdeck Stangengelenk	23658	6
7	Hase Faltverdeck Gelenk	23661	6
8	Hase Faltverdeck Gestänge 600mm	23642	10
9	Hase Faltverdeck Redesign ROT	25885	1

Safety information

Read User's Manual

Read this User's Manual carefully, and familiarize yourself with the construction and function of the Foldable Fairing. It's also important to read and observe all safety, installation, and operating instructions in the User's Manual for the trike with which the fairing is being used.

Intended use

The Foldable Fairing can only be used with trikes from HASE BIKES. The use of the Foldable Fairing with other vehicles is prohibited. HASE BIKES assumes no liability for any consequential damage.

Mounting and adjustment

Your authorized HASE BIKES retailer has mounted the Foldable Fairing and adjusted it to your height. See section "Adjusting the height and width of the Foldable Fairing" on page 5 for instructions on adjusting the fairing to another rider.

If you are mounting the Foldable Fairing yourself, be sure to follow the mounting instructions in this manual. When mounted, the Foldable Fairing should in no way restrict the rider's field of vision or the movement of the steering controls. The handlebar grips and brake levers must remain freely accessible.

Use of the Rain Poncho

When using the optional Rain Poncho, be sure that it does not in any way restrict movement of the torso and arms and, above all, that it is still possible to make the necessary hand signals and turn your head for looking over your shoulder. Check that the Rain Poncho is not covering the taillight.

If a trike is adjusted for very short riders, the Rain Poncho will probably hang in front of the taillight. In this case, do not, under any circumstances, ride the trike with the Rain Poncho. Ask a qualified bicycle mechanic to adjust the Rain Poncho accordingly.

Riding in windy conditions

A trike with a Foldable Fairing has a greater surface area, making it more susceptible to wind gusts. This can affect vehicle handling. A strong gust of wind could lift up the vehicle, push it into another lane, or even tip it over. For this reason, HASE BIKES strongly advises never to ride with the Foldable Fairing in windy conditions.

Parking in windy conditions

In windy conditions, we recommend removing the Foldable Fairing when parking your trike out-doors.

Otherwise, a gust of wind could tip over the vehicle or cause it to roll away. If you do not remove the Foldable Fairing, then be sure to secure the parked vehicle from tipping or rolling. A Kettwiesel, Trix, or Lepus that has been adjusted for a very short rider cannot be parked upright (on end) with a mounted Foldable Fairing, as this would damage the fairing.

Foldable Fairing Adjustment

Being visible for others

Visibility is generally poor in wet weather. Therefore, it may be more difficult for other road users to see you. HASE BIKES recommends riding with your lights on in wet weather to make it easier for other road users to see you.

Be sure to adjust the headlight properly so that it does not blind other road users. Risk of accident! Keep in mind that high-quality LED headlights are especially bright and produce long beams of light.

Caution when opening the Foldable Fairing

Use caution when releasing the catch on the side mount of the Foldable Fairing. The frame tension could cause the fairing to spring open, possibly injuring bystanders. Be sure that no one is standing near the fairing before you release the catch.

Before each ride

Check the Foldable Fairing to make sure it is mounted correctly. A fairing that has been improperly mounted could open during the ride and injure you or other road users or cause accidents.

Technical condition

The Foldable Fairing should only be used if it is in perfect technical condition and mounted properly. Before each trip, be sure to check the condition of the fairing and vehicle for possible faults or damage.

Conditions of warranty and liability

The terms and conditions are based on the statutory warranty. This excludes parts that wear, such as the chain, tires, brakes, etc. The warranty period (statutory) of 24 months commences from the date of purchase. This warranty covers defects in material and craftsmanship. The HASE BIKES warranty does not cover normal wear and tear, unauthorized modifications or alterations, improper use, improper maintenance, accident, misuse, negligence, damage, or if the product is used for a purpose for which it was not designed. If we determine that the damage was a result of normal wear and tear, abuse or accident, or exceeding reasonable expectations of the products lifespan, repairs can normally be made at a reasonable cost, depending on the individual case.

Care

Wash your Foldable Fairing by hand using water with no chemicals. Never machine wash or dry your Foldable Fairing. Make sure the Foldable Fairing is dry and clean before folding it up for storage.



Hase Bikes
Hiberniastraße 2
45731 Waltrop
Germany

Phone +49 (0) 23 09 / 93 77-0

Fax +49 (0) 23 09 / 93 77-201

info@hasebikes.com

www.hasebikes.com