

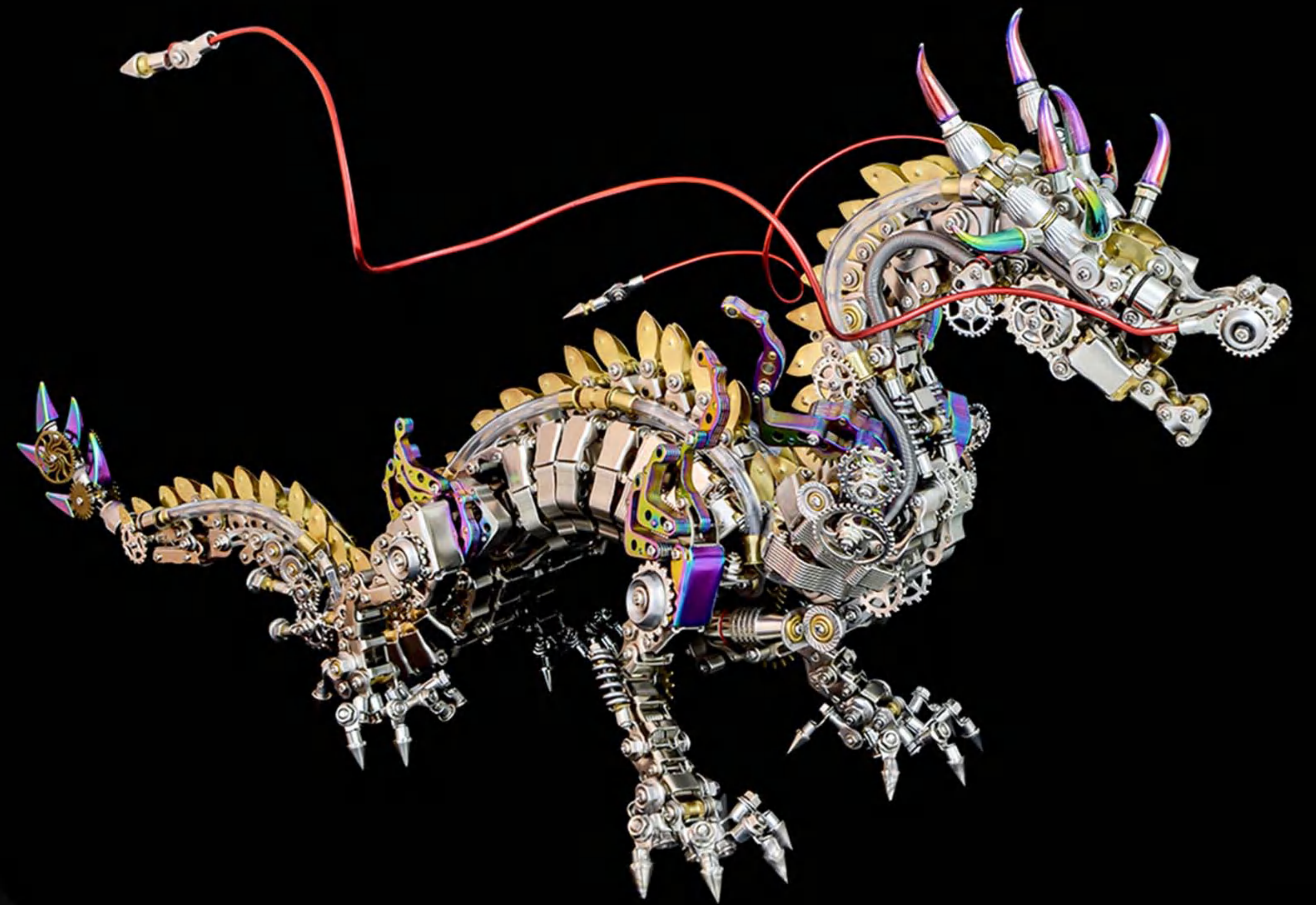

Difficulty in assembly: ★★★★★★



Warm tips: the package contains small parts, please do not swallow.



Accessories display

AF*41	AF25*19	A2*300	A3*35	A4*4	A5*5	A25*18	AY4*2	AB2*2
B5*3	B6*7	B10*9	B12*80	B14*67	B16*77	B18*23	B20*16	B22*7
B25*19	B28*12	B30*5	B32*1	B35*6	B38*7	B40*5	B45*2	B50*1
BA10*11	BA12*4	BA18*4	BA25*2	BA28*2	BA30*2	BB9*22	BB10*38	BB12*8
BB16*2	CA8*29	CA10*7	CA3*12	CB45*46	CB4*8	CB7*19	CB8*30	CB9*20
CB11*15	CC10*2	D1*2	CD1*2	LD1*2	D5*138	D8*83	E8*94	E10*30
E12*12	E14*4	F1*47	F2*8	F3*10	F4*16	FG60*2	FW1*2	FW2*4
FW3*8	G2*8	G3*1	G5*44	G6*24	DG7*4	G9*3	CG9*2	G10*45
SG10*5	G13*23	G15*1	GX78*8	G16*6	HX40*2	HX9*2	H1*39	H2*26
I1*4	I2*29	I22*6	I25*3	I27*3	C12*6	C124*14	I4*8	C14*6
J2*101	L1*10	L3*16	L5*6	TL6*6	DTL6*2	TL7*4	TL8*2	L9*2
TL10*2	M3*21	Q1*22	CR1*5	CY1*8	T1*16	U4*2	YV1*84	V4*1
V6*7	V10*1							

Due to different production batches, the shapes and colors of parts may vary.
Please refer to the actual products.

Tool instructions

Toolkit introduction



Small wrench



Cross copper



Dolt driver



Small screwdriver

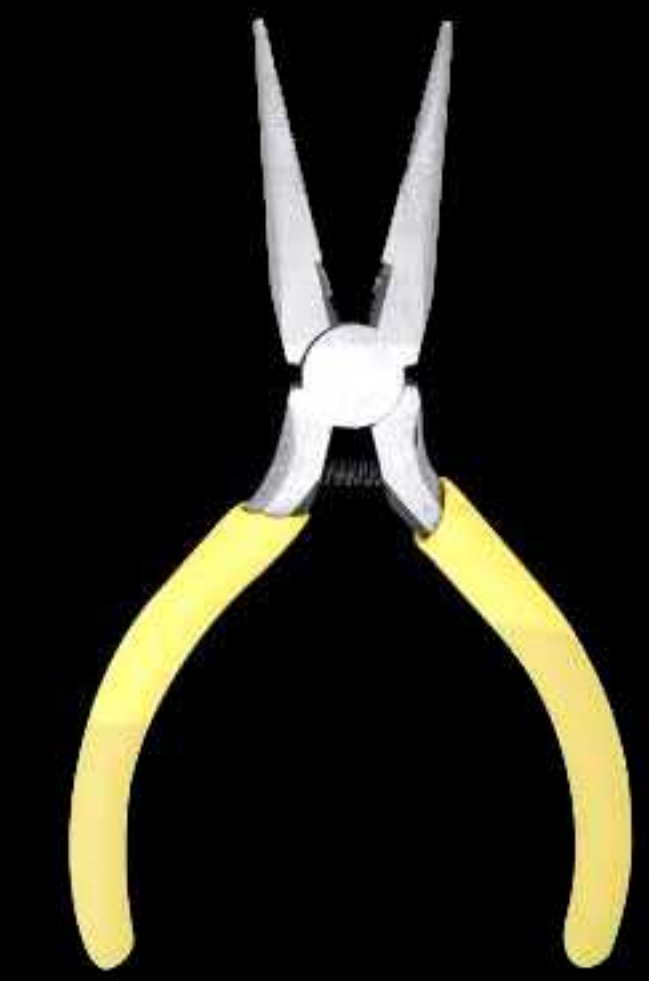

Needle nose pliers

Tool usage example



1.First screw A2-F into B2-14 by hand.

2.After clamping A2-F with pointed nose pliers, screw B2-14 in clockwise with a small screwdriver.

3.The fastening is completed by screwing A2-F until it is not loose between parts

Assembly skills, screws are preferred.

(X2 ▲▲) Means: assemble 2 and horizontally symmetrical.

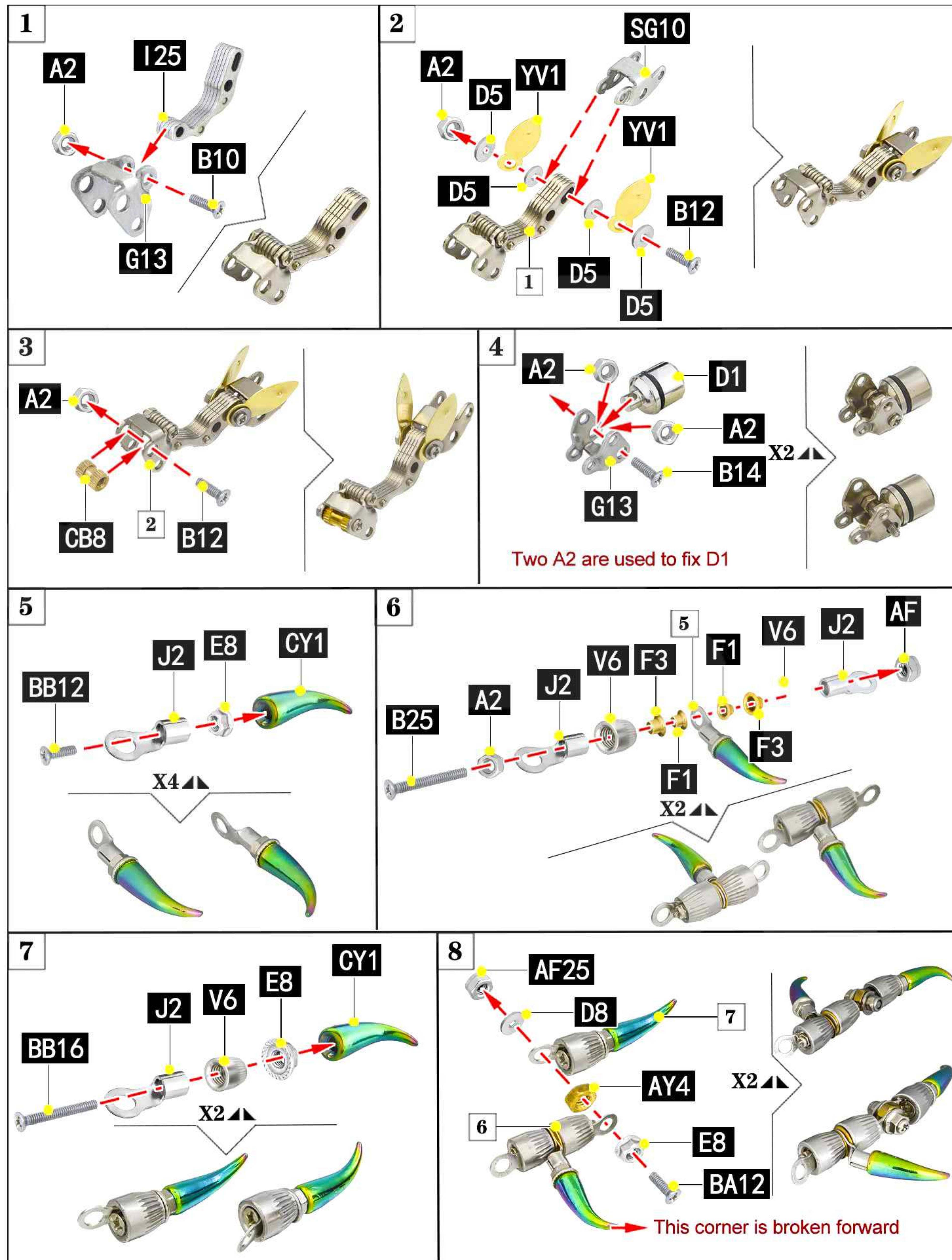

(X2 ▲▲) Means: assemble 2 and the direction is the same.

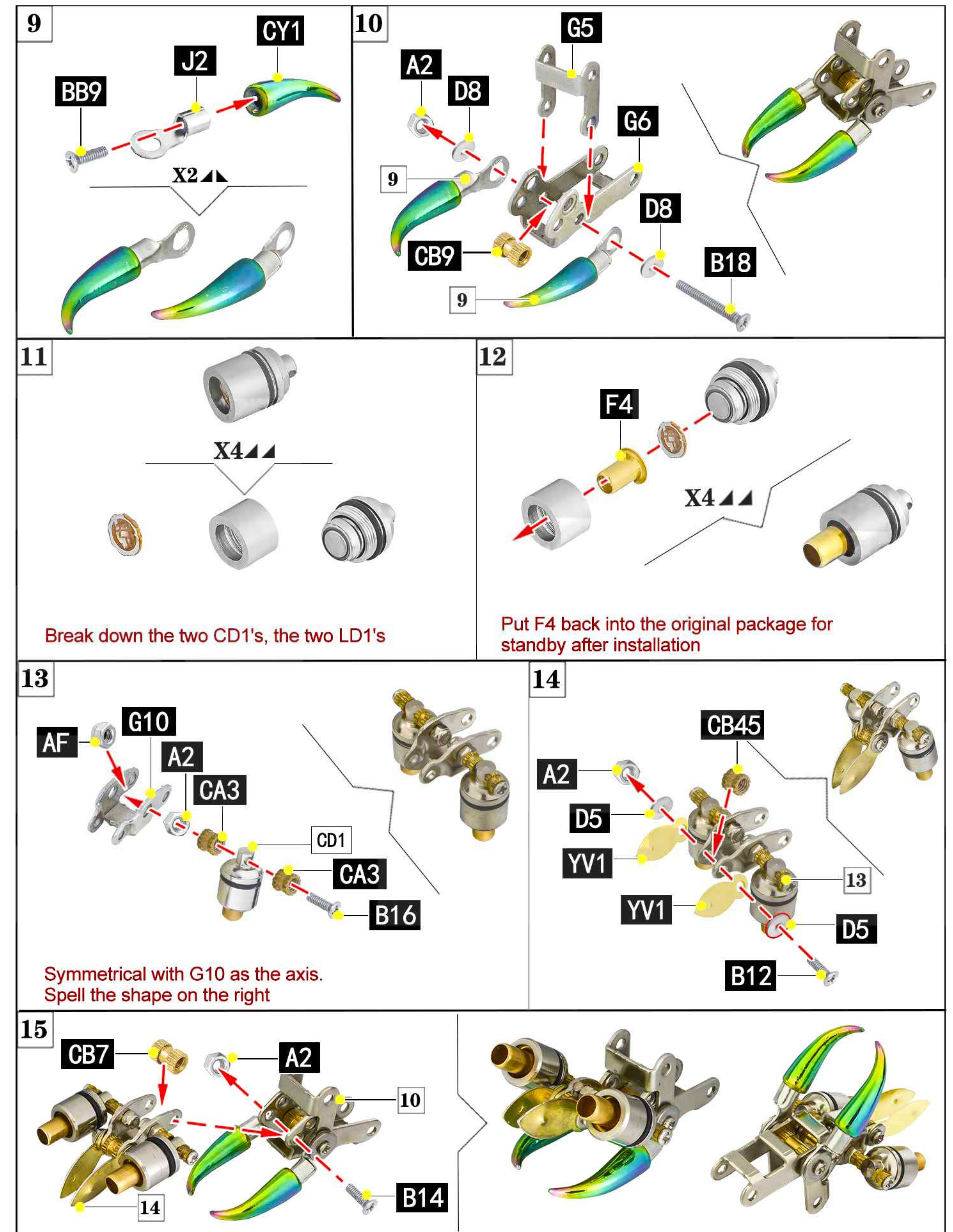

Assembly skills, screws are preferred. (X2 ▲▲) Means: assemble 2 and horizontally symmetrical.

16

17

18

The holes with four blue points should be aligned

(X2 ▲▲) Means: assemble 2 and the direction is the same.

19

20

21

22

23

Assembly skills, screws are preferred. (X2 ▲▲) Means: assemble 2 and horizontally symmetrical.

(X2 ▲▲) Means: assemble 2 and the direction is the same.

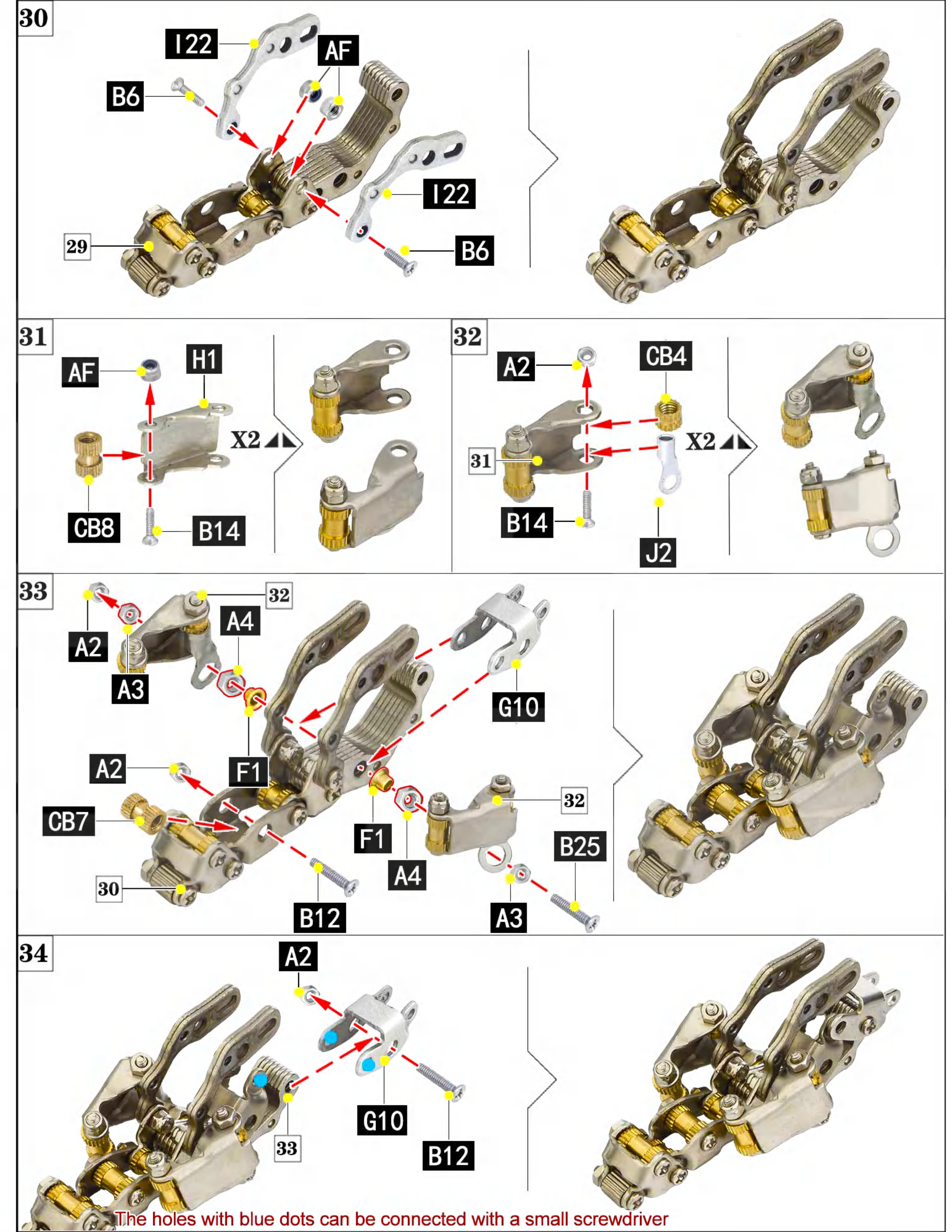
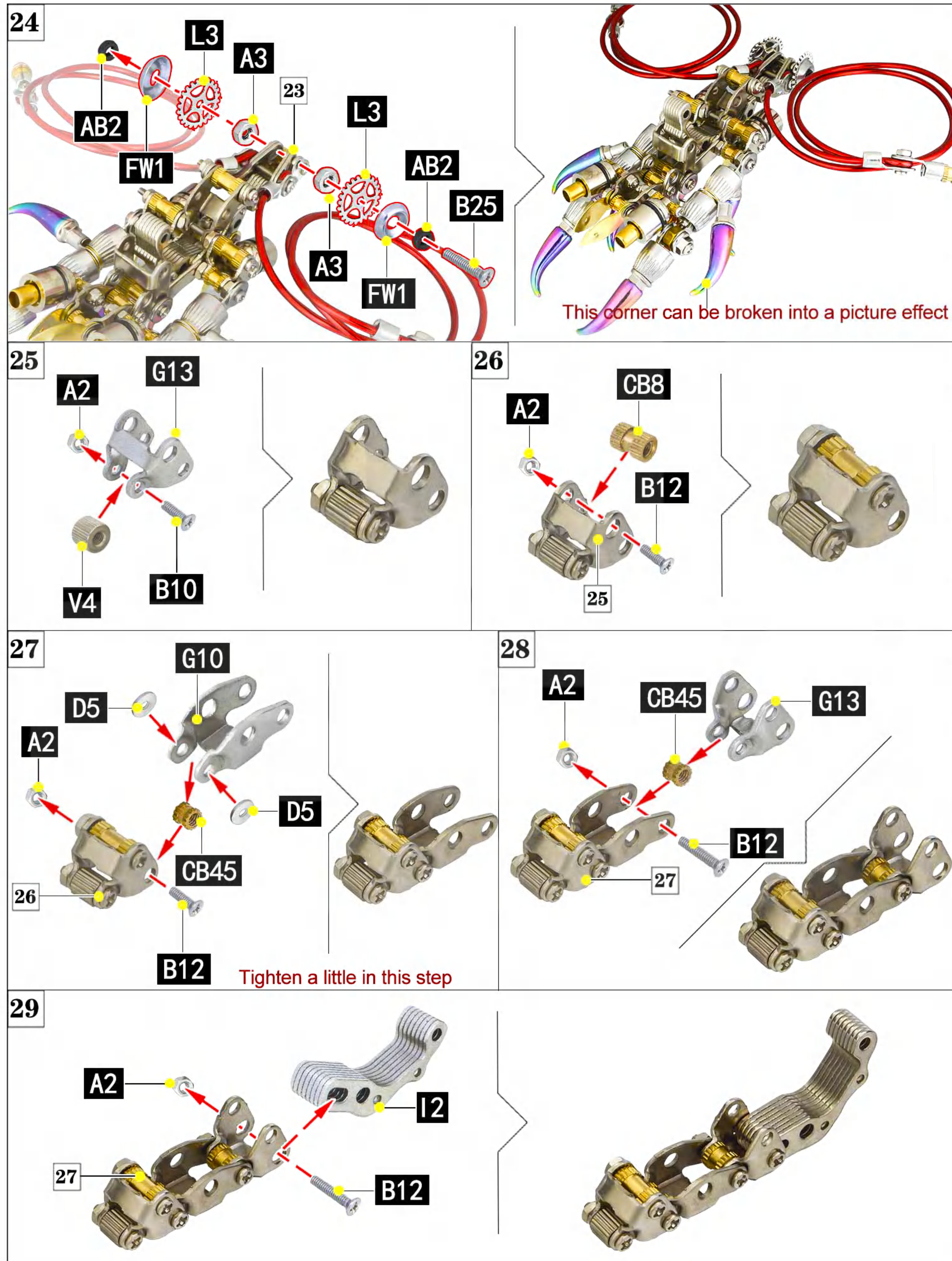

Assembly skills, screws are preferred. (X2 ▲▲)Means: assemble 2 and horizontally symmetrical.

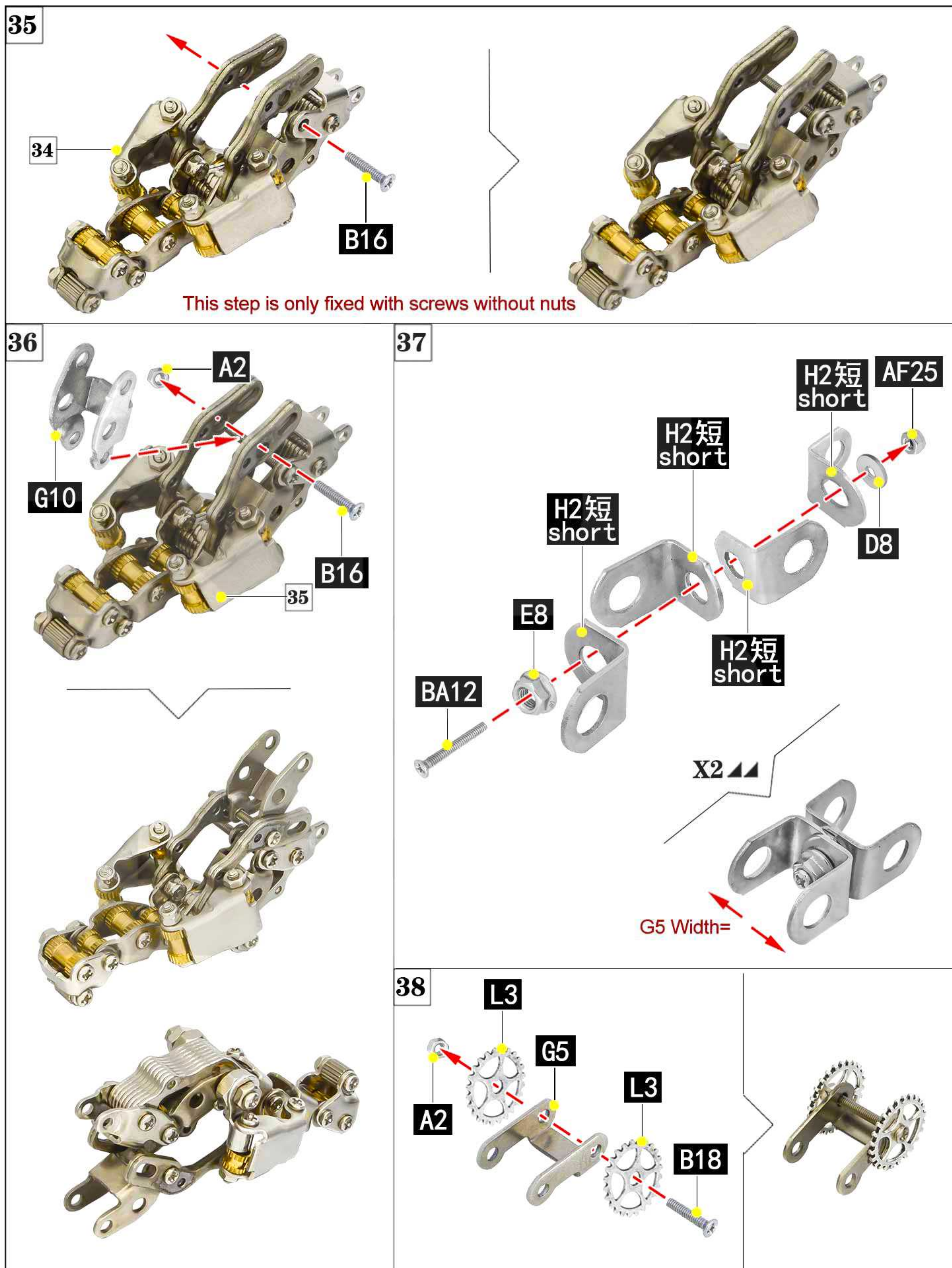

(X2 ▲▲)Means: assemble 2 and the direction is the same.

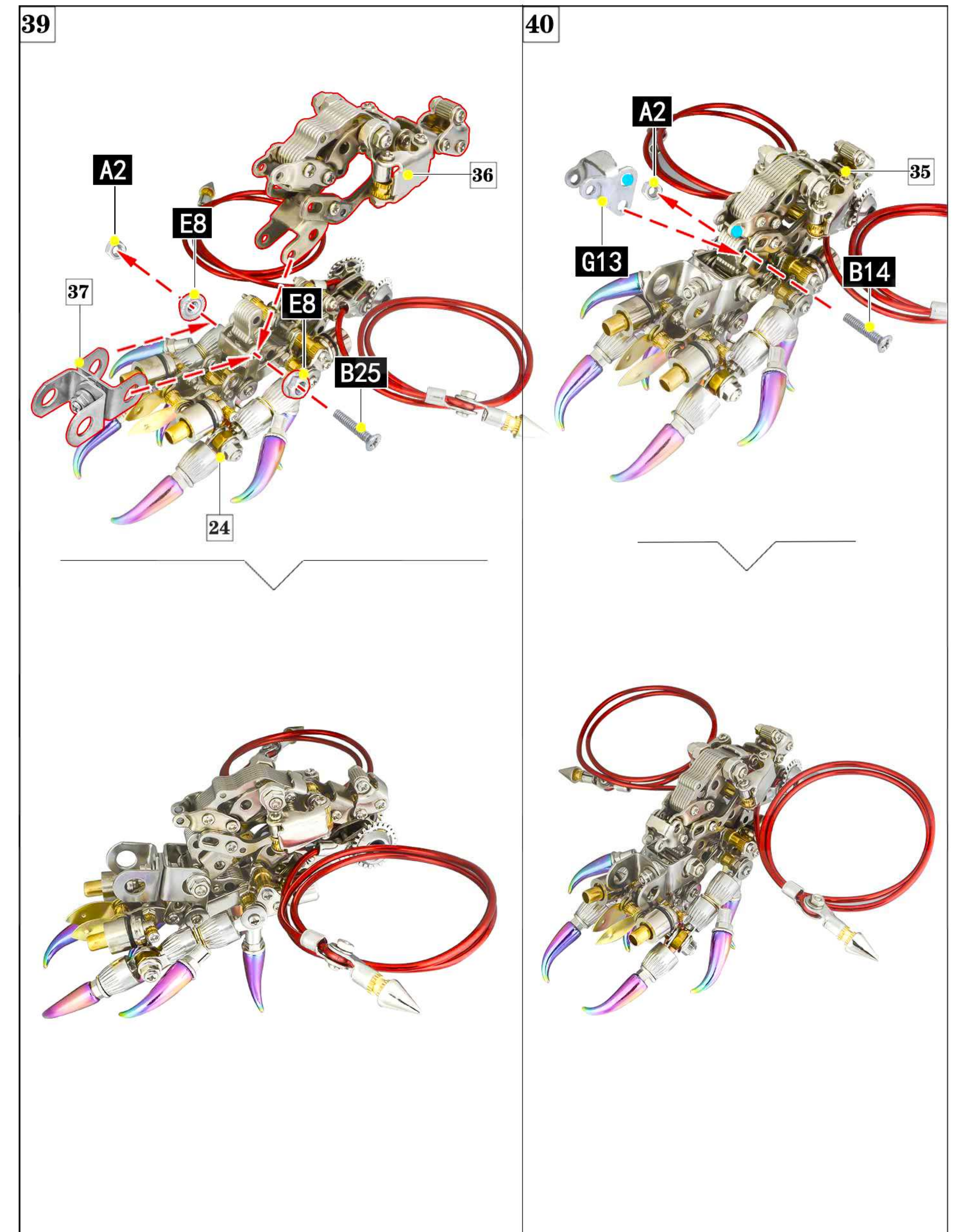

Assembly skills, screws are preferred. (X2 ▲▲) Means: assemble 2 and horizontally symmetrical.

41

HX9

G16

Use Pliers to bend one end of HX9 into a circle, size reference below, and then put G16 into the other end of HX9, as shown below

X2 ▲▲

43

G16

A2

B14

G13

42

X2 ▲▲

42

41

Use Pliers to bend the other end of the HX9 into a circle

X2 ▲▲

44

A2

43

CA3

CB45

40

38

CB45

43

B35

Use a small screwdriver to align holes

Pay attention to the spring position

(X2 ▲▲) Means: assemble 2 and the direction is the same.

45

Remove the blue position screw first

A2

L3

E8

FW3

FW3

CB4

44

L5

D8

CB4

FW3

L3

B38

E8

46

A2

D5

A3

A3

D5

B20

45

The head will be dense, if the cavity is large. You can adjust dense points.

Assembly skills, screws are preferred. (X2 ▲▲) Means: assemble 2 and horizontally symmetrical.

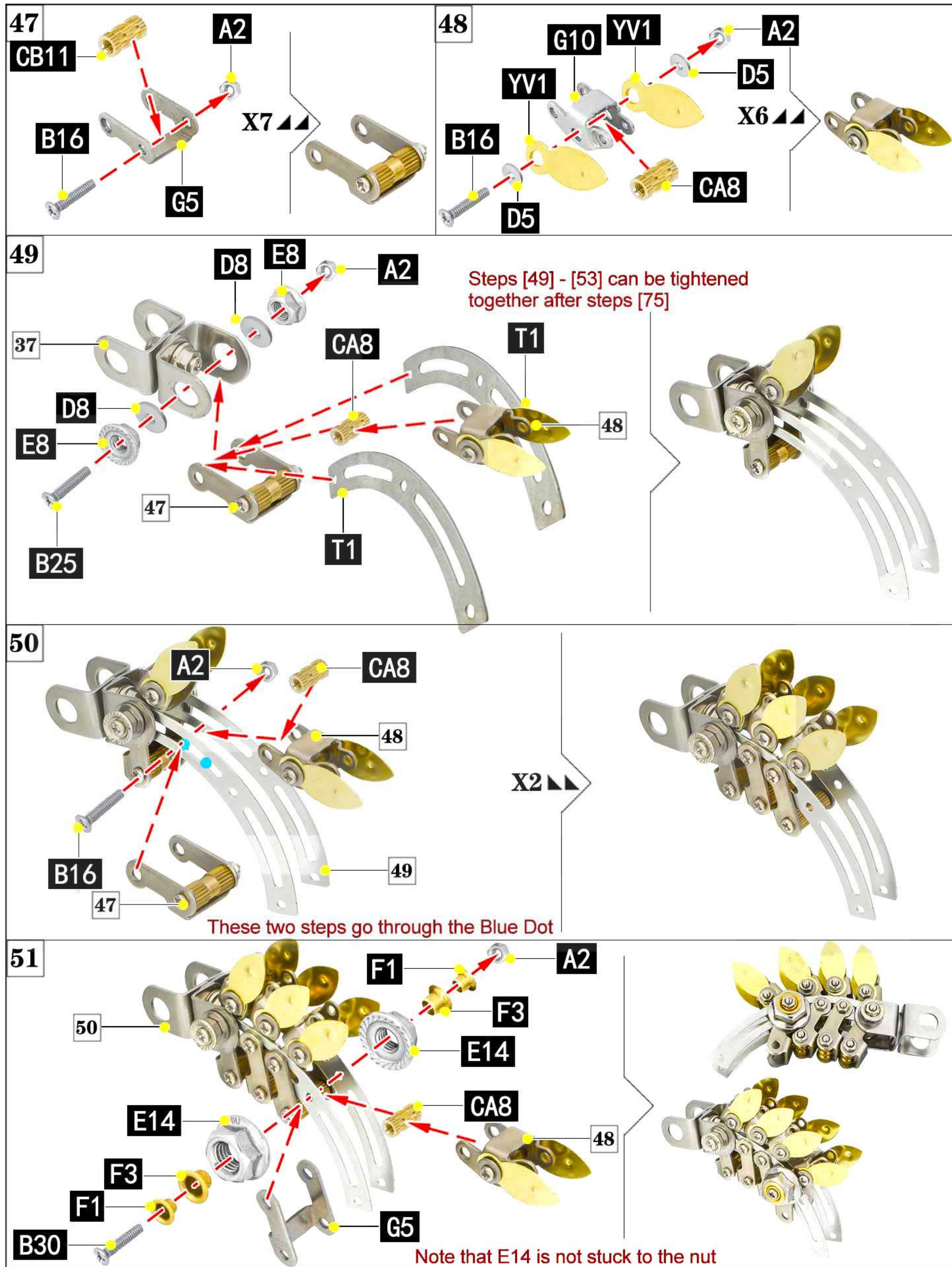

(X2 ▲▲) Means: assemble 2 and the direction is the same.

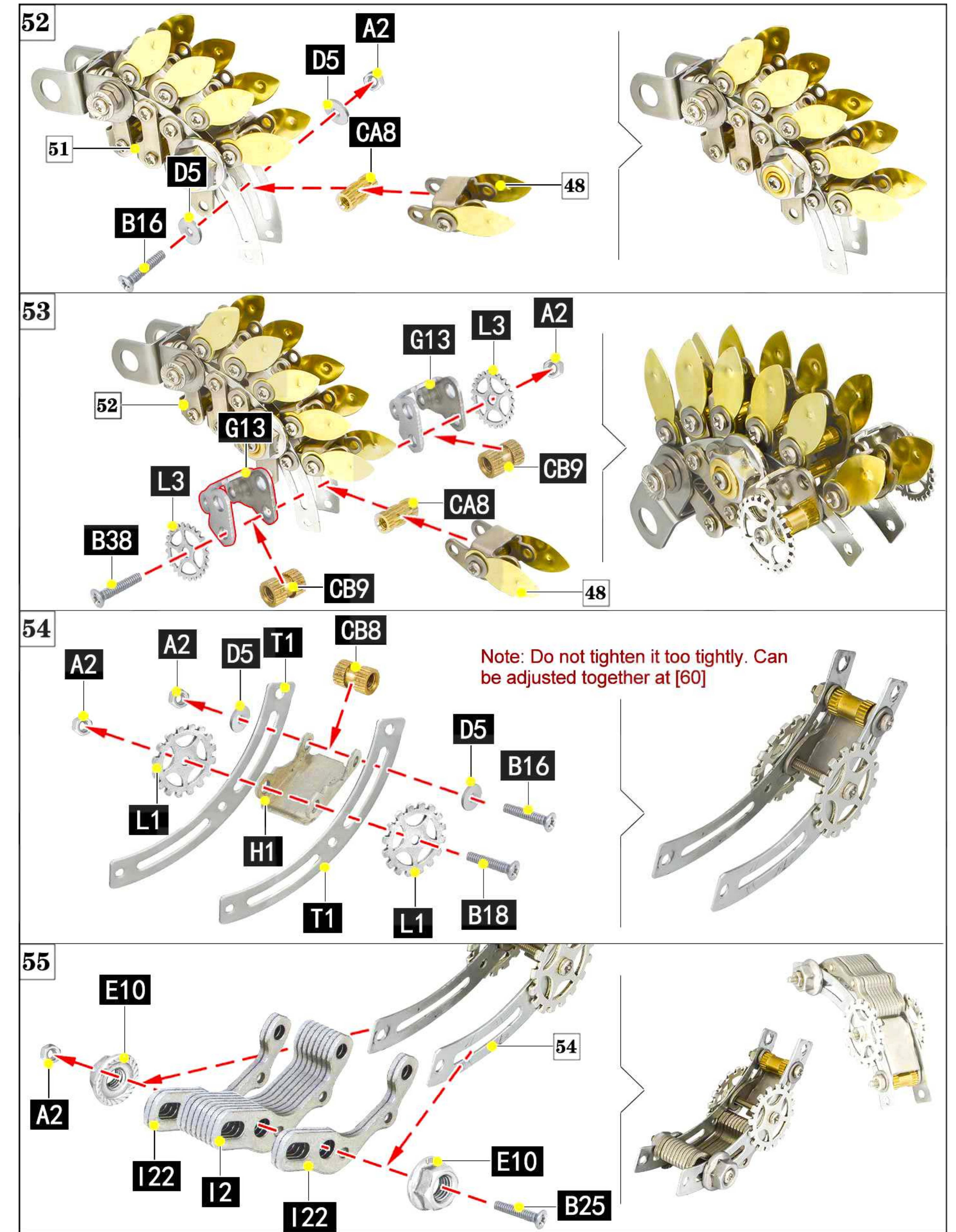

Assembly skills, screws are preferred. (X2 ▲▲) Means: assemble 2 and horizontally symmetrical.

(X2 ▲▲) Means: assemble 2 and the direction is the same.

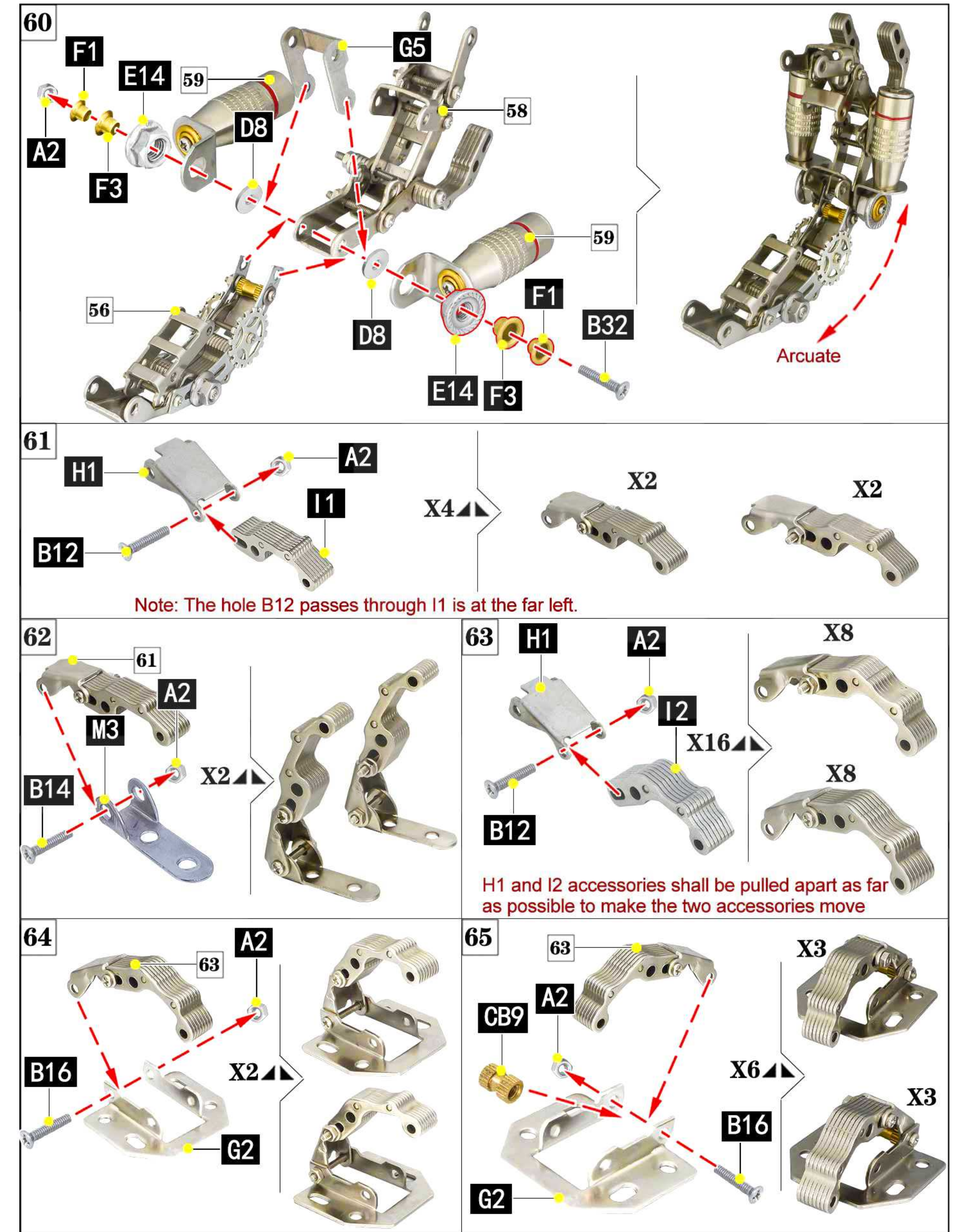
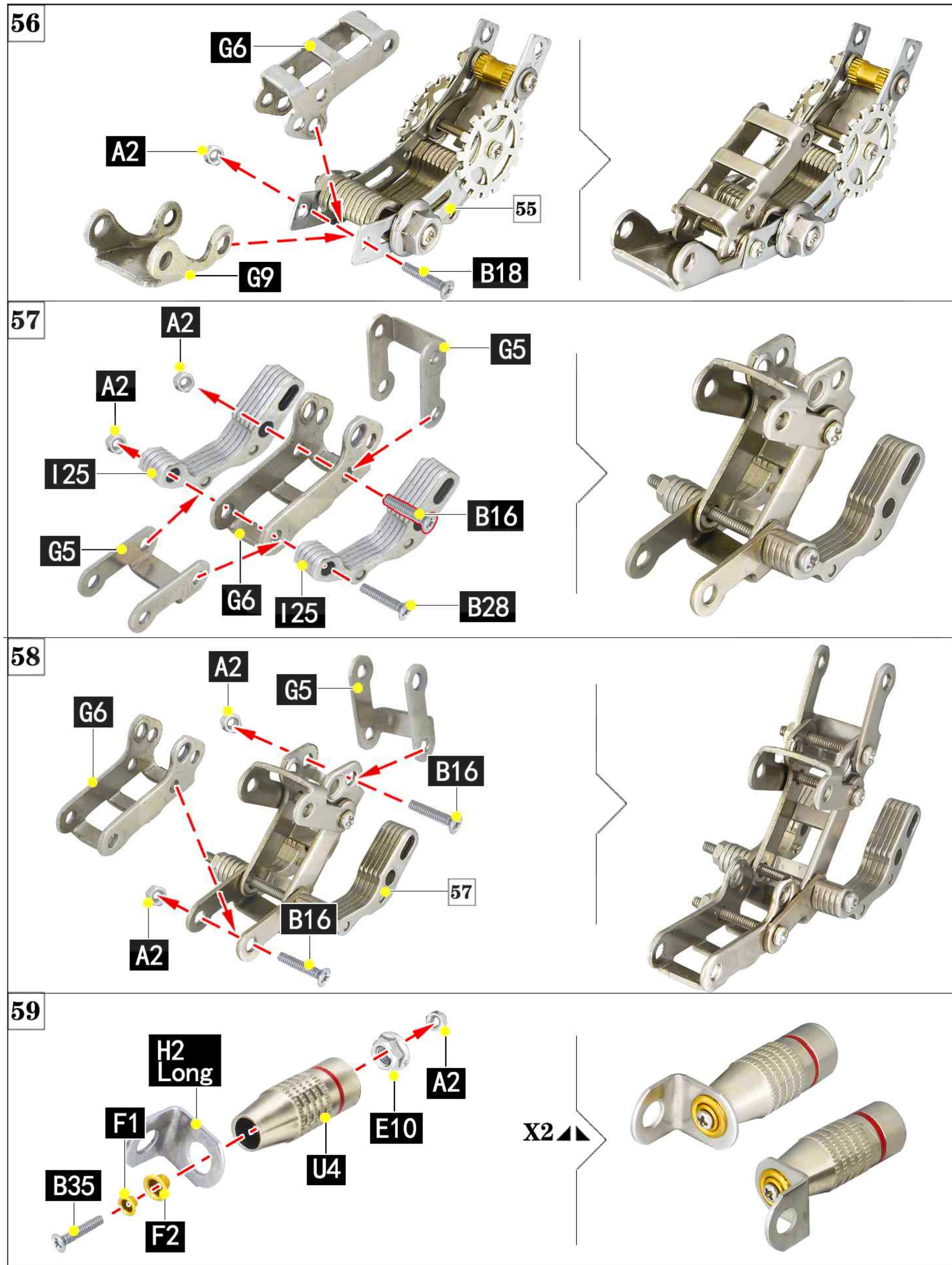

Assembly skills, screws are preferred. (X2 ▲▲)Means: assemble 2 and horizontally symmetrical.

(X2 ▲▲)Means: assemble 2 and the direction is the same.

