

NOTES:

1.HI-POT: 1800VAC/1sec., 2mA

REV	DESCRIPTION	DATE	APPROVE
P1	PRELIMINARY	14/05/06	SQ
P2	PRELIMINARY	14/06/11	SQ
P3	PRELIMINARY	14/06/20	LXN

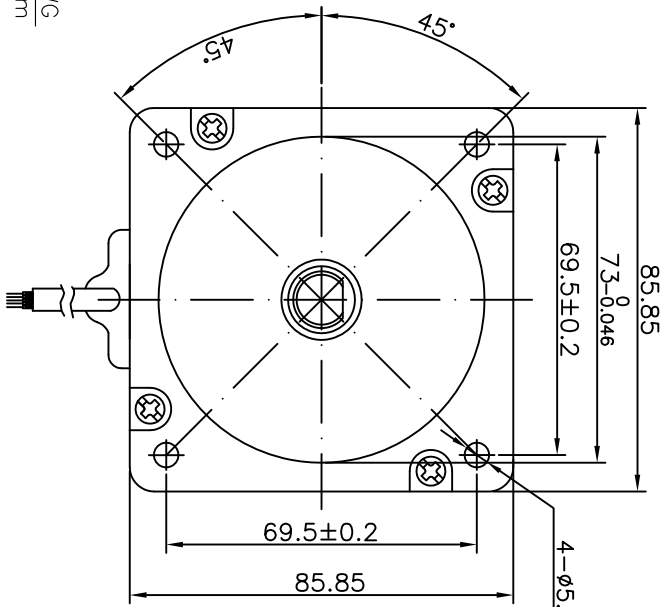
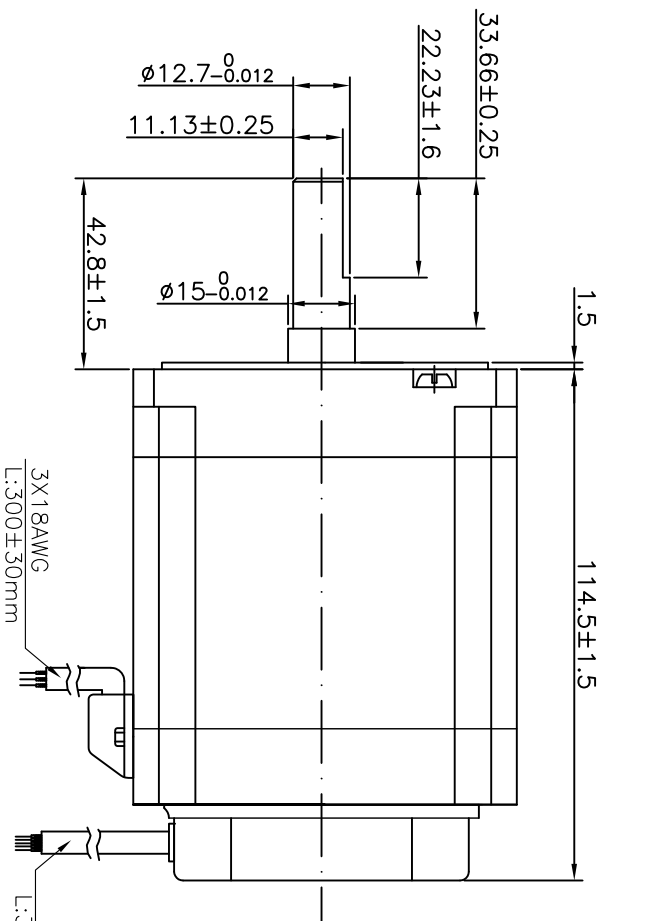

**Exmex Electric**  
P/N: ME086AS215 REV: P3  
S/N:XXXXXXXX WW/YY  
120VDC: 1.4Nm: 3000RPM  
Made in China

Motor Specification	
Resistance	1.2 Ohms±10%
Inductance	3.4 mH±20%
Voltage	120 VDC
Rated power	440 W
Rated Speed	3000 rpm
Rated Current	4.8 A
Rated Torque	1.4Nm
Peak Current	14.4 A
Peak Torque	4.2 Nm
Ke(RMS)	21 V/Krpm
KT	0.29Nm/A
Number of Poles	8
Insulation Class	B
Weight	2.6 Kg

ELECTRICAL DEGREES	TIMING DIAGRAM							
	60°	120°	180°	240°	300°	360°	ROTATION: CLOCKWISE AS VIEWED FROM SHAFT END.	
HALL A								
HALL B								
HALL C								
PHASE R-S								
PHASE S-T								
PHASE								

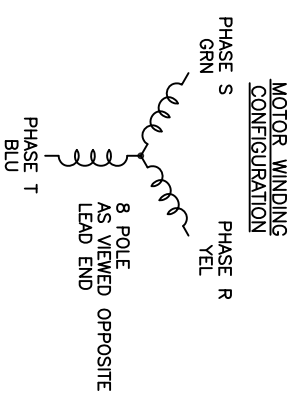

CONNECTION CHART	
COLOR	FUNCTION
YELLOW	PHASE R
GREEN	PHASE S
BLUE	PHASE T
YELLOW	HALL A
GREEN	HALL B
BLUE	HALL C
RED	+5 VDC
BLACK	GROUND

NOTE: THIS DRAWING HAS BEEN CREATED BY AUTOCAD. MANUAL REVISIONS ARE NOT ALLOWED.

MATERIAL	TOLERANCE UNLESS OTHERWISE SPECIFIED ISO 2768-1 MEDIUM		
DRAWN	CHECKED	APPROVED - DATE	SCALE
			N/A



SERVO MOTOR  
ME086AS215  
SHEET 1/1

THIS DRAWING AND THE INFORMATION DISCLOSED HEREIN ARE PROPRIETARY DATA OF EXMEX ELECTRIC CO., LTD., AND IS TO BE IMMEDIATELY RETURNED UPON REQUEST. REPRODUCTION OF THIS DRAWING OR THE INFORMATION DISCLOSED HEREIN IS PROHIBITED WITHOUT THE EXPRESS WRITTEN APPROVAL OF EXMEX.