

RemotePoint®

# Emerald Navigator

Presentation Remote



Users Manual  
VP4450

## CAUTION



LASER RADIATION - DO NOT  
STARE INTO BEAM

WAVE LENGTH: 532nm  
MAX OUTPUT: <1mW

CLASS II LASER PRODUCT



### **FCC Certification**

This device complies with Part 15 of the FCC Rules.

Operation is subject to the following two conditions:

(1) This device may not cause harmful interference, and (2) This device must accept any interference received, including interference that may cause undesired operation.

This equipment has been tested and found to comply with the limits for a CLASS B digital device, pursuant to Part 15 of the FCC rules. These limits are designed to provide reasonable protection against harmful interference when the equipment is operated in a residential installation. This equipment generates, uses, can radiate radio frequency energy and if not installed and used in accordance with the instruction guide, may cause harmful interference to radio communications. However, there is no guarantee that this radio interference will not occur in a particular installation. If this equipment does cause harmful interference to radio or television reception, which can be determined by turning the equipment on and off, the user is encouraged to try to correct the interference by one or more of the following measures:

- Re-orient or relocate the receiving antenna.
- Increase the separation between the equipment and the receiver.
- Consult the dealer or an experienced Radio-TV technician for help.

**Notice:** Any changes or modifications not expressly approved by the party responsible for compliance could void the user's authority to operate the equipment. Extension cables are not recommended, if used, they must be shielded in order to comply with the emission limits.

### **IC Certification**

Under Industry Canada regulations, this radio transmitter may only operate using an antenna of a type and maximum (or lesser) gain approved for the transmitter by Industry Canada. To reduce potential radio interference to other users, the antenna type and its gain should be so chosen that the equivalent isotropically radiated power (e.i.r.p.) is not more than that necessary for successful communication.

This device complies with Industry Canada licence-exempt RSS standard(s). Operation is subject to the following two conditions: (1) this device may not cause interference, and (2) this device must accept any interference, including interference that may cause undesired operation of the device.

Conformément à la réglementation d'Industrie Canada, le présent émetteur radio peut fonctionner avec une antenne d'un type et d'un gain maximal (ou inférieur) approuvé pour l'émetteur par Industrie Canada. Dans le but de réduire les risques de brouillage radioélectrique à l'intention des autres utilisateurs, il faut choisir le type d'antenne et son gain de sorte que la

puissance isotrope rayonnée équivalente (p.i.r.e.) ne dépasse pas l'intensité nécessaire à l'établissement d'une communication satisfaisante.

Le présent appareil est conforme aux CNR d'Industrie Canada applicables aux appareils radio exempts de licence. L'exploitation est autorisée aux deux conditions suivantes : (1) l'appareil ne doit pas produire de brouillage, et (2) l'utilisateur de l'appareil doit accepter tout brouillage radioélectrique subi, même si le brouillage est susceptible d'en compromettre le fonctionnement.

### **Declaration of Conformity**

Manufacturer:

SMK-Link Electronics, Inc.

3601-B Calle Tecate

Camarillo, CA 93012

We declare under our sole responsibility that the VP4450 conforms to the following directives and norms:

Directive 89/336/EEC, Amended by 93/68/EEC

EMI: EN 55022 (1992) Class B

EMC: EN 50082-1 (1992)

Directive 73/23/EEC, Amended by 93/68/EEC

Safety: EN 60950: 2000

## LASER Safety Statement

**CAUTION: Use of controls or adjustments or performance of procedures other than those specified herein may result in hazardous radiation exposure.**

The laser is activated by pressing laser button identified in the user guide.

- Do not stare into laser beam.
- Do not shine a laser pointer at anyone.
- Do not allow minors to use laser pointer unsupervised.
- Do not point laser pointer at any reflective surface. A reflected beam can be the same as a direct beam.
- Do not disassemble the device.
- Do not immerse in any liquid or expose to heat or moisture.
- Use only within the designed operating temperature range of 0-40 deg C.
- This product has no serviceable parts.

### **Laser Specifications:**

The following product complies as a Class 2 laser product with: IEC/EN 60825-1: 199+A1+A2, and CFR Title 21 1040.10 and 1040.11, except for deviations pursuant to Laser Notice No.50, dated June 25, 2007.

## CAUTION

LASER RADIATION



DO NOT STARE  
INTO BEAM

WAVELENGTH: 532nm

MAX OUTPUT: <1mW

CLASS II LASER PRODUCT

SMK-LINK

3601-B Calle Tecate, Camarillo, CA. 93012

[www.smklink.com](http://www.smklink.com)



"COMPLIES WITH CFR 21,  
SUBCHAPTER J"

MODEL NO. VP4450

SN:

MADE IN MEXICO



### Avoid Exposure

Laser radiation is  
emitted from this aperture



FCC ID: IE3VP445008

IC: 3683C-VP445008

This device complies with Part 15 of the FCC rules.  
Operation is subject to the following two conditions:  
(1) this device may not cause harmful interference, and  
(2) this device must accept any interference received,  
including interference that may cause undesired operation.

SMK-Link, VP4450

## Overview

Congratulations on your purchase of the VP4450 Emerald Navigator Presentation Remote. The VP4450 offers full control of presentations, customizable buttons to work with other programs, and the brightest laser in its class.

## Installation

Open the battery compartment by pressing down on the latch and sliding open. Insert the batteries per the diagram on the remote. Standard AA alkaline batteries are recommended.

The receiver and remote come pre-paired at the factory. The remote will automatically adjust frequencies and channels to ensure reliable communication.

Should you have any problem with communication, you can re-pair them by opening the battery door and plugging the USB receiver into USB port below the batteries. Plug the USB receiver into a free USB port, wait a few seconds for the device to be recognized by your computer and you are ready to control your presentation.

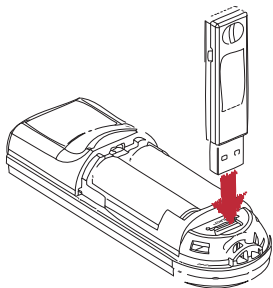
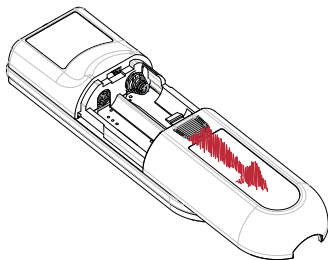

## Familiarizing Yourself with the Controls

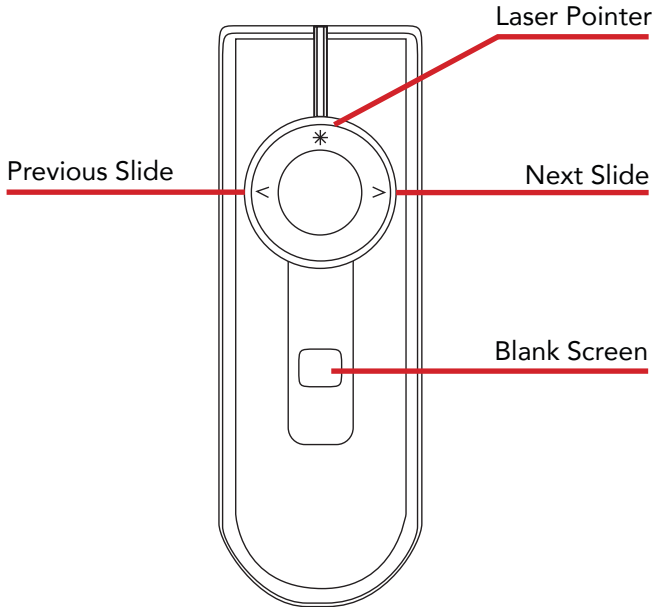

## Using the Laser Pointer

Press the button on the top of the ring to activate the laser pointer. The laser pointer can be used to highlight important points on slides and graphs. Because the laser emits a green beam it will appear much brighter than a standard laser beam.

### **Custom Programming**

The buttons on the VP4450 can be customized to send a wide variety of keystrokes to meet your needs. The software is available online at: [www.smklink.com](http://www.smklink.com)

From the program, select the desired keys and click "Program Receiver." Once programmed, these changes are written to non-volatile memory on the receiver.

Because the keys are stored on the receiver, any machine you plug it into will send these keys without any need for software.



## Product Specifications

- Laser: 532 nm green class II laser
- Laser Power: max < 1 mW
- Battery Type: 2 x AA alkaline batteries
- Battery Usage: Approx. six months
- Frequency: 2.4 GHz auto RF
- Range: Up to 100 feet

## System Requirements

Operation:

- Windows® or Mac® PC
- USB port

## Button Customizing

- PC running Windows XP® and up
- Downloadable software from:  
[www.smklink.com](http://www.smklink.com)

## For Product Support Please Contact

SMK-Link Electronics, Inc.  
3601-B Calle Tecate  
Camarillo, CA 93012 USA

(888) 696-3500  
(805) 987-6665  
[www.smklink.com](http://www.smklink.com)

Thank you for purchasing the VP4450 RemotePoint® Emerald Navigator Presentation Remote. We know you had other choices and we appreciate that you chose SMK-Link Electronics for your wireless needs. So that we may better serve you in the future, please register online at [www.smklink.com](http://www.smklink.com)



