



3M Mounting Installation Guide

ORDER INCLUDES

- 1 x Control Box
- 1 x GTI/GLI LED Badge
- 1x 3M VHB Tape (pre-applied)
- 1 x Inline Fuse with 5A Fuse
- 2 x Ring Terminals
- 1 x Straight Connector

HOW TO INSTALL

- 1. Disconnect the car battery.**
- 2. Remove the OEM GTI/GLI Badge** from your grill. Typically, these badges are secured with clips behind the grill, requiring bumper removal for access. After removal, you'll have a flat plastic section with holes and slots.
- 3. Use the provided stencil** to drill a hole in the flat plastic section for the wire passage. Align the stencil with your desired logo placement, mark the hole location, and drill. The hole matches the wire's widest point for precise shaping.
- 4. Thread the wire** through the drilled hole and affix the logo onto the grill. Ensure the surface is clean and dry before applying the 3M adhesive. Press the logo firmly onto the grill for at least a minute to ensure a strong bond. If needed, soften the plastic nut with heat to remove it for wire feeding, then reinstall it for waterproofing.
- 5. Position the Control Box** within reach of the front bumper but away from potential hazards like road debris, direct water, or high heat. This Control Box is vital for the logo's operation and is resistant to water and heat, but extreme conditions can harm it.
- 6. Select a power source for the logo.** Any 12V source will suffice, such as a fuse, headlight wire, or direct battery connection. Use a 5A fuse with any power source. Commonly, an inline fuse connected to the car battery is used, but a fuse tap into the fuse box is an alternative.
- 7. Route the power and ground wires** from the Control Box to the chosen power location, avoiding high heat and moving parts.
- 8. Connect the Control Box to the logo** using the waterproof quick disconnect and secure the plastic nut. Align the arrows on both sides of the connector before connecting to prevent pin damage. This connector allows bumper removal without detaching the logo.
- 9. Reconnect the car battery** and download the provided app to control the logo!

LED HUE BLUETOOTH APP

Download the LEDHue app from the App Store/Google Play store.

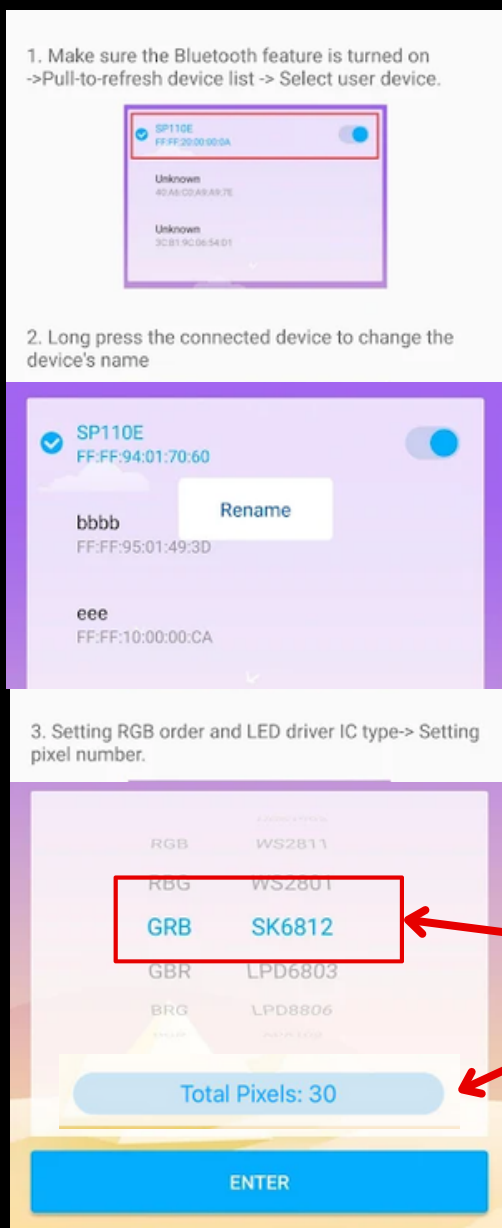

RGB Order should be **GRB** and LED Driver IC is **SK6812**

Make sure 'Total Pixels' is set to **30**

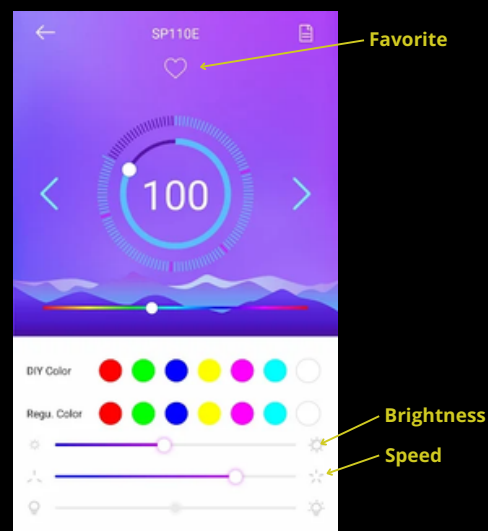

TROUBLESHOOTING STEPS

We hope you never encounter any problems with your logo, but if you do, here are the best steps to quickly get it back up and running smoothly:

Here are some troubleshooting steps to help you get your logo working properly:

1. **Turn off Bluetooth on your phone.** Uninstall and reinstall the app, then try to connect to the logo again.
2. **Check the ground source.** Ensure it's clean and connected to unpainted metal. We recommend connecting the ground wire to the same location where the battery is grounded.
3. **Try a different power source.** Sometimes a fuse tap doesn't reach far enough into the fuse, or the wire doesn't provide enough power. Try connecting the logo directly to the battery with an inline fuse.
4. **Verify app settings.** Ensure the logo is set to "GRB SK6812_RGBW" and the pixels are set to 15.
5. **Check the app settings.** Make sure the logo is switched to the "on" position in the app.
6. **Adjust the sliders in the app.** Ensure the bottom slider is turned all the way down and the top slider is turned all the way up.
7. **Try using a different phone** to connect to the logo.
8. **Check the arrows on the quick disconnect.** Ensure they are pointing towards each other.
9. **Power cycle the logo.** Disconnect the logo from power and leave it off for 12 hours.

Following these steps should help you resolve any issues.