

Gather all necessary Tools

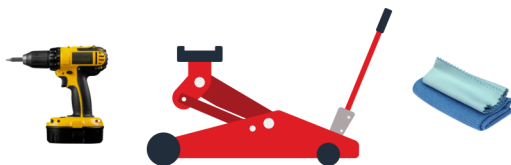

Order Includes:



Bluetooth Controller



Zip Ties



Mounting Clips

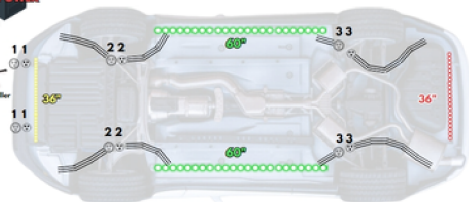
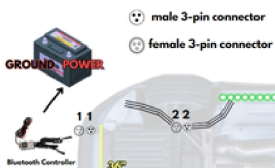

STEP 1. Testing the Kit

- Testing lights before installation
- Connecting lights with twist-on connectors
- Checking alignment with arrows on connectors

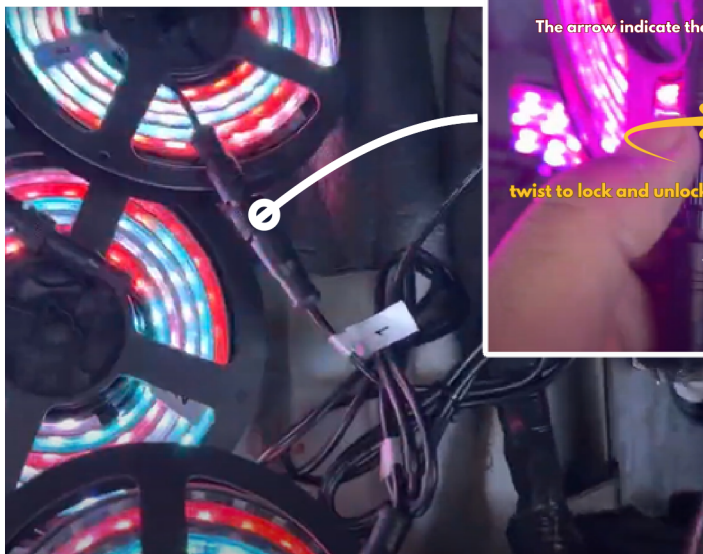

STEP 2. Preparing for Instalation

- Using mounting brackets and wiring diagram
- Cleaning surfaces (acetone or isopropyl alcohol)
- Ensuring a solid bond for mounting

Clean the underside of the car thoroughly where the kit will run.



STEP 3. Mounting the LED strips

- Drilling pilot holes for mounting
- Spacing holders and avoiding reliance on adhesive tape
- Routing wires away from exhaust and axles

Mount the LED strips using screws and brackets, ensuring proper spacing

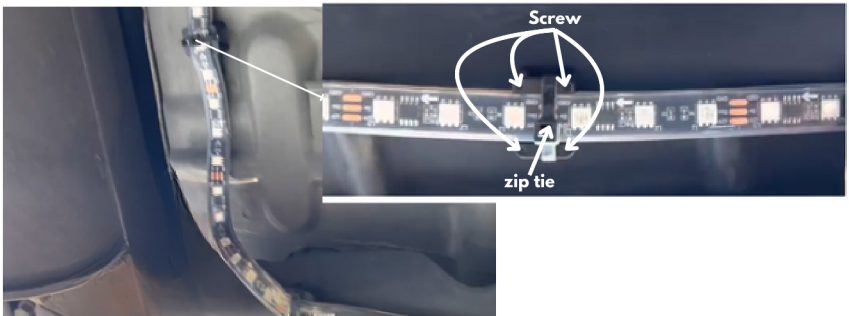

Take note of the numbering and refer to the wiring diagram



STEP 4. Finalizing the installation

- Tucking and securing wires with hardware
- Using zip ties for additional support



optional: Install a grommet for the wires to pass through cleanly into the trunk



STEP 5. Complete Installation

Congratulations! You have completed the installation



Download the LED Hue app



HOW TO SET UP APP

- Step 1: Download the app (LED Hue) in Google Play or App Store
- Step 2: Please make sure your phone's bluetooth is turned on
- Step 3: Open the app, swipe down to refresh. Click the device (sp110e) to connect
- Step 4: Please make sure the setting in the app are: GRB, WS2811.
Total pixels= 150+

note: android OS 6.0 or later version please request a location permission when you connect bluetooth device.



TIPS FOR INSTALLATION

- We recommend testing the lights before beginning any installation
- Please be careful not to step on the LED strips during install
- Please use screws and brackets to affix the lights under your car. The adhesive alone may not be sufficient to hold under heavy weather and road conditions.
- Color Chasing products pull very small amounts of power even when off, we recommend an on/off switch or wire to fuse if vehicle regularly sits for more than 7 days without being started.
- When installing we recommend hiding the cords that connect each lights strip behind the fender to avoid damage due to road conditions etc.

USE OF FUNCTIONS

1. Slide to select effect (120 total)
2. Click the heart icon to mark your favorite effect
3. Press and hold the heart icon to see all your favorite effects

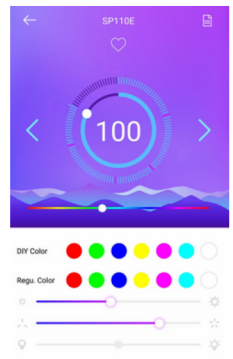

Kind Reminder

- The bluetooth device doesn't need a pin, if required, that means your connection step is wrong. Please uninstall the app and download again. Just turn the bluetooth on, then connect the device directly in the app
- If you need help, please feel free to contact us: info@rgbhalokits.com

Warranty

- Please note that the double sided tape on the back of the LED strips are meant for extra security and hold but not intended to hold the product by itself, please use the included mounting brackets, screws, and zip ties, along with any other method you see fit to security mount the LED Strips.
- Warranty covers any product defect. (ie. if the LED strip goes bad, Led's out, etc.) However, warranty does not cover physical damage to the LED strips themselves or if the LED strips or brackets fall off the vehicle, get scraped off, etc.