



**⚠ WARNING**

## FALL AND SUFFOCATION HAZARD

**FALL HAZARD** - Infant can fall through a wide leg opening or out of the carrier; Your balance is adversely affected when using carrier and you may trip or fall

- Adjust leg openings to fit baby's leg snugly
- Before each use, make sure all fasteners, belts, straps, snaps are secure
- Take special care when leaning or walking; lift support pole before moving
- Never bend at waist; bend at knees; never lean on support pole
- Only use this carrier for children between 12-44lbs and 4-36months
- One arm should support child at all times, with or without attachment top

**SUFFOCATION HAZARD** - Infants under 4months can suffocate in this product if face is pressed tight against your body

- Do not strap infant too tight against your body
- Allow room for head movement
- Keep infant's face free from obstructions at all times

**Mamapod™ Baby Carrier**

Model: S200

Baby Age: 4 - 36months  
 Carry Capacity: 12 - 44 lbs  
 Standard Compliance: ASTM F2236  
 Designed by Mamapod in California  
 www.mamapod.com 1-888-473-7821

Video Instruction at

**Care Instruction**

- Machine wash cold, separately, with mild detergent, drip dry
- Do not bleach, iron, tumble dry or dry clean
- Remove seat and support pole before washing
- Wipe clean with cloth or sponge between washings

HAND WASH NO BLEACH NO IRON NO TUMBLE DRY NO DRY CLEAN

**⚠ Read instruction thoroughly before assembling & using the carrier, please be aware:**

- Failure to following instruction may result in severe injury or death.
- Never leave baby unattended or unprotected.
- Baby's safety is your responsibility; Support baby at all times.
- Do not use if carrier is damaged or part is missing.
- Carrier is subject to normal wear & tear over time. Always check for ripped seams, torn straps or damaged fasteners to ensure that all buckles, snaps, zippers, seams, straps & adjustments are secure before each use.
- Baby must face towards you until baby is able to hold head upright.
- Premature infants, infants with respiratory problems, and infants under 4 months are at greater risk of suffocation.
- Wear carrier around waist not pelvis, fasten waist belt for weight bearing.
- Baby should be positioned with legs straddling the seat and both arms extending through arm holes.
- Always protect baby with one arm when putting on shoulder strap.
- Always ensure sufficient room around baby's face for good air flow, proper breathing & head movement.
- If use without wrapper, always protect baby at least with one hand and have baby wear safety belts.
- Use extra caution to prevent trip or fall when move around or adjust carrier.

- Only use support pole when standing. Do not use when you need to move around a lot.
- Lift or stow support pole before moving.
- Refrain from prolonged use. Never use for more than 2 hours without break or within 30 minutes after nursing.
- Monitor baby at all times. Carefully unload baby when you or baby feels uncomfortable.
- Never use while you are in strenuous activities except walking, standing or sitting.
- Never use while engaging in activities such as cooking and cleaning which involves a heat source or expose to chemicals.
- Be aware of and stay away from hazards in the surroundings such as fire, heat source, spilling of hot drinks.
- Never use when balance or mobility is impaired because of exercise, drowsiness or medical conditions.
- Never use while driving or being a passenger in a motor vehicle.
- Pregnant woman, low birth weight baby or baby with medical conditions should consult doctor before use.
- Avoid unnecessary excessive sun exposure to extend product life.

## Parts & Features

### As Hip Seat Carrier

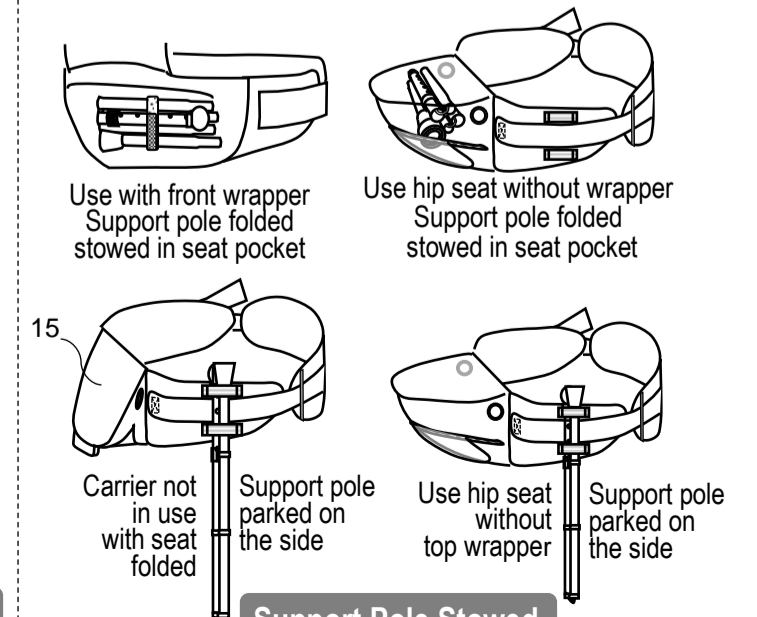
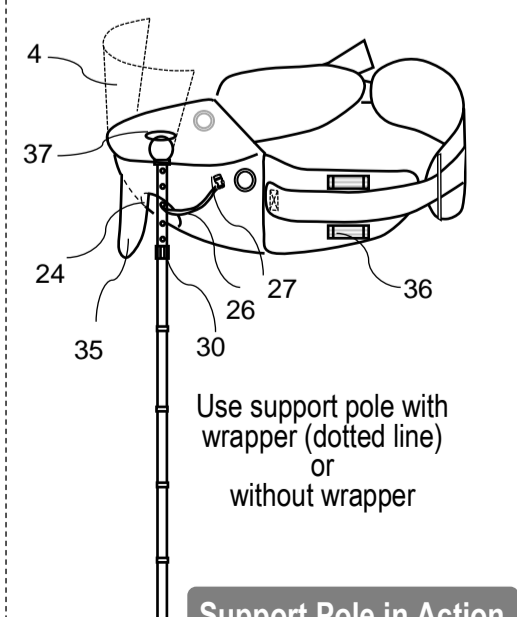
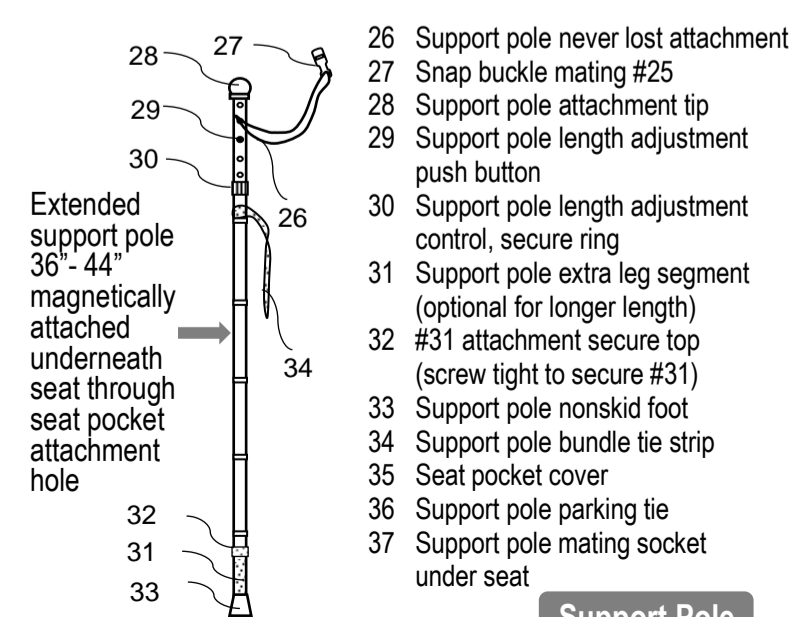
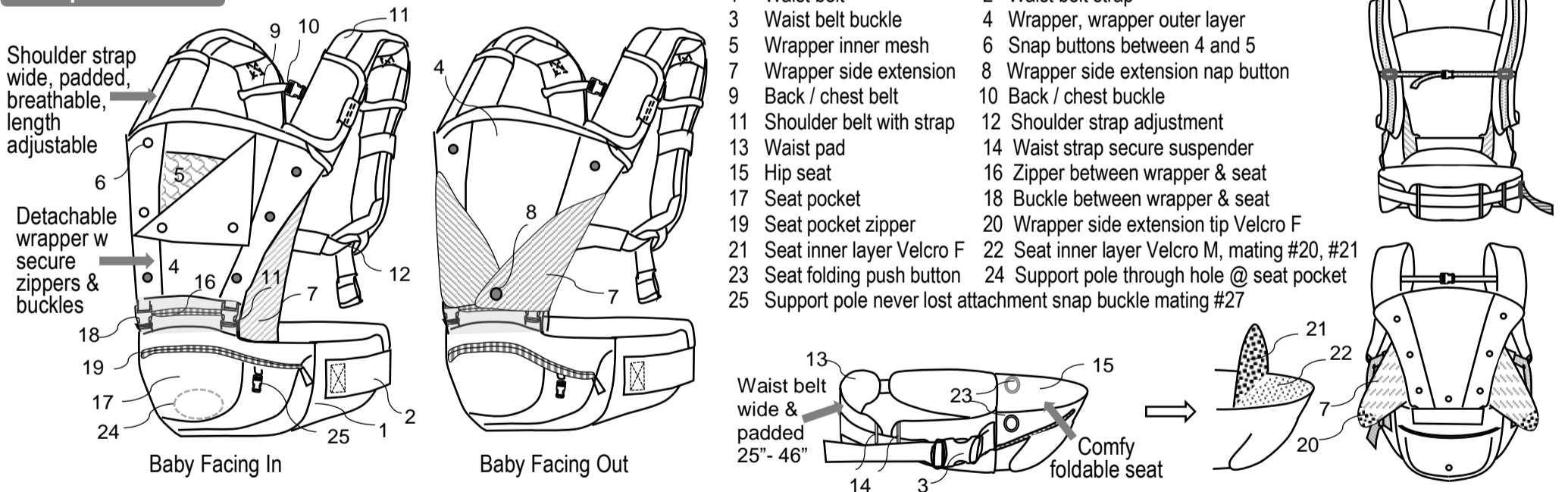

**Support Pole**

**Support Pole in Action**

**Support Pole Stowed**



# User Instruction



## Use without Support Pole

**WARNING! BABY MUST FACE TOWARD/OUT UNTIL IT IS STABLE TO HOLD ITS HEAD UPRIGHT  
KEEP ONE HAND ON BABY UNTIL ALL BUCKLES & STRAPS ARE PROPERLY FASTENED**

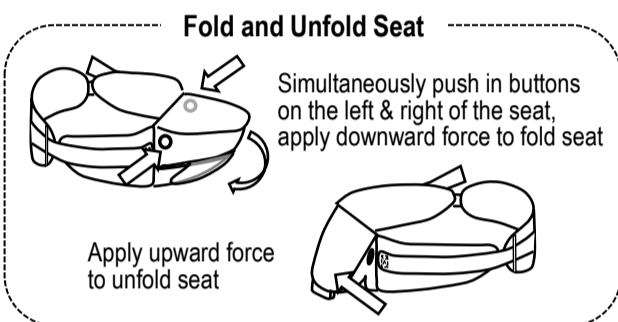
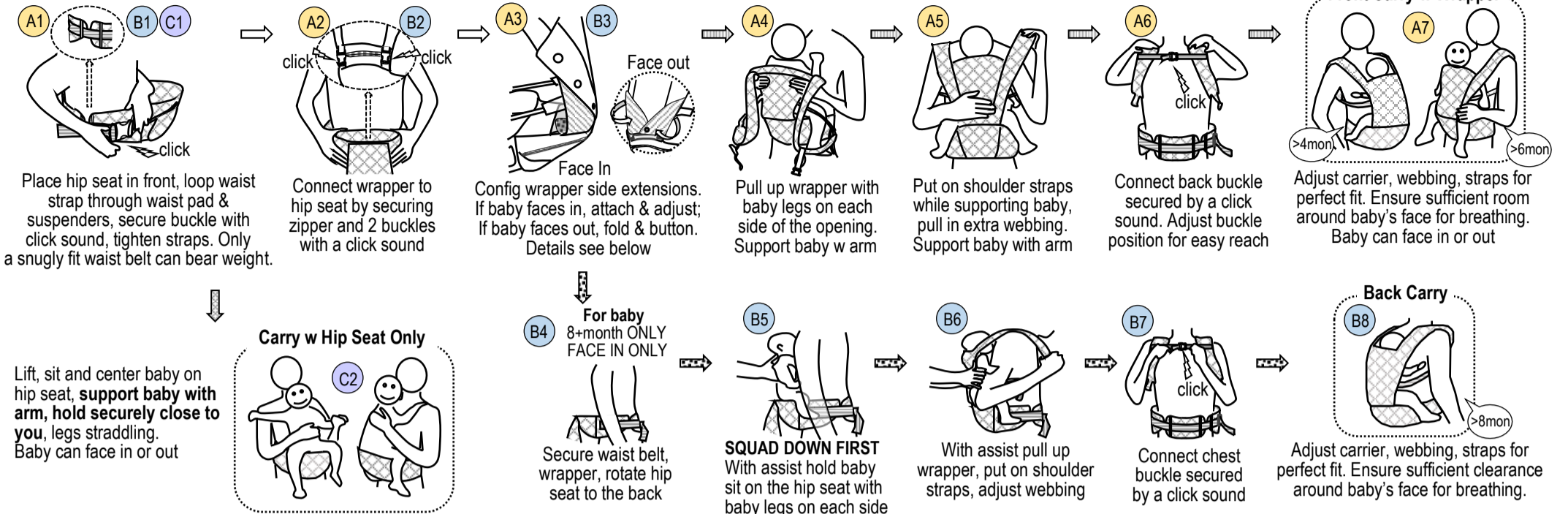

**IMPORTANT!**  
READ INSTRUCTION CAREFULLY BEFORE USE.  
FAILURE TO FOLLOW INSTRUCTION MAY RESULT IN DEATH OR SEVERE INJURY.  
KEEP INSTRUCTION FOR FUTURE REFERENCE

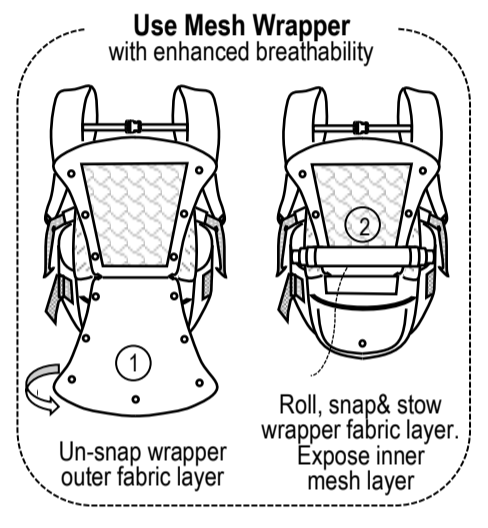
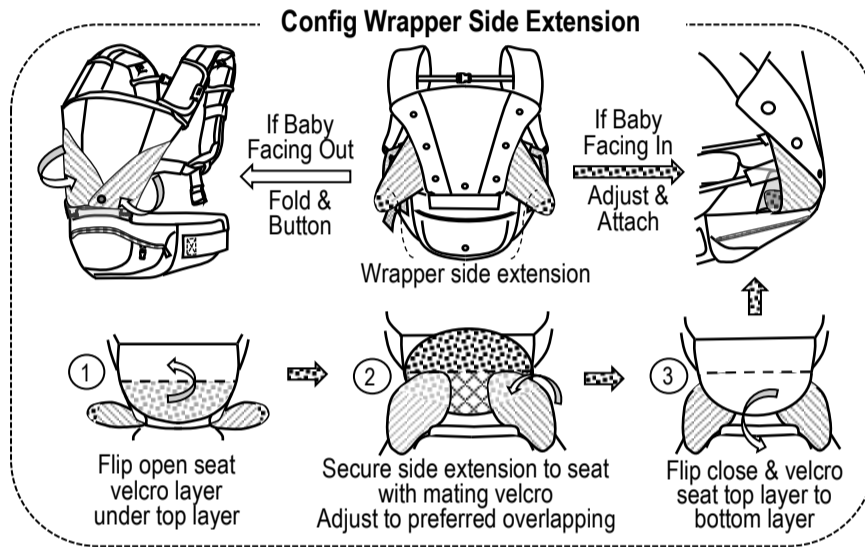

## Use With Support Pole

**WARNING! USE SUPPORT POLE ONLY WHEN STANDING AND NOT MOVING. ALWAYS PROTECT BABY WITH ARM. DO NOT LEAVE BABY**

