



FROM THE SOURCE handcrafted
furniture

DART DINING LEG

- Dart legs are made with iron and equipped with adjustable levelers. These elegant tapering legs work for tabletops with straight corners and flat edges and minimal thickness of 1.25 in.
- Clear finish for indoor use.
- Also available in a bench height.
- Work best with Lurus style tops 60 x 32 - 84 x 36 in.
- Not suitable to support slab tops and tops with live edges or beveled edges.
- Hand made in Central Java, Indonesia.

WIDTH: 1.25 - 7.25 in
TOTAL HEIGHT: 29.5 in
CLEARANCE: 28.25 in
MOUNTING PLATE: 7.25 x 7.25 in



2022 Finishes:
- Clear Iron (RC)



RC

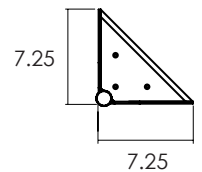
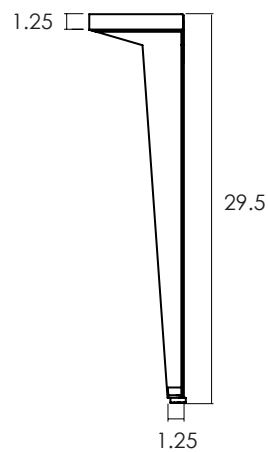

2022
sales@ftsny.com
www.ftsny.com