



BRUSHLESS FAN SHROUD ASSEMBLY INSTRUCTIONS

32-SP480

NOTE: If factory assembled, fan attachment bolts are torqued to proper specifications.

Kit components included:

QTY	ITEM	SKU#
1	Switch	32-SBL-TS-195P
1	Jumper	32-SP-Jumper
1	Harness	32-SP-TS Harn
1	Fan	32-SP30107101
1	Shroud	32-SP080

Hardware included:

QTY	ITEM	SKU#
4	Bolts	1/4-20 x 1 BHCS
4	Flaps	32-990
4	Nuts	1/4-20 Flange
4	Washers	1/4" AN
12	Screws	Self-Tapping

Tools needed:

- Torque wrench
- Ratchet + Extension
- 7/16" Socket
- 5/32" Allen
- #3 Phillips driver
- Pliers

Step 1

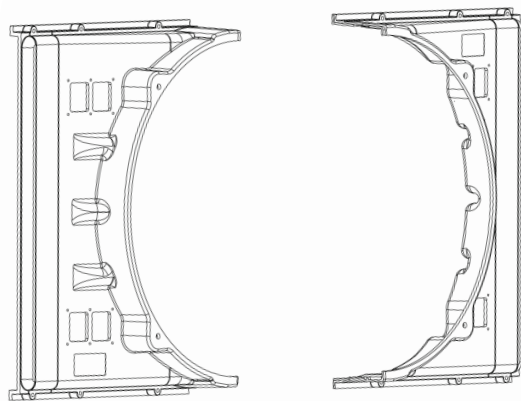

Connect the two halves by pushing them together until the interlocking tabs connect with each other and lock.

Step 2

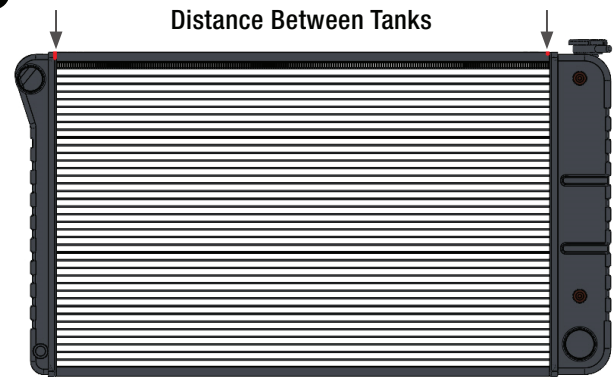

Measure your radiator in the flow direction between the tanks, then deduct 1/8" for shroud width.

Step 3

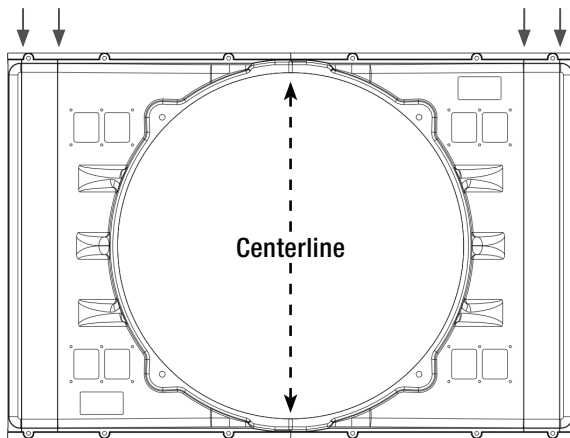

Center the radiator measurement on the shroud centerline. Note where your measurement ends in relation to the reference lines on the shroud. The lines molded in are for 22.5" and 26" wide radiators. Scribe your cut mark on the shroud and cut with a band saw, hack saw, or cutoff wheel.

Your cut may remove a mounting boss. Twelve (12) mounting bosses are molded into the shroud, only eight (8) are needed to mount the shroud to the radiator. After cutting, debur with a file or knife edge.

Step 4

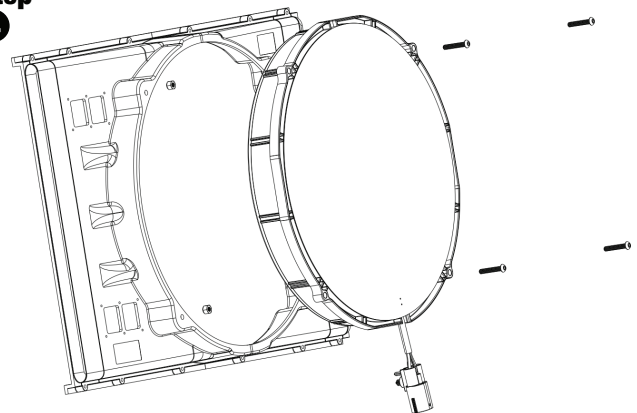

Attach a fan to the shroud using the four (4) 1/4"-20 x 1" button head cap screws with a washer on each one. Push bolts through the fan and into the shroud. Place flange nut on bolt from inside shroud. Torque to 90 in-lb.



BRUSHLESS FAN SHROUD ASSEMBLY INSTRUCTIONS

32-SP480

Step 5

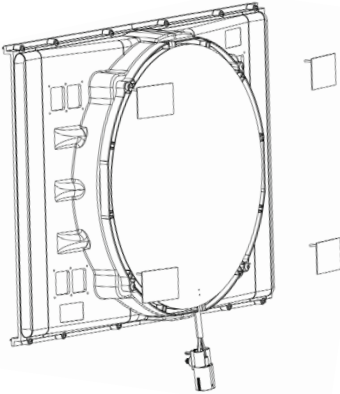

Install the four (4) rubber flaps, so they hang down, by piercing the pointed ends of the flap through the upper three (3) holes in the shroud. All four (4) flaps will use the upper mounting holes. Pull on the pointed ends with pliers until the flap fully seats against the shroud.

Step 6

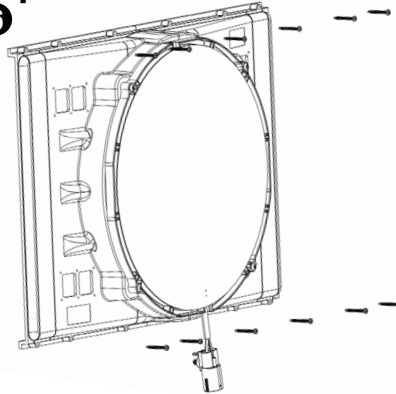

Using a self-tapping screw through each mounting boss, screw the shroud to the support (hat channel, extrusion) on the ends of the radiator with a #3 Phillips driver.

Step 7

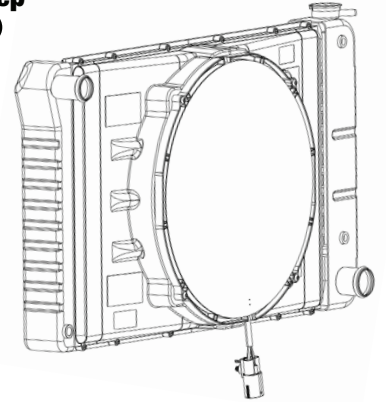

The radiator is ready for installation and wiring. See SPAL wiring diagram and instructions below.

BRUSHLESS FAN TECHNICAL INFORMATION

SKU #	SIZE	MOUNT STYLE	MOTOR	FUSE VALUE*	PUSH/PULL	CFM	HEIGHT	WIDTH	DEPTH
32-SP30107101	16"	DROP-IN MOUNT	500W	50 AMP MAXI FUSE	PULL	2430	17.00"	17.00"	3.20"

*Recommended fuse values only. Vehicle must support fuse rating. If unsure or you have questions regarding recommended fuse values, please contact DeWitts for support.

BRUSHLESS FAN TEMPERATURE SENSOR INFORMATION

SBL-TS-195P

MINIMUM "ON" SPEED AT 175°F / INCREASING TO 100% "FULL" SPEED AT 195°F

SPAL 12VDC

Brushless Fan Wiring Diagram

