

# *Electronic Cruise Control for* **HONDA ST1300**



The following provides a brief description of the power consumption and component locations of the MotorCycle Setup electronic cruise control.

Installed weight of the cruise control is approximately 2.3kg.

Current draw while the cruise is switched on, but not engaged, is approximately 0.10 amp (1 watts). Current draw while the cruise is engaged is nominally 0.50~0.80 amp (6~10 Watts).

By comparison, a head light bulb typically draws about 4 amps (55 Watts), and a tail light bulb (running light) draws about 0.4 amp (5 Watts).

Refer to the line drawing on the back of this sheet to identify the components from the numbers in the text.

The **Computer (1)** mounts in the rear storage compartment under the seat. It is mounted to the bike's ECU using self-adhesive Velcro.



The **Electric Throttle Servo (2)** (white rectangle in the photo below left) is mounted on the right side of the bike, on the fairing frame for the horn.



The **CIU (3)** is located near the front corner of the cylinder head, under the front of the air filter housing. A new **cable (4)** connects it to the throttle bodies.



The **Control Switch** has three different mounting brackets available.

The **Standard Control Switch mount (5A)** is shown here, above the handlebar, mounted on the clamp that mounts the clutch lever.



The optional **Low Control Switch mount (5B)** is shown here, below the handlebar, mounted on the clamp that mounts the clutch lever, however this will not fit with standard handlebars.

When the handlebars are turned full left, there is not enough space between the bike's switch block and the fuel tank for the switch (see photos below).

If the bike is fitted with higher bars, OR spacers to raise the standard bars (see next photo), the switch may fit.



## ***MotorCycle Cruise Controls***

**6 Kingston Street  
Mount Waverley VIC 3149  
AUSTRALIA**

**Web Site:** <http://www.mccruise.com>

**International:** **Phone** (International Access Code) 61 3 9808 2804

**Fax** (International Access Code) 61 3 9808 2445

**Australia:** **Phone** (03) 9808 2804

**Fax** (03) 9808 2445

**E-mail:** [sales@mccruise.com](mailto:sales@mccruise.com)

This bike had these spacers fitted to raise the handlebars, as a result there is enough space under the bars for the switch to be mounted below the bars.

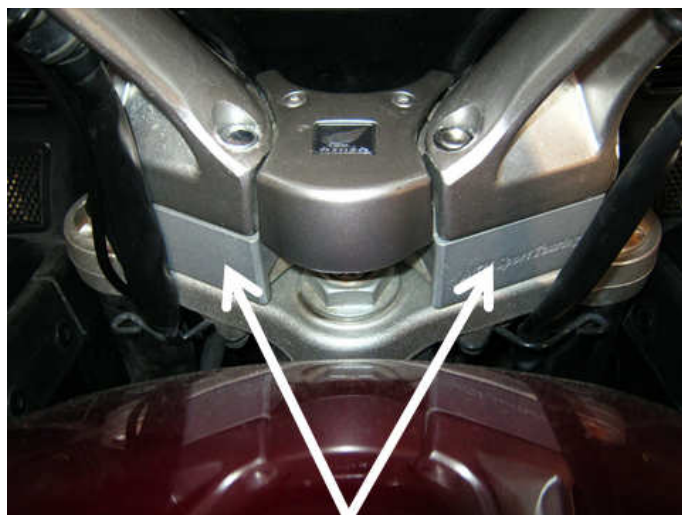

How to determine if there is space for the switch below the handlebars.

Turn the handlebars to full left lock.

Measure from the drain hole in the bottom of the switch block, down another 20mm (~3/4") (see arrow in photo). This is roughly where the cruise control switch will sit.

If there is more than 25mm (1") of space between the breather and the fuel tank when the handlebars are turned to full left lock, there is enough space for the switch to fit without risking damaging the fuel tank or switch during handlebar movement.



The third alternative switch mount is for bike's fitted with **Honda RDS Audio System (5C)**.

This bracket mounts on the RDS control panel mounting bolts. New longer bolts are provided in the kit to mount the switch.



## ***MotorCycle Cruise Controls***

**6 Kingston Street  
Mount Waverley VIC 3149  
AUSTRALIA**

**Web Site:** <http://www.mccruise.com>

**International:** **Phone** (International Access Code) 61 3 9808 2804

**Fax** (International Access Code) 61 3 9808 2445

**Australia:** **Phone** (03) 9808 2804

**Fax** (03) 9808 2445

**E-mail:** [sales@mccruise.com](mailto:sales@mccruise.com)

The **Wiring Harness (6)** has the same type of plugs or terminals that are already used on the motorcycle. Power for the cruise control and brake sensing is taken off the brake light circuit by unplugging the rear brake light switch. Matching connectors on the cruise control loom are plugged in to the switch and the bike's harness. Road speed sensing is detected from the bike's speedometer sender. Tach signal is sourced from one of the ignition coils. Tach signal is used to disengage the cruise if the clutch is operated. The bike's clutch switch is also connected to the cruise control to disengage the cruise control. The cruise control is grounded on the negative battery terminal.

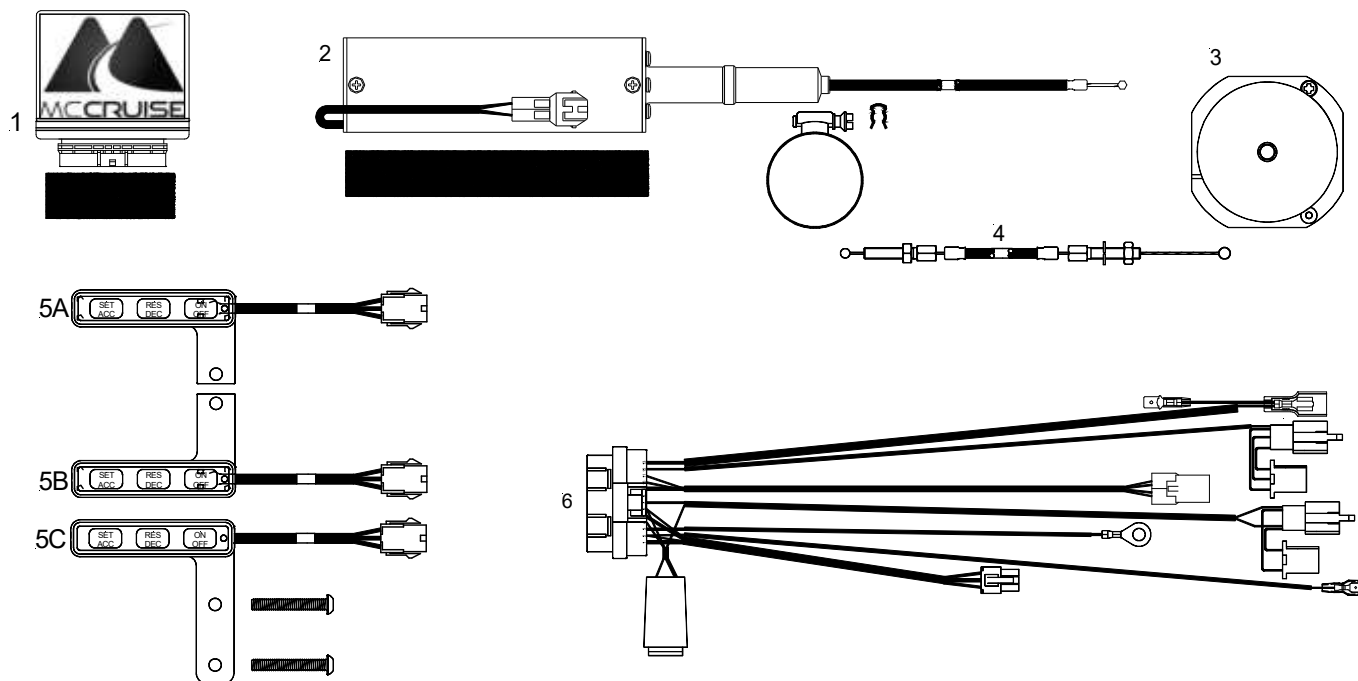

## *MotorCycle Cruise Controls*

6 Kingston Street  
Mount Waverley VIC 3149  
AUSTRALIA

Web Site: <http://www.mccruise.com>

International: Phone (International Access Code) 61 3 9808 2804

Fax (International Access Code) 61 3 9808 2445

Australia: Phone (03) 9808 2804

Fax (03) 9808 2445

E-mail: [sales@mccruise.com](mailto:sales@mccruise.com)