

Electronic Cruise Control for **Kawasaki Versys KLZ1000 from 2015**



The following provides a brief description of the power consumption and component locations of the MotorCycle Setup electronic cruise control.

Installed weight of the cruise control is approximately 2.5g.

Current draw while the cruise is switched on, but not engaged, is approximately 0.20 amp (2.5 watts). Current draw while the cruise is engaged is nominally 0.5~1 amp (6~12 Watts).

By comparison, a head light bulb typically draws about 4 amps (55 Watts), and a tail light bulb (running light) draws about 0.4 amp (5 Watts).

Refer to the line drawing on the back of this sheet to identify the component numbers in the text.

The **Computer (1)** mounts at the rear of the bike under the seat (photo left below). There is Velcro mounting tape provided in the kit as well as suitable screws and nuts to mount the computer.

The **Electric Throttle Servo (2)** can be mounted either under the seat next to the cruise control computer (photo left below) or may be mounted on the left side of the bike to the frame above the passenger footrest (photo below right). Note that the decision for mounting **MUST** be made when ordering the cruise control. Different parts that are **NOT** supplied in the kit are required to use the alternate mounting position. The under seat location means that only the cruise control switch is visible, but that does use some of the under seat storage space.



The **Cable Interface Unit (3)** is located near the front left corner of the fuel tank, inside the fairing panels. It has a new **cable (4)** connects it to the fuel injection throttle bodies.

A special bracket is provided in the kit to mount the servo and CIU.



The **Speed sensor (5)** is mounted on the right of the rear wheel, behind the ABS wheel speed sensor. Nickel-plated magnets are placed in the heads of the bolts that mount the brake disc.

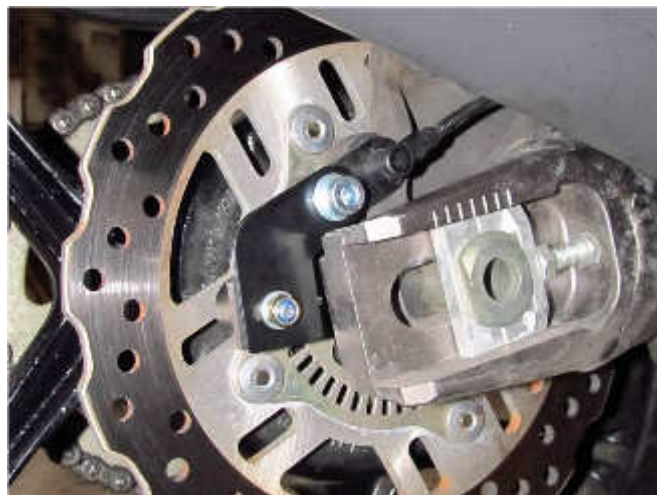

The **Control Switch (6a)** may be mounted above the handlebar on the mirror mount.



If you wish to mount the **Control Switch (6b)** below the handlebar, a replacement control switch bracket can be supplied in the kit at no extra cost.

For below handlebar mounting the bracket is mounted to the left hand (clutch) master cylinder handlebar clamp. The bracket mounts between the lower faces of the clamp. The clamp must have about 1~1.5mm (0.040"~ 0.060") filed from the lower face of the clamp to allow for the thickness of the switch bracket.

This bracket may also be purchased as a separate item if desired. The part number of this alternate bracket is MCS831A.

Note that some handlebar brush guards have mountings that will not allow the control switch to be mounted below the handlebars.



MotorCycle Cruise Controls

**6 Kingston Street
Mount Waverley VIC 3149
AUSTRALIA**

Web Site: <http://www.mccruise.com>

International: **Phone** (International Access Code) 61 3 9808 2804

Fax (International Access Code) 61 3 9808 2445

Australia: **Phone** (03) 9808 2804

Fax (03) 9808 2445

E-mail: sales@mccruise.com

The **Wiring Harness (7)** has the same type of plugs or terminals that are already used on the motorcycle. Power for the cruise control and brake sensing is taken off the brake light switches by unplugging the front brake light switch. Matching connectors on the cruise control loom are plugged in to the switch and the bike's harness. Tach (engine speed) sensing is detected from the bike's primary ignition circuit. This is used to disengage the cruise if the clutch is operated. The bike's clutch switch is also connected to the cruise control to disengage the cruise control. The cruise control is grounded on the battery negative terminal.

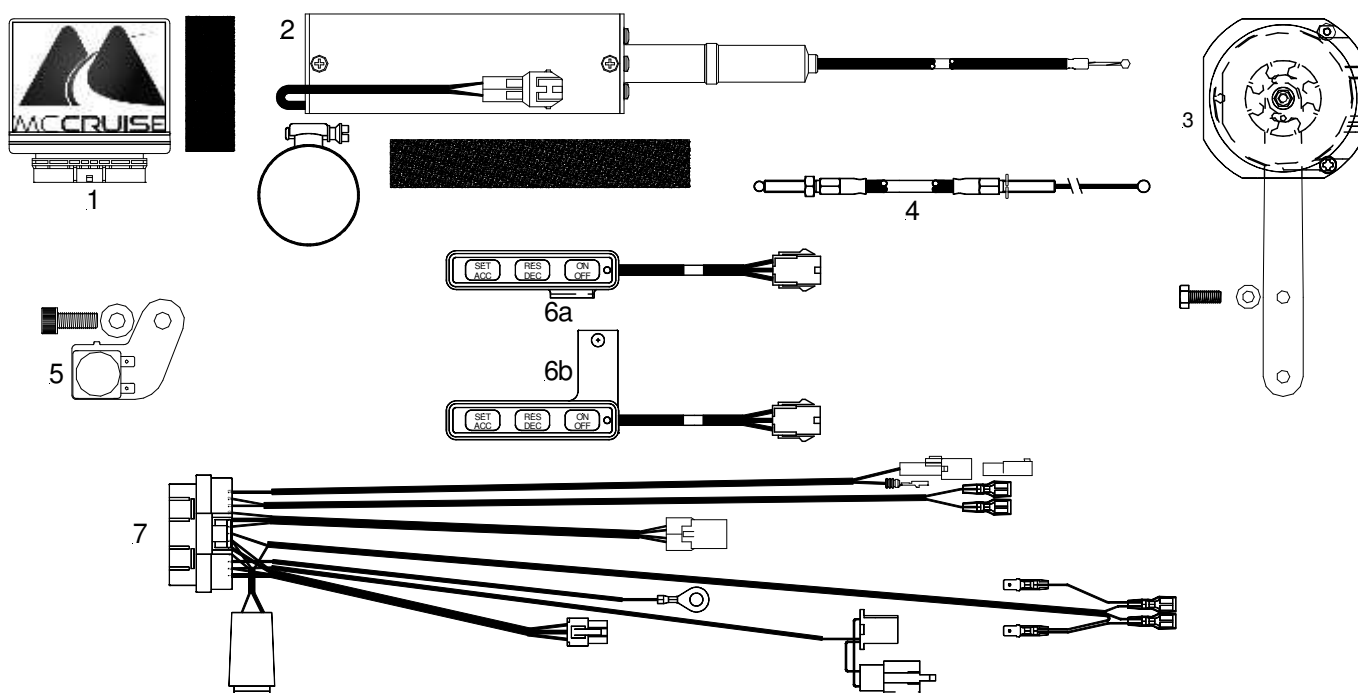

ORDERING THE CRUISE CONTROL.

When ordering the cruise control you must specify the location of the throttle servo (under the seat or on the left side of the bike on the frame) and the location of the control switch (above or below the handlebar).

Note that if your bike has brush guards on the handlebars with a mount that runs under the handlebar like the one in the photo, the control switch cannot be mounted below the handlebar, as the bracket blocks access to the clutch lever mount.



MotorCycle Cruise Controls

6 Kingston Street
 Mount Waverley VIC 3149
 AUSTRALIA

Web Site: <http://www.mccruise.com>

International: Phone (International Access Code) 61 3 9808 2804

Fax (International Access Code) 61 3 9808 2445

Australia: Phone (03) 9808 2804

Fax (03) 9808 2445

E-mail: sales@mccruise.com