

Electronic Cruise Control for **HONDA CB500X from 2013**



The following provides a brief description of the power consumption and component locations of the MotorCycle Setup electronic cruise control.

Installed weight of the cruise control is approximately 2.5kg.

Current draw while the cruise is switched on, but not engaged, is approximately 0.10 amp (1 watts). Current draw while the cruise is engaged is nominally 0.50~0.80 amp (6~10 Watts).

By comparison, a head light bulb typically draws about 4 amps (55 Watts), and a tail light bulb (running light) draws about 0.4 amp (5 Watts).

Refer to the line drawing on the back of this sheet to identify the components from the numbers in the text.

The **Computer (1)** is mounted under the passenger seat. There is self-adhesive Velcro provided in the kit to mount the computer.



The **Electric Throttle Servo (2)** (right arrow in the photo) is mounted on the right side of the bike, on the frame tube next to the radiator.

The **CIU (3)** is located near the right rear corner of the cylinder head. A new **cable (4)** connects it to the throttle bodies.



The **Control Switch (5)** mounts below the handlebar on the left side on the clutch lever mount.



The **Wiring Harness (6)** has the same type of plugs or terminals that are already used on the motorcycle. Power for the cruise control and brake sensing is taken off the brake light circuit by unplugging the rear brake light switch. Matching connectors on the cruise control harness are plugged in to the switch and the bike's harness. Road speed sensing is detected from the bike's speedometer sender using the same connection method. Tach signal is sourced from one of the ignition coils. Tach signal is used to disengage the cruise if the clutch is operated. The bike's clutch switch is also connected to the cruise control to disengage the cruise control. The cruise control is grounded on the negative terminal of the battery.

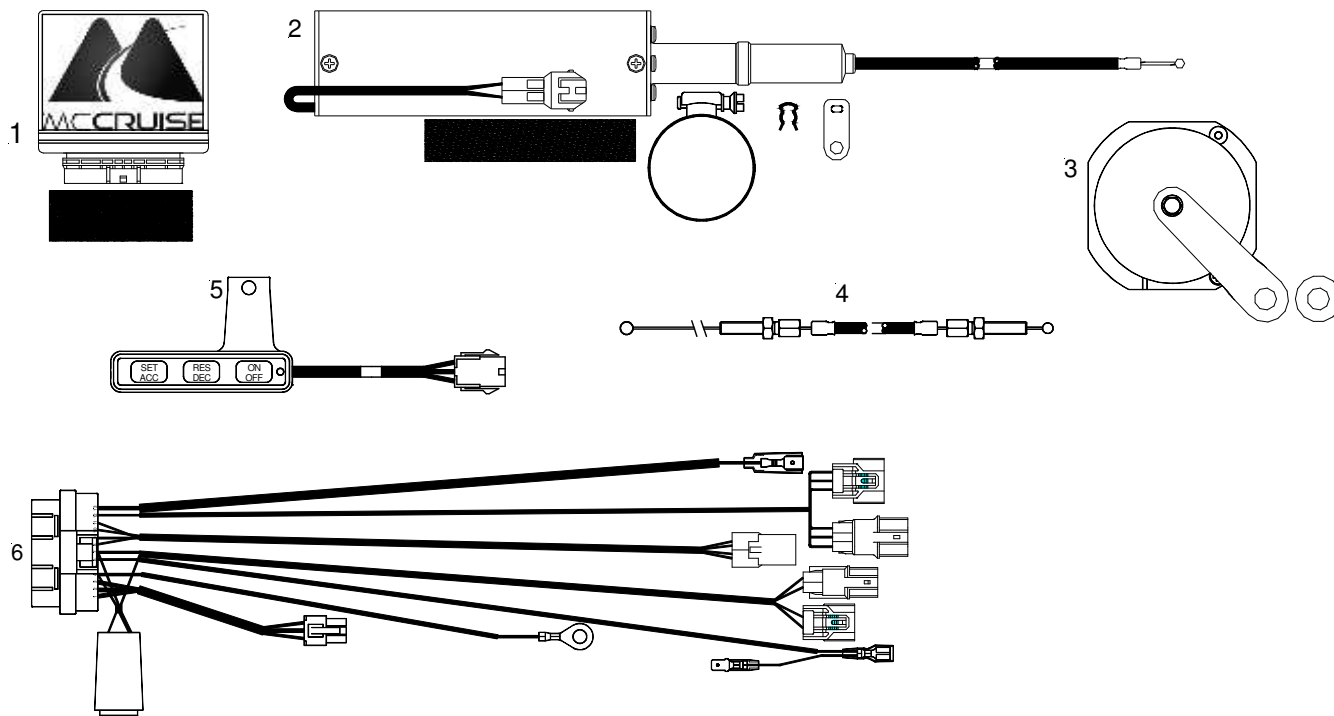

MotorCycle Cruise Controls

6 Kingston Street
 Mount Waverley VIC 3149
 AUSTRALIA

Web Site: <http://www.mccruise.com>

International: Phone (International Access Code) 61 3 9808 2804

Fax (International Access Code) 61 3 9808 2445

Australia: Phone (03) 9808 2804

Fax (03) 9808 2445

E-mail: sales@mccruise.com